

# ***DEPARTMENT OF THE ARMY PERMIT***

**Permittee:** Florida Department of Transportation  
C/o Frank Roberts  
Post Office Box 607  
Chipley, Florida 32428

**Permit No:** 200002363 (IP-CP)

**U.S. Army Engineer District, Jacksonville**

NOTE: The term "you" and its derivatives, as used in this permit, means the permittee or any future transferee. The term "this office" refers to the appropriate district or division office of the Corps of Engineers having jurisdiction over the permitted activity or the appropriate official of that office acting under the authority of the commanding officer.

You are authorized to perform work in accordance with the terms and conditions specified below.

**Project Description:** Discharge fill material over approximately 5.68 acres of forested wetlands to facilitate the widening of State Road 87 from U.S. Highway 98 to Five Forks Road.

**Project Location:** The project site encompasses approximately 3.25 miles of Right-of-Way for State Road 87 from U.S. Highway 98 to Five Forks Road. The project is located in Sections 4, 5, 8, 9, 17, and 20, Township 2 South, Range 26 West, Santa Rosa County, Florida.

**Latitude & Longitude:** Latitude.....30° 31' 20" North  
Longitude.....87° 05' 30" West

**Permit Conditions:**

**General Conditions:**

1. The time limit for completing the work authorized ends on 10 April 2007. If you find that you need more time to complete the authorized activity, submit your request for a time



Permittee: Florida Department of Transportation

Permit No: 200002363 (IP-CP)

Page 2

extension to this office for consideration at least one month before the above date is reached.

2. You must maintain the activity authorized by this permit in good condition and in conformance with the terms and conditions of this permit. You are not relieved of this requirement if you abandon the permitted activity, although you may make a good faith transfer to a third party in compliance with General Condition 4 below. Should you wish to cease to maintain the authorized activity or should you desire to abandon it without a good faith transfer, you must obtain a modification of this permit from this office, which may require restoration of the area.

3. If you discover any previously unknown historic or archeological remains while accomplishing the activity authorized by this permit, you must immediately notify this office of what you have found. We will initiate the Federal and State coordination required to determine if the remains warrant a recovery effort or if the site is eligible for listing in the National Register of Historic Places.

4. If you sell the property associated with this permit, you must obtain the signature and the mailing address of the new owner in the space provided and forward a copy of the permit to this office to validate the transfer of this authorization.

5. If a conditioned water quality certification has been issued for your project, you must comply with the conditions specified in the certification as special conditions to this permit.

6. You must allow representatives from this office to inspect the authorized activity at any time deemed necessary to ensure that it is being or has been accomplished in accordance with the terms and conditions of your permit.



Permittee: Florida Department of Transportation  
Permit No: 200002363 (IP-CP)  
Page 3

Special Conditions:

1. Prior to initiating landclearing or discharge of fill material in association with this permit, the permittee will erect entrenched silt fence and hay bales at the limit of wetland impact as depicted on Sheets 2-22 of 27 of the permit drawings. The limit of wetland impact is denoted by the following text "Wetland Excavation" and "Wetland Fill". The permittee will maintain the silt fence and hay bales for the duration of all construction associated with the project and until sufficient vegetation has established to stabilize the construction areas.
2. The permittee will ensure that sufficient monies are provided to the Northwest Florida Water Management District to ensure that no less than 175 acres of land is purchased from the area marked "Targeted Acquisitions" on Sheet 24 of 27 of the permit drawings. The permittee will assure the no less than 175 acres of land within 3 years of permit issuance. The Permittee will notify the Corps of Engineers Pensacola Regulatory office (41 North Jefferson Street Suite 104 Pensacola, Florida 32501) and the Jacksonville District Corps of Engineers Regulatory Division Enforcement Branch (Post Office Box 4970 Jacksonville, Florida 32232-0019) in writing immediately upon real estate closing for each parcel purchased.
3. The permittee will ensure that sufficient monies are provided to the Northwest Florida Water Management District to allow proper management of the no less than 175 acres referenced in Special Condition 1.
4. The permittee will ensure the not less than 175 acres of land will be managed in perpetuity by the Northwest Florida Water Management District following the general management provisions stated in the "MANAGEMENT POLICIES AND ACTIVITIES" section of the document entitled "Conceptual Management Plan for Mitigation Projects in Garcon Point, Yellow River, and Blackwater River Water Management Areas" as noted on Sheets 25-27 of 27 of the permit drawings. The Northwest Florida Water Management



Permittee: Florida Department of Transportation

Permit No: 200002363 (IP-CP)

Page 4

District's management strategy will focus on preservation, restoration, and maintenance of the ecological diversity of the land, with less of an emphasis placed on public recreational use as is noted on the document referenced above. The Corps of Engineers Pensacola Regulatory Office will be notified in writing of proposed alterations of the management strategy to allow comment as needed.

5. The permittee will ensure that a detailed baseline resource inventory (baseline monitoring) is accomplished and utilized to develop a specific management plan for each parcel purchased for a total of not less than 175 acres. The specific management plan will include provisions for utilization of prescribed fire on a 4-8 year rotational cycle after the initial fuel reduction burn. The specific management plan will include provisions requiring exotic and nuisance species to compose no more than 5% coverage when analyzing all vegetative strata collectively. The detailed resource inventory and specific management plan for each parcel will be completed within 180 days of real estate closing as referenced in Special Condition 1 above. The permittee will ensure that a copy of the resource inventory and specific management plan for each parcel is provided to the Corps of Engineers Pensacola Regulatory Office to allow for review and comment as needed. The Corps of Engineers Pensacola Regulatory Office will be provided a copy of the final specific management plan for each parcel. The final specific management plans for each parcel can be consolidated into a single unified management plan for the total acreage purchased.
6. The permittee will ensure the Corps of Engineers Pensacola Regulatory Office will be notified in writing of any proposed alteration of the final specific management plan referenced in Special Condition 5.
7. The permittee will ensure that the specific management plan for each parcel includes provisions for monitoring changes in vegetative composition and faunal use. Photographic monitoring at designated sampling stations



will be accomplished on transects utilized to sample vegetative conditions of the site. The specific management plan will provide a location and length for the transects and location for the sampling stations. The transects will be positioned at topographic, hydrologic, or vegetative gradients. The vegetative sampling will follow accepted scientific sampling protocols for the canopy, sapling/shrub, herbaceous, and woody vine vegetative stratum. Site specific monitoring will involve both observation and documentation of faunal use and include some form of functional assessment utilized to document changes in site characteristics. Site specific monitoring would occur during a monitoring period which would be scheduled in correlation to the occurrence of prescribed fire on the parcel. A monitoring report would be used to document the findings of the site specific monitoring, which occurred during a discrete monitoring period.

8. The permittee will ensure that baseline monitoring will be accomplished prior to initiation of activities required in the specific management plan. Monitoring reports will be submitted for a period to include a minimum of 4 rotational burns at which time the Corps of Engineers will render a decision if additional monitoring is necessary. All monitoring reports will be provided to the Corps of Engineers at the addresses listed in Special Condition 1 within 45 days of completion of the field data collection.
9. If upon submittal of the fourth monitoring report there is not evidence of enhanced ecological value as determined by the functional assessment, the permittee will submit an alternative mitigation proposal for Corps review and approval prior to implementation.
10. The permittee will ensure that if the State of Florida, acting through the North West Florida Water Management District, no longer desires to manage the not less than 175 acres for preservation, restoration, and maintenance of ecological diversity or acts to relinquish title to the



Permittee: Florida Department of Transportation

Permit No: 200002363 (IP-CP)

Page 6

not less than 175 acres, title to the not less than 175 acres can only be transferred to an entity that is qualified and legally required to manage the land in perpetuity for preservation, restoration, and maintenance of ecological diversity as required by the specific management plan(s).

The Corps of Engineers Jacksonville District Regulatory Division will be notified in writing of any change in ownership of the not less than 175 acres. This provision will be included on the deed to the not less than 175 acres.

11.

a. The permittee shall provide as-built drawings of the authorized work, including mitigation, and a completed As-Built Certification Form. The drawings and certification Form are to be submitted within 30 days of the completion of the authorized work, including mitigation, or at the expiration date listed on page 1 of the permit, whichever comes first. The drawings and Certification Form must be signed and sealed by a professional engineer registered in the State of Florida. In the event that the completed work deviates from the approved permit drawings and special conditions, the permittee shall describe, on the Certification Form, the deviations between the work authorized by the permit and the work as constructed. A blank form is attached. Please note that depiction and description of the deviations on the drawings and Certification Form does not necessarily mean that the U.S. Army Corps of Engineers will approve the deviation.

b. The as-built drawings shall include the following:

1. Location of the authorized work footprint (as shown on the permit drawings) with an overlay of the work as constructed.

2. Clear indication of any deviations which have been described on the As-Built Certification Form.

3. The Department of the Army permit number



Permittee: Florida Department of Transportation  
Permit No: 200002363 (IP-CP)  
Page 7

4. Please include pre- and post-construction aerial photographs of the project site, if available.

5. As-built drawings and Certification Forms shall be submitted to:

U.S. Army Corps of Engineers  
Regulatory Division, Enforcement Branch  
Attention: Alice Kirkland  
Post Office Box 4970  
Jacksonville, Florida 32232-00119

Further Information:

1. Congressional Authorities: You have been authorized to undertake the activity described above pursuant to:

(x) Section 10 of the Rivers and Harbors Act of 1899 (33 U.S.C. 403).

(X) Section 404 of the Clean Water Act (33 U.S.C. 1344).

( ) Section 103 of the Marine Protection, Research and Sanctuaries Act of 1972 (33 U.S.C. 1413).

2. Limits of this authorization.

a. This permit does not obviate the need to obtain other Federal, State, or local authorizations required by law.

b. This permit does not grant any property rights or exclusive privileges.

c. This permit does not authorize any injury to the property or rights of others.

d. This permit does not authorize interference with any existing or proposed Federal projects.



Permittee: Florida Department of Transportation

Permit No: 200002363 (IP-CP)

Page 8

3. Limits of Federal Liability. In issuing this permit, the Federal Government does not assume any liability for the following:

a. Damages to the permitted project or uses thereof as a result of other permitted or unpermitted activities or from natural causes.

b. Damages to the permitted project or uses thereof as a result of current or future activities undertaken by or on behalf of the United States in the public interest.

c. Damages to persons, property, or to other permitted or unpermitted activities or structures caused by the activity authorized by this permit.

d. Design or construction deficiencies associated with the permitted work.

e. Damage claims associated with any future modification, suspension, or revocation of this permit.

4. Reliance on Applicant's Data: The determination of this office that issuance of this permit is not contrary to the public interest was made in reliance on the information you provided.

5. Reevaluation of Permit Decision: This office may reevaluate its decision on this permit at any time the circumstances warrant. Circumstances that could require a reevaluation include, but are not limited to, the following:

a. You fail to comply with the terms and conditions of this permit.

b. The information provided by you in support of your permit application proves to have been false, incomplete, or inaccurate (see 4 above).



Permittee: Florida Department of Transportation

Permit No: 200002363 (IP-CP)

Page 9

c. Significant new information surfaces which this office did not consider in reaching the original public interest decision.

Such a reevaluation may result in a determination that it is appropriate to use the suspension, modification, and revocation procedures contained in 33 CFR 325.7 or enforcement procedures such as those contained in 33 CFR 326.4 and 326.5. The referenced enforcement procedures provide for the issuance of an administrative order requiring you comply with the terms and conditions of your permit and for the initiation of legal action where appropriate. You will be required to pay for any corrective measures ordered by this office, and if you fail to comply with such directive, this office may in certain situations (such as those specified in 33 CFR 209.170) accomplish the corrective measures by contract or otherwise and bill you for the cost.

6. Extensions: General Condition 1 establishes a time limit for the completion of the activity authorized by this permit. Unless there are circumstances requiring either a prompt completion of the authorized activity or a reevaluation of the public interest decision, the Corps will normally give favorable consideration to a request for an extension of this time limit.



Permittee: Florida Department of Transportation  
Permit No: 200002363 (IP-CP)  
Page 10

Your signature below, as permittee, indicates that you accept and agree to comply with the terms and conditions of this permit.

A total of 31 pages are affixed behind this signature page.

  
\_\_\_\_\_  
(PERMITTEE)

4-10-02  
(DATE)

This permit becomes effective when the Federal official, designated to act for the Secretary of the Army, has signed below.

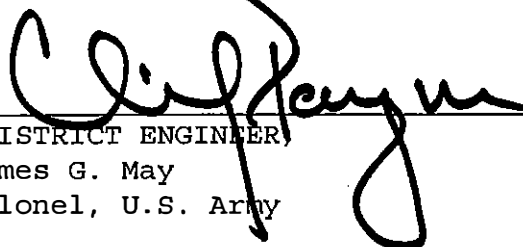
  
\_\_\_\_\_  
(DISTRICT ENGINEER)  
James G. May  
Colonel, U.S. Army

10 April 2002  
(DATE)





Permittee: Florida Department of Transportation  
Permit No: 200002363 (IP-CP)  
Page 11

**DEPARTMENT OF THE ARMY PERMIT TRANSFER REQUEST**

PERMIT NUMBER: 200002363 (IP-CP)

When the structures or work authorized by this permit are still in existence at the time the property is transferred, the terms and conditions of this permit will continue to be binding on the new owner(s) of the property. Although the construction period for works authorized by Department of the Army permits is finite, the permit itself, with its limitations, does not expire.

To validate the transfer of this permit and the associated liabilities associated with compliance with its terms and conditions, have the transferee sign and date below and mail to the U.S. Army Corps of Engineers, Pensacola Regulatory Office, 41 North Jefferson Street Suite 104, Pensacola, Florida 32501.

\_\_\_\_\_  
(TRANSFeree-SIGNATURE)

\_\_\_\_\_  
(SUBDIVISION)

\_\_\_\_\_  
(DATE)

\_\_\_\_\_  
(LOT)

\_\_\_\_\_  
(BLOCK)

\_\_\_\_\_  
(NAME-PRINTED)

\_\_\_\_\_  
(ADDRESS)

\_\_\_\_\_  
(CITY, STATE, AND ZIP CODE)



Permittee: Florida Department of Transportation

Permit No: 200002363 (IP-CP)

Page 12

***Attachment to Department of the Army  
Permit Number 200002363 (IP-CP)***

1. PERMIT DRAWINGS: Twenty-Seven (27) pages, dated 15 March 2002.



W.P.J. NO. 318043

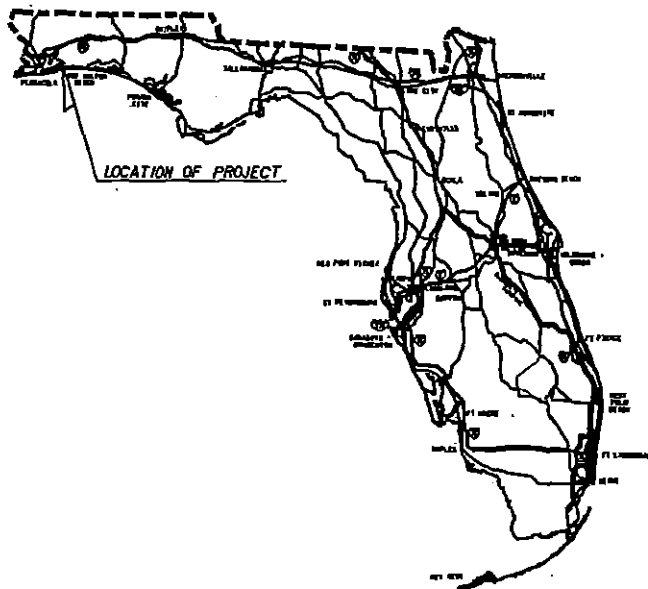

*Handwritten signature and date:*  
8/28/01

**END PROJECT**

STA. 159+42.296 & CONST. SR 87 =  
STA. 69+30.311 @ SURVEY SR 87  
tp 6.024 = MP 3.743

**EQUATION**

STA. 159+36.296 & CONST. SR 87 =  
STA. 69+24.311 @ SURVEY SR 87

END PROP. BRIDGE NO. 580077  
STA. 153+67.861 RT. ROADWAY  
END EXIST. BRIDGE NO. 58007  
STA. 153+67.861 LT. ROADWAY

BEGIN PROP. BRIDGE NO. 580077  
STA. 152+84.361 RT. ROADWAY  
BEGIN EXIST. BRIDGE NO. 58007  
STA. 152+88.586 LT. ROADWAY

END WEST RAMP  
STA. 423+0.590

END EAST RAMP  
STA. 528+93.072

BEGIN EAST RAMP  
STA. 524+32.154

BEGIN WEST RAMP  
STA. 417+87.692

**BEGIN PROJECT**

STA. 109+8.467 & CONST. SR 87  
tp 00.000 = MP 0.000 (SR 87)  
tp 32.148 = MP 19.976 (SR 30)

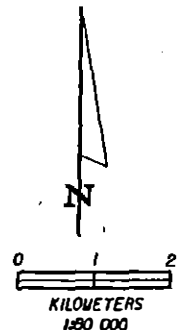
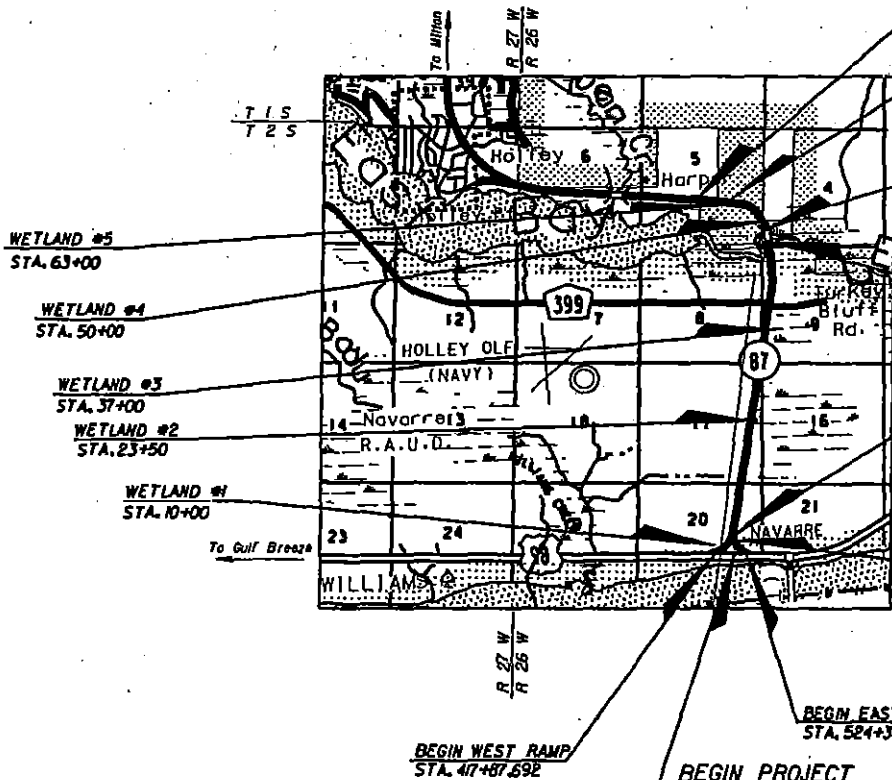

Applicant: Florida Department of Transportation (FDOT)

Water Body: N/A

County: Santa Rosa

Datum: NGVD 29 (Metric Conversion)

Applicant: FDOT

File: 200002363 IP-CP

Date: 15 March 2002

Page 1 of 27



NOT TO SCALE



DETENTION POND #6  
STA. 65+00.00

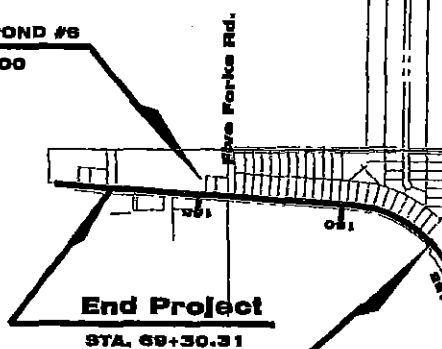

END BRIDGE NO.580177  
STA. 153+87.88 RT. ROADWAY  
STA. 153+87.88 LT. ROADWAY

BEGIN BRIDGE NO.580177  
STA. 152+84.38 RT. ROADWAY  
STA. 152+88.59 LT. ROADWAY

DETENTION POND #5  
STA. 57+50.00

DETENTION POND #4  
STA. 48+50.00

WETLAND #4

County Rd. 399

TUCKER BLUFF RD.

DETENTION POND #3  
STA. 40+50.00

WETLAND #3

DETENTION POND #2  
STA. 37+00.00

BLVD RIVERS RD.

WETLAND #2

*Handwritten signature: Jeffrey Allen*  
8/28/01

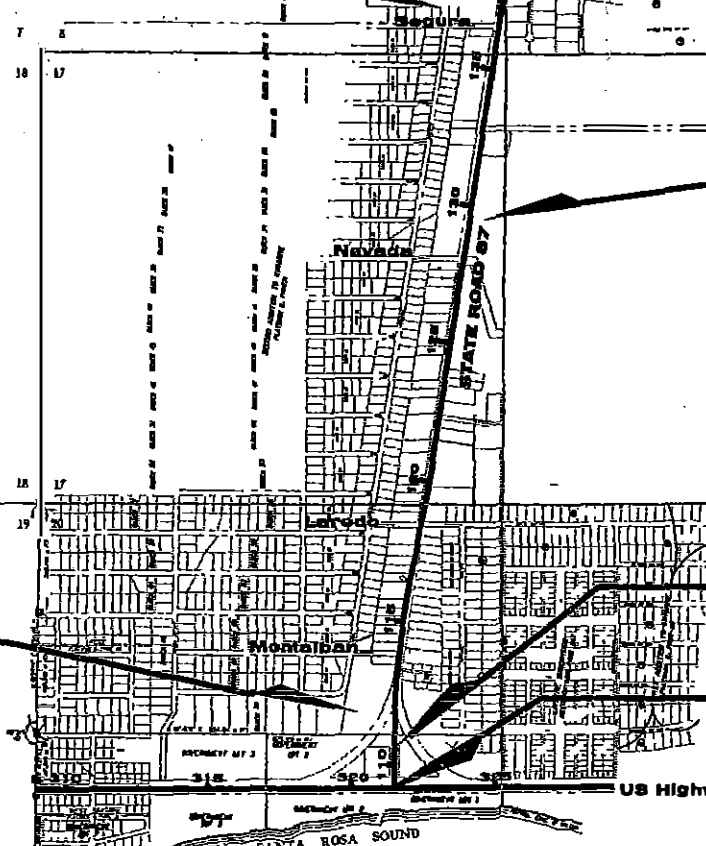

DETENTION POND #1  
STA. 13+00.00

WETLAND #1

Begin Project

STA. 109+18.47 ( Constr. SR 87

US Highway 98 (SR 30)

SANTA ROSA SOUND

Applicant: CorlanKilom Consulting Group, Inc.

Water Body: N/A

County: Santa Rosa

Datum: \_\_\_\_\_

Applicant: FDOT

File: 200002363 IP-CP

Date: 15 March 2002

Page 2 of 27



# Legend

R/W Line  
 Edge of Exist. Pavement  
 Wetland Boundary  
 Wetland Excavation  
 Wetland Fill

0 5 25  
 Meters

R/W LINE  
 EXISTING EDGE  
 OF PAVEMENT

EXISTING EDGE  
 OF PAVEMENT

R/W LINE

0.001 ACRES  
 FILL

PROPOSED EGDE  
 OF PAVEMENT

0.04 ACRES  
 FILL

R/W LINE

SIDEWALK

0.14 ACRES  
 CUT

R/W LINE

SR87 EAST RAMP

PROPOSED EDGE  
 OF PAVEMENT

R/W LINE

SIDEWALK

EXISTING EGDE  
 OF PAVEMENT

SR 30 (US 98)

Applicant: Florida Department of Transportation (FDOT)

Water Body: N/A

County: Santa Rosa

Datum: NGVD 29 (Metric Conversion)

Applicant: FDOT

File: 200002363 IP-CP

Date: 15 March 2002

Page 3 of 27



# Legend

R/W Line ———  
 Edge of Exist. Pavement ———  
 Wetland Boundary [stippled pattern]  
 Wetland Excavation [diagonal lines]  
 Wetland Fill [cross-hatch pattern]

0 10 50  
 Meters

EXISTING EDGE  
 OF PAVEMENT

PROPOSED EDGE  
 OF PAVEMENT

R/W LINE

MONTALBAN STREET

R/W LINE

SIDEWALK

PROPOSED EDGE  
 OF PAVEMENT

EXISTING EDGE  
 OF PAVEMENT

FILL  
 (SEE SHEET 3  
 FOR QUANTITY)

WETLAND \*1  
 WOIC

0.02 ACRES  
 FILL

R/W LINE

PROPOSED EDGE  
 OF PAVEMENT

EXISTING EDGE  
 OF PAVEMENT

WETLAND \*1  
 WOIA

Applicant: Florida Department of Transportation (FDOT)

Water Body: N/A

County: Santa Rosa

Datum: NGVD 29 (Metric Conversion)

Applicant: FDOT

File: 200002363 IP-CP

Date: 15 March 2002

Page 4 of 27



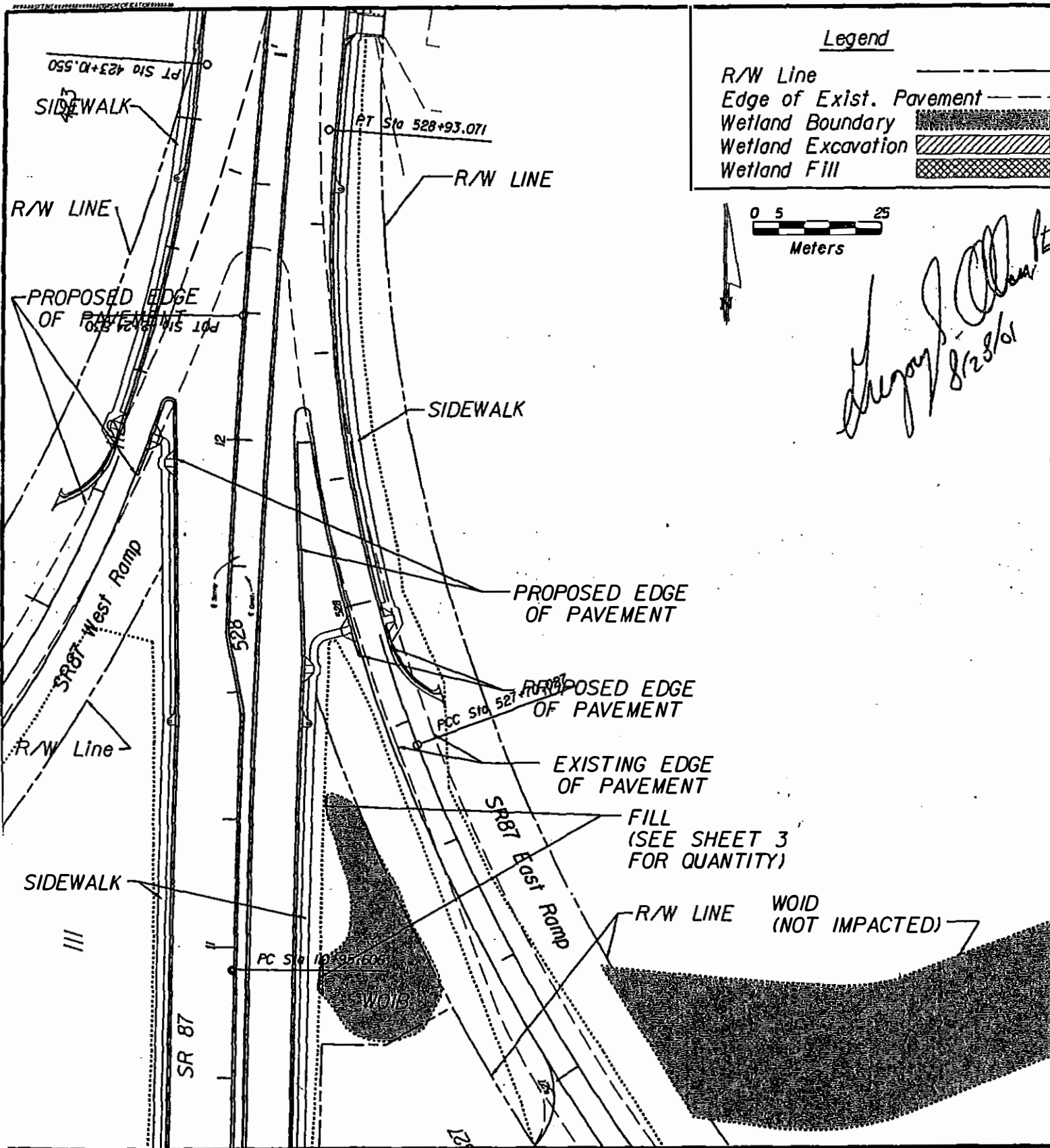

Applicant: Florida Department of Transportation (FDOT)

Water Body: N/A

County: Santa Rosa

Datum: NGVD 29 (Metric Conversion)

Applicant: FDOT

File: 200002363 IP-CP

Date: 15 March 2002

Page 5 of 27



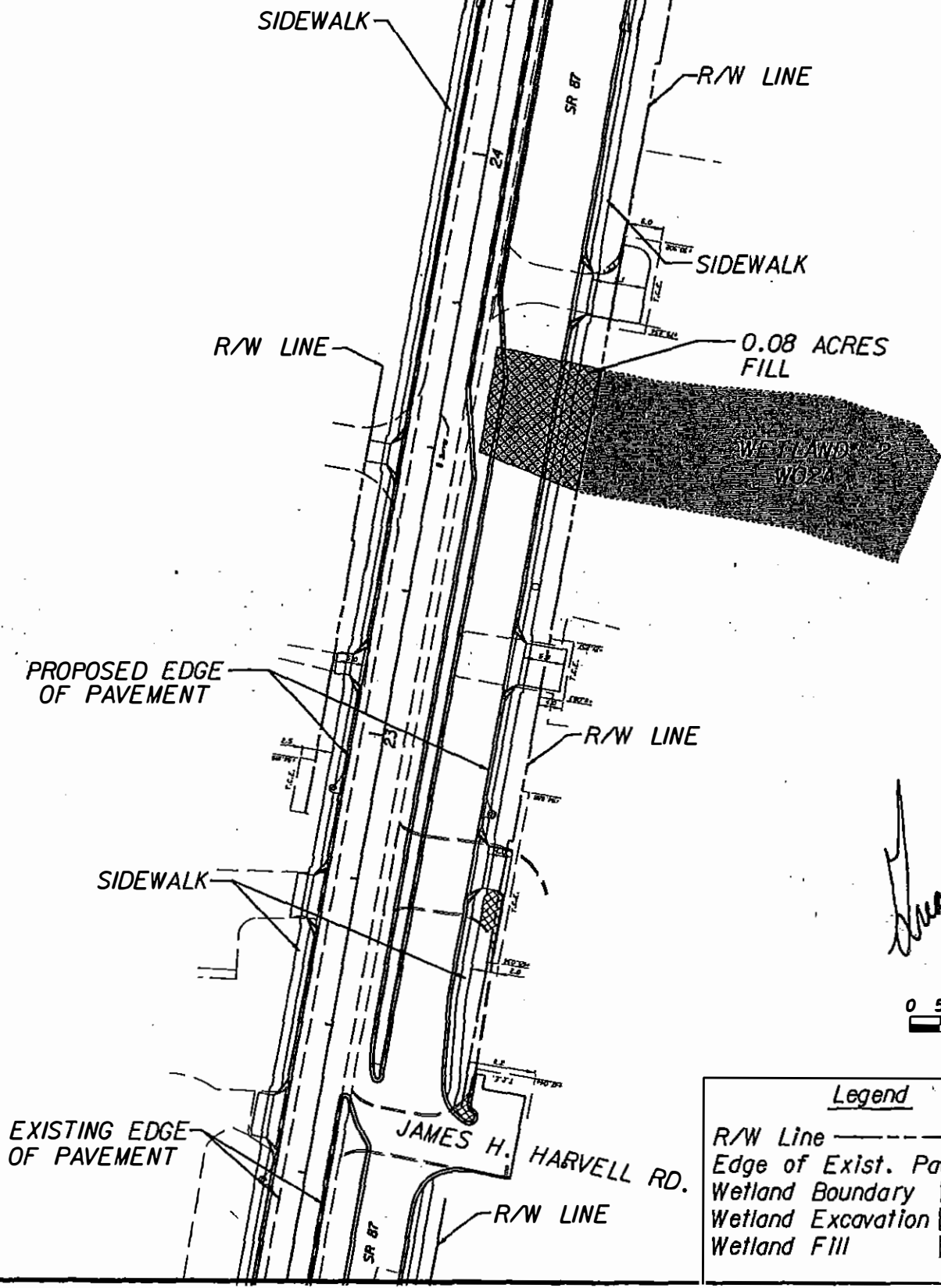

*Handwritten signature*  
 8/28/01  
 0 5 25  
 Meters

Legend	
R/W Line	-----
Edge of Exist. Pavement	-----
Wetland Boundary	-----
Wetland Excavation	-----
Wetland Fill	-----

Applicant: Florida Department of Transportation (FDOT)  
 Water Body: N/A  
 County: Santa Rosa  
 Datum: NGVD 29 (Metric Conversion)

Applicant: FDOT  
 File: 200002363 IP-CP  
 Date: 15 March 2002  
 Page 6 of 27



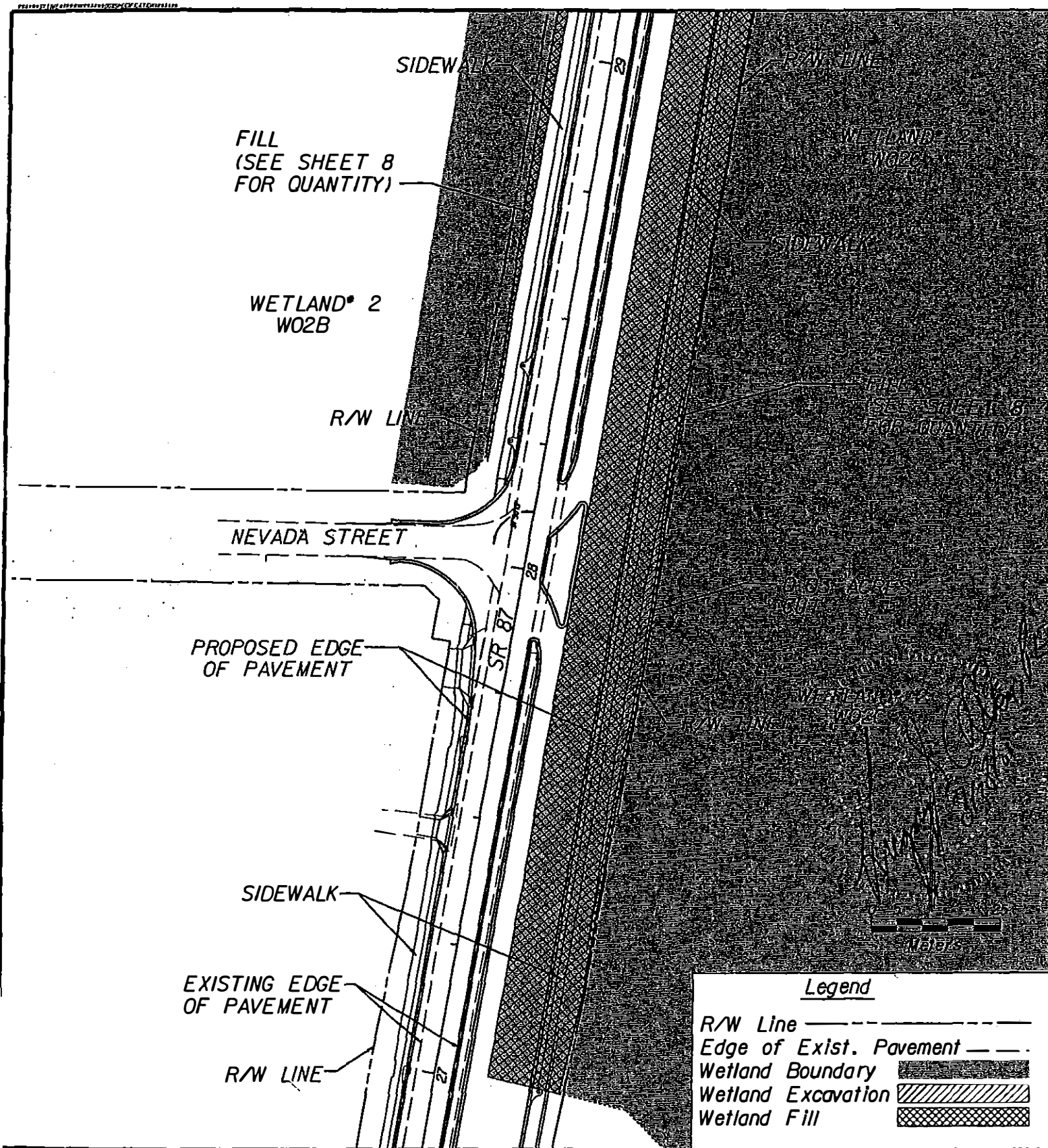

Applicant: Florida Department of Transportation (FDOT)

Water Body: N/A

County: Santa Rosa

Datum: NGVD 29 (Metric Conversion)

Applicant: FDOT

File: 200002363 IP-CP

Date: 15 March 2002

Page 7 of 27



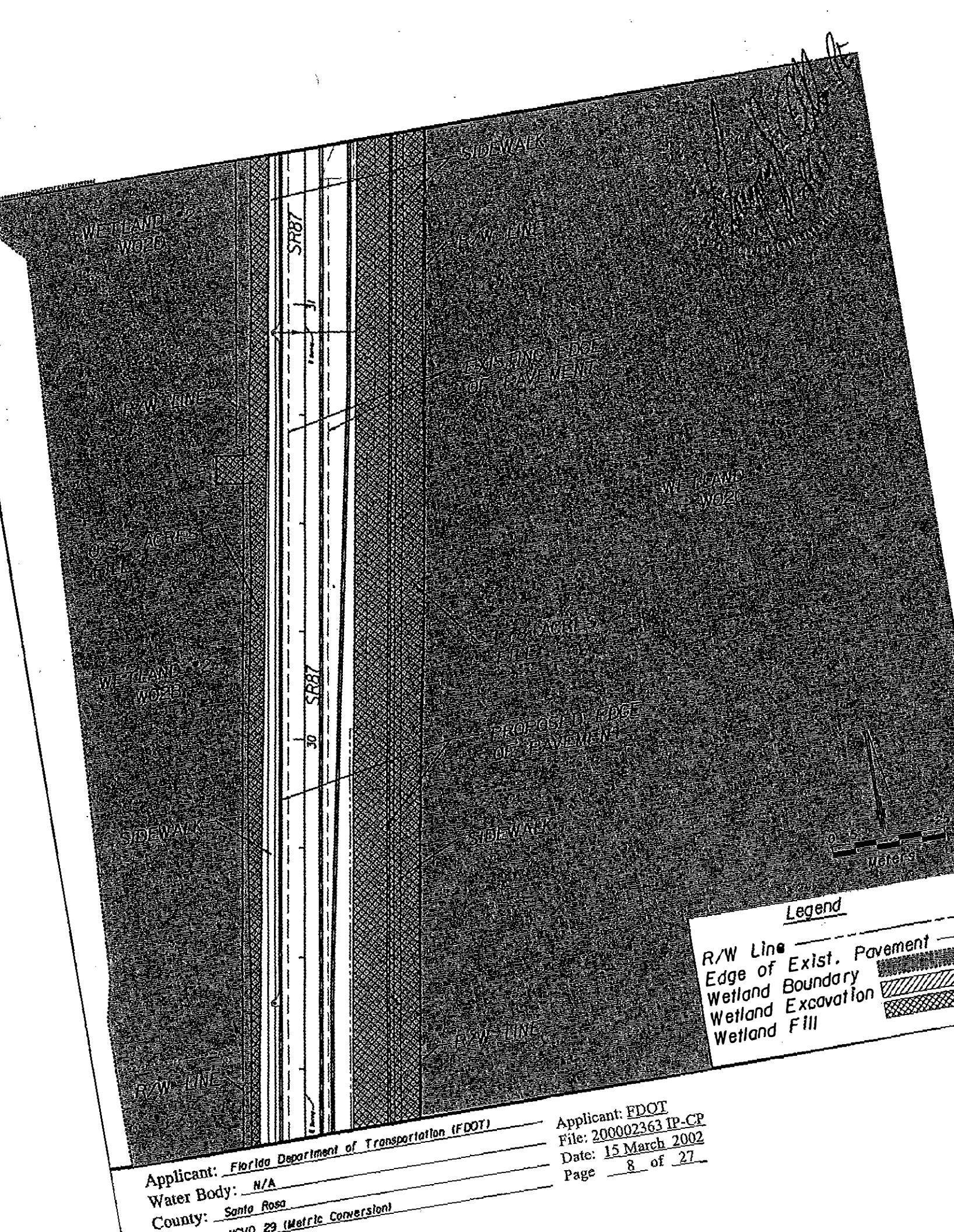

Applicant: Florida Department of Transportation (FDOT)  
Water Body: N/A  
County: Santa Rosa  
W020.29 (Metric Conversion)

Applicant: FDOT  
File: 200002363 IP-CP  
Date: 15 March 2002  
Page 8 of 27



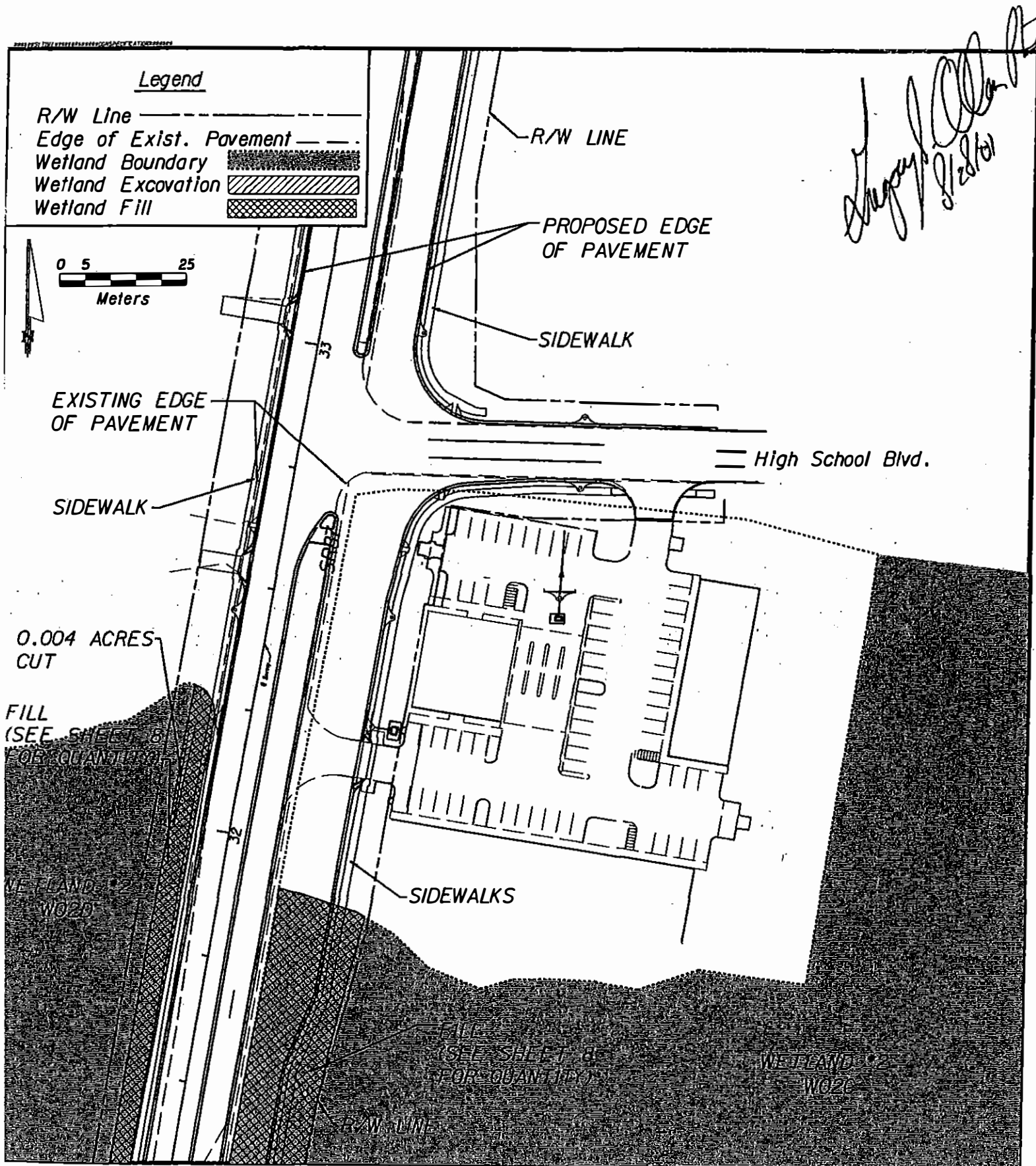

Applicant: Florida Department of Transportation (FDOT)

Water Body: N/A

County: Santa Rosa

Datum: NGVD 29 (Metric Conversion)

Applicant: FDOT

File: 200002363 IP-CP

Date: 15 March 2002

Page 9 of 27



# Legend

R/W Line ———  
 Edge of Exist. Pavement — — —  
 Wetland Boundary [stippled pattern]  
 Wetland Excavation [diagonal lines]  
 Wetland Fill [cross-hatch pattern]

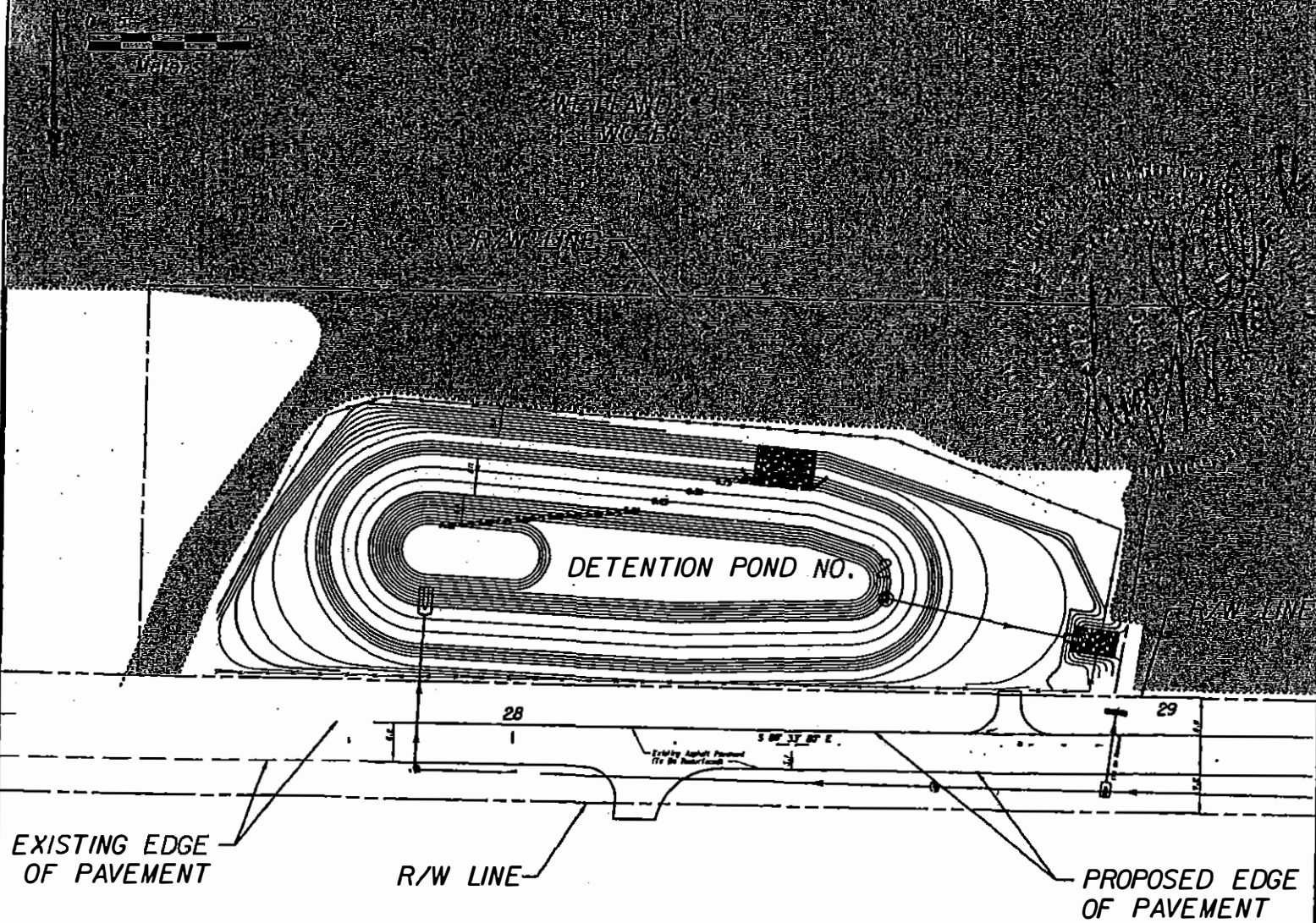

Applicant: Florida Department of Transportation (FDOT)

Water Body: N/A

County: Santa Rosa

Datum: NGVD 29 (Metric Conversion)

Applicant: FDOT

File: 200002363 IP-CP

Date: 15 March 2002

Page 10 of 27



# Legend

R/W Line  
Edge of Exst. Pavement  
Wetland Boundary  
Wetland Excavation  
Wetland Fill



R/W LINE

Sequoia Street

R/W LINE

FILL  
(SEE SHEET 12  
FOR QUANTITY)

WETLAND #3  
W03A

PROPOSED EDGE  
OF PAVEMENT

R/W LINE

Applicant: Florida Department of Transportation (FDOT)  
Water Body: N/A  
County: Santa Rosa

Applicant: FDOT  
File: 200002363 IP-CP  
Date: 15 March 2002  
Page 11 of 27

MSVD 29 (Metric Conversion)



Legend  
 New Line  
 Edge of Exist. Pavement  
 Wetland Boundary  
 Wetland Excavation  
 Wetland Fill

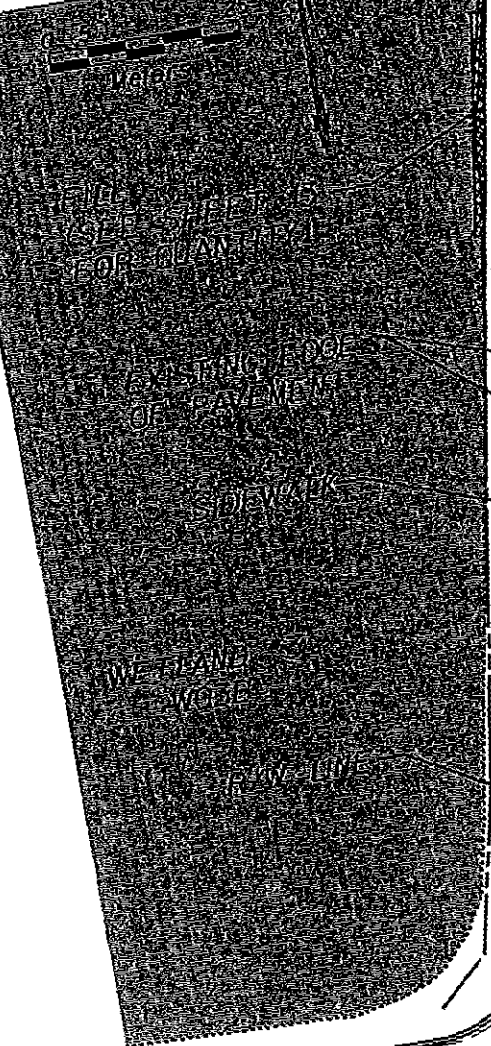

SR 87

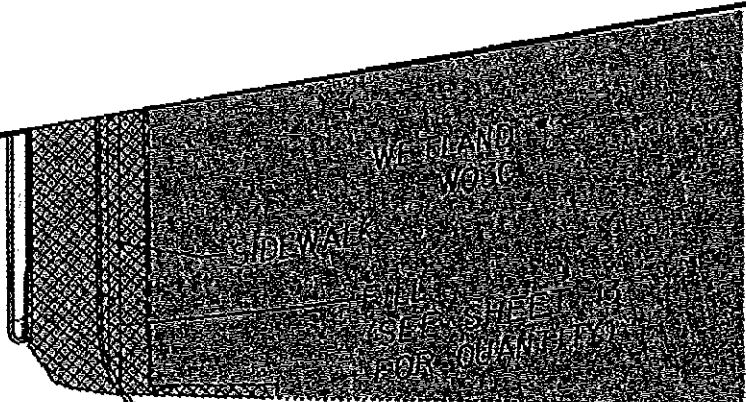

Bay River Road

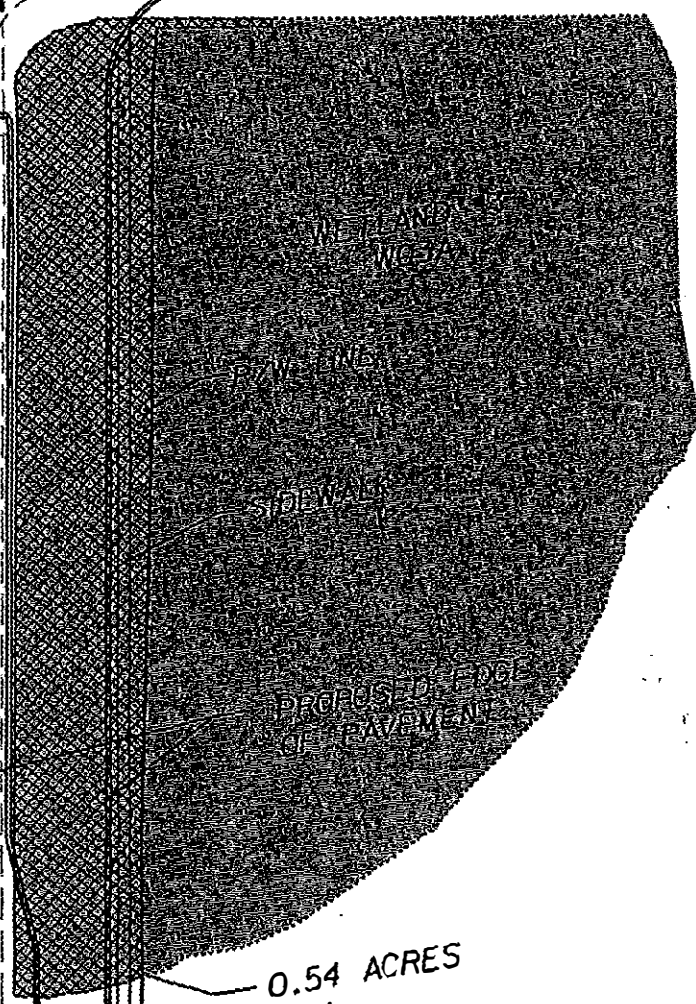

0.54 ACRES FILL

Segura Street

*Gregory J. Allen, P.E.*  
3/15/02



Legend

RW Line  
 Edge of Exst. Pavement  
 Wetland Boundary  
 Wetland Excavation  
 Wetland Fill

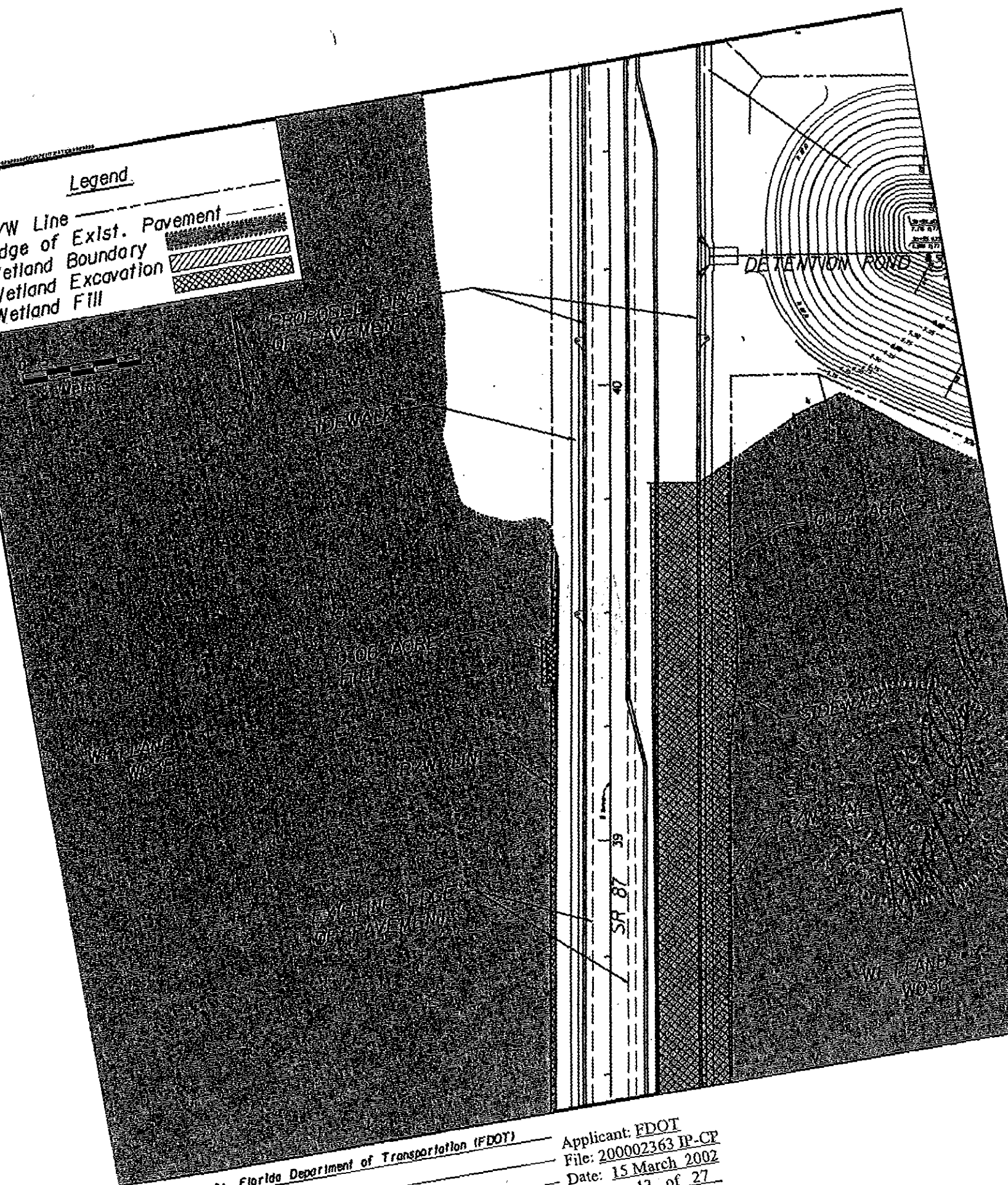

Applicant: Florida Department of Transportation (FDOT)  
 Water Body: N/A  
 County: Santa Rosa  
 Datum: NGVD 29 (Metric Conversion)  
 Applicant: FDOT  
 File: 200002363 IP-CP  
 Date: 15 March 2002  
 Page: 13 of 27



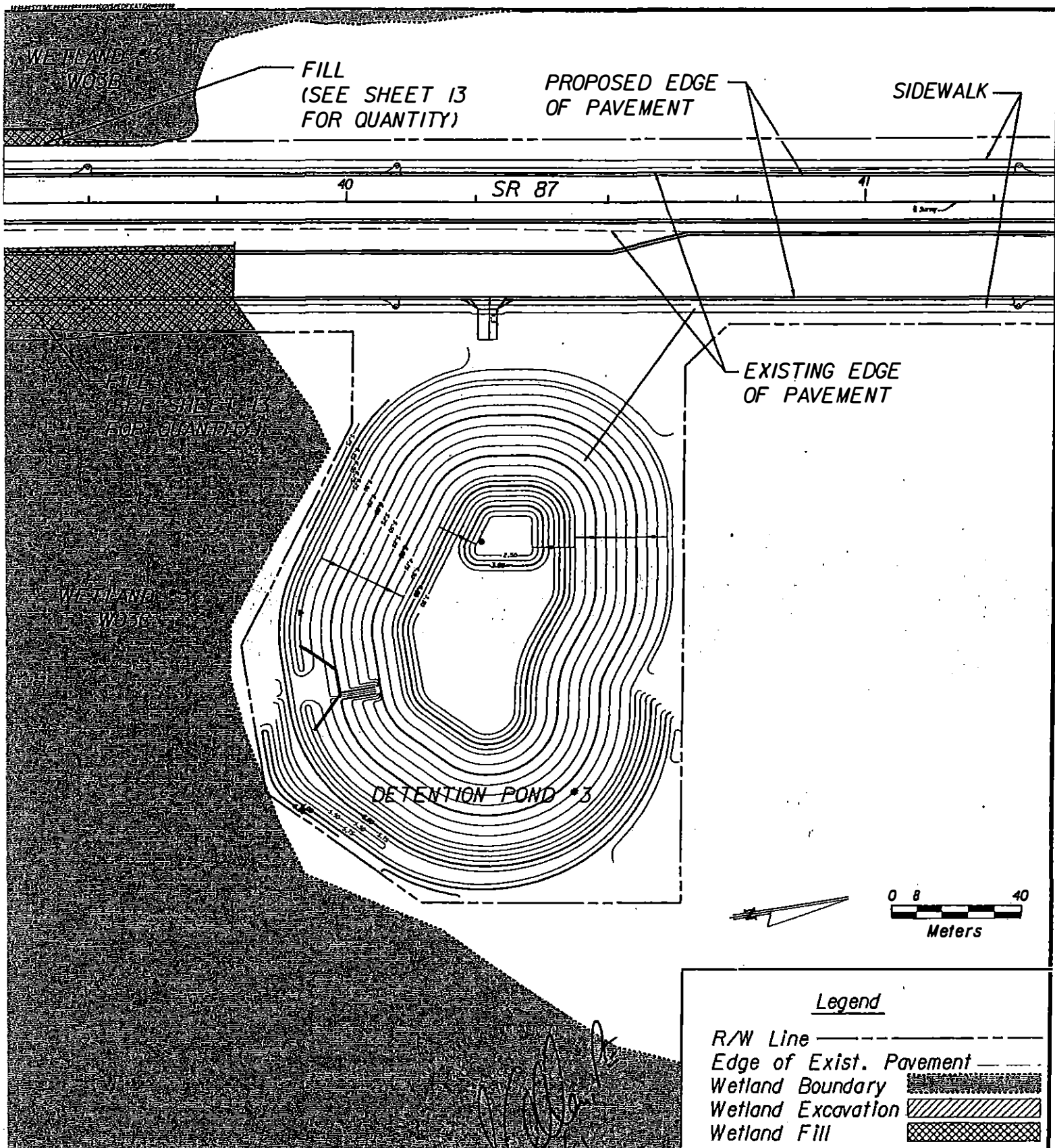

Applicant: Florida Department of Transportation (FDOT)

Water Body: N/A

County: Santa Rosa

Datum: NGVD 29 (Metric Conversion)

Applicant: FDOT

File: 200002363 IP-CP

Date: 15 March 2002

Page 14 of 27



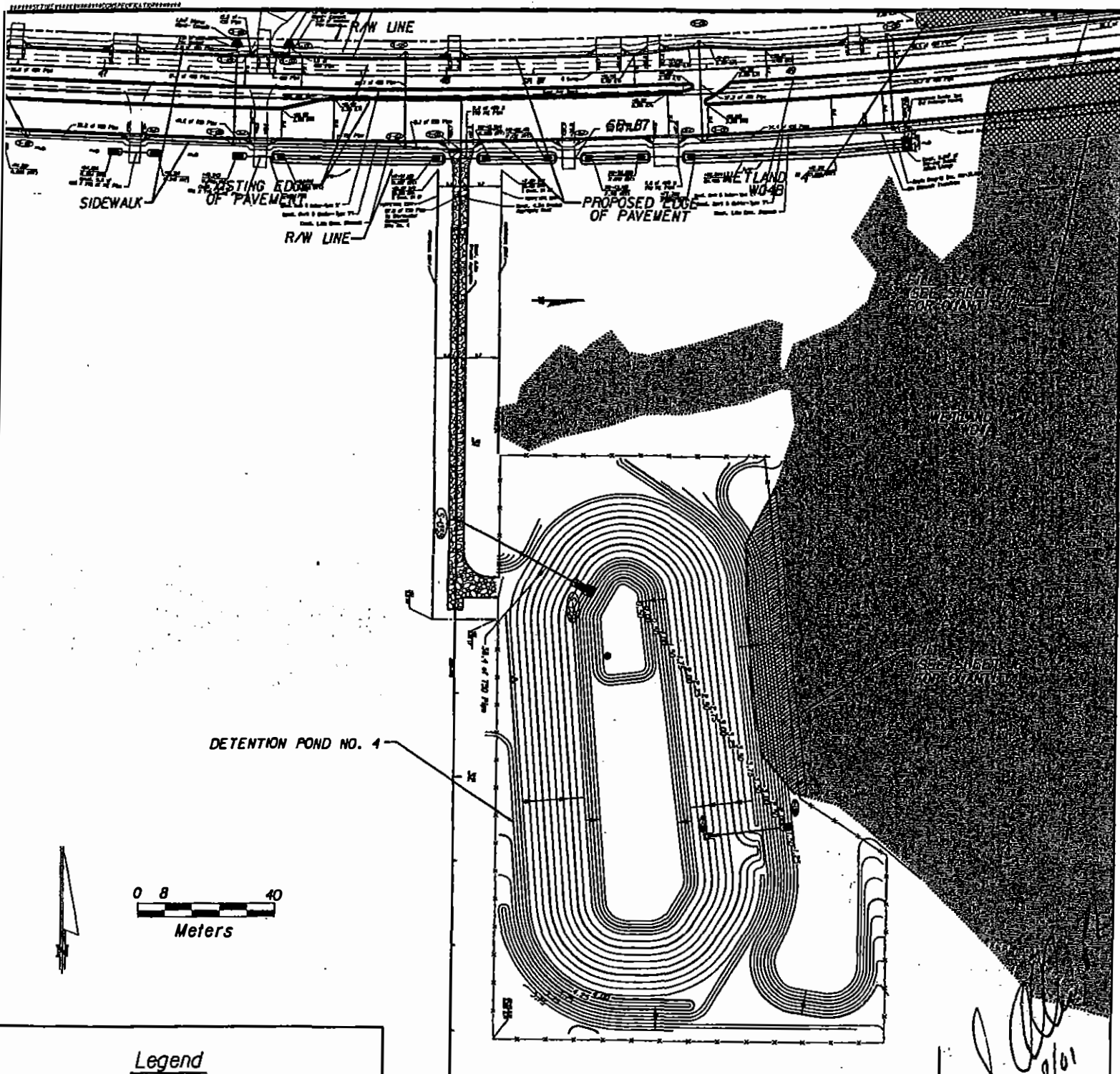

### Legend

R/W Line ———  
 Edge of Exist. Pavement — — —  
 Wetland Boundary [stippled pattern]  
 Wetland Excavation [diagonal hatching]  
 Wetland Fill [cross-hatching]

Applicant: Florida Department of Transportation (FDOT)

Water Body: N/A

County: Santa Rosa

Datum: NGVD 29 (Metric Conversion)

Applicant: FDOT

File: 200002363 IP-CP

Date: 15 March 2002

Page 15 of 27

*Handwritten signature and date: 3/28/01*



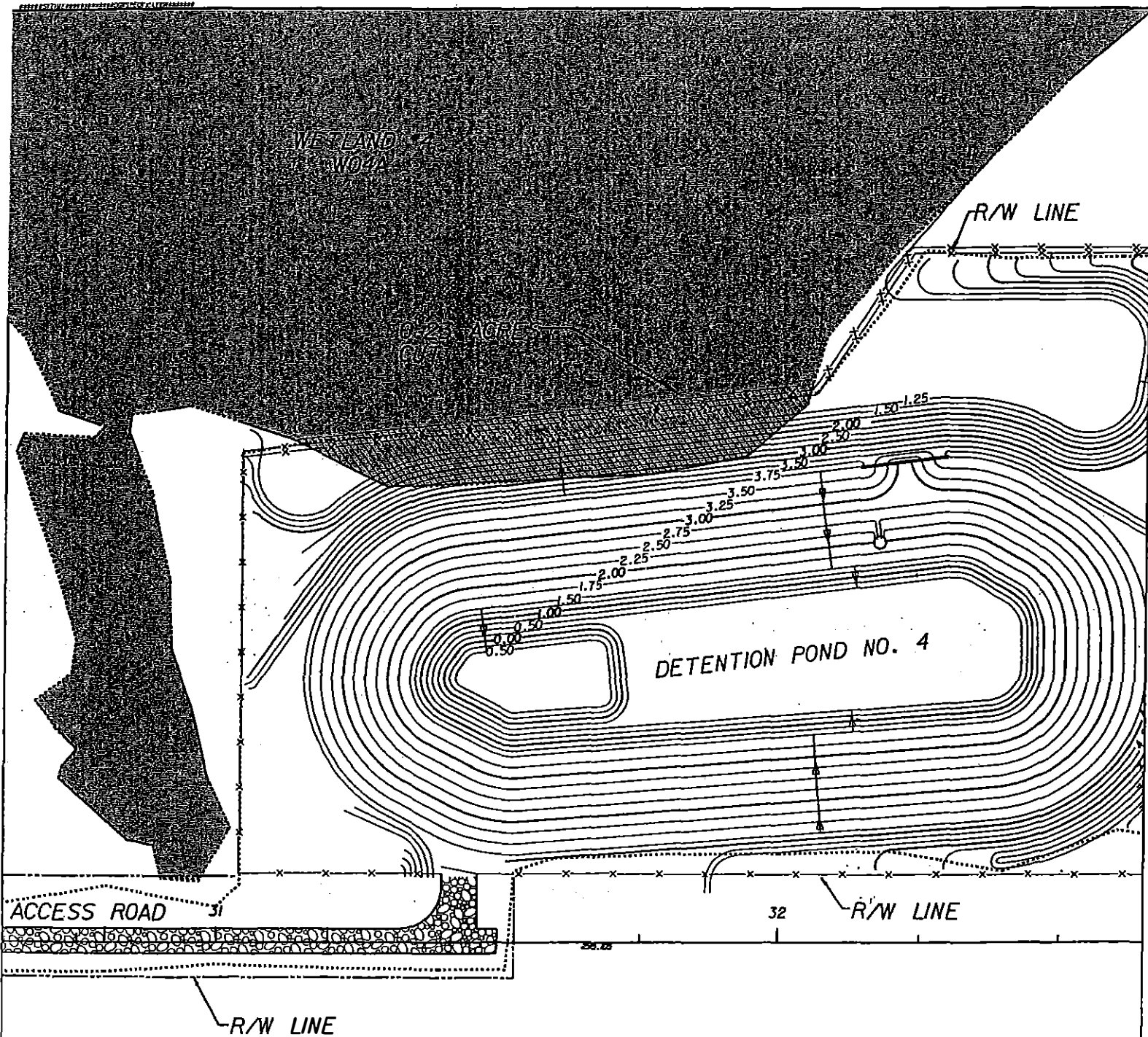

### Legend

- R/W Line ————
- Edge of Exist. Pavement ————
- Wetland Boundary [Stippled Pattern]
- Wetland Excavation [Diagonal Hatching]
- Wetland Fill [Cross-hatching]

Applicant: Florida Department of Transportation (FDOT)

Water Body: N/A

County: Santa Rosa

Datum: NVGD 29 (Metric Conversion)

Applicant: FDOT

File: 200002363 IP-CP

Date: 15 March 2002

Page 16 of 27



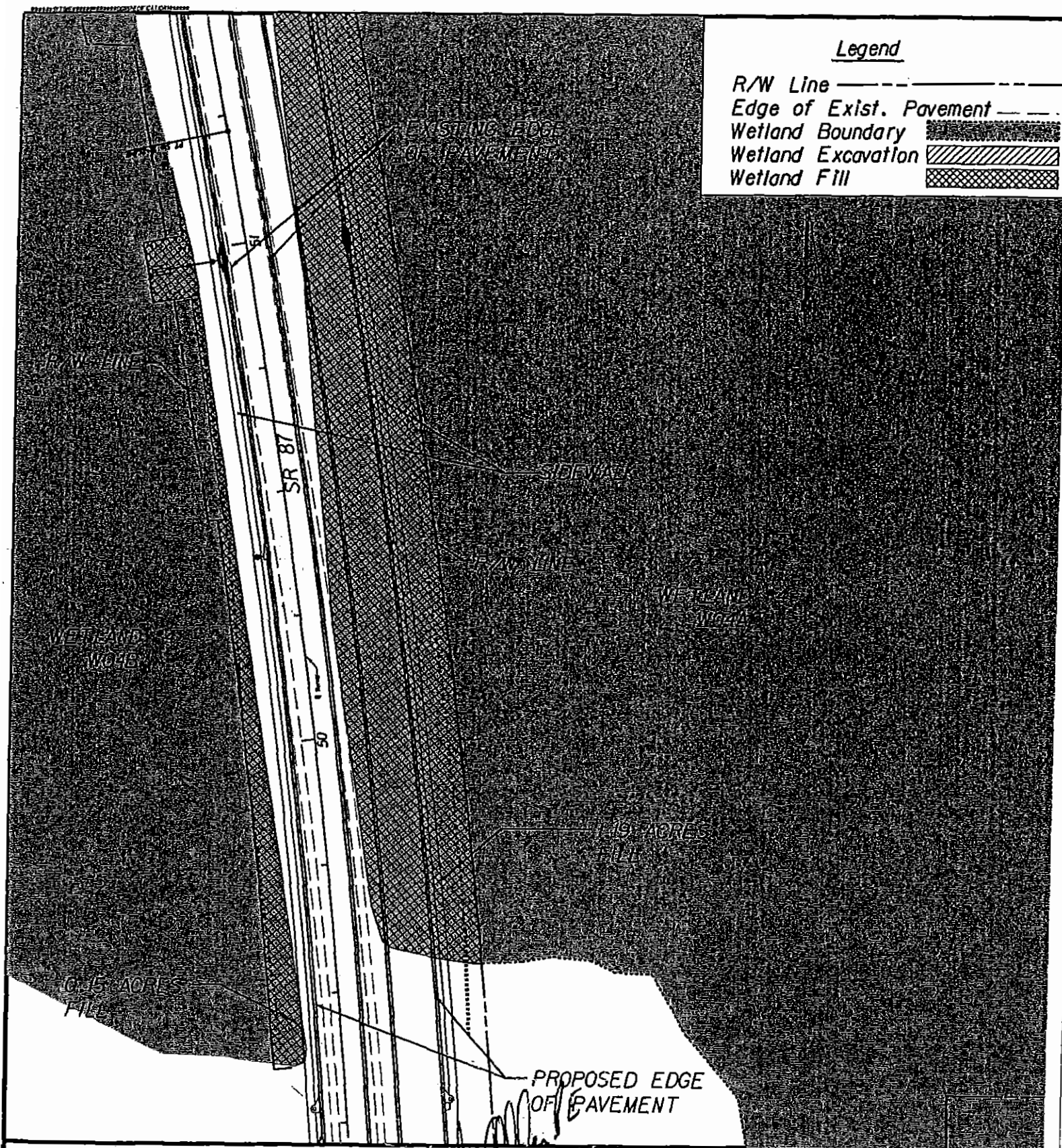



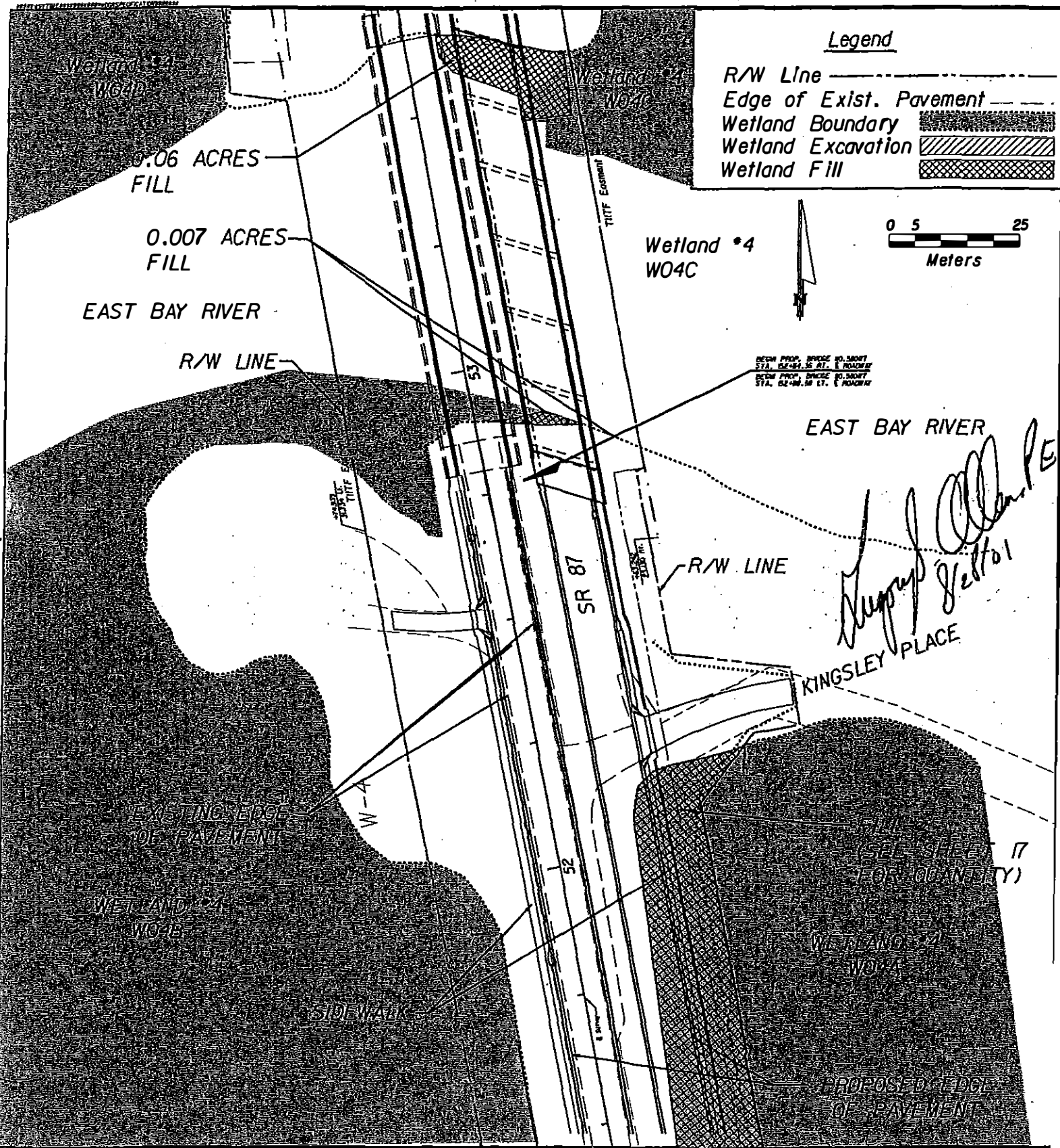

Applicant: Florida Department of Transportation (FDOT)

Water Body: N/A

County: Santa Rosa

Datum: NGVD 29 (Metric Conversion)

Applicant: FDOT

File: 200002363 IP-CP

Date: 15 March 2002

Page 18 of 27







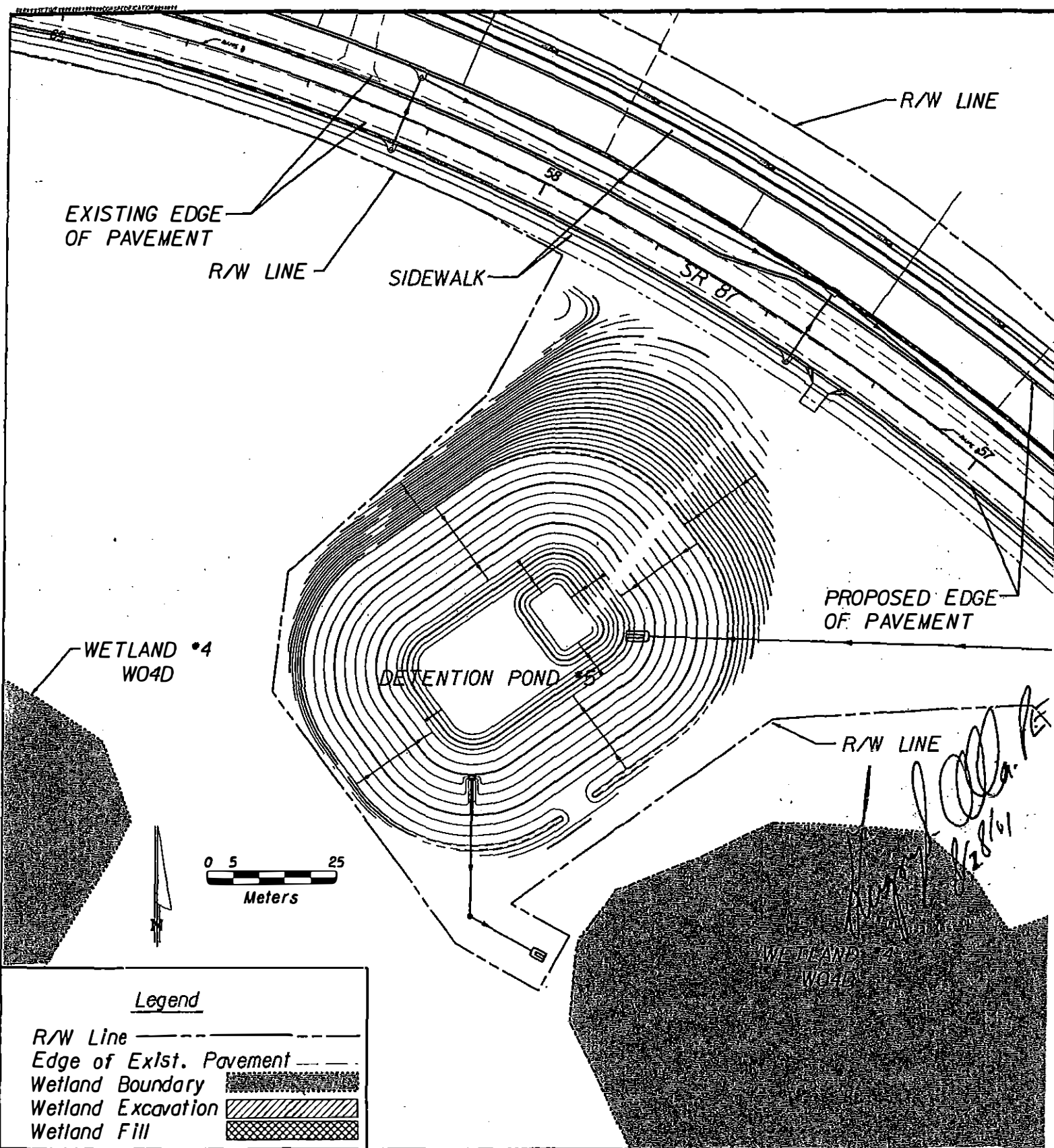



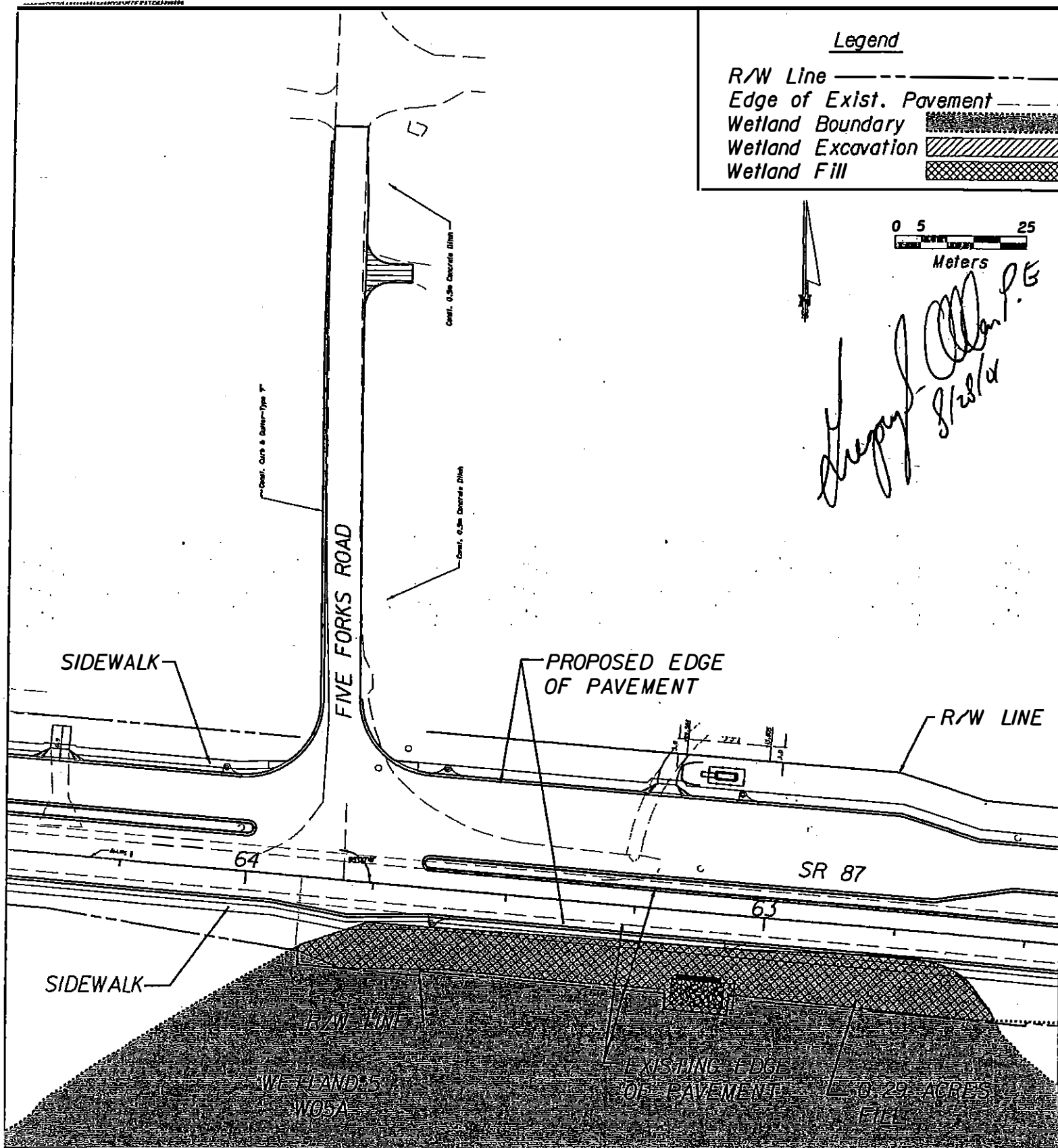

Applicant: Florida Department of Transportation (FDOT)

Water Body: N/A

County: Santa Rosa

Datum: NGVD 29 (Metric Conversion)

Applicant: FDOT

File: 200002363 IP-CP

Date: 15 March 2002

Page 21 of 27



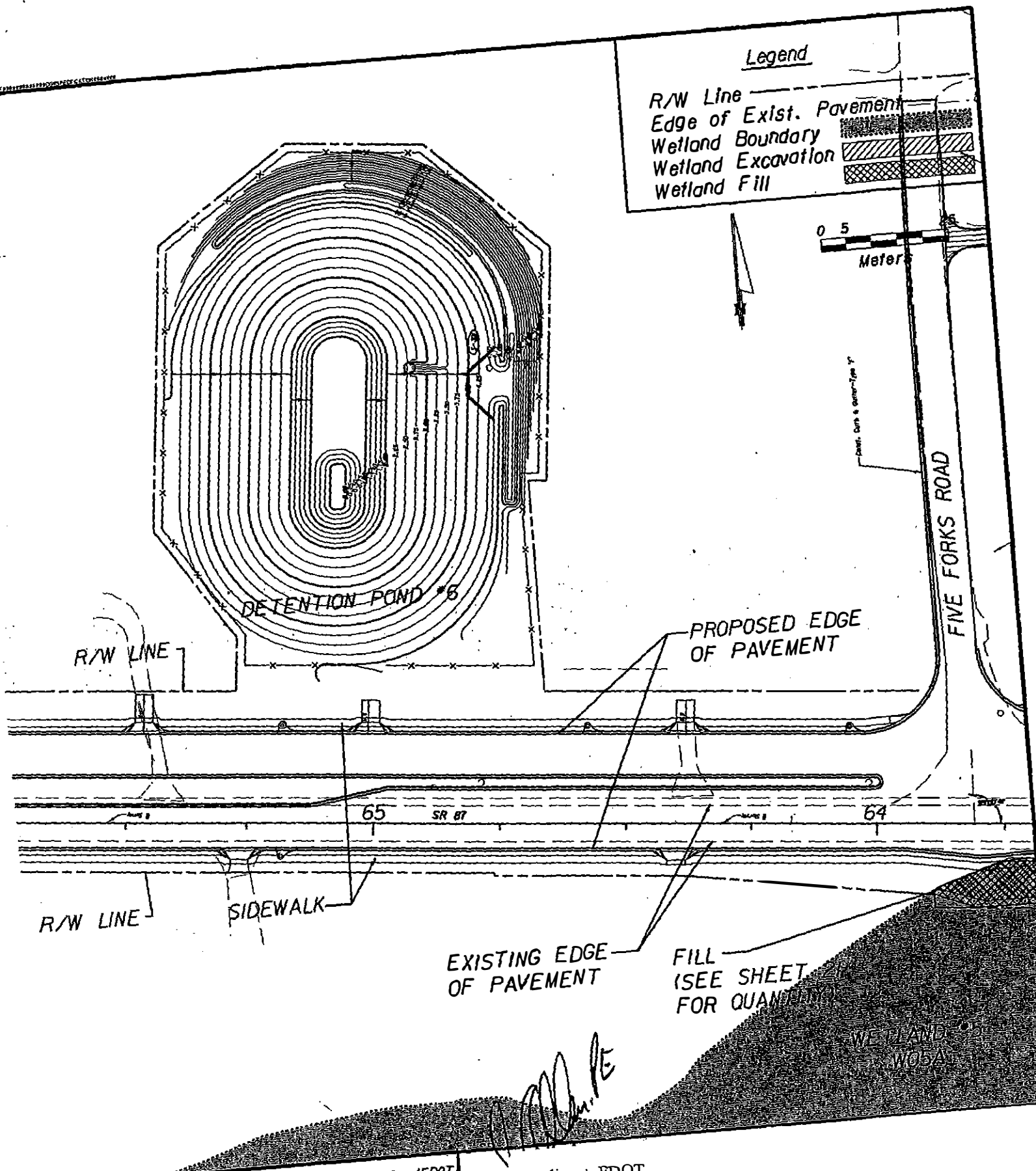

Applicant: Florida Department of Transportation (FDOT)  
 Water Body: N/A  
 County: Santa Rosa  
 Datum: NGVD 29 (Metric Conversion)

Applicant: FDOT  
 File: 200002363 IP-CP  
 Date: 15 March 2002  
 Page: 22 of 27



WPI 3118042

(SR 87 from US 98 north to CR 399; 5.68 acres of impact)

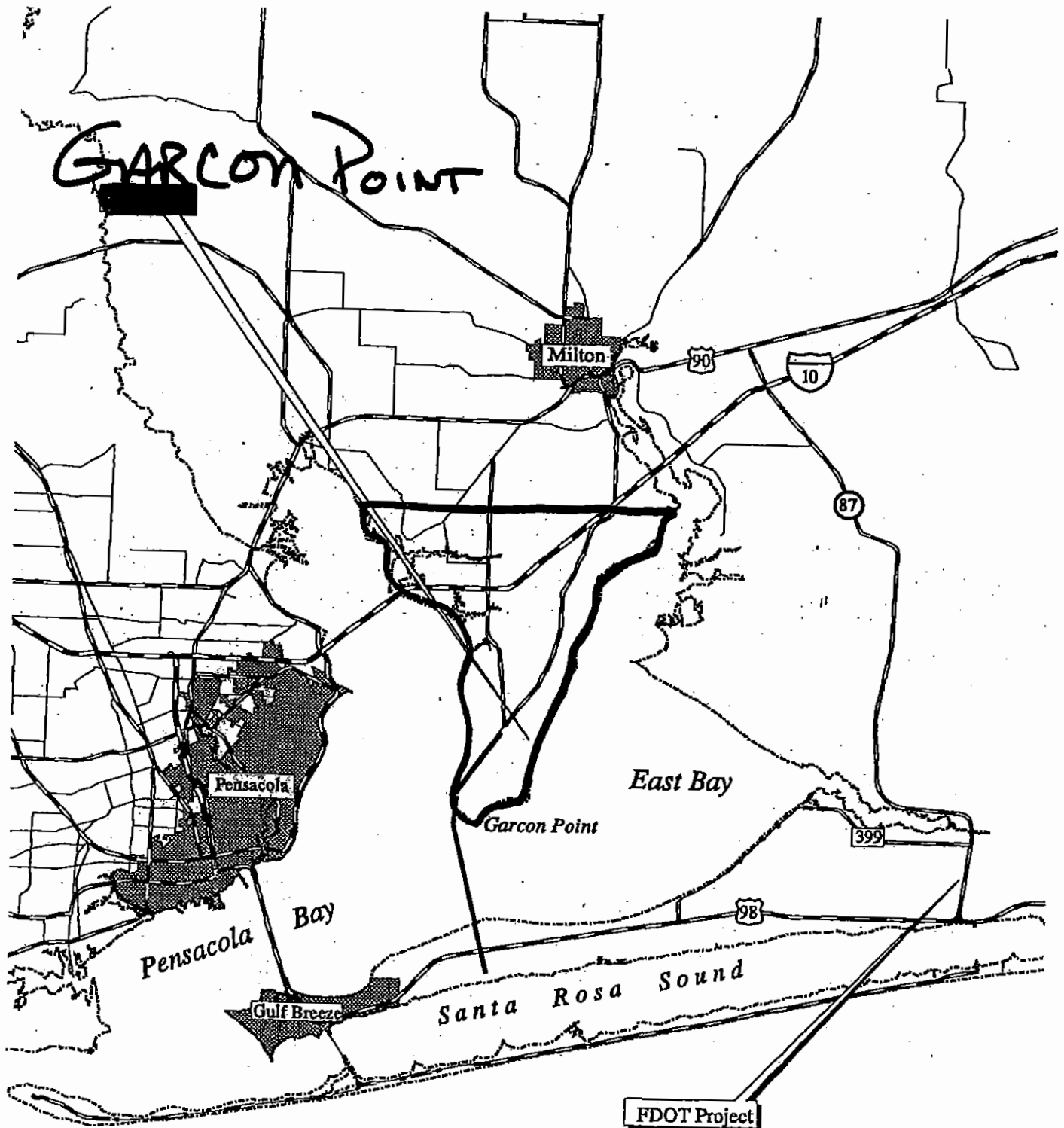

Applicant: FDOT  
File: 200002363 IP-CP  
Date: 15 March 2002  
Page 23 of 27



# Garcon Point Peninsula

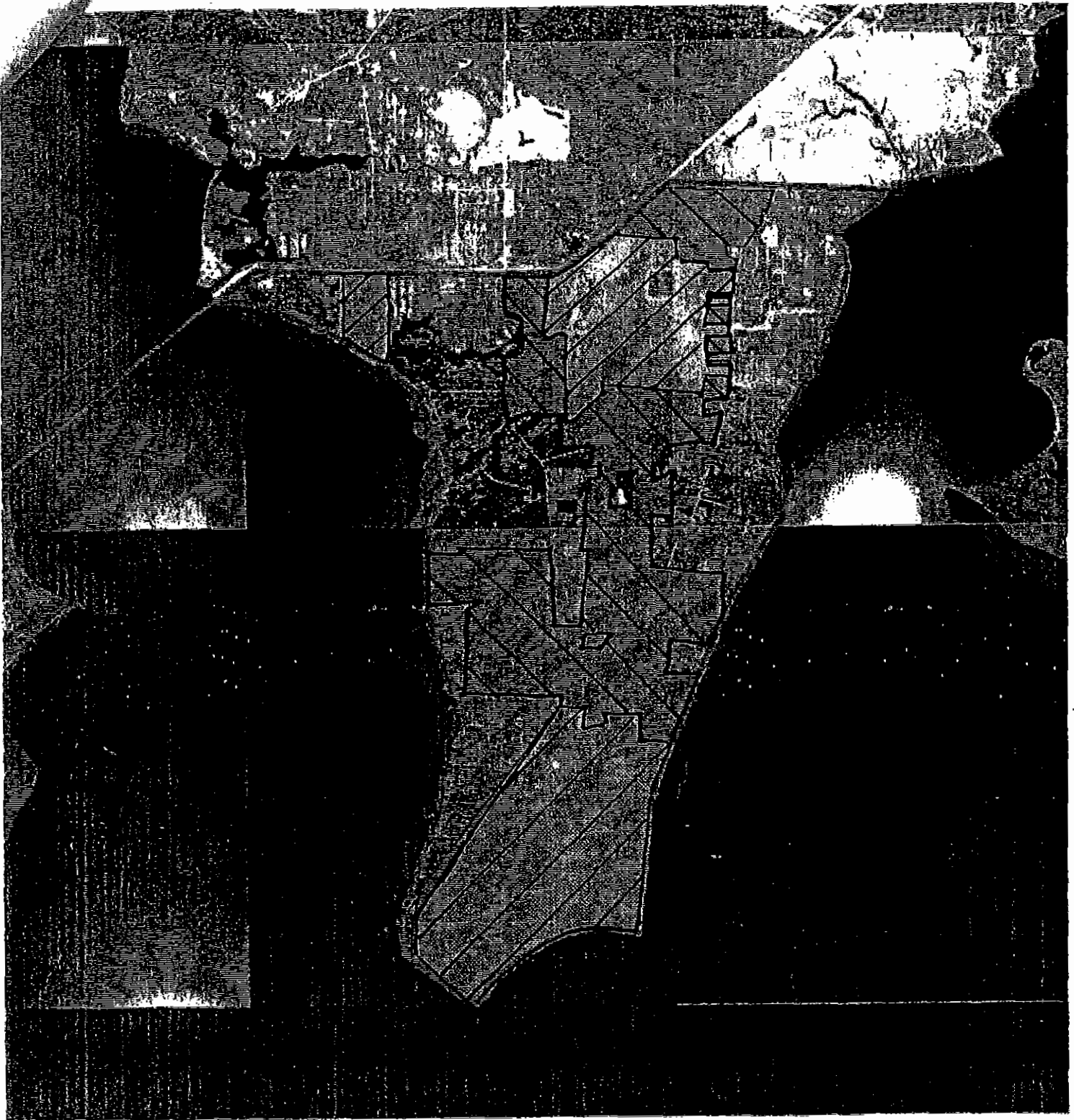

0 1 2 3 4 5 Miles



Garcon Point (ca. 12,000 acres)  
NFWMD Lands (3,225 acres)  
Targeted Acquisitions (4,053 acres)

Applicant: FDOT  
File: 200002363 IP-CP  
Date: 15 March 2002  
Page 24 of 27



The Yellow River has its headwaters in Alabama's Conecuh National Forest and it forms the northern border of Eglin Air Force Base across much of Santa Rosa and Okaloosa counties. The proposed purchase brings much of the remainder of the Yellow River floodplain in Florida under public ownership. Included in the project is a segment of the lower part of the Shoal River, the largest tributary to the Yellow. Three timber companies own a majority of the floodplain in this project, but considerable areas of the bordering and buffer lands must also be acquired to ensure effective management and the protection of water resources. To accomplish these objectives, acquisition of the bordering lands within the 100-year floodplain, along with an additional 50-foot upland buffer, will be required. The District anticipates working over a period of several years to acquire the buffers and the three primary properties. Highest priority will be given to acquiring tracts in the western portion of the project. Although the Yellow and Shoal rivers exhibit good overall water quality, both are fed largely by rainwater runoff and thus are highly susceptible to pollution from land use activities. Degradation in the Yellow River is known to occur primarily from the Florida line southward and has resulted in large part from construction activities and from timbering the slopes and other high runoff portions of the basin. This purchase will provide water quality protection from near the Alabama state line southward for some 33 miles. Purchase of the lands north of the Eglin ownership would bring nearly all of the river corridor under public protection. Wetlands throughout these basins provide habitat and refuge for a large number and variety of designated species, including the panhandle lily, sweet pitcher plant, yellow fringeless orchid, orange azalea, silky Camellia, Atlantic sturgeon, Florida pine snake, gopher tortoise, alligator snapping turtle, Eastern chipmunk, woodstork and several endemic varieties of mayflies. These rivers have been recognized as significant natural and recreational resources and have received designations as Outstanding Florida Waters and Recreational Canoe Trails.

## **MANAGEMENT POLICIES AND ACTIVITIES**

The Northwest Florida Water Management District has specific policies relating to the management and governance of its water management areas. The policies are comprehensive and are applied consistently to all designated areas managed by the District. Land management is a constant activity requiring many immediate decisions that are based on a familiarity with local conditions and the natural resources. Managers must have latitude to make those decisions effectively and to exercise professional judgment, but within the bounds of an established policy framework. These policies are intended to provide the general guidance needed for making daily management decisions. A detailed resource inventory and specific management plan will be developed for each water management area. When required, appropriate rules will be adopted to enforce the specific policies. The policies are subject to public review and comment. It is important to note, however, that these policies attempt to project procedures for managing the water management areas over time and changing circumstances. It may be necessary, therefore, for the Governing Board of the Water Management District to modify some of these provisions. In accomplishing this process, the District will provide notice of proposed changes and will give all interested parties an opportunity to comment.



## SPECIFIC MANAGEMENT ACTIVITIES

**Garcon Point Ecosystem** - Management activities in the Garcon Point Ecosystem Water Management Area include:

- establishment of boundary lines
- construction of parking lots to facilitate public access
- gate installation at parking lots and old road system to control access as necessary
- install signage for public information and outreach
- routine maintenance of road system and adjacent vegetation
- installation of wooden fencing around parking lots
- establishment of hiking trails
- installation of fire lines around boundary
- control burns in designated areas (2300+ acres burned 1999-2001 (2-7 year burn regime))
- evaluation of coast line restoration and potential vegetation donor sites
- cooperative research program with University of West Florida - Ground Cover Study of Fire in Wet Prairie Habitat

Sites acquired for mitigation purposes will be managed in a similar manner with emphasis on preserving the on-site wetlands in perpetuity.

~~**Yellow River/Shoal River Basin** - Management activities in the Yellow River/Shoal River Water Management Areas would be similar to those anticipated for any subsequent mitigation sites acquired in the Blackwater River Basin. These activities include:~~

- ~~- establishment and maintenance of boundary lines~~
- ~~- repair of parking lots to facilitate public access~~
- ~~- installation of picnic tables and grills in public access points~~
- ~~- installation of foot bridges for public access to certain areas~~
- ~~- repair of existing boat ramps for river access~~
- ~~- trash pickup program initiated~~
- ~~- gate installation at parking lots and road system to control access as necessary. Selected roads along river edge are restricted to "foot travel only"~~
- ~~- install signage for public information and outreach~~
- ~~- routine maintenance of road system and adjacent vegetation~~
- ~~- BMP implementation for woods road system (10 low water crossings and 11 culverts to facilitate hydrologic connections)~~
- ~~- installation of wooden fencing around parking lots~~
- ~~- establishment of hiking trails~~
- ~~- installation of fire lines around boundary~~
- ~~- control burns in designated areas (~35 acres burned 1999-2001 (2-7 year burn regime))~~
- ~~- replanting of pine in designated areas (~450 acres with 6 x 8 spacing/ 908 trees per acre)~~
- ~~- Longleaf Pine planting and regeneration (~200 acres)~~



## Conceptual Monitoring Plan

Post-acquisition monitoring will be conducted to ascertain the status and improvements to lands acquired for mitigation within the Garcon Peninsula and along the Yellow River and Blackwater River. The Northwest Florida Water Management District has substantial land ownership in these areas. It is anticipated that management and restoration of mitigation parcels and existing District lands will be conducted in a similar fashion. Parcels acquired within these areas would be primarily for preservation/enhancement and to institute long-term management plans to insure their environmental value. This type of mitigation generally does not warrant intensive monitoring of environmental conditions. Mitigation monitoring will likely be limited to photo-documentation of selected transects and evaluation of ongoing management activities.

[REDACTED]

[REDACTED] Intensive vegetation monitoring assessments will be conducted on an annual basis with more frequent monitoring protocols implemented in conjunction with specific management efforts.

Details of monitoring will depend upon site-specific conditions dictated by the particular parcels that are acquired. All specific monitoring plans will be forwarded to permitting personnel for concurrence as they are finalized. Factors that may affect the selection of monitoring strategies include the existing and targeted wetland communities, topography, hydrologic regime, and degree of disturbance. Potential monitoring methods are briefly described below.

Ground-based photography will be used to document natural changes in wetland vegetation caused by management/enhancement activities, or to document the success of re-vegetation efforts. Photography points would be established with permanent stakes (e.g., steel rebar, PVC pipe, etc.) and the coordinates determined through GPS. Information recorded with each photo would include date of photograph, direction of view, notes about species present, hydrologic conditions, and any stress or robustness evidenced by the vegetation. Aerial photography will be employed in applicable situations to obtain qualitative and quantitative information.

Permanent vegetation transects will be established where appropriate and where photo-documentation is not sufficient. Transects will typically pass through topographic, hydrologic, and/or vegetation gradients. A variety of transect protocol options (e.g., line-intercept, point-quarter sampling, etc.) are available. The length, spacing, and distance between sampling points along transects would be determined by site-specific conditions (typically 100 to 300 feet). Permanent vegetation quadrats (rectangular and/or circular) would be used where appropriate (e.g., to measure seedling recruitment and monitor changes in herbaceous vegetation coverage).





REPLY TO  
ATTENTION OF

DEPARTMENT OF THE ARMY  
JACKSONVILLE DISTRICT CORPS OF ENGINEERS  
PENSACOLA REGULATORY OFFICE  
41 North Jefferson Street, Suite 104  
PENSACOLA, FLORIDA 32501-5794

Regulatory Division  
North Permits Branch  
200002363 (IP-CP)

April 9, 2002

Florida Department of Transportation  
c/o Frank Roberts  
Post Office Box 607  
Chipley, Florida 32428

Dear Mr. Roberts:

We have completed the review of your permit application number Application 200002363. The proposal included the discharge of fill material over approximately 5.68 acres of wetland to allow the widening of State Road 87 from U.S. Highway 98 to Five Forks Road. Our regulations require that you have an opportunity to review any special or general conditions prior to final signature by the Department of the Army. Enclosed are an original and a copy of an unsigned Department of the Army permit instrument.

Both copies must be signed by the applicant in the space provided on the next to last page of the instrument. In the case of corporations, acceptance must be by an officer of that corporation. The party responsible for assuring the work is done in accordance with the permit terms and conditions must sign the permit. Please type or print the name and title of the person signing below the signature and the date signed.

Please read carefully the Special Conditions beginning on page 2 of the permit. These Special Conditions were developed to apply specifically for your project. Water Quality Certification is also required prior to issuance of a Department of the Army permit. A copy of your certification has been received. In accordance with General Condition number 5 of the permit, the Water Quality



Certification specific conditions become a part of the Department of the Army permit.

SIGN AND RETURN BOTH THE ORIGINAL AND THE COPY TO THIS OFFICE.

The original will be signed by the District Engineer and returned to you with a placard to be posted at the project site. It is important to note that the permit is not valid until it has been signed by the District Engineer.

You are hereby advised that the attached "Notification of Administrative Appeal Options and Process and Request For Appeal" identifies options available to you in your evaluation of the enclosed permit. Please be advised that this permit may contain special conditions required by your State of Florida water quality certification. These conditions are not subject to the appeal process.

Attached is a 2 page customer service survey form. If you have any comments on the service you have received during the evaluation of this application, please return the survey to us along with your signed permit instruments.

Sincerely,

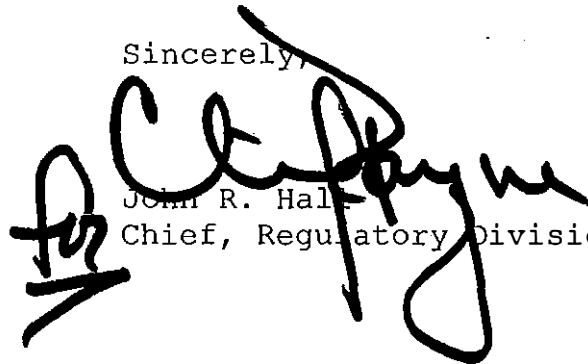
  
John R. Hale  
Chief, Regulatory Division

Enclosures



# NOTIFICATION OF ADMINISTRATIVE APPEAL OPTIONS AND PROGRESS AND REQUEST FOR APPEAL

Applicant:	File Number:	Date:
Attached is:		See Section below
INITIAL PROFFERED PERMIT (Standard Permit or Letter of permission)		A
PROFFERED PERMIT (Standard Permit or Letter of permission)		B
PERMIT DENIAL		C
APPROVED JURISDICTIONAL DETERMINATION		D
PRELIMINARY JURISDICTIONAL DETERMINATION		E

**SECTION I:** The following identifies your rights and options regarding an administrative appeal of the above decision. Additional information may be found at <http://usace.army.mil/aeel/functions/cw/aeewo/reg.or> or Corps regulations at 33 CFR Part 33.11.

**A: INITIAL PROFFERED PERMIT:** You may accept or object to the permit.

- **ACCEPT:** If you received a Standard Permit, you may sign the permit document and return it to the district engineer for final authorization. If you received a Letter of Permission (LOP), you may accept the LOP and your work is authorized. Your signature on the Standard Permit or acceptance of the LOP means that you accept the permit in its entirety, and waive all rights to appeal the permit, including its terms and conditions, and approved jurisdictional determinations associated with the permit.
- **OBJECT:** If you object to the permit (Standard or LOP) because of certain terms and conditions therein, you may request that the permit be modified accordingly. You must complete Section II of this form and return the form to the district engineer. Your objections must be received by the district engineer within 60 days of the date of this notice, or you will forfeit your right to appeal the permit in the future. Upon receipt of your letter, the district engineer will evaluate your objections and may: (a) modify the permit to address all of your concerns, (b) modify the permit to address some of your objections, or (c) not modify the permit having determined that the permit should be issued as previously written. After evaluating your objections, the district engineer will send you a proffered permit for your reconsideration, as indicated in Section B below.

**B: PROFFERED PERMIT:** You may accept or appeal the permit

- **ACCEPT:** If you received a Standard Permit, you may sign the permit document and return it to the district engineer for final authorization. If you received a Letter of Permission (LOP), you may accept the LOP and your work is authorized. Your signature on the Standard Permit or acceptance of the LOP means that you accept the permit in its entirety, and waive all rights to appeal the permit, including its terms and conditions, and approved jurisdictional determinations associated with the permit.
- **APPEAL:** If you choose to decline the proffered permit (Standard or LOP) because of certain terms and conditions therein, you may appeal the declined permit under the Corps of Engineers Administrative Appeal Process by completing Section II of this form and sending the form to the division engineer. This form must be received by the division engineer within 60 days of the date of this notice.

**C: PERMIT DENIAL:** You may appeal the denial of a permit under the Corps of Engineers Administrative Appeal Process by completing Section II of this form and sending the form to the division engineer. This form must be received by the division engineer within 60 days of the date of this notice.

**D: APPROVED JURISDICTIONAL DETERMINATION:** You may accept or appeal the approved JD or provide new information.

- **ACCEPT:** You do not need to notify the Corps to accept an approved JD. Failure to notify the Corps within 60 days of the date of this notice, means that you accept the approved JD in its entirety, and waive all rights to appeal the approved JD.
- **APPEAL:** If you disagree with the approved JD, you may appeal the approved JD under the Corps of Engineers Administrative Appeal Process by completing Section II of this form and sending the form to the division engineer. This form must be received by the division engineer within 60 days of the date of this notice.

**E: PRELIMINARY JURISDICTIONAL DETERMINATION:** You do not need to respond to the Corps regarding the preliminary JD. The Preliminary JD is not appealable. If you wish, you may request an approved JD (which may be appealed), by contacting the Corps district for further instruction. Also you may provide new information for further consideration by the Corps to reevaluate the JD.



**SECTION II REQUEST FOR APPEAL & OBJECTIONS TO AN INITIAL PROFFERED PERMIT**

**REASONS FOR APPEAL OR OBJECTIONS:** (Describe your reasons for appealing the decision or your objections to an initial proffered permit in clear concise statements. You may attach additional information to this form to clarify where your reasons or objections are addressed in the administrative record.)

**ADDITIONAL INFORMATION:** The appeal is limited to a review of the administrative record, the Corps memorandum for the record of the appeal conference or meeting, and any supplemental information that the review officer has determined is needed to clarify the administrative record. Neither the appellant nor the Corps may add new information or analyses to the record. However, you may provide additional information to clarify the location of information that is already in the administrative record.

**POINT OF CONTACT FOR QUESTIONS OR INFORMATION**

If you have questions regarding this decision and/or the appeal process you may contact:  
Pensacola Regulatory Office  
41 North Jefferson Street Suite 104  
Pensacola, Florida 32501

If you only have questions regarding the appeal process you may also contact:  
US Army Corps of Engineers  
Regulatory Division  
Post Office Box 4970  
Jacksonville, Florida 32501

**RIGHT OF ENTRY:** Your signature below grants the right of entry to Corps of Engineers personnel, and any government consultants, to conduct investigations of the project site during the course of the appeal process. You will be provided a 15 day notice of any site investigation, and will have the opportunity to participate in all site investigations.



<div data-bbox="69 136 574 184" data-label="Text"><p>Signature of appellant or agent.</p></div>	<div data-bbox="797 69 878 107" data-label="Text"><p>Date:</p></div>	<div data-bbox="1159 69 1425 111" data-label="Text"><p>Telephone number:</p></div>
---	--	--



PLEASE COMPLETE THE FOLLOWING QUESTIONS BY GIVING US  
ANY COMMENTS OR SUGGESTIONS FOR HOW WE CAN IMPROVE.

Please indicate the nature of your business (if applicable, check more than one):

- |   |   |  |
|---|---|--|
| <input type="checkbox"/> Property developer           | <input type="checkbox"/> Flood/Water Control District | <input type="checkbox"/> Sand & Gravel   |
| <input type="checkbox"/> Public Agency Applicant      | <input type="checkbox"/> Consultant                   | <input type="checkbox"/> Law Office      |
| <input type="checkbox"/> Civic or Trade Organization  | <input type="checkbox"/> Farming/Ranching             | <input type="checkbox"/> Silviculture    |
| <input type="checkbox"/> Member of Legislature        | <input type="checkbox"/> Public Agency                | <input type="checkbox"/> Mining          |
| <input type="checkbox"/> Federal/State/Local Official | <input type="checkbox"/> Personal/Private Project     | <input type="checkbox"/> Media           |
| <input type="checkbox"/> Conservation Organization    | <input type="checkbox"/> Adjacent Property Owner      | <input type="checkbox"/> Native American |
| <input type="checkbox"/> Other (describe): _____      |   |  |

What Service(s) Did You Seek From the Corps? (If applicable, check more than one):

- |  |  |
|--|--|
| <input type="checkbox"/> General Information                     | <input type="checkbox"/> Jurisdictional/wetland determination          |
| <input type="checkbox"/> Pre-application Consultation            | <input type="checkbox"/> Resolution of violation/non-compliance        |
| <input type="checkbox"/> Nationwide general permit               | <input type="checkbox"/> Regulatory Program presentation               |
| <input type="checkbox"/> Regional or programmatic general permit | <input type="checkbox"/> Commented on Public Notice/permit application |
| <input type="checkbox"/> Standard Individual permit              | <input type="checkbox"/> Other (describe): _____                       |
| <input type="checkbox"/> Letter of Permission                    | _____  |

Which Corps office (District, Division, Headquarters, other) did you deal with? \_\_\_\_\_

Name of person you contacted in our office (optional): \_\_\_\_\_

Do you have any comments or suggestions on the Regulatory Program?

Information about you (optional):

Name/Title: \_\_\_\_\_

Address: \_\_\_\_\_  
\_\_\_\_\_  
\_\_\_\_\_

Telephone (include area code): \_\_\_\_\_

May we contact you?

YES ☐

NO ☐

PRIVACY ACT STATEMENT

Authorities: The government Performance and Results Act of 1993 and Executive Order (EO) 12862, "Setting Customer Service Standards", dated September 11, 1993. Purpose: To determine the quality of services our customers expect, as well as their satisfaction with USACE's existing services. Information provided on this form will be used in evaluating the performance of the Corps Regulatory Program. Routine Uses: This information may be shared with the Office of Management and Budget, members of Congress, and other federal, state, and local government



The Public reporting burden for this collection of information is estimated to average 15 minutes per response, including time for reviewing instructions, searching existing data sources, gathering and maintaining the data needed, and completing and reviewing the collection of information. Send comments regarding this burden estimate or any other aspect of this collection of information, including suggestions for reducing this burden, to Department of Defense, Washington Headquarters Services, Directorate for Information Operations and Reports (0710-0012), 1215 Jefferson Davis Highway, Suite 1204, Arlington, VA 22202-4302. Respondents should be aware that notwithstanding any other provision of law, no person shall be subject to any penalty for failing to comply with a collection of information if it does not display a currently valid OMB control number. PLEASE DO NOT RETURN YOUR APPLICATION TO THE ABOVE ADDRESS. RETURN COMPLETED APPLICATION TO THE ADDRESS SHOWN ON THE APPLICATION INSTRUCTIONSHEET.

**U.S. ARMY CORPS OF ENGINEERS  
 CUSTOMER SERVICE SURVEY - REGULATORY PROGRAM**

We at the U.S. Army Corps of Engineers Regulatory Branch are committed to improving service to our customers and would like to know how well we have been doing. Who are our customers? You are our customers if you submitted a permit application, requested a jurisdictional determination or wetland delineation, or scheduled a pre-application meeting with us. Other customers include those of you who receive our Public Notice and/or commented on a particular project or our work in general, because of your interest in the Regulatory Program. To identify how we can better serve you, we need your help. Please take the time to fill out this brief survey and mail it back to us. Your honest opinions will help us determine areas in which we need to improve. For each question, please indicate the level of service you received by marking the appropriate number on a scale from 1-5, with 1 being low (dissatisfied) and 5 being high (very satisfied). If the question does not apply to you, simply mark N/A. Thank you for your time and comments! Response to this survey is VOLUNTARY. If you choose not to respond, it will not affect any current or future dealings you may have with the USACE in any

I. FOR APPLICANTS & OTHERS REQUIRING AUTHORIZATIONS	LOW SATISFACTION			HIGH SATISFACTION		
	1	2	3	4	5	NA
1. Do you think you received your Corps permit decision in a reasonable amount of time?						
2. Do you think you received your Corps jurisdictional determination in a reasonable amount of time?						
3. If we recommended/required project changes/modifications to reduce impacts, did we clearly explain the reasons why?						
4. If we recommended/required project changes/modifications to reduce impacts, did the changes seem reasonable to you?						
5. If we denied your permit, did we clearly explain the reasons why?						
6. For enforcement cases, did our office clearly and professionally explain the basis for the enforcement action (e.g., what work we believe you performed without authorization)?						
7. For enforcement cases, did our office include options for resolution?						
II. FOR "OTHER" CUSTOMERS						
1. For permitted actions, was the permit effective in achieving appropriate protection/mitigation for impacts to aquatic resources?						
2. For enforcement actions, did the Corps require appropriate compensation/restoration for impacts to aquatic resources?						
III. FOR APPLICANTS & "OTHER" CUSTOMERS						
1. Did the Corps representative act professionally and treat you with courtesy?						
2. Did the Corps provide sufficient information to allow you to complete an application form, comment on a public notice, or otherwise evaluate our work?						
3. Did we respond to your letters and telephone calls in a reasonable amount of time?						
4. Did the Corps representative answer your questions clearly, giving you accurate information about our Regulatory Program?						
5. What is your OVERALL rating of the level of service provided by the Corps of Engineers Regulatory Program?						

Note: DATA FROM THIS QUESTIONNAIRE WILL BE USED BY THE DISTRICT TO IMPROVE SERVICE. ALSO, INFORMATION WILL BE TABULATED NATIONALLY BY SERVICE AREA. RESPONDENTS WILL NOT BE IDENTIFIED BY NAME OR ORGANIZATION FOR ANY REPORT DERIVED FROM THIS SURVEY.