



Douglas E. Barr
Executive Director

Northwest Florida Water Management District

81 Water Management Drive, Havana, Florida 32333-4712

(U.S. Highway 90, 10 miles east of Tallahassee)

(850) 539-5999 • (Fax) 539-2777

June 19, 2007

U.S. Army Corps of Engineers
Enforcement Branch
Post Office Box 4970
Jacksonville, FL 32232-0019

Re: Semi-annual Report (Progress Report 4)

Dear Sir or Madam,

Please accept this submittal as the semi-annual progress report for the SHLMB.

Please provide a brief description of permit requirements met and extent of work completed the previous report or since the permit was issued:

1. The SHLMB opened for limited opportunity fishing on 5/18/2007. Fishing has been allowed only on selected lakes due to the low water levels. These include Dry Pond, Black Lake and Deep Edge Pond. There were a total of 40 anglers over the first four days (12 Friday, 6 Saturday, 9 Sunday and 13 Monday). Anglers caught a total of 65 bass and 143 bluegill with 100 bluegill taken. Boats are expected to arrive within the next two weeks; however no boats will be placed on Deep Edge pond to reduce potential impacts.
2. A Gyro-track has been used in the wet flatwoods area to reduce the shrub layer (Figure 1). Shrub reduction was initiated in February of 2007 and is expected to be completed by August of 2007. To date approximately 82.5 acres have had shrubs removed. An additional 58 acres will be gyro-tracked by August of 2007.
3. Construction on three bridges and two culverts was completed in early April of 2007 (Figure 10, Typical Bridge Design Sheet 2 of 7, and Typical Culvert Installation Sheet 4 of 7). All construction was completed in compliance with permit drawings. Permit and as-built drawings have been included for your review (Appendix 1). Photos included in Appendix 2.
4. The remediation of erosion areas #6 occurred as part of erosion control in summer of 2006 (Figure 9). Remediation of three road-fill crossings and remaining 9 erosion areas was initiated January, 2007 and completed in March of 2007 (Figure 9 and 10 and Typical Road Cut Sheet 3 of 7). Silt fences and turbidity barriers were installed and maintained. Following earth moving annual rye grass was planted. Erosion areas were planted within 30 days in accordance with the planting plan (Attachment D). Wire grass was planted on 3' centers.

GEORGE ROBERTS
Chair
Panama City

PHILIP K. McMILLAN
Vice Chair
Blountstown

SHARON PINKERTON
Secretary/Treasurer
Pensacola

PETER ANTONACCI
Tallahassee

STEPHANIE BLOYD
Panama City Beach

SHARON L. GASKIN
Wewahatchee

STEVE GHAZVINI
Tallahassee

TIM NORRIS
Santa Rosa Beach

JERRY PATE
Pensacola

Cypress trees were planted in the wetlands while long leaf pines were planted in the uplands at a rate of 300 trees per acre. However, due to the drought, most of the planted material has since died.

5. Surveys for feral hogs and beavers continued through the winter and spring at the SHLMB. No hog or beaver damage has been observed. However a small feral hog was observed in April of 2007 near Black Pond.
6. During the winter and spring site inspections no nuisance species have been observed. Areas where torpedo grass has been previously observed were evaluated. These areas have been bone dry for over 6 months and no viable torpedo grass has been observed.
7. In accordance with Specific Condition 8, security and law enforcement continued at the bank throughout the winter and spring. No violations were observed on the bank.
8. Several winter burns were attempted in 2007. However, due to the drought, low humidity and higher winds than anticipated. Several of the planned burns were postponed due to the danger of wildfire. Completed, attempted or postponed winter burns are shown in Figure 11.
9. Monthly site inspections were conducted for the SHLMB from December through April (Appendix 3).

Restoration activities anticipated within the next 6 months:

1. Oak trees will be thinned in approximately 6 acres surrounding Cat Pond and 18 acres adjacent to Little Deep Edge (Figure 12). These two areas contain high quality sand hill community that has been degraded by dense oak stands. Thinning of oaks within these areas should improve the quality of the sand hill habitat.
2. Continued surveys for feral hogs will continue during the summer at the SHLMB.
3. Anticipated summer burns have been suspended due to the prolonged drought and extreme potential for wildfire. If conditions change the summer burn plan will be re-implemented.
4. The harvesting of sand pine stands and thinning of planted slash pines should begin in June of 2007.
5. Design of the dam at Black Pond has been nearly completed. Construction of the dam should occur in July or August.
6. Gyro-tracking in the wet pine flatwoods will continue over the next several months.
7. Materials for the boat ramp at Dry Pond have been ordered and the boat ramp should be installed by August of 2007.

Please provide copies of the permit drawings indicating areas where work has been completed:

Copies of permit drawings and associated maps are included: Figure 9 and 10, Typical Bridge Design Sheet 2 of 7, Typical Road Cut Sheet 3 of 7, Typical Culvert Installation Sheet 4 of 7 and Appendix 1.

Please provide a brief description of problems encountered and solutions undertaken:

-An intense winter burn occurred adjacent to Greenhead Branch in Management Unit 12. Nearly all of the planted long leaf pine seedlings were destroyed. The site will be evaluated this fall for survivorship of long leaf pine. The area will be re-planted during the winter of 2007 if few to no long leaf pine trees survived.

-Scattered Bahia grass seedlings have been observed within the erosion stabilization areas #1, #2, #3 and #10. Orange Hill Soil and Water Conservation District inadvertently applied mulch contaminated with Bahia grass seed to the sites listed above. Orange Hill has agreed to herbicide all Bahia grass within these areas using hand sprayers and appropriate chemicals as well as re-plant any damaged plant material.

-Due to the drought, the majority of the planted material in the erosion areas, bridge embankments and road fill removal areas has died. These areas will be re-planted next year in accordance with the planting plan. However, in order to prevent erosion when the summer rains finally begin, the areas will be seeded native grasses or a mixture of native upland meadow species.

Thank you for your consideration of this submittal. If you have any question or comments please feel free to contact me at 850-539-5999.

Sincerely,

David Clayton
QMS

Enclosures:

- Figure 1 – Brush Reduction Polygons (Gyro-Track)
- Figure 9 – Erosion Stabilization Sites (From Permit)
- Figure 10 – Structures (From Permit)
- Figure 11 – Winter Burns at the SHLMB
- Figure 12 – 2007 Oak Reduction: Adjacent to Little Deep Edge and Cat Pond
- Typical Bridge Design (From Permit)
- Typical Road Cut (From Permit)
- Typical Culvert Installation (From Permit)

- Appendix 1: As-built drawings for Bridge and Culvert Construction
- Appendix 2: Photos of Bridge and Culvert Construction
- Appendix 3: Copies of Monthly Site Inspection

Appendix 1: As-build drawings for Bridge and Culvert Construction

AS-BUILT

GRAPHIC SCALE

(IN FEET)
1" = 20'

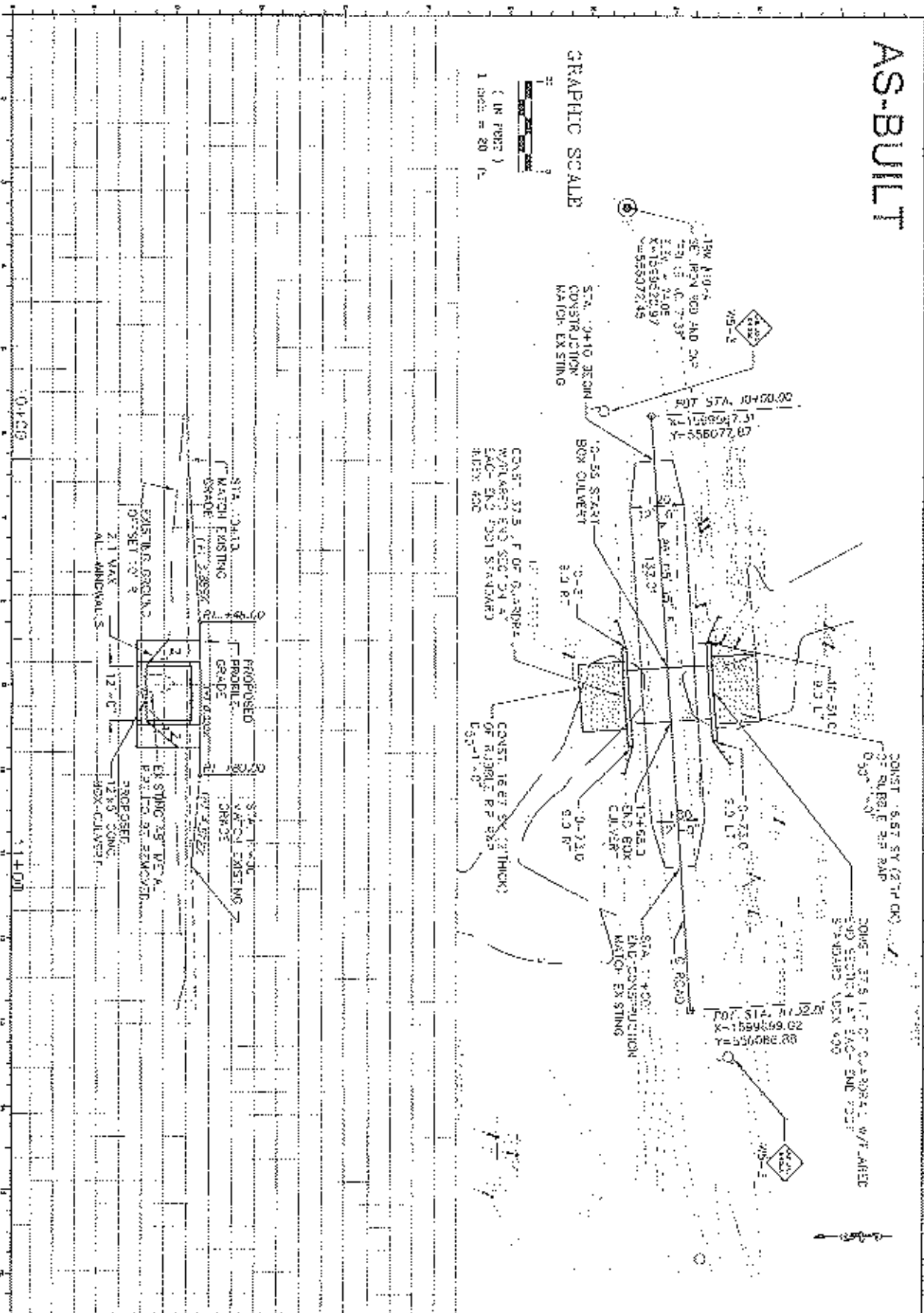

C1-2	NORTHWEST FLORIDA WATER MANAGEMENT DISTRICT PLAN AND ELEVATION JOYNER LAKE/GREEN PONDS CHANNEL SAND HILL LAKES MITIGATION BANK	DATE: 1/15/07 DRAWN: J. SUGEL CHECKED: C. CARLOS DESIGNED: J. BEBIE	ORIGINAL QUANTITY TOTAL REMAINING	PRICE TOTAL REMAINING	TOTAL REMAINING
		APPROVED FOR CONSTRUCTION DATE: 1/15/07 BY: [Signature]	APPROVED FOR CONSTRUCTION DATE: 1/15/07 BY: [Signature]	APPROVED FOR CONSTRUCTION DATE: 1/15/07 BY: [Signature]	APPROVED FOR CONSTRUCTION DATE: 1/15/07 BY: [Signature]

CARTER TRACT
 NORTHWEST FLORIDA WATER
 MANAGEMENT DISTRICT
 WASHINGTON COUNTY, FLORIDA

AS-BUILT

CURVE DATA (2007):
 PI STA = 20+25.85
 DELTA = 15 38' 07" (90°)
 D = 25 56'
 T = 25 56'
 L = 58.59'
 R = 230.00'

PO STA = 20+00.00
 PT STA = 20+50.28
 STA 20+00
 BEG. CONSTRUCTION
 MATO EXISTING

(BA 13+0
 ST. HOV 300 AND OVER
 20' LE. NO. 7137
 C.S.N. = 75.05
 X = 1546221.02
 Y = 557409.45

GRAPHIC SCALE
 (IN FEET)
 1 inch = 20 ft.

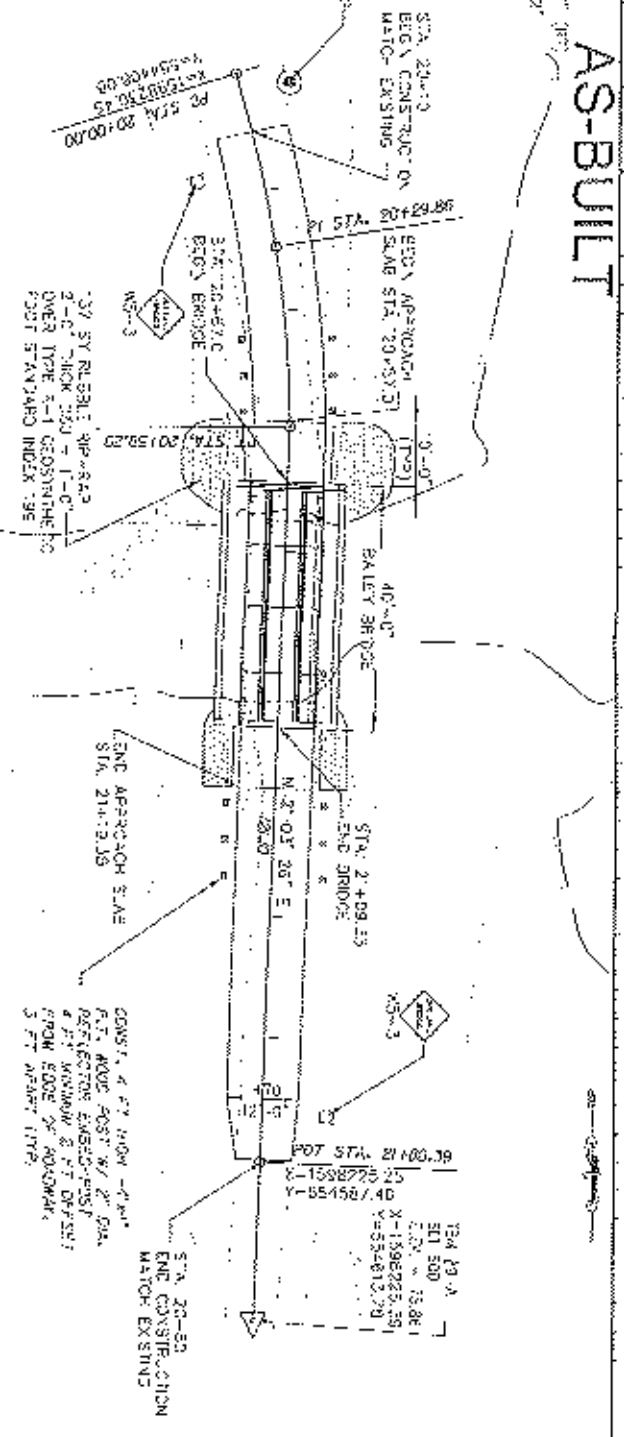

3/7 SY. REBAR: 9# 4'S, 2-# 6" THICK CURB - 1'-0" OVER TYPE 1-1 GEOMETRIC TO CDDT STANDARD INDEX .95

CONSTR. 4 FT. HOV - 6" R.F.T. HOV FOOT W/ 2" DIA. REINFORCING EMBED. 4 FT. MINIMUM 3 FT. DEPTH FROM EDGE OF ROADWAY 3 FT. MINIMUM TYPE

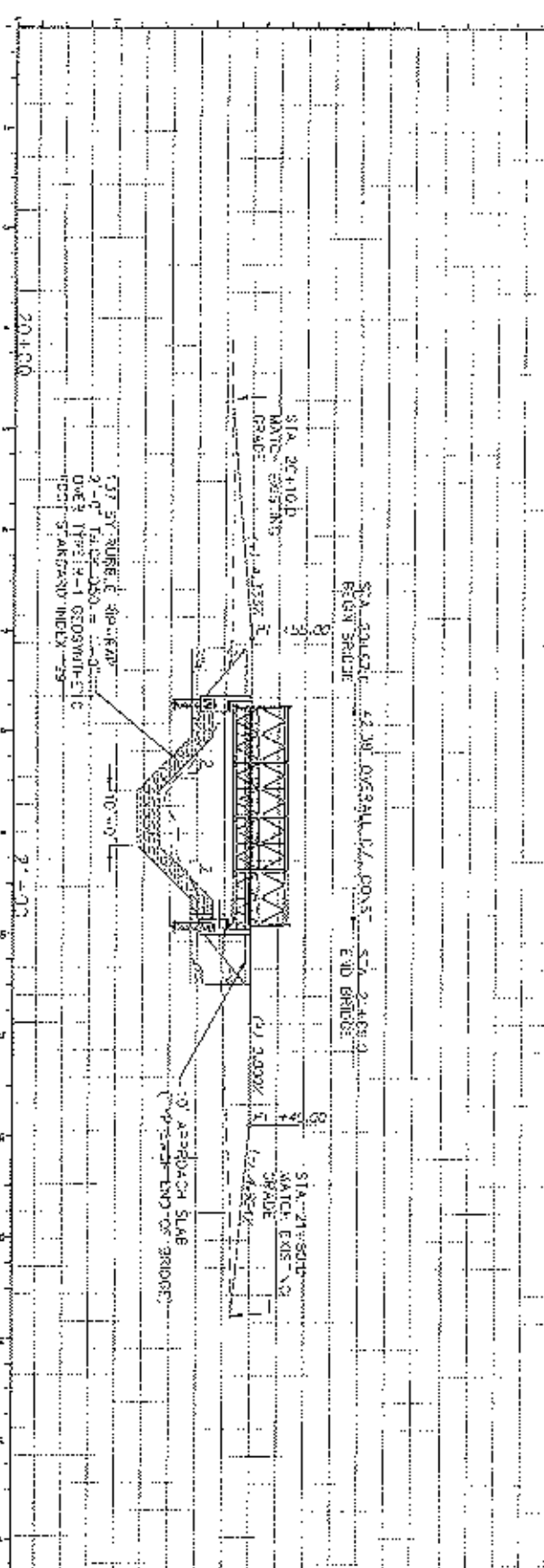

CR2-2 NORTHWEST FLORIDA WATER MANAGEMENT DISTRICT PLAN AND ELEVATION JOHNER LAKE CANAL SAND HILL LAKES MITIGATION BANK	DATE: 08/14/07 DRAWN BY: J. SLIGER CHECKED BY: J. CAMPOS REVISION: 4 REGISSE	SHEET: 94A107 OF: 100	DATE: 08/14/07 TIME: 10:00 AM	DATE: 08/14/07 TIME: 10:00 AM
			DATE: 08/14/07 TIME: 10:00 AM	DATE: 08/14/07 TIME: 10:00 AM

NORTHWEST FLORIDA WATER MANAGEMENT DISTRICT
 WASHINGTON COUNTY, FLORIDA

AS-BUILT

78-45-3
 SET BACK 800 AND 500
 W/ 3' HO. 7'-37"
 ELEV. 4.7531
 X=155447.17
 Y=552122.51

PUT STA. 30+100.00
 X=155447.878
 Y=552122.11

CONST. 30' ± OF OUBERDAM
 W/ ALPHED END SECTION AT EACH
 END FCOS STANDARD INDEX 200

CONST. 76.0' ± X 12'-THICK
 OF REEFLE SIP R&D
 50'-1'-0"

78-45-4
 SET BACK 500 AND 500
 W/ 3' HO. 7'-37"
 ELEV. 4.7523
 X=155447.15
 Y=552122.86

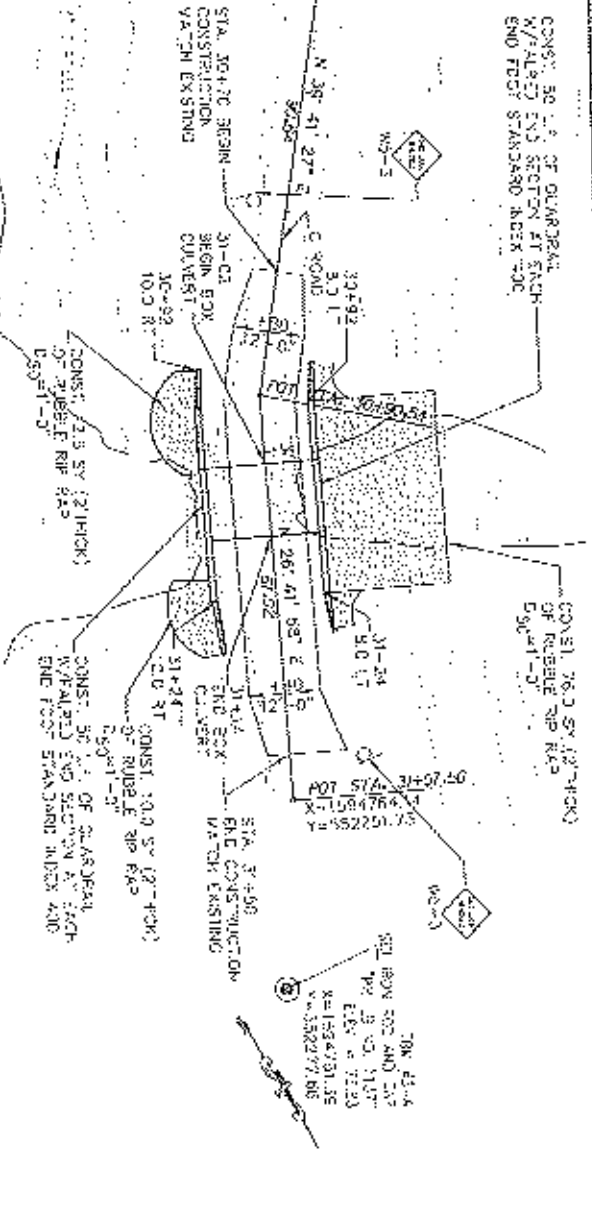

GRAPHIC SCALE

1" = 50 FEET
 1" = 50 FT

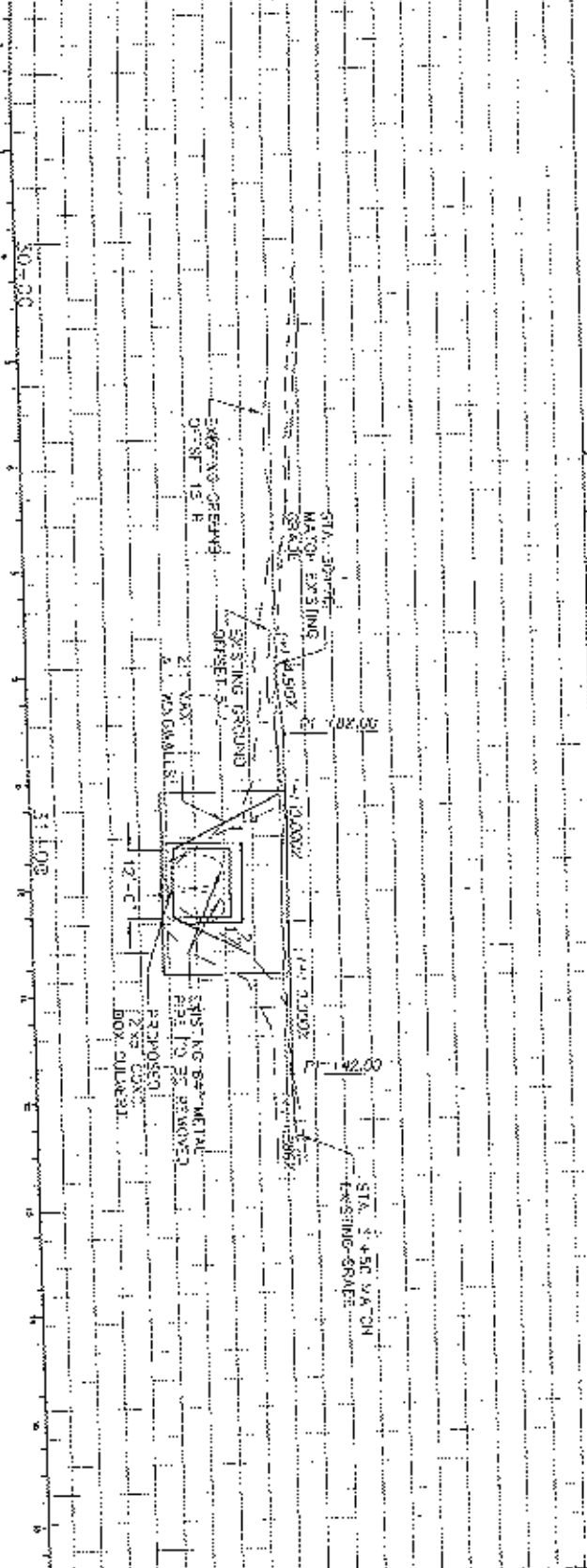

NORTHWEST FLORIDA WATER MANAGEMENT DISTRICT PLAN AND ELEVATION POWER LINE POND SAND HILL LAKES MITIGATION BANK	78-45-3 78-45-4 78-45-5 78-45-6 78-45-7 78-45-8 78-45-9 78-45-10 78-45-11 78-45-12 78-45-13 78-45-14 78-45-15 78-45-16 78-45-17 78-45-18 78-45-19 78-45-20	78-45-3 78-45-4 78-45-5 78-45-6 78-45-7 78-45-8 78-45-9 78-45-10 78-45-11 78-45-12 78-45-13 78-45-14 78-45-15 78-45-16 78-45-17 78-45-18 78-45-19 78-45-20	78-45-3 78-45-4 78-45-5 78-45-6 78-45-7 78-45-8 78-45-9 78-45-10 78-45-11 78-45-12 78-45-13 78-45-14 78-45-15 78-45-16 78-45-17 78-45-18 78-45-19 78-45-20	78-45-3 78-45-4 78-45-5 78-45-6 78-45-7 78-45-8 78-45-9 78-45-10 78-45-11 78-45-12 78-45-13 78-45-14 78-45-15 78-45-16 78-45-17 78-45-18 78-45-19 78-45-20
	78-45-3 78-45-4 78-45-5 78-45-6 78-45-7 78-45-8 78-45-9 78-45-10 78-45-11 78-45-12 78-45-13 78-45-14 78-45-15 78-45-16 78-45-17 78-45-18 78-45-19 78-45-20			

A-B-BUILT

130' FROM SET BACK ROAD AND ONE WAY TO ROAD 7' FROM
 ELEV. 4.5011
 21555571.87
 21555571.87

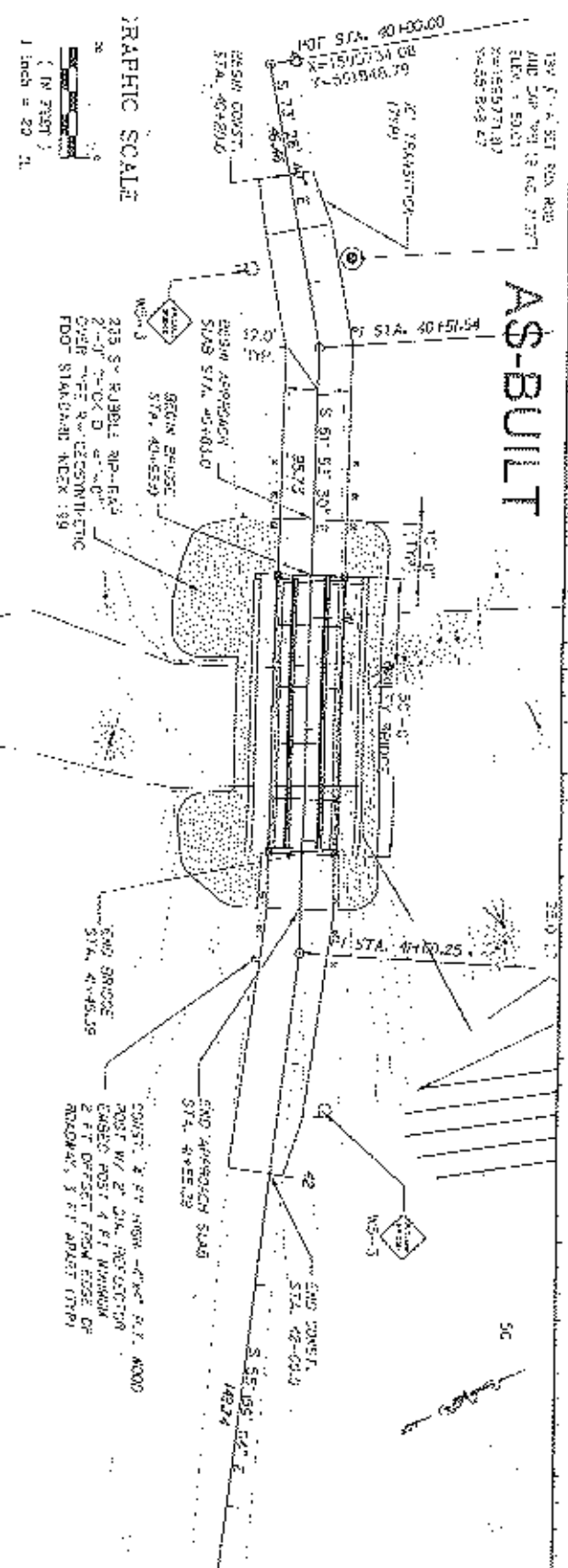

GRAPHIC SCALE
 (IN FEET)
 1 inch = 20'

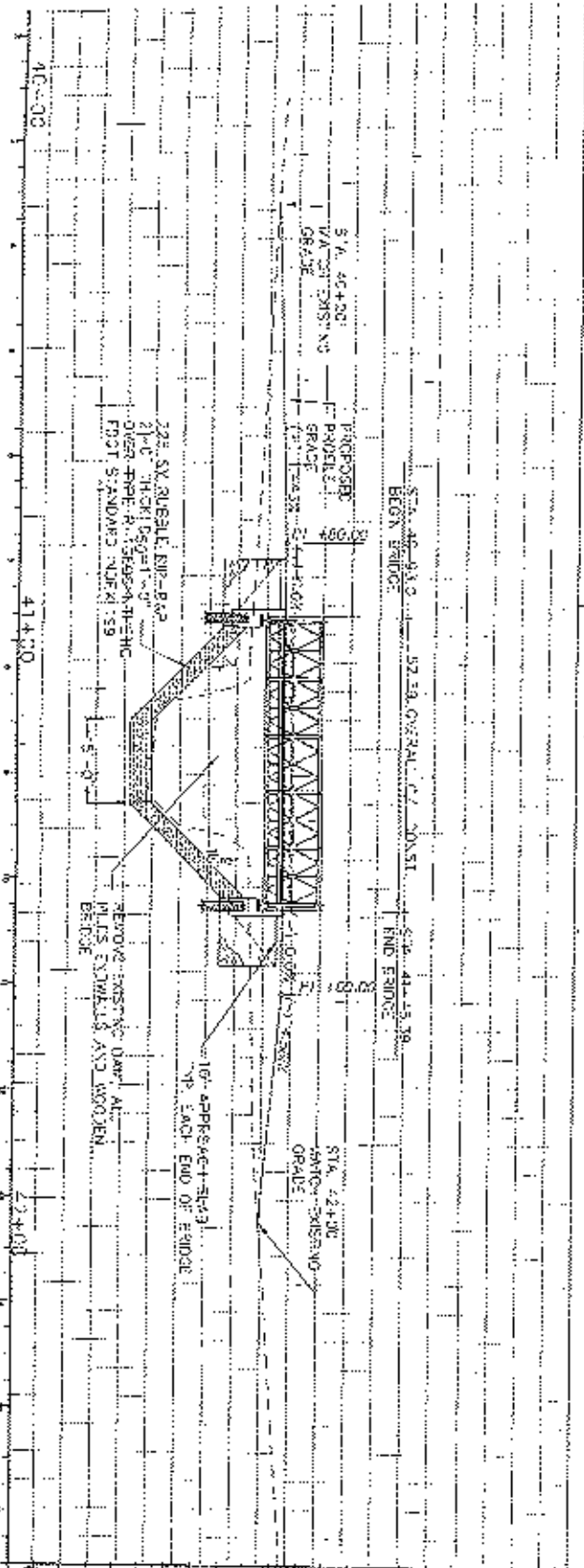

NORTHWEST FLORIDA WATER MANAGEMENT DISTRICT PLAN AND ELEVATION DYKES MILL POND SAND HILL DAM MITIGATION BANK	DATE: 12/14/07 DRAWN BY: J. RECISTE CHECKED BY: C. CAMPOS APPROVED BY: J. RECISTE	SHEET NO. 04-2 TOTAL SHEETS 04-2	PROJECT NO. 2007-001 CONTRACT NO. 2007-001	DRAWING NO. 2007-001 CONTRACT NO. 2007-001	SHEET NO. 04-2 TOTAL SHEETS 04-2
	PROJECT NO. 2007-001 CONTRACT NO. 2007-001	DRAWING NO. 2007-001 CONTRACT NO. 2007-001	SHEET NO. 04-2 TOTAL SHEETS 04-2	SHEET NO. 04-2 TOTAL SHEETS 04-2	SHEET NO. 04-2 TOTAL SHEETS 04-2

C4-2

S-BUILT

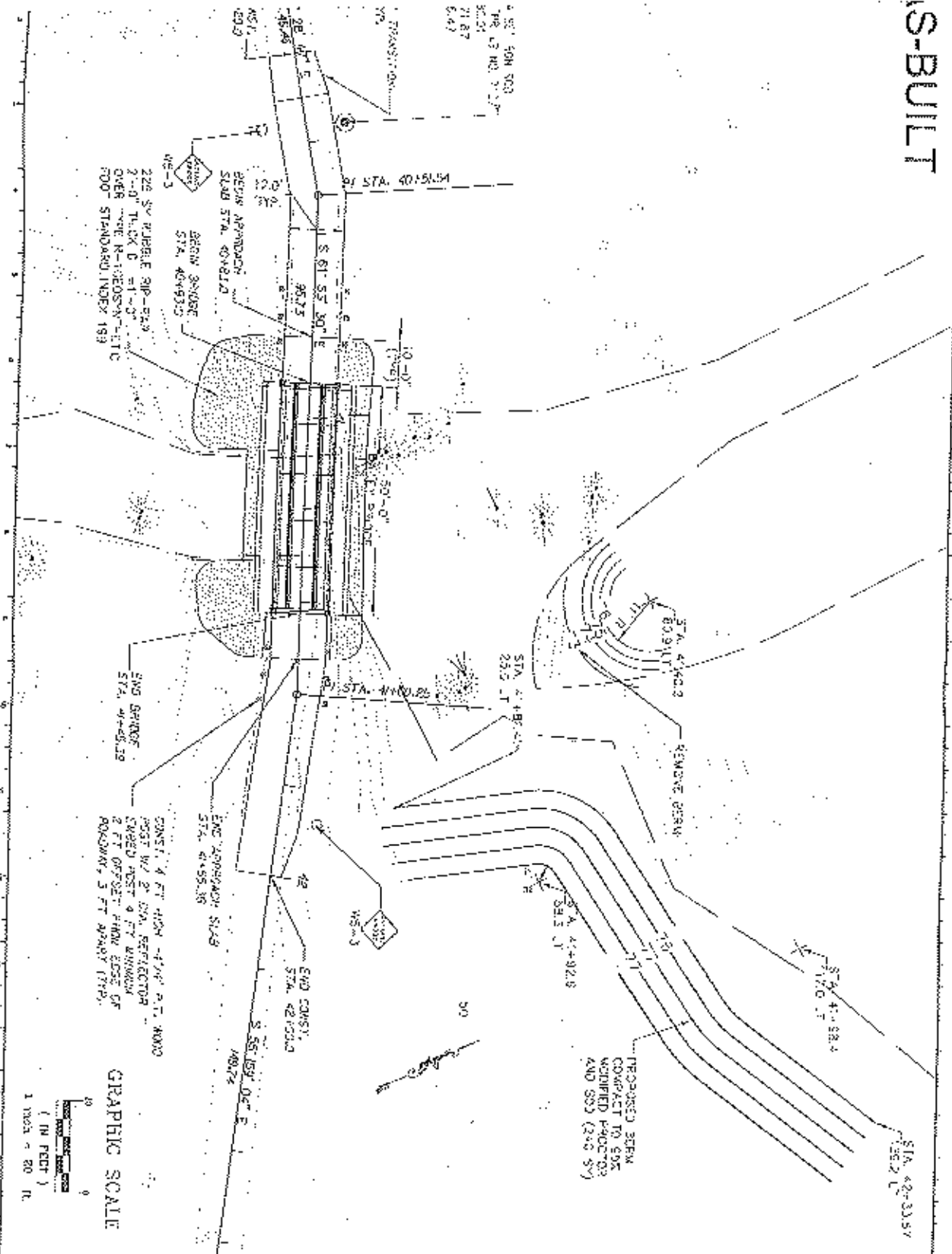

GRAPHIC SCALE 1" = 20' FT. (IN FEET)	NORTHWEST FLORIDA WATER MANAGEMENT DISTRICT PROPOSED BERM DYKES MILL POND SAND HILL LAKES WILLOW OAK	PROJECT NO. 19-000000 SHEET NO. 19-000000 DATE 10/10/2019	DESIGNER: J. SUER CHECKER: D. CAMPBELL APPROVER: J. REISCH	DATE: 08/14/2019 TIME: 10:00 AM LOCATION: 19-000000	PROJECT NO. 19-000000 SHEET NO. 19-000000 DATE 10/10/2019	NORTHWEST FLORIDA WATER MANAGEMENT DISTRICT WASHINGTON COUNTY, FLORIDA
	CA-3	NORTHWEST FLORIDA WATER MANAGEMENT DISTRICT PROPOSED BERM DYKES MILL POND SAND HILL LAKES WILLOW OAK	PROJECT NO. 19-000000 SHEET NO. 19-000000 DATE 10/10/2019	DESIGNER: J. SUER CHECKER: D. CAMPBELL APPROVER: J. REISCH	DATE: 08/14/2019 TIME: 10:00 AM LOCATION: 19-000000	PROJECT NO. 19-000000 SHEET NO. 19-000000 DATE 10/10/2019

AS-BUILT

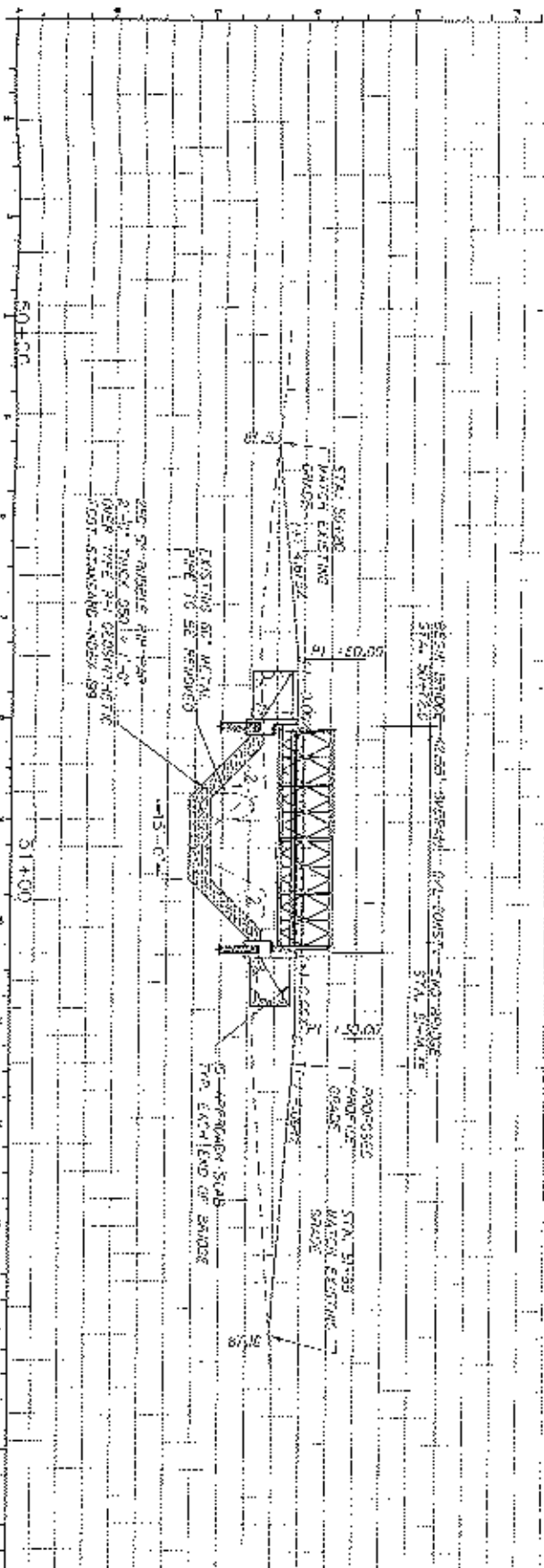
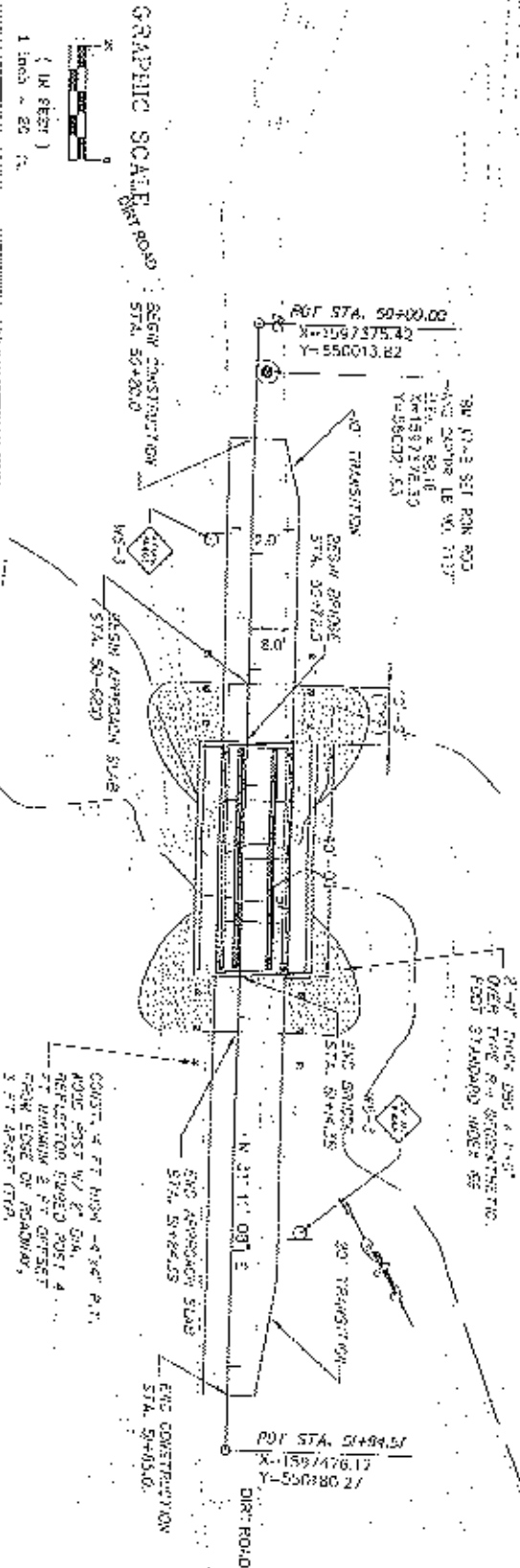

NORTHWEST FLORIDA WATER MANAGEMENT DISTRICT PLAN AND ELEVATION GREENHEAD BRIDGE SAVO HILL LAKES MITIGATION BANK	DATE: 11/11/11 DRAWN BY: J. SUGER CHECKED BY: D. CAMPOS APPROVED BY: J. TROSCHE	PROJECT NUMBER: 11-00000000 SHEET NUMBER: 1 OF 1	CONTRACT NUMBER: 11-00000000 SHEET NUMBER: 1 OF 1	PROJECT LOCATION: SAVO HILL LAKES MITIGATION BANK COUNTY: ALACHUA COUNTY, FLORIDA	PROJECT NUMBER: 11-00000000 SHEET NUMBER: 1 OF 1	CONTRACT NUMBER: 11-00000000 SHEET NUMBER: 1 OF 1	PROJECT LOCATION: SAVO HILL LAKES MITIGATION BANK COUNTY: ALACHUA COUNTY, FLORIDA
	PROJECT NUMBER: 11-00000000 SHEET NUMBER: 1 OF 1 CONTRACT NUMBER: 11-00000000 SHEET NUMBER: 1 OF 1 PROJECT LOCATION: SAVO HILL LAKES MITIGATION BANK COUNTY: ALACHUA COUNTY, FLORIDA						

AS-BUILT

GRAPHIC SCALE

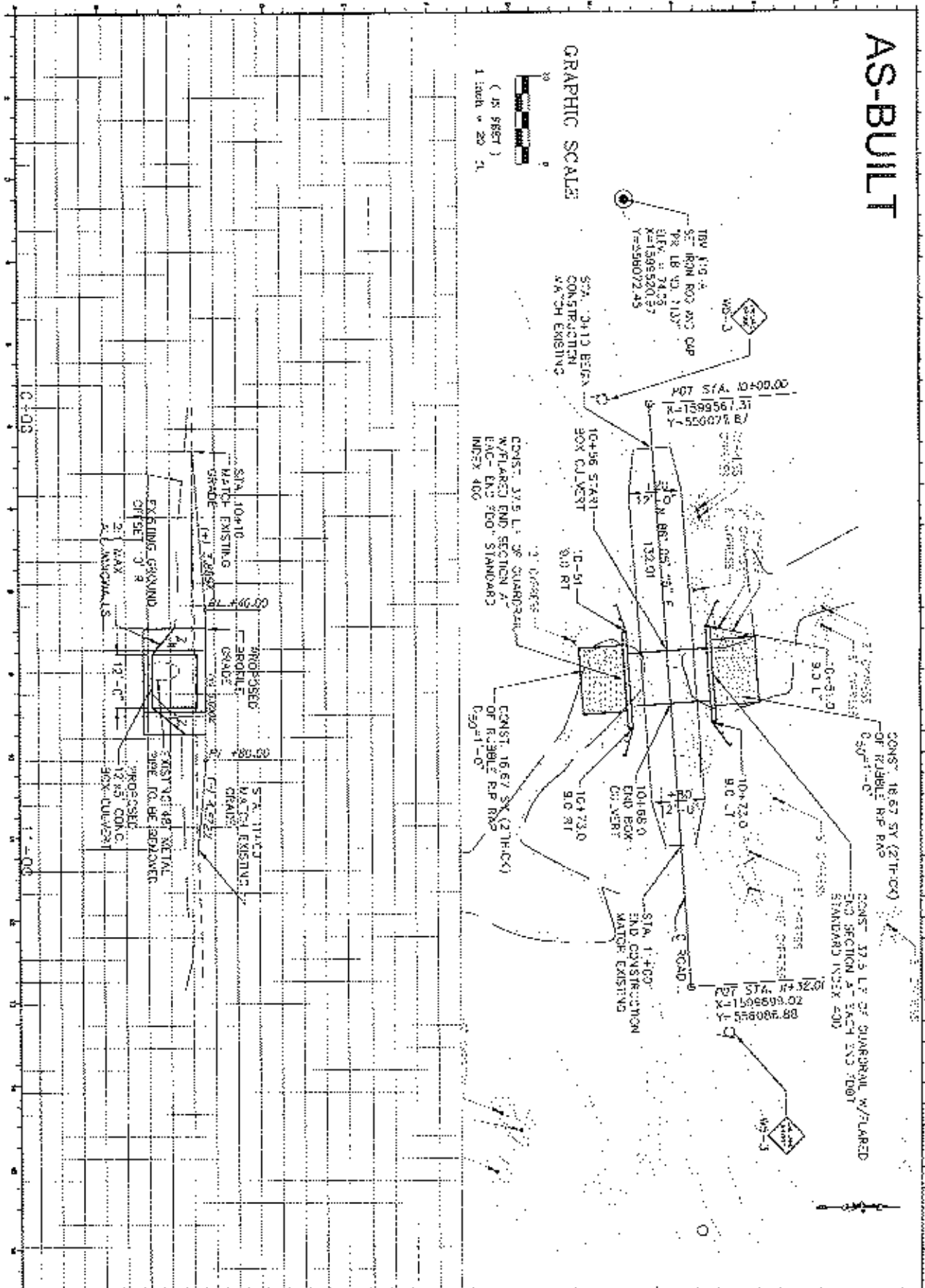
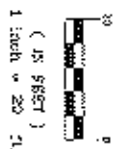

C1-2	NORTHWEST FLORIDA WATER MANAGEMENT DISTRICT PLAN AND ELEVATION JOINER LAKE/GREEN PONDS CHANNEL SAND HILL LAKES MITIGATION BANK		DESIGN: J. SLIGER CHECKED: D. CAMPOS DRAWN: J. ROEBIE		SCALE: SHAWYER DATE: 07/11/07 PROJECT NO.: 07-000007		CONTRACTOR: CARTER TRACT NORTHWEST FLORIDA WATER MANAGEMENT DISTRICT WASHINGTON COUNTY, FLORIDA	
	PROJECT FILE:		DATE: 07/11/07		PROJECT NO.: 07-000007		CONTRACTOR:	
	PROJECT FILE:		DATE: 07/11/07		PROJECT NO.: 07-000007		CONTRACTOR:	

AS-BUILT

CURVE DATA CURVE 1:

R STA. = 20+29.80
 P STA. = 18+39.07 (R²)
 DELTA = 28° 38' 52"

PC STA. = 20+00.00
 PT STA. = 20+55.28
 PI STA. = 20+27.44
 PTA STA. = 20+00.00
 PVB STA. = 20+27.44
 PVI STA. = 20+27.44

137 SY RUBBLE RIP-RAP
 2'-0" T-CUR DSD - 1'-0" T-OT
 OVER TYPE R-1 GEOSYNTHETIC
 FOOT STANDARD INDEX 193

GRAPHIC SCALE
 (IN FEET)
 1 inch = 20 ft

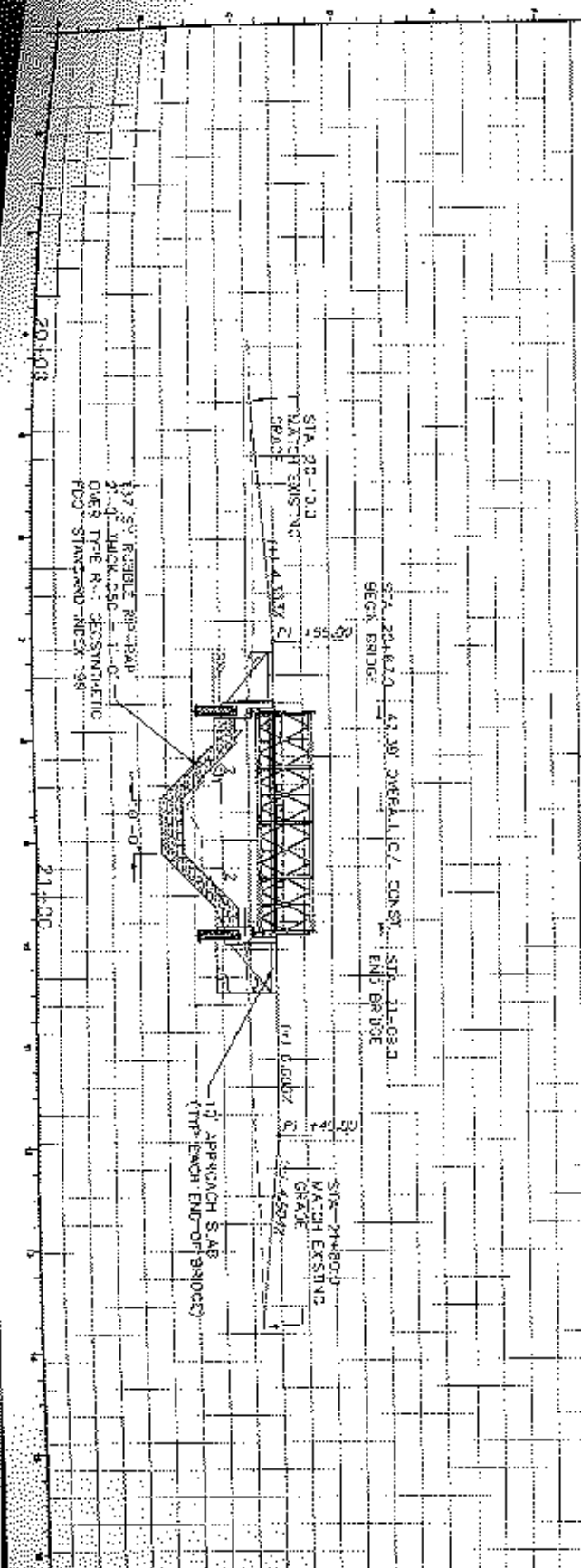
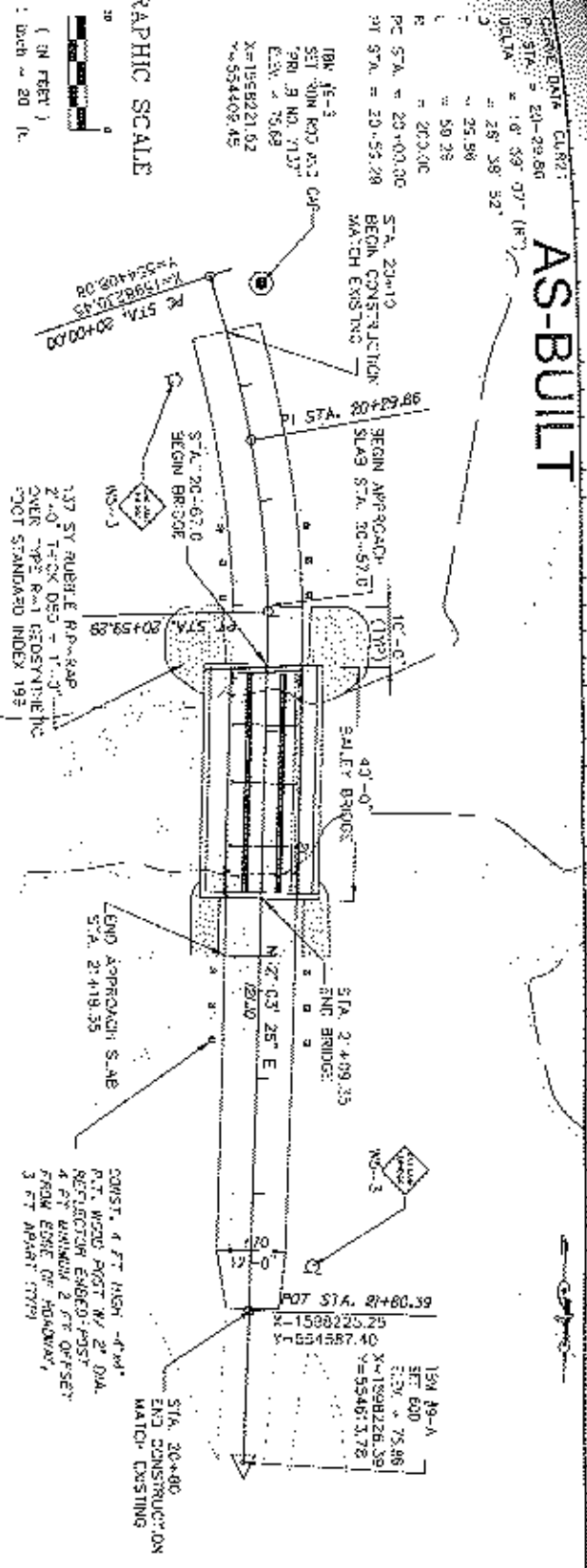

NORTHWEST FLORIDA WATER MANAGEMENT DISTRICT PLAN AND ELEVATION JOYNER LAKE CANAL SAND HILL LAKES MITIGATION BARK	DATE: 02/28/21 DRAWN BY: J. J. JONES CHECKED BY: J. J. JONES PROJECT NO.: 193	SHEET NO.: 02-2 TOTAL SHEETS: 02	PROJECT NO.: 193 SHEET NO.: 02-2 TOTAL SHEETS: 02	PROJECT NO.: 193 SHEET NO.: 02-2 TOTAL SHEETS: 02	PROJECT NO.: 193 SHEET NO.: 02-2 TOTAL SHEETS: 02
	PROJECT NO.: 193 SHEET NO.: 02-2 TOTAL SHEETS: 02	PROJECT NO.: 193 SHEET NO.: 02-2 TOTAL SHEETS: 02	PROJECT NO.: 193 SHEET NO.: 02-2 TOTAL SHEETS: 02	PROJECT NO.: 193 SHEET NO.: 02-2 TOTAL SHEETS: 02	PROJECT NO.: 193 SHEET NO.: 02-2 TOTAL SHEETS: 02

02-2

AS-BUILT

134 N3-4
 SEC 30N RD NO. 1 COR
 TR 28 NO. 7137
 ELEV. = 73.63
 X = 1584478.39
 Y = 552122.61

POT STA. 30+00.00
 X = 1584478.39
 Y = 552122.61

CONST. 30 L.F. OF GUARDRAIL
 W/FALLER END SECTION AT EACH
 END FOOT STANDARD INDEX 400

CONST. 78.0 SY (27'-0")
 OF RIBBLE RIP RAP
 D₅₀ = 1.0"

134 N3-4
 SEC 30N RD NO. 1 COR
 TR 28 NO. 7137
 ELEV. = 73.63
 X = 1584478.39
 Y = 552122.61

GRAPHIC SCALE

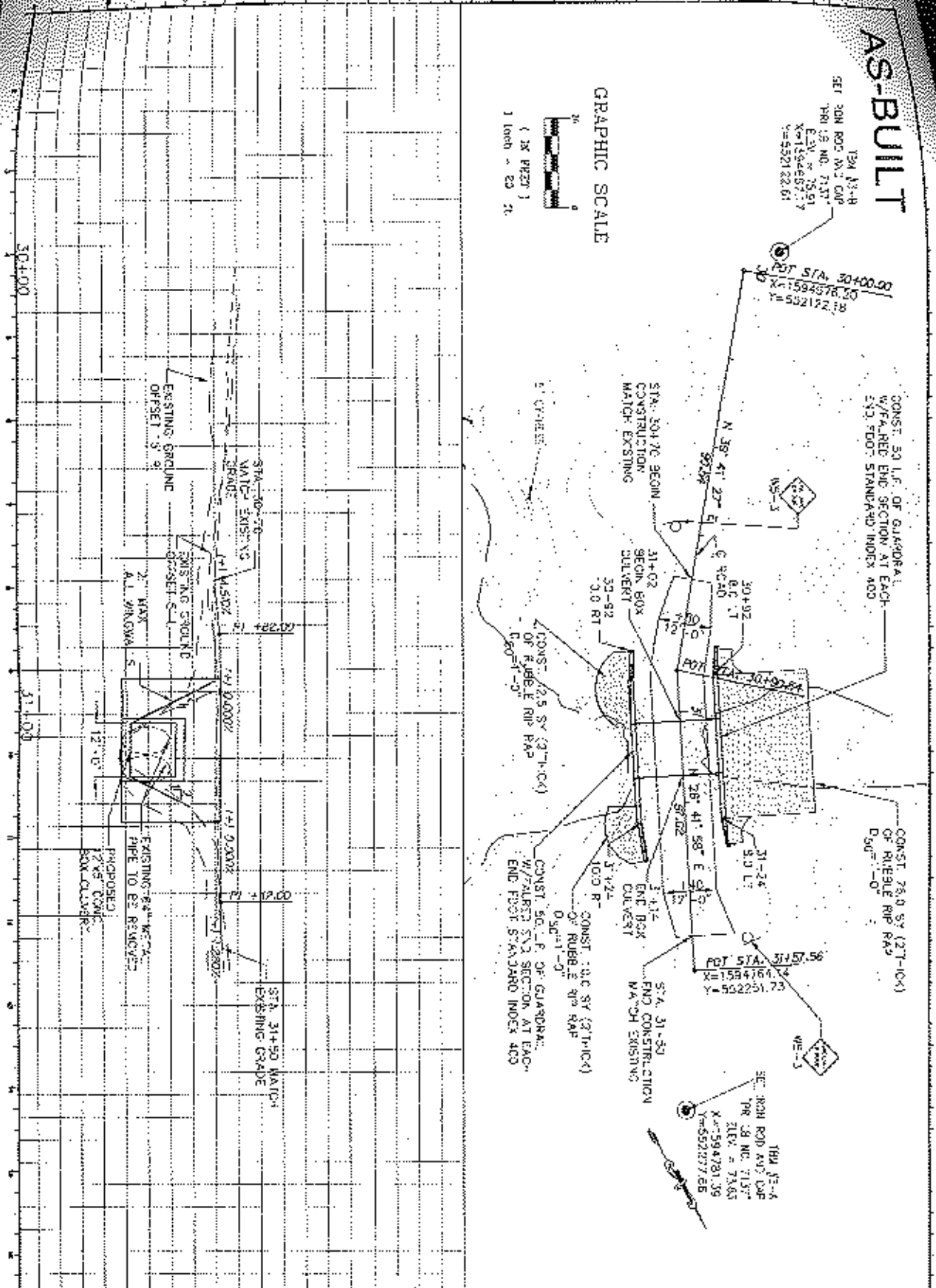
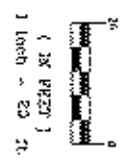

C3-2 NORTHWEST FLORIDA WATER MANAGEMENT DISTRICT PLAN AND ELEVATION POWER LINE POND SAND HILL LAKES MITIGATION BANK	PROJECT NO. 134 N3-4 DATE 11/11/11 DRAWN BY J. NEGISTE CHECKED BY J. NEGISTE	PROJECT NO. 134 N3-4 DATE 11/11/11 DRAWN BY J. NEGISTE CHECKED BY J. NEGISTE	PROJECT NO. 134 N3-4 DATE 11/11/11 DRAWN BY J. NEGISTE CHECKED BY J. NEGISTE
	CARTER TRAFFIC NORTHWEST FLORIDA WATER MANAGEMENT DISTRICT WASHINGTON COUNTY, FLORIDA		

TRM 4144-507 IRON ROD
AND CAP PER IS NO. 7-37
FIN. = 90.00
K=1555271.87
V=551846.47

AS-BUILT

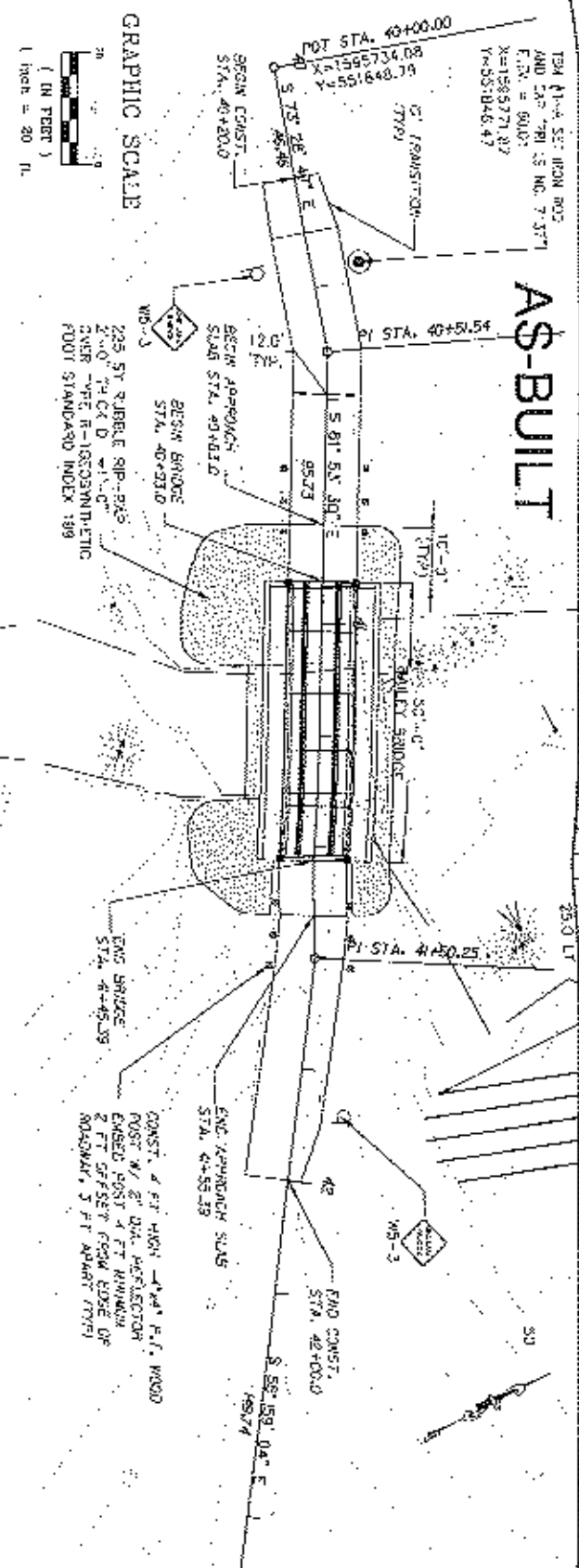

GRAPHIC SCALE
(IN FEET)
1 inch = 20 ft

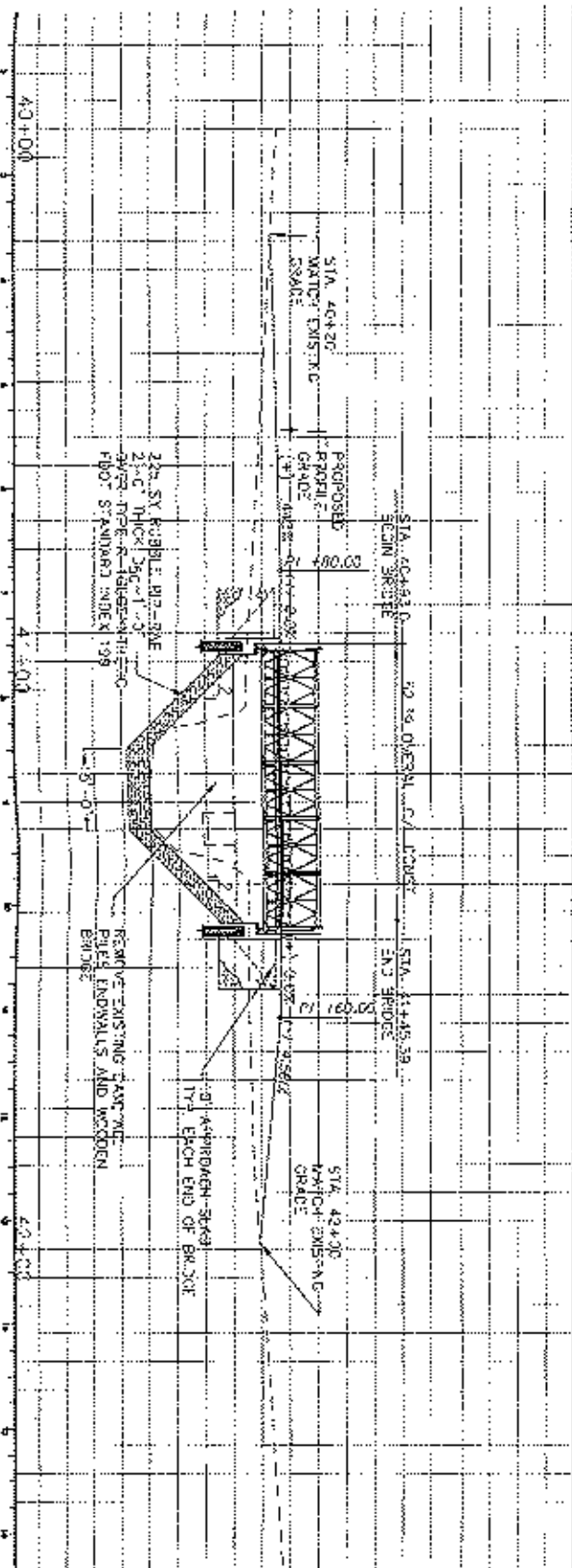

<p>NORTHWEST FLORIDA WATER MANAGEMENT DISTRICT PLAN AND ELEVATION BYKES MILL POND PROJECT SAND HILL LAKES MITIGATION BANK</p>	<p>DATE: 7/10/07</p> <p>BY: [Signature]</p>	<p>NO. 2 SLIDER</p> <p>NO. 3 CASPES</p>	<p>DATE: 04/10/07</p> <p>NO. 1 CASPES</p>	<p>DATE: 04/10/07</p> <p>NO. 1 CASPES</p>	<p>DATE: 04/10/07</p> <p>NO. 1 CASPES</p>	<p>DATE: 04/10/07</p> <p>NO. 1 CASPES</p>	<p>DATE: 04/10/07</p> <p>NO. 1 CASPES</p>	<p>DATE: 04/10/07</p> <p>NO. 1 CASPES</p>	<p>DATE: 04/10/07</p> <p>NO. 1 CASPES</p>								
	<p>CARTER TRACY NORTHWEST FLORIDA WATER MANAGEMENT DISTRICT WASHINGTON COUNTY, FLORIDA</p>	<p>REVISIONS</p> <table border="1"> <thead> <tr> <th>NO.</th> <th>DESCRIPTION</th> <th>DATE</th> </tr> </thead> <tbody> <tr> <td>1</td> <td>ISSUED FOR PERMITS</td> <td>04/10/07</td> </tr> <tr> <td>2</td> <td>AS-BUILT</td> <td>07/10/07</td> </tr> </tbody> </table>								NO.	DESCRIPTION	DATE	1	ISSUED FOR PERMITS	04/10/07	2	AS-BUILT
NO.	DESCRIPTION	DATE															
1	ISSUED FOR PERMITS	04/10/07															
2	AS-BUILT	07/10/07															

AS-BUILT

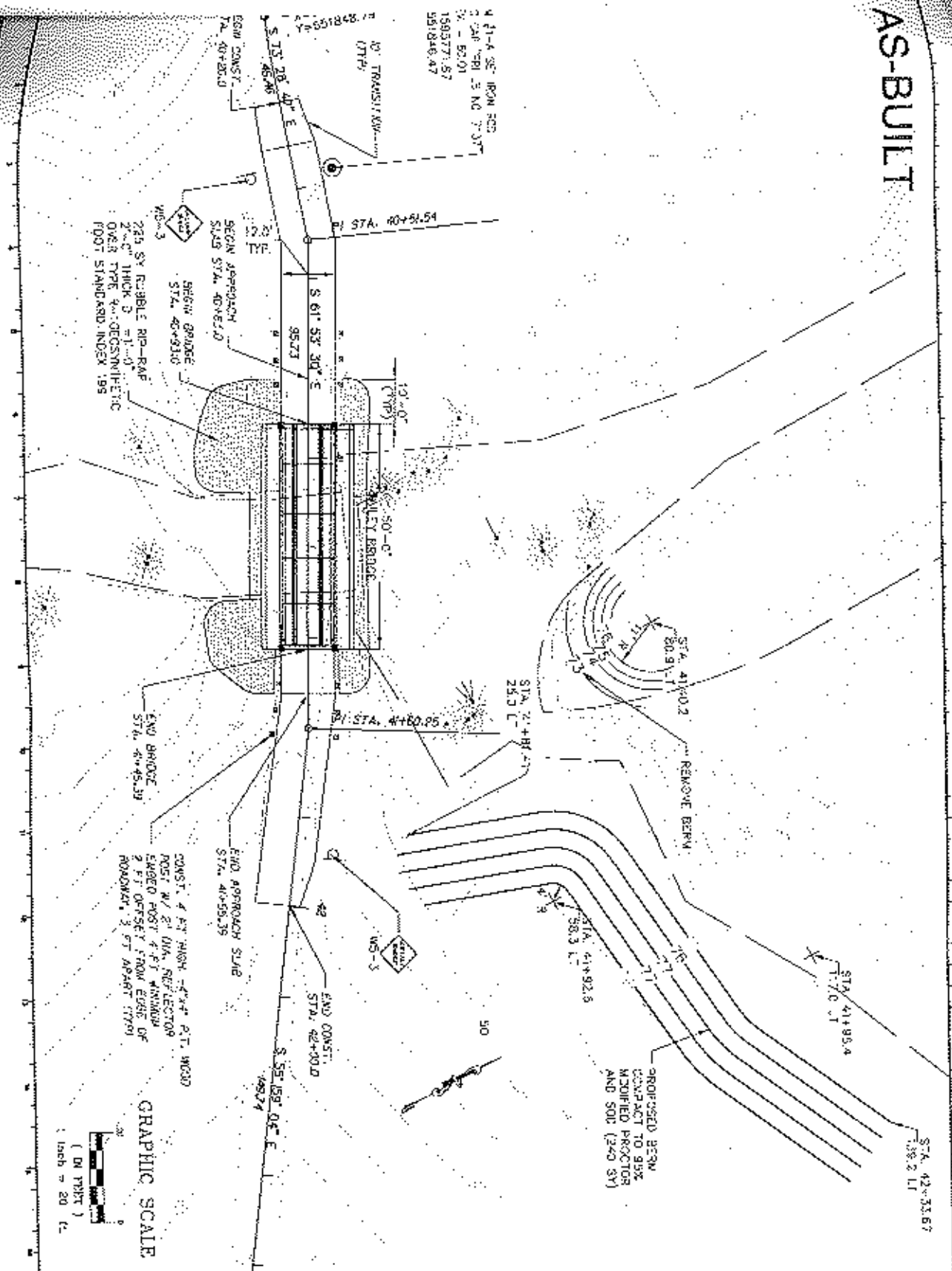

4 1/4" x 5/8" IRON ROD
 2" DIA. x 30" L. NO. 7-3077
 150377-57
 551846-47

BEGIN APPROACH
 SLAB STA. 40+62.00
 BEGIN GRAVEL
 STA. 42+03.00
 225 SY RUBBLE RIP-RAP
 2" THICK 3' x 1'-0"
 OVER TYPE 4-GEOSYNTHETIC
 FOOT STANDARD INDEX 195

END APPROACH SLAB
 STA. 41+55.39
 CONST. 4 FT HIGH x 4 FT x 4 FT P.T. WOOD
 POST W/ 2" DIA. REFLECTOR
 EMBED POST 4 FT MINIMUM
 2 FT OFFSET FROM EDGE OF
 ROADWAY 3 FT APART (770)

PROPOSED BERM
 COMPACT TO 95%
 MODIFIED PROCTOR
 AND SOE (240 SY)

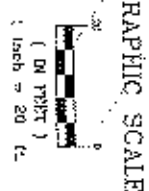

C4-3

NORTHWEST FLORIDA WATER MANAGEMENT DISTRICT PROPOSED BERM DYKES MILL POND SAND HILL LAKES MITIGATION BANK		DATE: 11/10/01 DRAWN BY: [Signature] CHECKED BY: [Signature]
--	--	--

DESIGNER: J. SUGER CHECKED BY: C. CAMPOS PROJECT NO.: 2-REG18E	DATE: 08/20/01 SCALE: AS SHOWN SHEET NO.: 1 OF 1
--	--

CARTER TRACT NORTHWEST FLORIDA WATER MANAGEMENT DISTRICT WASHINGTON COUNTY, FLORIDA	
--	--

AS-BUILT

GRAPHIC SCALE
1 inch = 20 feet

(IN PERS)
1 inch = 20 feet

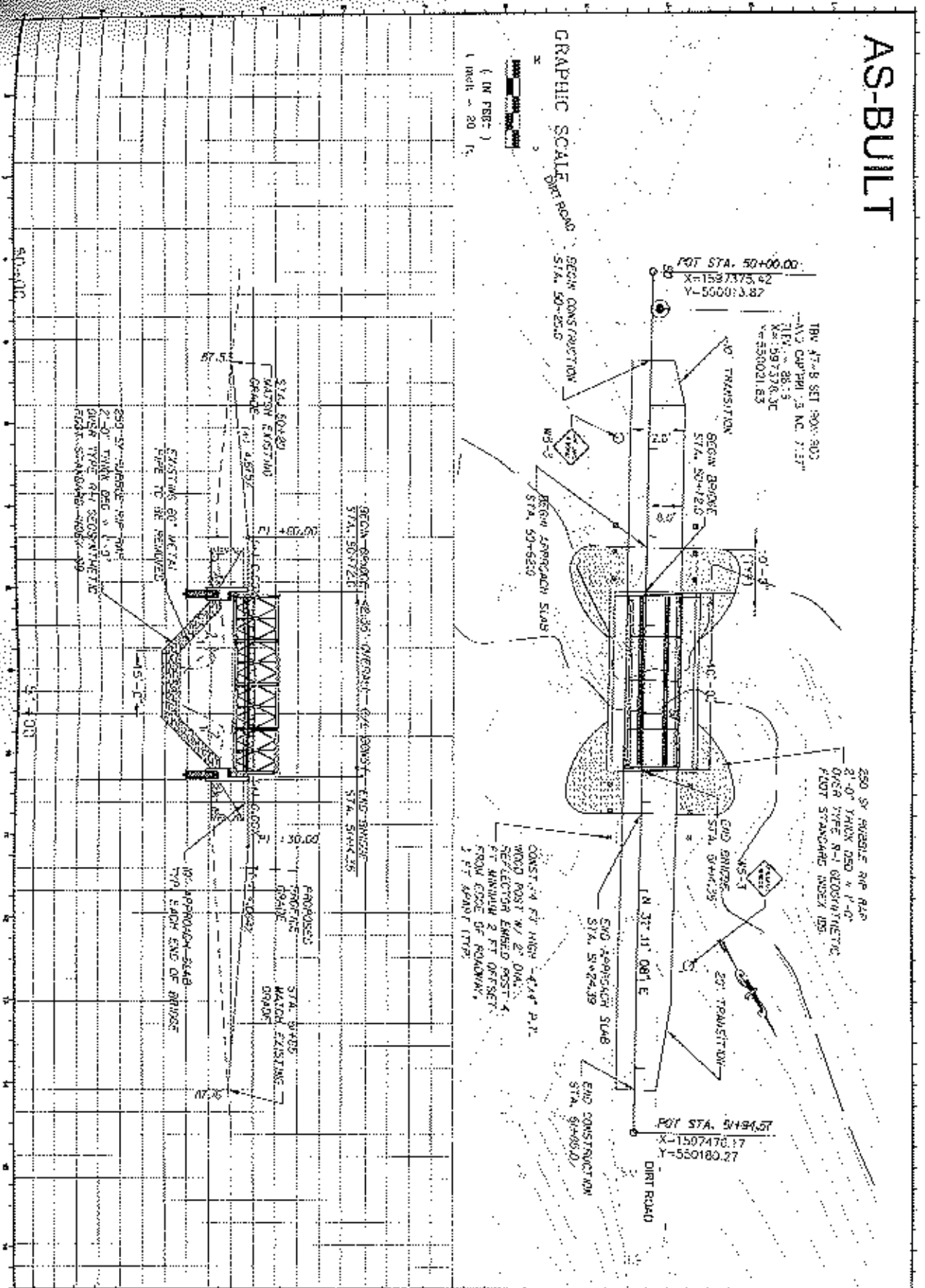

05-2

NORTHWEST FLORIDA WATER MANAGEMENT DISTRICT
PLAN AND ELEVATION
GREENWALD BRIDGE
SAND HILL LAKES MITIGATION BANK

Author: J. SLAGER	Check: M. BHANUJ
Design: D. CAMPBELL	Drawn: M. BHANUJ
Reviewed: K. ROBERTS	Scale: 1" = 20'

MANAGEMENT DISTRICT
WASHINGTON COUNTY, FLORIDA

Appendix 2: Photos of Bridge and Culvert Construction

Figure 1. Brush Reduction Polygons

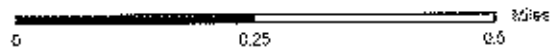
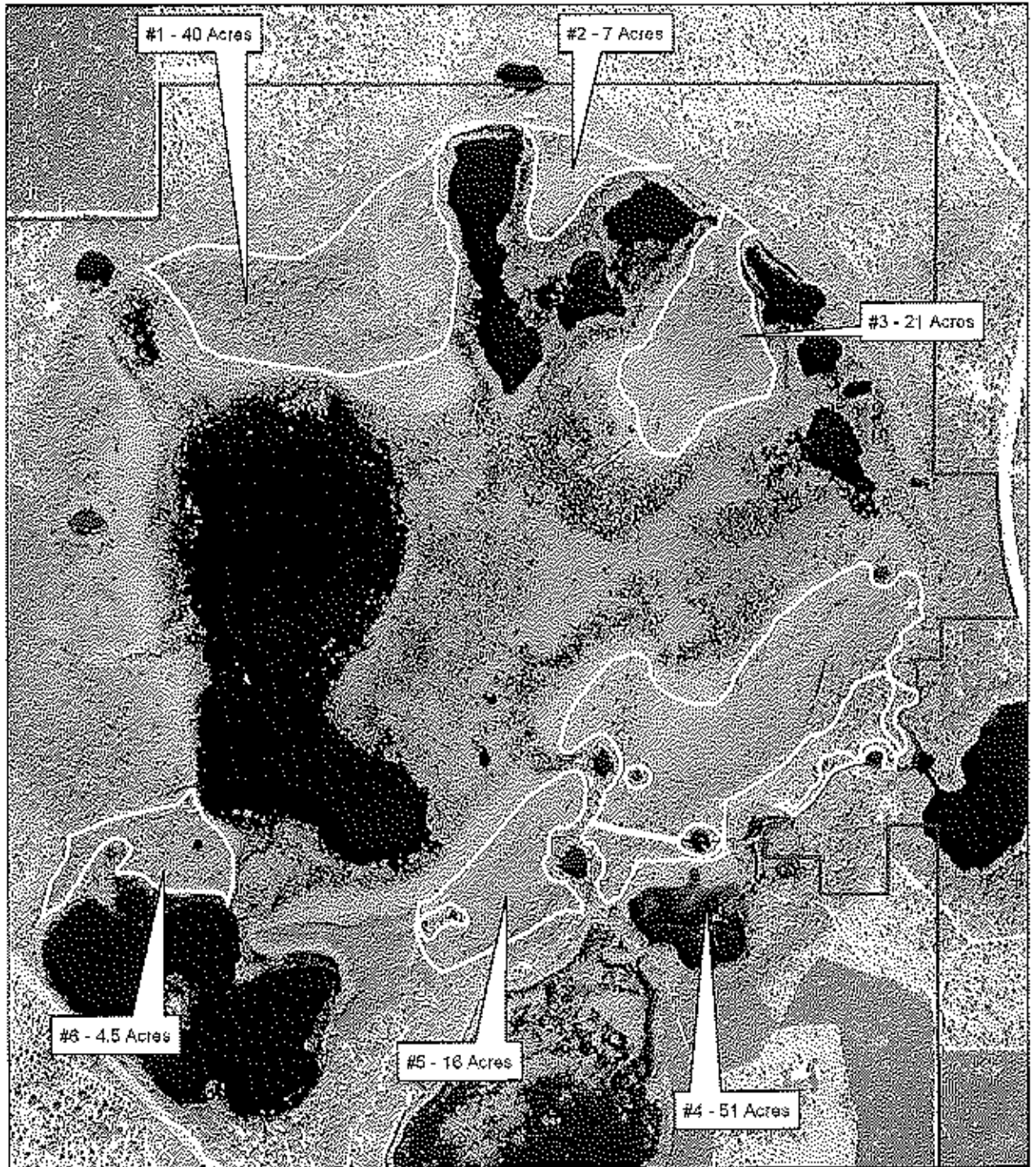
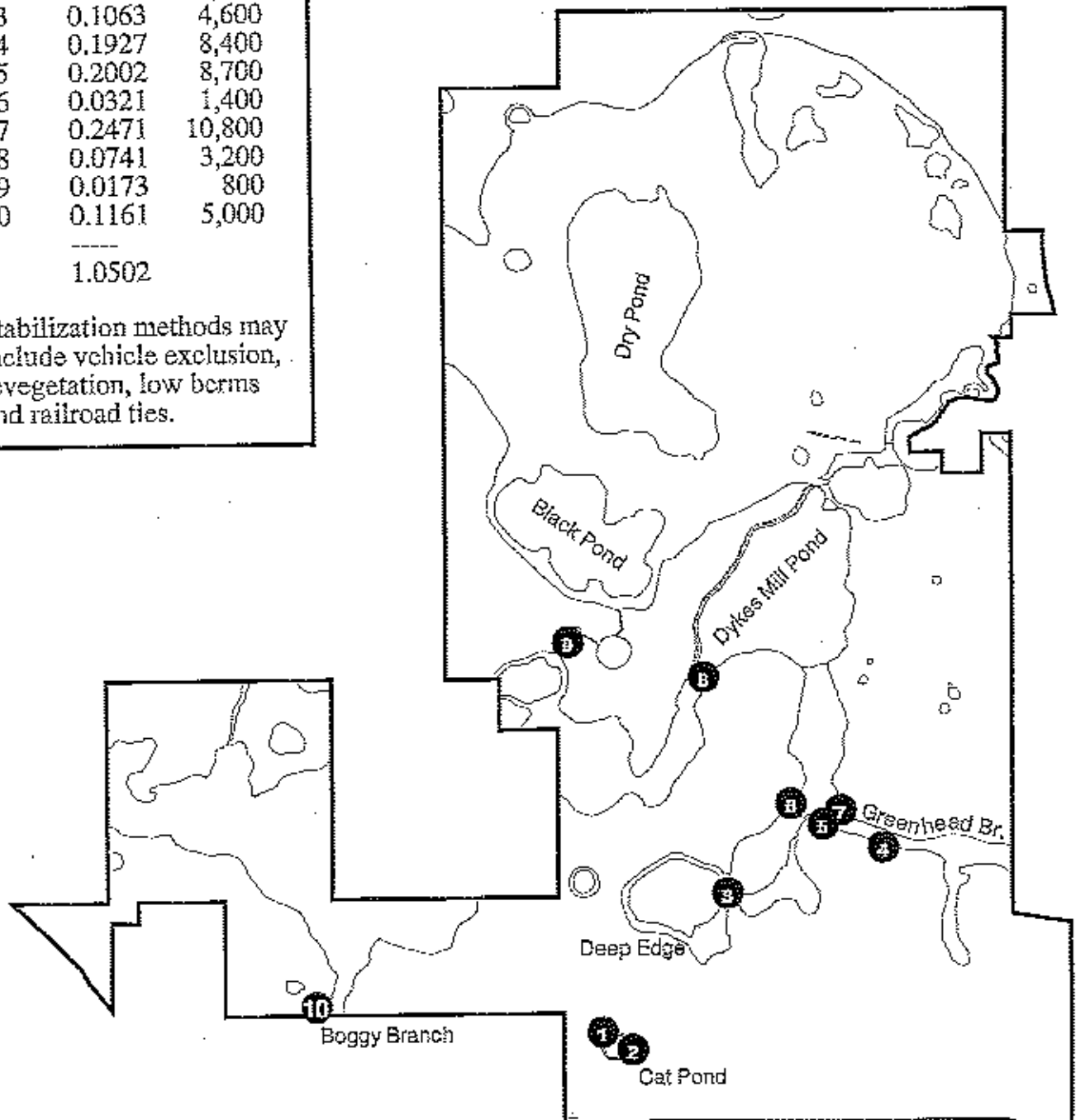

Figure 9 - Erosion Stabilization Sites

Site	Acres	Sq. Ft.
1	0.0272	1,200
2	0.0371	1,600
3	0.1063	4,600
4	0.1927	8,400
5	0.2002	8,700
6	0.0321	1,400
7	0.2471	10,800
8	0.0741	3,200
9	0.0173	800
10	0.1161	5,000

		1.0502

Stabilization methods may include vehicle exclusion, revegetation, low berms and railroad ties.



0 0.5 1 1.5 2 Miles



Figure 10 - Structures

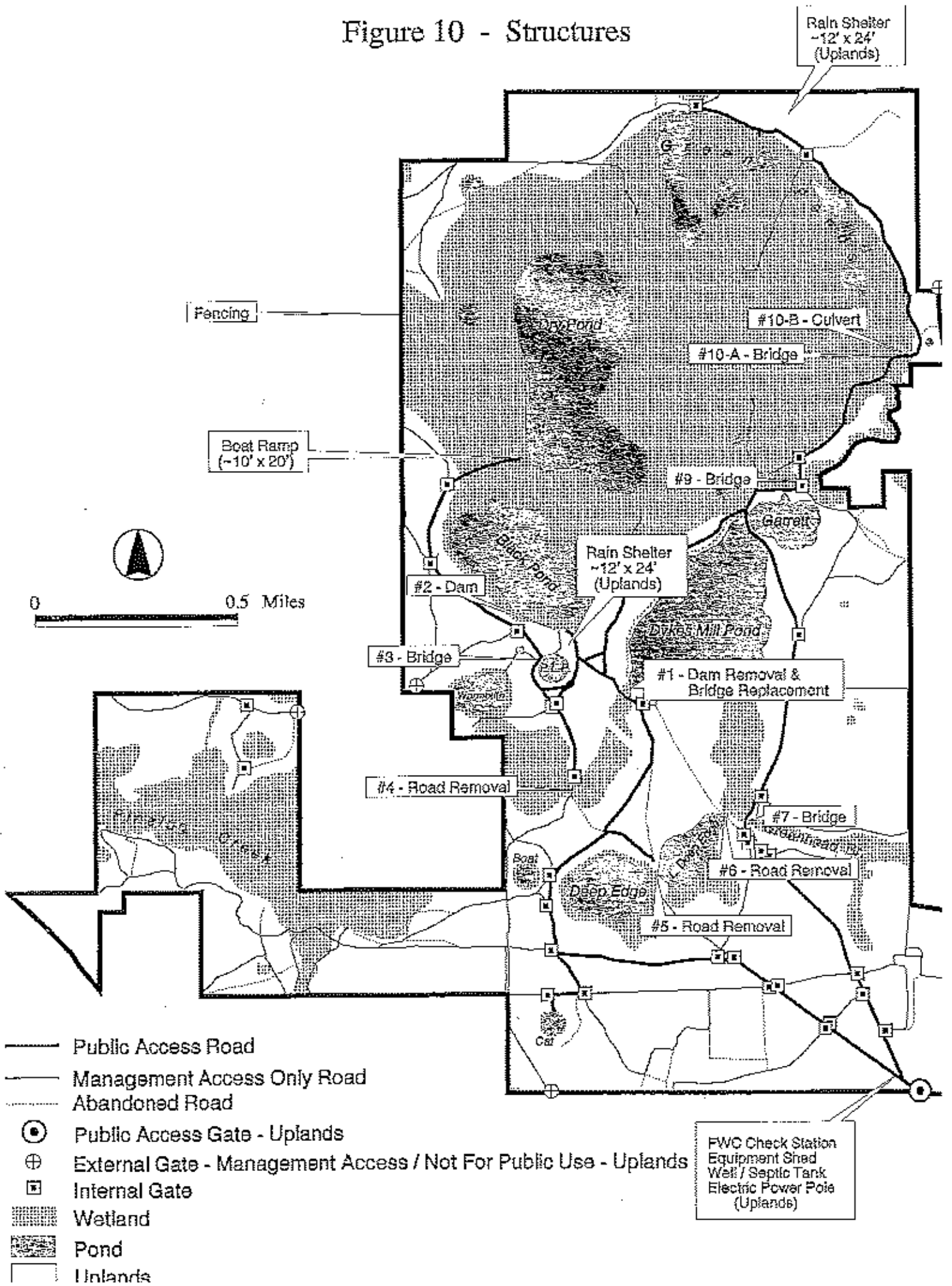

Figure 11. Winter burns at the SHLMB

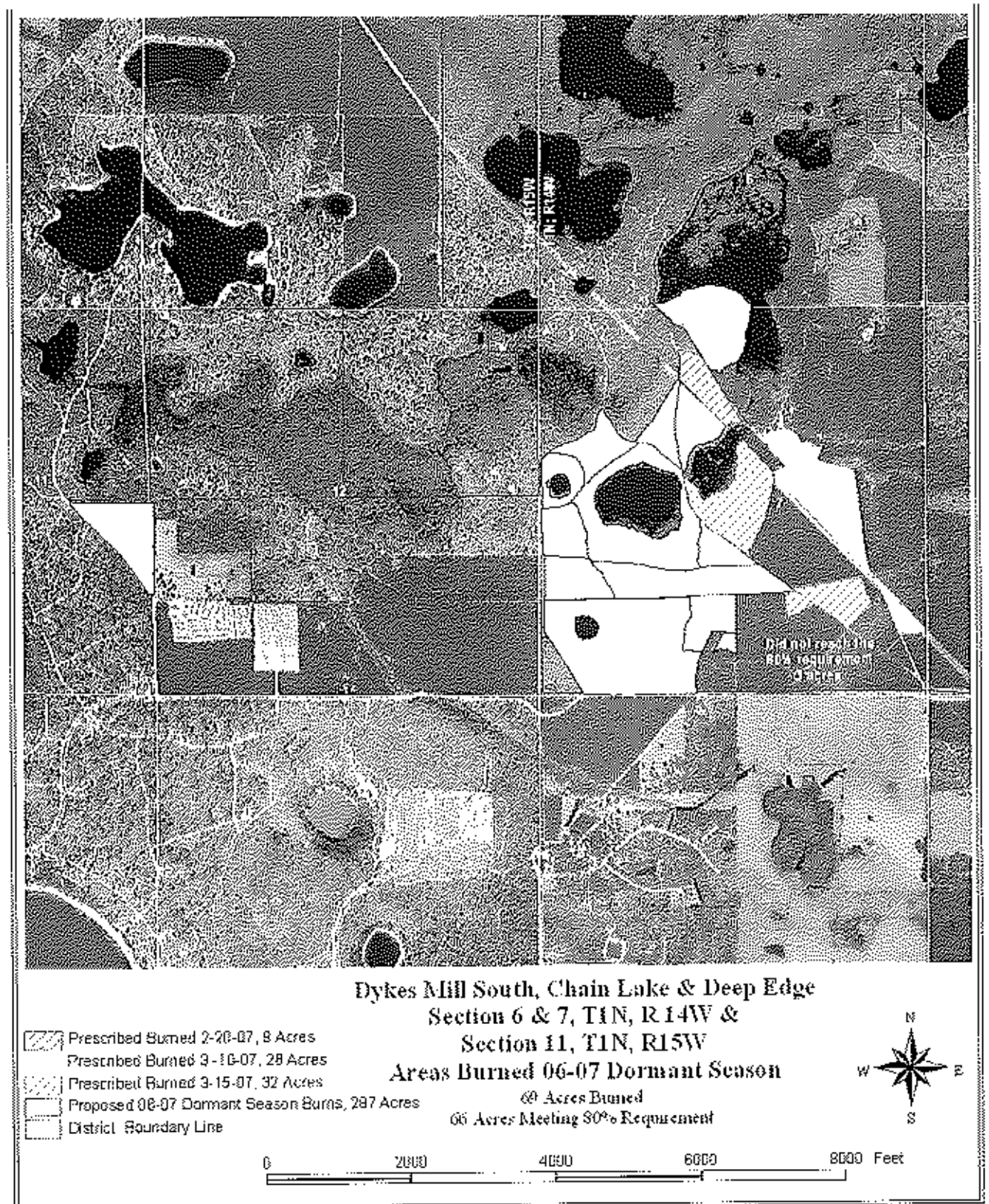
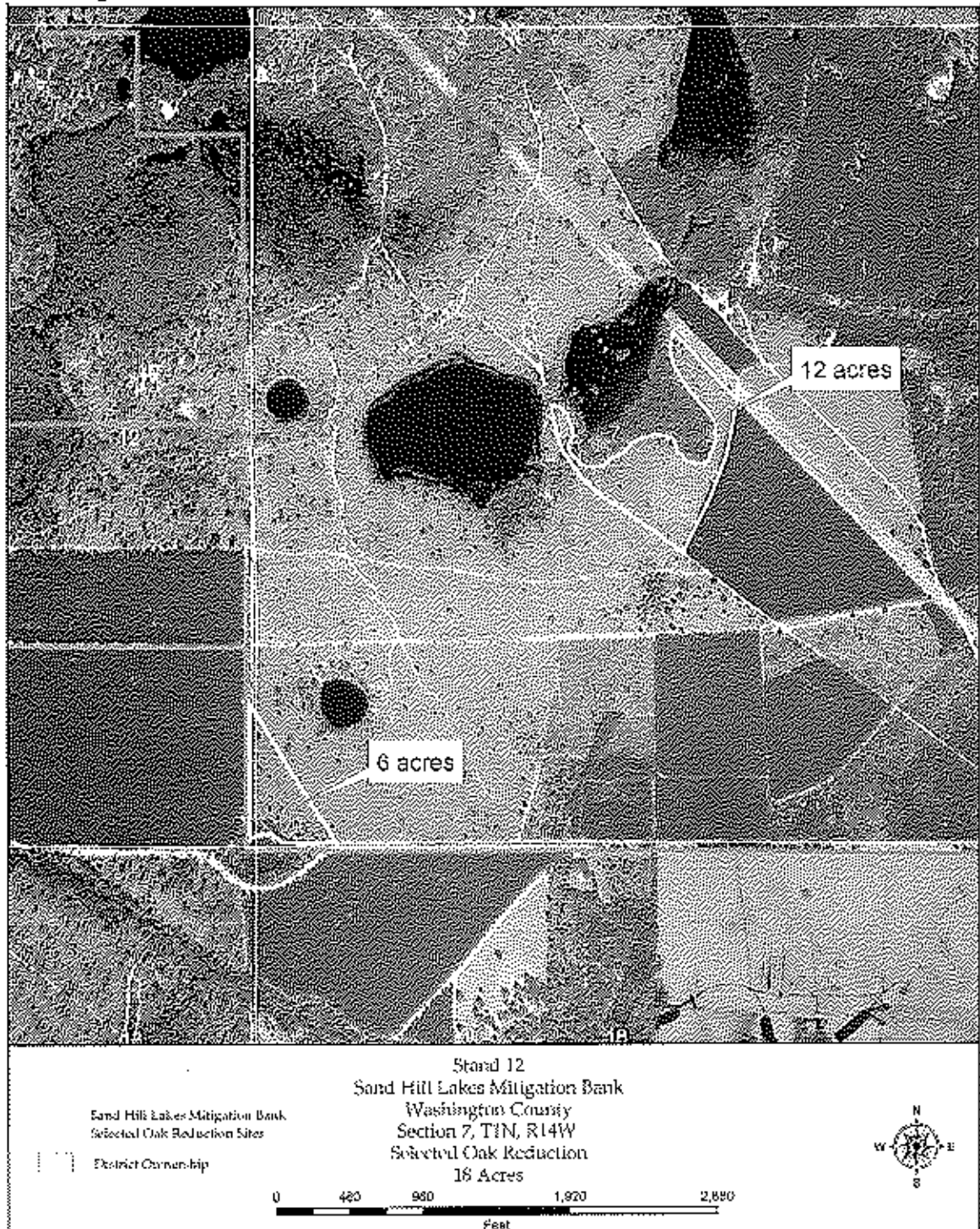
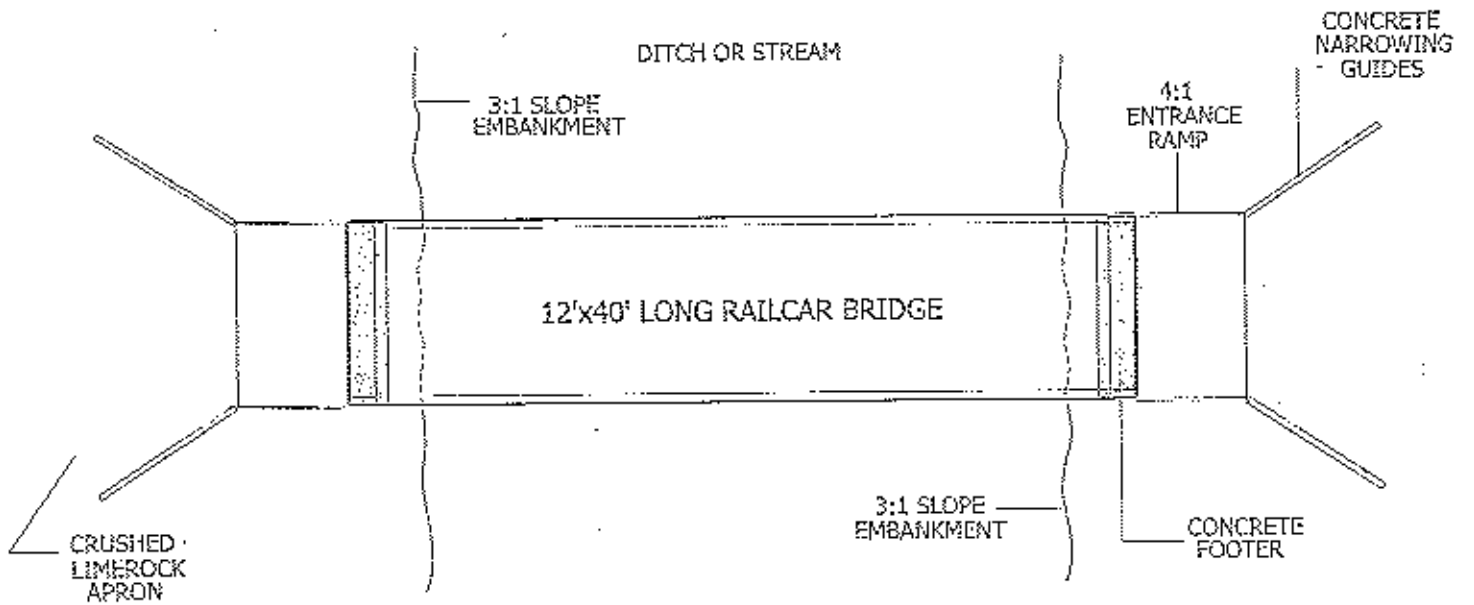

Figure 12. 2007 Oak Reduction: Adjacent to Little Deep Edge and Cat Pond



TYPICAL BRIDGE DESIGN

NOT TO SCALE



PLAN VIEW

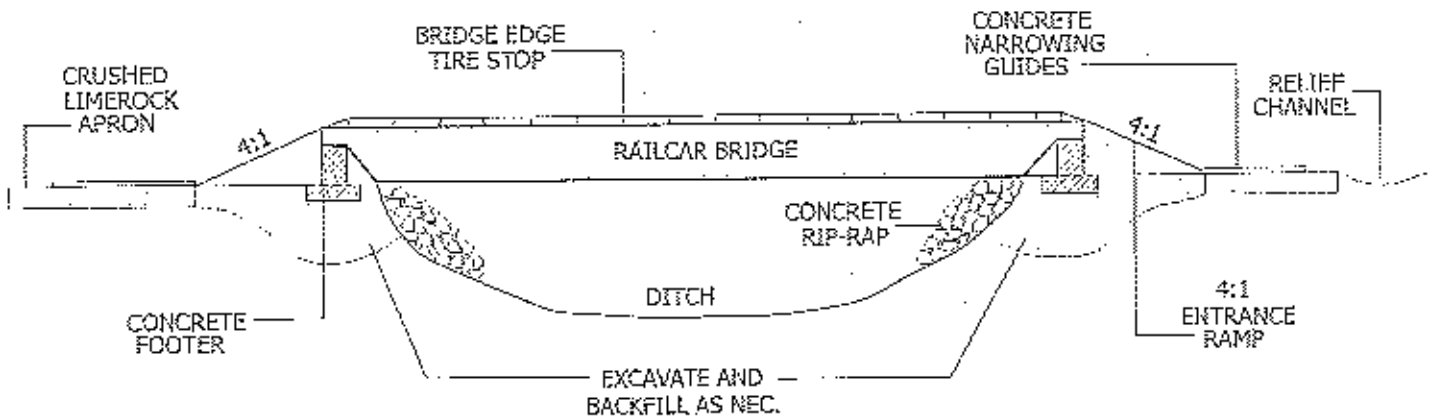

PROFILE VIEW

Grady to the Max
9/22/05

TYPICAL ROAD CUT

(NOT TO SCALE)

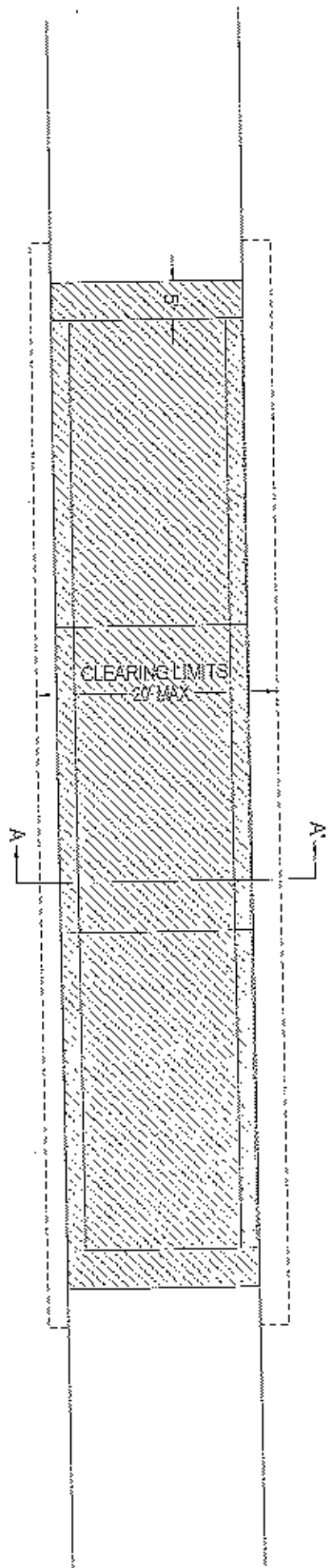
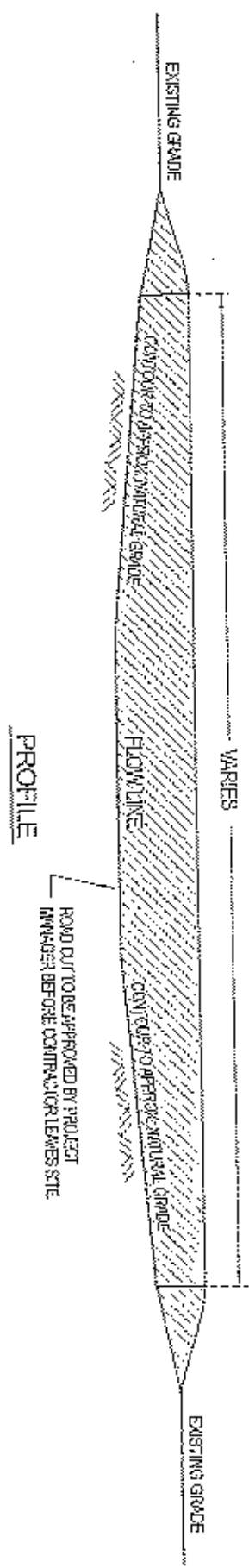

PLAN VIEW

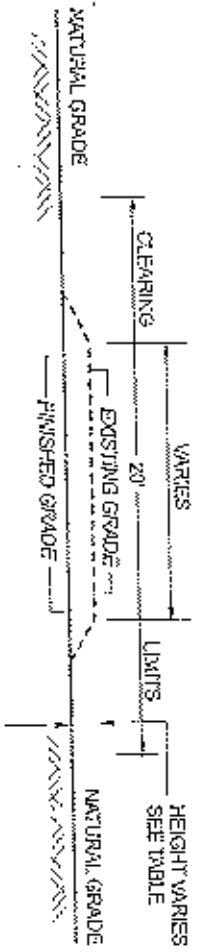

SECTION A-A'

- NOTES:
1. REMOVED MATERIAL TO BE PLACED IN ERODING UPLANDS OR OTHER APPROPRIATE UPLAND DISPOSAL SITE.
 2. ALL MATERIALS TO BE PROVIDED FROM SITE.
 3. VEGETATION ALONG SIDES OF ROAD TO BE REMOVED BY CONTRACTOR WHERE NECESSARY.
 4. REPLANT FORMER ROAD FOOTPRINT TO MATCH SURROUNDING COMMUNITY.

Bradford G. Burdick

CULVERT INSTALLATION

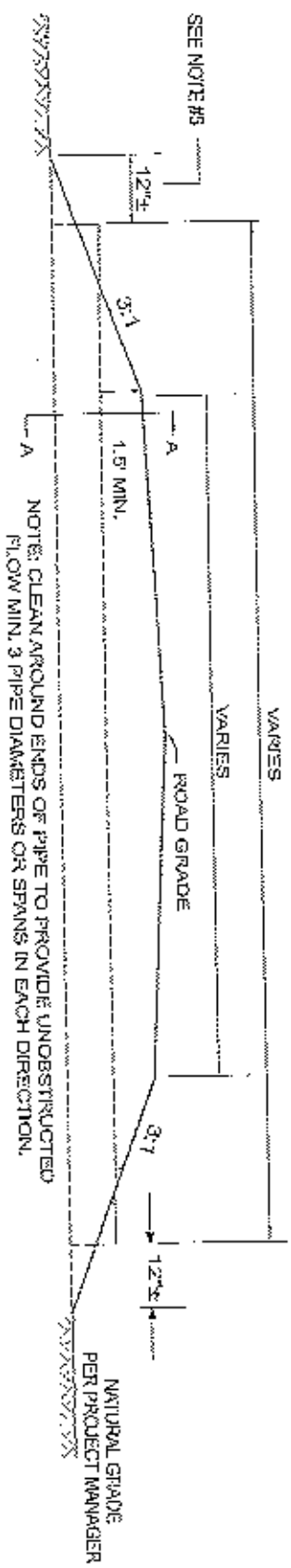

PROFILE

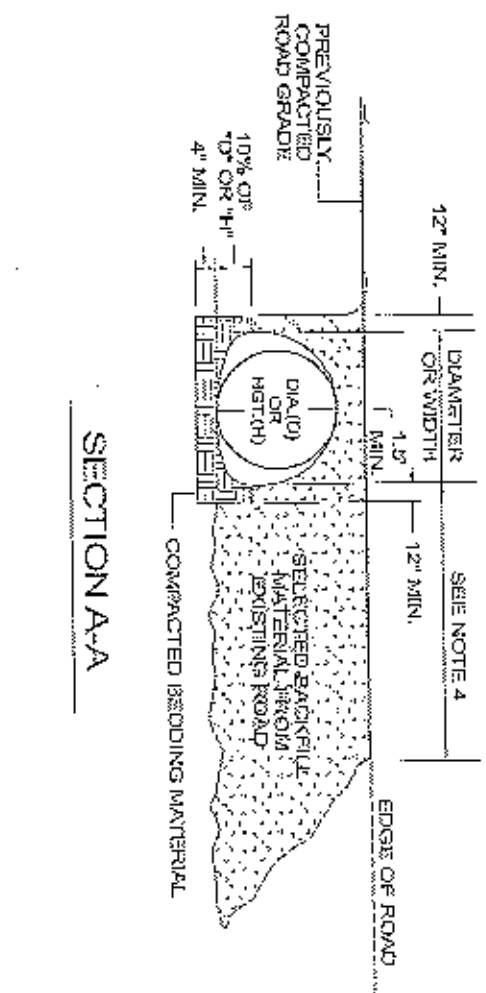

SECTION A-A

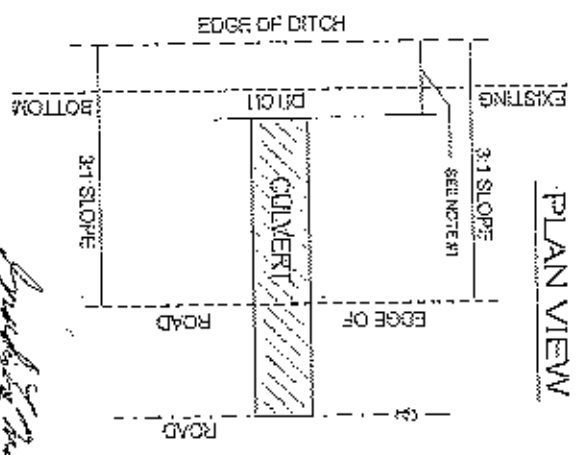

PLAN VIEW

RAILCAR BRIDGE (10A) AND CULVERT (10B) INSTALLATION

ROAD PROFILE AT BRIDGE & CULVERT LOCATION

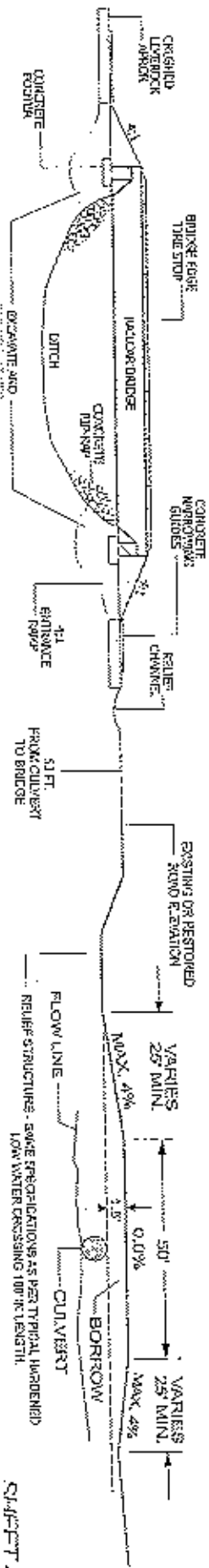

Erin Stipan
8/12/05

Appendix 2: Photos of Bridge and Culvert Construction

Culvert Construction at Powerline Pond (Pond Near Dry) March 2007

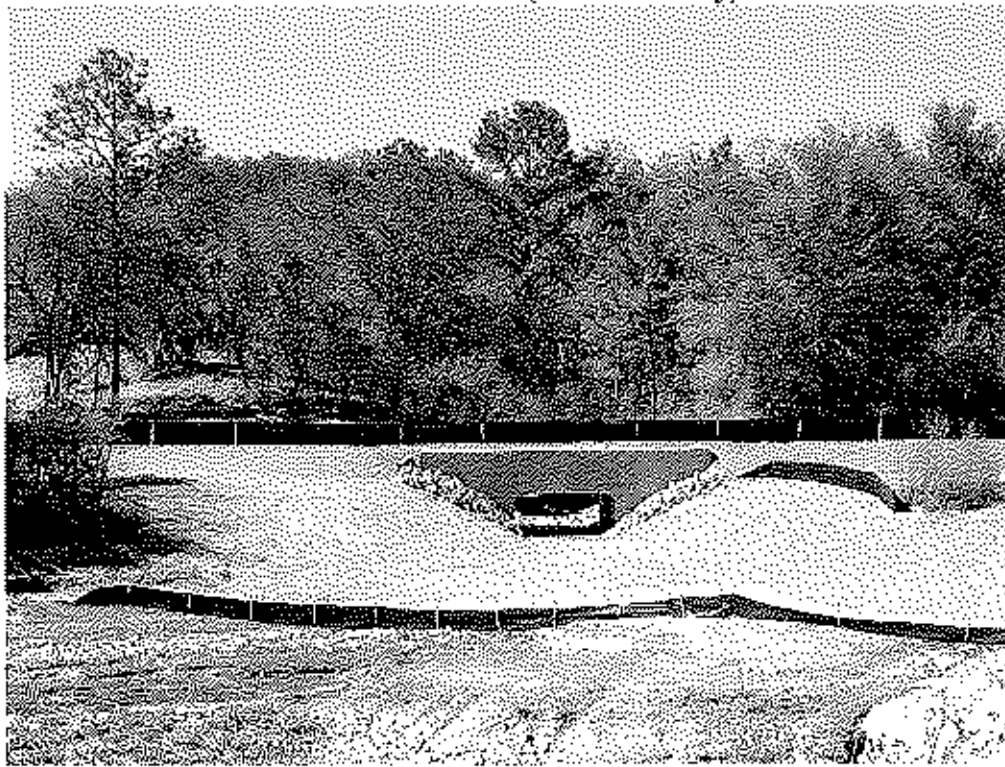

Culvert Construction at Powerline Pond (March 2007)

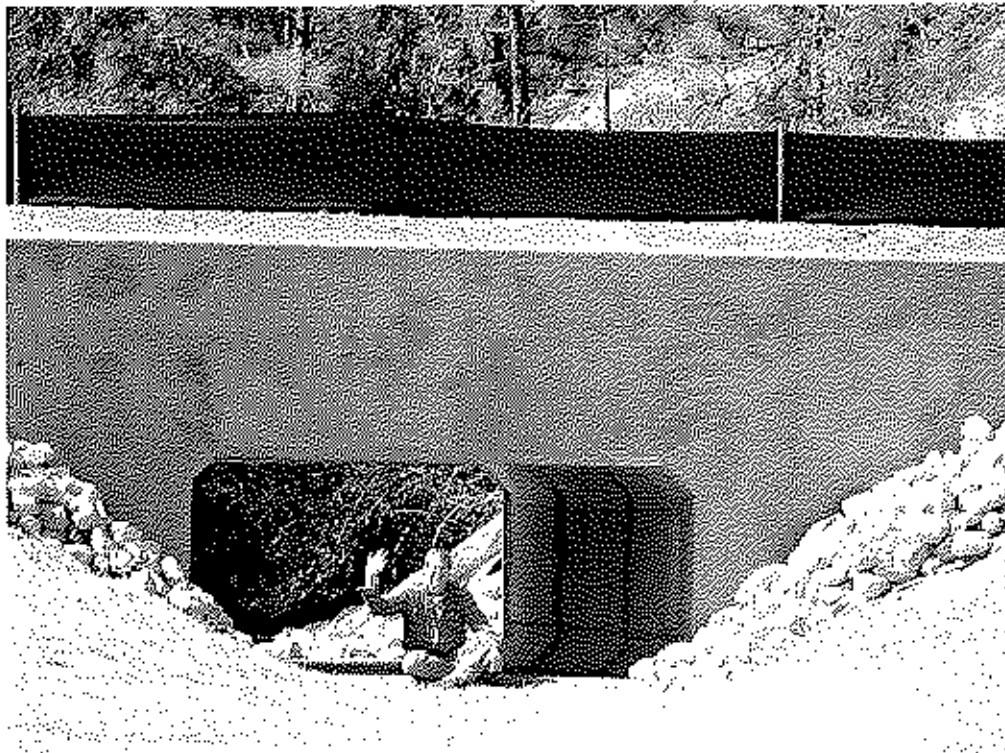

Completed Bridge at Pine Log Creek (April 2007)



Completed Culvert at Old Pine Log Creek Crossing (April 2007)



Culvert at Old Pine Log Creek (April 2007)



Boggy Branch Erosion Restoration Site #10 (February 2007)

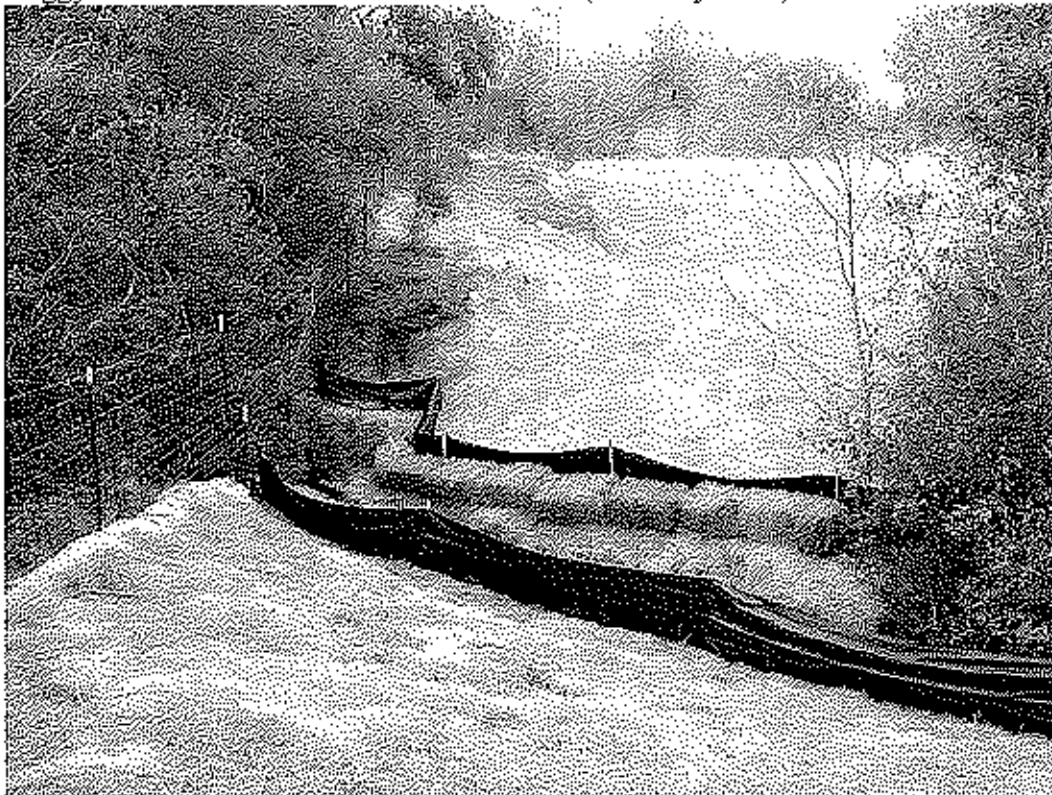

Cat Pond Erosion Restoration Sites #1 and #2 (February 2007)



Erosion Control Site #4 at Greenhead Branch March 2007



Erosion Control Site #7 at Greenhead Branch March 2007



Roadfill Removal Between Little Deep Edge and Greenhead Branch (March 2007)



Road Removal Between Little Deep Edge and Greenhead Branch March 2007



Road Removal Between Little Deep Edge and Greenhead Branch from Uplands



Road Removal Between Deep Edge and Little Deep Edge (February 2007)



Road Removal Between Deep Edge and little Deep Edge (February 2007)



Bridge Construction at Greenhead Branch (February 2007)



Bridge Construction at Greenhead Branch (February 2007)



Winter Burn in Management Unit 12 Adjacent to Greenhead Branch March 2007

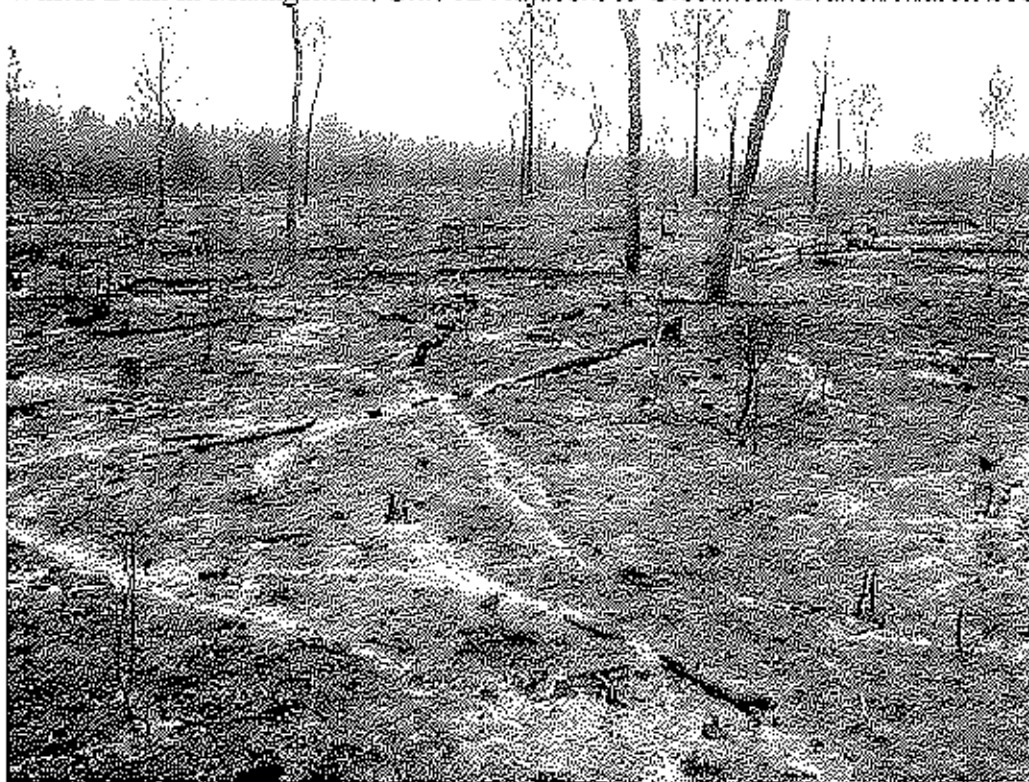

Winter Burn in Management Unit 12 Adjacent to Greenhead Branch March 2007

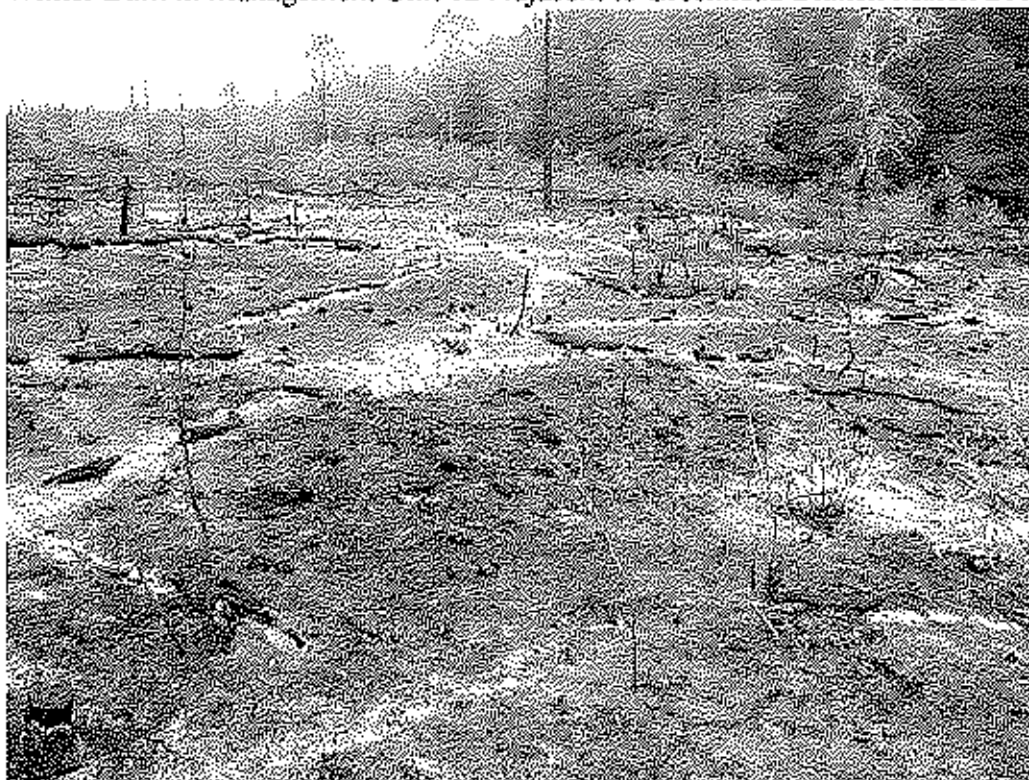

Appendix 3: Copies of Monthly Site Inspection

Site Inspection Field Form

Page 1 of 1

Name(s) of Data Collectors: David Clayton

Date: 1/23/07 Time: 9:30 am

On a monthly basis, the site will be inspected as follows:

Perimeter checked for signs of trespassing, fencing and signage integrity and infestation by exotic or nuisance vegetation;

Comments: None

Internal Roads (Both public and maintenance) checked for signs of dumping or trespassing, erosion, bridges and road integrity, and exotic or nuisance species infestations;

Comments: No dumping, erosion or trespass.

All construction areas checked for stabilization and re-vegetation, structure, operation, and integrity;

Comments: Stabilization of Greenhead branch bridge, placement of rye grass, and mulch...same for Dykes Mill Pond. Area around Dykes Mill Pond needs to be cleaned up. Talked to Tyler and site manager about this...follow up...the area was cleaned up. Silt fences in one area compromised around Dykes Mill pond...discussed with project manager...follow up...silt fences back in place...also at Pine Log Creek...silt fences down...no turbid water noted...area was dry...talked to site manager about repairing and replacing silt fences...follow up visit, areas were corrected. Bridge and culverts expected to be completed by middle of March.

Culvert removed from Greenhead branch.

Met with Don Walters and contractor that will be doing the erosion sites...and spelled out permit requirements including silt fences and turbidity barriers. Checked sites prior to work initiation. All silt fences properly installed and turbidity barriers in place. Areas will be stabilized soon after work complete...planting of long leaf pine and wire grass expected to occur on 2/23/07.

Powerline checked for trespassing or disturbance that may affect the integrity of the bank;

Comments: None

At least 3 polygons of each UMAM community evaluated or for those UMAM communities with less than three polygons, each UMAM polygon evaluated.

Comments:
See above.

Wildlife Observations: Chirping Sparrows, 8 Quail, Robin, 5 deer, Red-shouldered Hawk, Titmouse, coyote and dog tracks, Rufus Sided Towhee. Yellow jasmine, blue berry, innocence, wild olive and black ti ti in bloom.

Site Inspection Field Form

Page 1 of 1

Name(s) of Data Collectors: David Clayton

Date: 2/20/07 Time: 9:30 am

On a monthly basis, the site will be inspected as follows:

Perimeter checked for signs of trespassing, fencing and signage integrity and infestation by exotic or nuisance vegetation;

Comments: None

Internal Roads (Both public and maintenance) checked for signs of dumping or trespassing, erosion, bridges and road integrity, and exotic or nuisance species infestations;

Comments: No dumping, erosion or trespass.

All construction areas checked for stabilization and re-vegetation, structure, operation, and integrity;

Comments: Construction completed for Dykes Mill Pond, Green Head Branch Bridges, culverts almost completed for old Pine log creek, alternative flowpath for Pine log creek, and powerline pond. Most areas have been stabilized with rye grass and non invasive mulch. The erosion sites for Boggy Branch, Cat Pond and road removal for Deep Edge/Little Deep Edge have been completed and planted with wire grass and pine trees. Wetlands were planted with cypress.

Powerline checked for trespassing or disturbance that may affect the integrity of the bank;

Comments: None

At least 3 polygons of each UMAM community evaluated or for those UMAM communities with less than three polygons, each UMAM polygon evaluated.

Comments:

Construction continues on the installation of the bridges and culverts. The silt fences were inspected. Assisted in a fuel reduction burn surrounding Deep Edge and Little Deep Edge...this area had the oaks thinned and this area was burned to reduce the cover of the downed trees. This was a good fuel reduction fire and the first of several planned for this area this spring. Took lots of photographs.

Wildlife Observations: Blue jay, tufted titmouse, crow, deer tracks, coyote scat, raccoon tracks.

Site Inspection Field Form

Page 1 of 1

Name(s) of Data Collectors: David Clayton

Date: 3/15/07 Time: 10:30 am

On a monthly basis, the site will be inspected as follows:

Perimeter checked for signs of trespassing, fencing and signage integrity and infestation by exotic or nuisance vegetation;

Comments: None

Internal Roads (Both public and maintenance) checked for signs of dumping or trespassing, erosion, bridges and road integrity, and exotic or nuisance species infestations;

Comments: No dumping, erosion or trespass.

All construction areas checked for stabilization and re-vegetation, structure, operation, and integrity;

Comments: Construction completed for Dykes Mill Pond, Green Head Branch Bridges, culverts almost completed for old Pine log creek, alternative flowpath for Pine log creek, and powerline pond. Most areas have been stabilized with rye grass and non invasive mulch. The erosion sites for Boggy Branch, Cat Pond and road removal for Deep Edge/Little Deep Edge have been completed and planted with wire grass and pine trees...wetlands were planted with cypress. Bahia grass seed, stems and leaves were observed at Boggy Branch, Deep Edge Road Removal and the two erosion areas at Cat Pond. Mulch contaminated with Bahia grass seed was placed in these areas. The contractor, Orange Hill Soil and Conservation District was informed and agreed to herbicide any Bahia grass plants that were found within the restored areas for as long as it takes to control the Bahia grass. Any wire grass or cypress trees damaged by the herbicide will be re-planted.

Powerline checked for trespassing or disturbance that may affect the integrity of the bank;

Comments: None

At least 3 polygons of each UMAM community evaluated or for those UMAM communities with less than three polygons, each UMAM polygon evaluated.

Comments:

Construction continues on the installation of the bridges and culverts. The silt fences were inspected.

Wildlife Observations: Blue jay, tufted titmouse, possum tracks, rabbit tracks.

Site Inspection Field Form

Page 1 of 1

Name(s) of Data Collectors: David Clayton

Date: 4/9/07 Time: 10:00 am

On a monthly basis, the site will be inspected as follows:

Perimeter checked for signs of trespassing, fencing and signage integrity and infestation by exotic or nuisance vegetation;

Comments: None

Internal Roads (Both public and maintenance) checked for signs of dumping or trespassing, erosion, bridges and road integrity, and exotic or nuisance species infestations;

Comments: No dumping, erosion or trespass.

All construction areas checked for stabilization and re-vegetation, structure, operation, and integrity;

Comments: Construction completed for Dykes Mill Pond, Green Head Branch Bridges, culverts almost completed for old Pine log creek, alternative flowpath for Pine log creek, and powerline pond. Guard rails and signs have been installed. Rye grass dying due to drought. Alternative seed source needed when rains finally start. Gyro-track work well underway.

Powerline checked for trespassing or disturbance that may affect the integrity of the bank;

Comments: None

At least 3 polygons of each UMAM community evaluated or for those UMAM communities with less than three polygons, each UMAM polygon evaluated.

Comments: Spent 5 days flagging for Gyro-track. Need to GPS completed polygons. Removal of all shrubs within the polygons required. It is amazing how different these areas look. Will burn areas this fall.

Wildlife Observations: Blue jay, black racer, sliders, alligator, deer

Site Inspection Field Form

Page 1 of 1

Name(s) of Data Collectors: David Clayton

Date: 5/07/07 Time: 11:00 am

On a monthly basis, the site will be inspected as follows:

Perimeter checked for signs of trespassing, fencing and signage integrity and infestation by exotic or nuisance vegetation;

Comments: None

Internal Roads (Both public and maintenance) checked for signs of dumping or trespassing, erosion, bridges and road integrity, and exotic or nuisance species infestations;

Comments: No dumping, erosion or trespass.

All construction areas checked for stabilization and re-vegetation, structure, operation, and integrity;

Comments: Gyro-track work nearly completed for wet pine flatwood adjacent to Dry Pond...51 acres, an additional area behind the planted pine, and about half of the peninsula. Additional areas need flagging in the near future adjacent to the green ponds. This wet flatwood area was supposed to be burned last winter but heavy fuel loads prevented burning. Hopefully gyro-tracking will reduce cover sufficiently to prevent the fire from getting out of control.

Powerline checked for trespassing or disturbance that may affect the integrity of the bank;

Comments: None

At least 3 polygons of each UMAM community evaluated or for those UMAM communities with less than three polygons, each UMAM polygon evaluated.

Comments: Spent 3 additional days flagging for Gyro-track. The Bank is extremely dry. Powerline pond completely dry as well as Garret Pond. Some green ponds also completely dry. Nearly all of Little Deep Edge pond is dry. The rookery this year has been abandoned probably due to the lack of water surrounding the shrub islands. This is the driest I have ever seen the ponds at the bank.

Wildlife Observations: Deer tracks, coyote tracks