



REPLY TO
ATTENTION OF

DEPARTMENT OF THE ARMY
JACKSONVILLE DISTRICT CORPS OF ENGINEERS
400 HIGH POINT DRIVE, SUITE 600
COCOA, FLORIDA 32926

August 20, 2012

429296-1
FLOR

Cocoa Permits Section
SAJ-2012-00414 (NW-AWP)

RECEIVED

SEP - 5 2012

ENVIRONMENTAL MANAGEMENT
OFFICE

Florida Department of Transportation, District 3
Attn: Joy Giddens
1074 Highway 90
Chipley, FL 32428

Dear Mrs. Giddens:

Reference is made to your request received August 8, 2012, in which you requested re-verification of Department of the Army Nationwide verification dated April 16, 2012, assigned number SAJ-2012-00414. This verification will supersede the verification provided to you April 16, 2012. A review of the information and drawings provided shows the proposed work is to permanently impact 0.002 acre and temporarily impact 0.017 acre of wetlands and waters of the United States associated with the replacement of eroded riprap with gabion mats to fortify the approach of an existing vehicular bridge. The project is located at State Road 30 (U.S. Highway 98) over Turkey Bayou, in Panacea, Franklin County, Florida, Latitude: 29.91731° North, Longitude: 84.51203° West.

Your project, as depicted on the received drawings, is authorized by Nationwide Permit (NWP) Number 14. In addition, project specific conditions have been enclosed. This verification is valid until August 20, 2014. Please access the U.S. Army Corps of Engineers' (Corps) Jacksonville District's Regulatory webpage to access web links to view the Final Nationwide Permits, Federal Register Vol. 77, dated February 21, 2012, specifically pages 10270 – 10290, the Corrections to the Final Nationwide Permits, Federal Register 77, March 19, 2012, and the List of Regional Conditions. The website address is as follows:

<http://www.saj.usace.army.mil/Divisions/Regulatory/sourcebook.htm>.

Please be aware this web address is case sensitive and should be entered as it appears above. Once there you will need to click on "Nationwide Permits." These files contain the description of the Nationwide Permit authorization, the Nationwide Permit general conditions, and the regional conditions, which apply specifically to this verification for NWP 14. Enclosed is a list of the six General Conditions, which apply to all Department of the Army authorizations. You must comply with all of the special and general conditions and any project specific condition of this authorization or you may be subject to enforcement action. In the event you have not completed construction of your project within the specified time limit, a separate application or re-verification may be required.

The following special conditions are included with this verification:

1. Within 60 days of completion of the work authorized, the attached "Self-Certification Statement of Compliance" must be completed and submitted to the U.S. Army Corps of Engineers. Mail the completed form to the Regulatory Division, Enforcement Section, Mr. Terry Wells, 41 North Jefferson St., Suite 111, Pensacola, FL 32502.

2. The Permittee understands and agrees that, if future operations by the United States require the removal, relocation, or other alteration, of the structures or work herein authorized, or if, in the opinion of the Secretary of the Army or his authorized representative, said structure or work shall cause unreasonable obstruction to the free navigation of the navigable waters, the Permittee will be required, upon due notice from the U.S. Army Corps of Engineers, to remove, relocate, or alter the structural work or obstructions caused thereby, without expense to the United States. No claim shall be made against the United States on account of any such removal or alteration.

3. Cultural Resources/Historic Properties:

a. No structure or work shall adversely affect impact or disturb properties listed in the National Register of Historic Places (NRHP) or those eligible for inclusion in the NRHP.

b. If during the ground disturbing activities and construction work within the permit area, there are archaeological/cultural materials encountered which were not the subject of a previous cultural resources assessment survey (and which shall include, but not be limited to: pottery, modified shell, flora, fauna, human remains, ceramics, stone tools or metal implements, dugout canoes, evidence of structures or any other physical remains that could be associated with Native American cultures or early colonial or American settlement), the Permittee shall immediately stop all work in the vicinity and notify the Corps. The Corps shall then notify the Florida State Historic Preservation Officer (SHPO) and the appropriate Tribal Historic Preservation Officer(s) (THPO(s)) to assess the significance of the discovery and devise appropriate actions.

c. A cultural resources assessment may be required of the permit area, if deemed necessary by the SHPO, THPO(s), or Corps, in accordance with 36 CFR 800 or 33 CFR 325, Appendix C (5). Based, on the circumstances of the discovery, equity to all parties, and considerations of the public interest, the Corps may modify, suspend or revoke the permit in accordance with 33 CFR Part 325.7. Such activity shall not resume on non-federal lands without written authorization from the SHPO and the Corps.

d. In the unlikely event that unmarked human remains are identified on non-federal lands, they will be treated in accordance with Section 872.05 Florida Statutes. All work in the vicinity shall immediately cease and the Permittee shall immediately notify the medical examiner, Corps,

and State Archeologist. The Corps shall then notify the appropriate SHPO and THPO(s). Based, on the circumstances of the discovery, equity to all parties, and considerations of the public interest, the Corps may modify, suspend or revoke the permit in accordance with 33 CFR Part 325.7. Such activity shall not resume without written authorization from the State Archeologist, SHPO and the Corps.

e. In the unlikely event that human remains are encountered on federal or tribal lands, or in situations where Archaeological Resources Protection Act of 1979, or Native American Graves Protection Repatriation Act of 1990 applies, all work in the vicinity shall immediately cease and the Permittee immediately notify the Corps. The Corps shall then notify the appropriate THPO(s) and SHPO. Based, on the circumstances of the discovery, equity to all parties, and considerations of the public interest, the Corps may modify, suspend or revoke the permit in accordance with 33 CFR Part 325.7. After such notification, project activities on federal lands shall not resume without written authorization from the Corps, and/or appropriate THPO(s), SHPO, and federal manager. After such notification, project activities on tribal lands shall not resume without written authorization from the appropriate THPO(s) and the Corps.

4. This letter of authorization does not obviate the necessity to obtain any other Federal, State, or local permits, which may be required. Prior to the initiation of any construction, projects qualifying for this Nationwide permit must qualify for an exemption under section 403.813(1), F.S. or 373.406, F.S., or otherwise be authorized by the applicable permit required under Part IV of Chapter 373, F.S., by the Department of Environmental Protection, a water management district under section 373.069, F.S., or a local government with delegated authority under section 373.441, F.S., and receive Water Quality Certification (WQC) and applicable Coastal Zone Consistency Concurrence (CZCC) or waiver thereto, as well as any authorizations required for the use of state-owned submerged lands under Chapter 253, F.S., and, as applicable, Chapter 258, F.S. You should check State-permitting requirements with the Florida Department of Environmental Protection or the appropriate water management district.

This letter of authorization does not include conditions that would prevent the 'take' of a state-listed fish or wildlife species. These species are protected under sec. 379.411, Florida Statutes, and listed under Rule 68A-27, Florida Administrative Code. With regard to fish and wildlife species designated as species of special concern or threatened by the State of Florida, you are responsible for coordinating directly with the Florida Fish and Wildlife Conservation Commission (FWC). You can visit the FWC license and permitting webpage (<http://www.myfwc.com/license/wildlife/>) for more information, including a list of those fish and wildlife species designated as species of special concern or threatened. The Florida Natural Areas Inventory (<http://www.fnai.org/>) also maintains updated lists, by county, of documented occurrences of those species.

5. Prior to the initiation of any work authorized by this permit, the Permittee shall install erosion control measures along the perimeter of all work areas to prevent the displacement of fill material outside the work area. Immediately after completion of the final grading of the land surface, all slopes, land surfaces, and filled areas shall be stabilized using sod, degradable mats, barriers, or a combination of similar stabilizing materials to prevent erosion. The erosion control measures shall remain in place and be maintained until all authorized work has been completed and the site has been stabilized.

6. The Permittee shall use only clean fill material for this project. The fill material shall be free from items such as trash, debris, automotive parts, asphalt, construction materials, concrete block with exposed reinforcement bars, and soils contaminated with any toxic substance, in toxic amounts in accordance with Section 307 of the Clean Water Act.

7. Should any other regulatory agency require changes to the work authorized or obligated by this permit, the Permittee is advised that a modification to this permit instrument is required prior to initiation of those changes. It is the Permittee's responsibility to request a modification of this letter of authorization from the Cocoa Regulatory Office.

This letter of authorization does not give absolute Federal authority to perform the work as specified on your application. The proposed work may be subject to local building restrictions mandated by the National Flood Insurance Program. You should contact your local office that issues building permits to determine if your site is located in a flood-prone area, and if you must comply with the local building requirements mandated by the National Flood Insurance Program.

If you are unable to access the internet or require a hardcopy of any of the conditions, limitations, or expiration date for the above referenced NWP, please contact Andrew Phillips by telephone at 321-504-3771, extension 14

Thank you for your cooperation with our permit program. The Corps Jacksonville District Regulatory Division is committed to improving service to our customers. We strive to perform our duty in a friendly and timely manner while working to preserve our environment. We invite you to take a few minutes to visit <http://per2.nwp.usace.army.mil/survey.html> and complete our automated Customer Service Survey. Your input is appreciated – favorable or otherwise. Again, please be aware this web address is case sensitive and should be entered as it appears above.

Sincerely,

A handwritten signature in black ink, appearing to read "Irene Sadowski", with a large, stylized flourish at the end.

Irene Sadowski
Chief, Cocoa Permits Section

Enclosures

Copy Furnished:

H.W. Lochner, Inc.
Attn: Kevin Connor
13577 Feather Sound Drive, Suite 600
Clearwater, FL 33762

GENERAL CONDITIONS

33 CFR PART 320-330

PUBLISHED FEDERAL REGISTER DATED 13 NOVEMBER 1986

1. The time limit for completing the work authorized ends on **August 20, 2014**. If you find that you need more time to complete the authorized activity, submit your request for a time extension to this office for consideration at least one month before the above date is reached.
2. You must maintain the activity authorized by this permit in good condition and in conformance with the terms and conditions of this permit. You are not relieved of this requirement if you abandon the permitted activity, although you may make a good faith transfer to a third party in compliance with General Condition 4 below. Should you wish to cease to maintain the authorized activity or should you desire to abandon it without a good faith transfer, you must obtain a modification of this permit from this office, which may require restoration of the area.
3. If you discover any previously unknown historic or archeological remains while accomplishing the activity authorized by this permit, you must immediately notify this office of what you have found. We will initiate the Federal and state coordination required to determine if the remains warrant a recovery effort or if the site is eligible for listing in the National Register of Historic Places.
4. If you sell the property associated with this permit you must obtain the signature of the new owner in the space provided and forward a copy of the permit to this office to validate the transfer of this authorization.
5. If a conditioned water quality certification has been issued for your project, you must comply with the conditions specified in the certification as special conditions to this permit. For your convenience, a copy of the certification is attached if it contains such conditions.
6. You must allow a representative from this office to inspect the authorized activity at any time deemed necessary to ensure that it is being or has been accomplished in accordance with the terms and conditions of your permit.

SELF-CERTIFICATION STATEMENT OF COMPLIANCE

Permit Number: NW-14

Application Number: SAJ-2012-00414

Permittee's Name & Address (please print or type): _____

Telephone Number: _____

Location of the Work: _____

Date Work Started: _____ Date Work Completed: _____

Description of the Work (e.g., bank stabilization, residential or commercial filling, docks, dredging, etc.): _____

Acreeage or Square Feet of Impacts to Waters of the United States:

Describe Mitigation completed (if applicable): _____

Describe any Deviations from Permit (attach drawing(s) depicting the deviations): _____

I certify that all work, and mitigation (if applicable) was done in accordance with the limitations and conditions as described in the permit. Any deviations as described above are depicted on the attached drawing(s).

Signature of Permittee

Date

DEPARTMENT OF THE ARMY PERMIT TRANSFER REQUEST

PERMIT NUMBER: SAJ-2012-00414 (NW-AWP)

When the structures or work authorized by this permit are still in existence at the time the property is transferred, the terms and conditions of this permit will continue to be binding on the new owner(s) of the property. Although the construction period for works authorized by Department of the Army permits is finite, the permit itself, with its limitations, does not expire.

To validate the transfer of this permit and the associated responsibilities associated with compliance with its terms and conditions, have the transferee sign and date below and mail to the U.S. Army Corps of Engineers, Enforcement Section, Post Office Box 4970, Jacksonville, FL 32232-0019.

(TRANSFEEE-SIGNATURE)

(SUBDIVISION)

(DATE)

(LOT)

(BLOCK)

(NAME-PRINTED)

(STREET ADDRESS)

(MAILING ADDRESS)

(CITY, STATE, ZIP CODE)

CONSTRUCTION CONTRACT NO. E3K46



STATE OF FLORIDA
DEPARTMENT OF TRANSPORTATION

CONTRACT PLANS

FINANCIAL PROJECT ID 429296-1-52-01

FRANKLIN COUNTY (49040)

STATE ROAD NO. 30

STRUCTURE PLANS

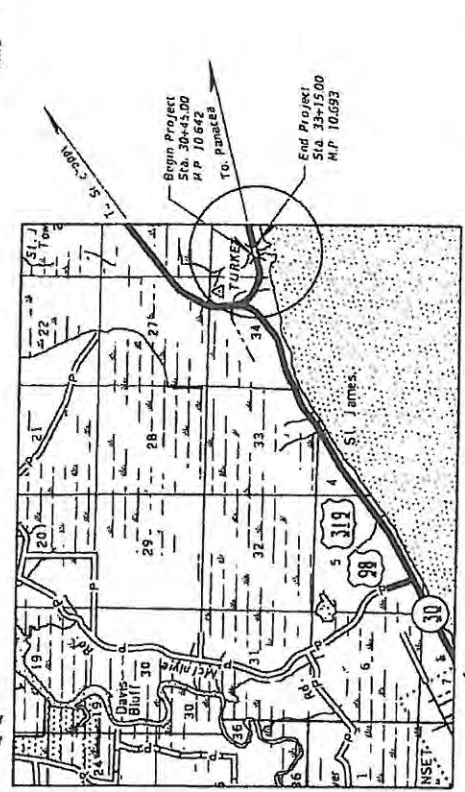

STRUCTURE SHOP DRAWINGS TO BE SUBMITTED TO
WILLIAM D. BURTON
FL. P.E. NO. 62803
H.W. LOCHNER, INC.
2940 EAST PARK AVENUE,
SUITE 200
TALLAHASSEE, FL 32301
TELEPHONE: (850) 656 8027

PLANS PREPARED BY:
H.W. LOCHNER, INC.
2940 EAST PARK AVENUE,
SUITE 200
TALLAHASSEE, FL 32301
TELEPHONE: (850) 656 8027
CONTRACT NUMBER: C-9109
PERSON NUMBER: 7633308101
AUTHORIZATION NO. 884

NOTE THE SCALE OF THESE PLANS MAY HAVE CHANGED DUE TO REPRODUCTION

INDEX OF STRUCTURE PLANS

SHEET NO.	SHEET DESCRIPTION
B-1	BRIDGE NET SHEET
B1-1	SUMMARY OF PAY ITEMS
B1-2	GENERAL NOTES (1 OF 2)
B1-3	GENERAL NOTES (2 OF 2)
B1-4	PLAN
B1-5	SECTIONS
B1-6	PROSITY CONTROL PLAN
B1-7	WETLAND IMPACTS
BX1-1 - BX1-4	EXISTING BRIDGE SHEETS



GOVERNING STANDARDS & SPECIFICATIONS:
FLORIDA DEPARTMENT OF TRANSPORTATION,
DESIGN STANDARDS DATED 2010,
AND STANDARD SPECIFICATIONS FOR ROAD AND
BRIDGE CONSTRUCTION DATED 2010,
AS AMENDED BY CONTRACT DOCUMENTS

APPLICABLE DESIGN STANDARDS & SPECIFICATIONS, 01-01-2012
For Design Standards and Specifications, click on "Design Standard,"
at the following web site: <http://www.dot.state.fl.us/roads/design/>

FOR PERMIT ONLY
NOT FOR CONSTRUCTION

DATE	DESCRIPTION

ROADWAY	LINEAR FT.	MILES
	270.00	0.051
NET LENGTH OF PROJ.	270.00	0.051
GROSS LENGTH OF PROJ.	270.00	0.051

STRUCTURE P.L. NO. 490033
ENGINEER OF RECORD: WILLIAM D. BURTON
P.E. NO. 62803

FDOT PROJECT MANAGER: BILL HOWELL, ATKINS

100% PLAN SET

Coastal Protection repair on Bridge No. 490033,
SR 30 (US 98) over Turkey Bayou.

NOTICE: THE OFFICIAL RECORD OF THIS SHEET IS THE ELECTRONIC FILE SIGNATURE AND SEALED UNDER RULE 61G15.23, 23. F.A.C.

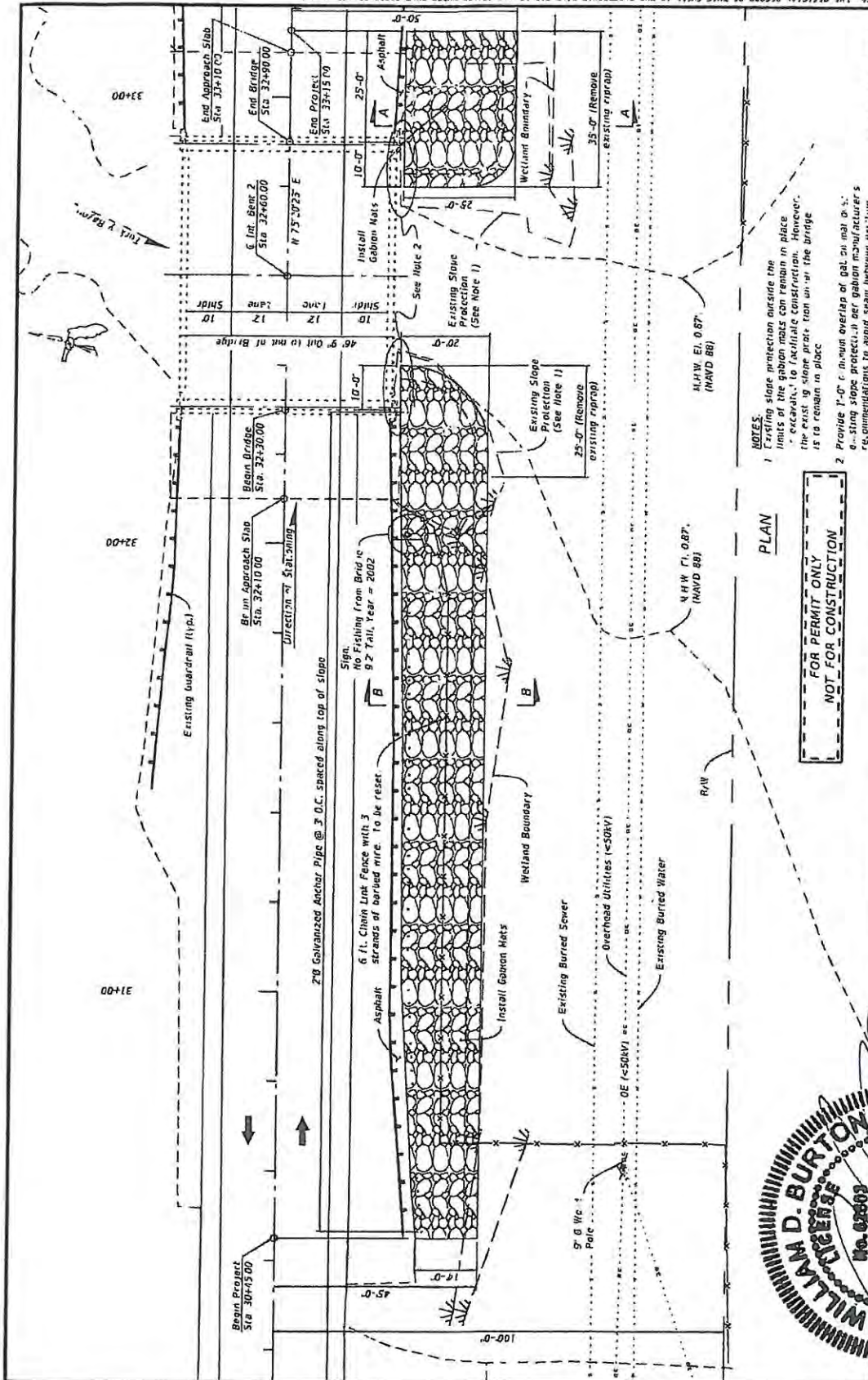

PLAN

- NOTES**
- Existing slope protection outside the limits of the gabion mats shall remain in place except as to facilitate construction. However, the existing slope protection shall be removed and new protection is to remain in place.
 - Provide 1'-0" minimum overlap of gabion mats at all existing slope protection. Use gabion manufacturer's recommendations to avoid seam between existing and new protection.

FOR PERMIT ONLY
NOT FOR CONSTRUCTION

LOCHNER		STATE OF FLORIDA	
2940 East Park Avenue, Suite 200 Tallahassee, FL 32301 FBBP Certificate of Auth. # 894 William D. Burton, P.E. #62803		DEPARTMENT OF TRANSPORTATION	
PROJECT NO.	SR 30	COUNTY	FRANKLIN
DRAWN BY	SR 30	UNDESIGNED	429236-1-92-01
CHECKED BY	SR 30	DATE	1/10/12
BRIDGE No. 490030		SR 30 (US 98) OVER TURKEY BAYOU	

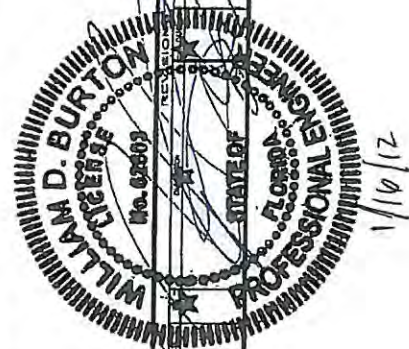

NOTE:
Excavate existing top of slope to 15' depth to ensure top of gabion toe support is even with existing slope.

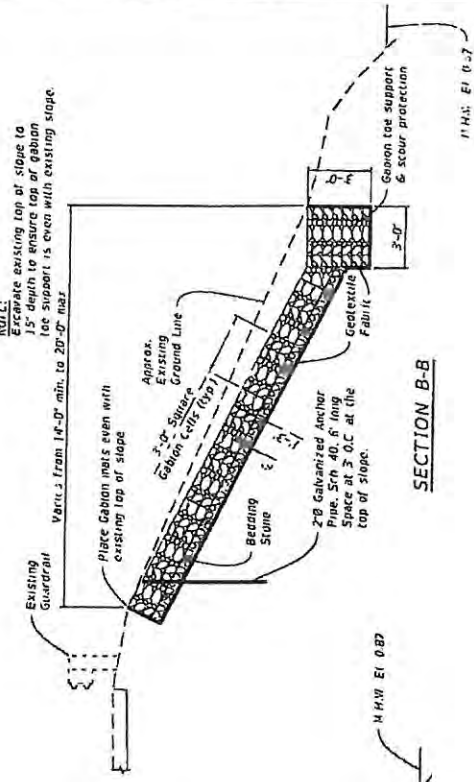

SECTION B-B

NOTE:
Excavate existing top of slope to 15' depth to ensure top of gabion toe support is even with existing slope.

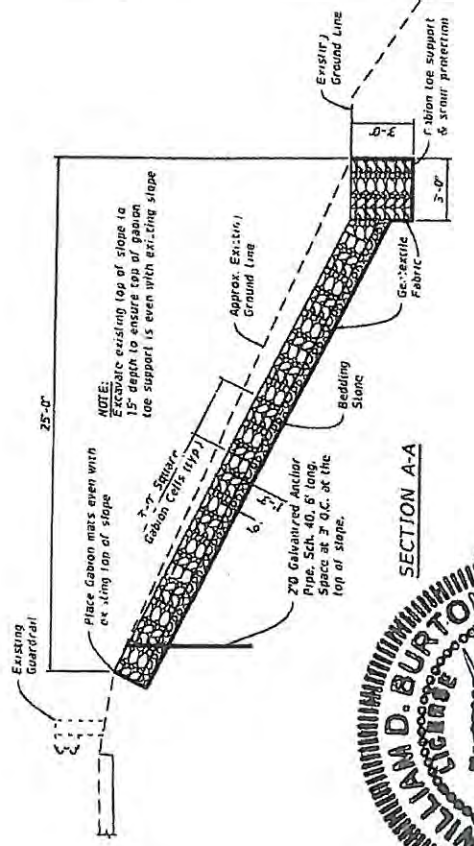

SECTION A-A

FOR PERMIT ONLY
NOT FOR CONSTRUCTION

BRIDGE No. 490030		SECTION	
SR 30 (US 98) OVER TURKEY BAYOU		SR 30 (US 98) OVER TURKEY BAYOU	
DATE: 11/16/12		DATE: 11/16/12	
DRAWN BY: [Signature]		DRAWN BY: [Signature]	
CHECKED BY: [Signature]		CHECKED BY: [Signature]	
DESIGNED BY: [Signature]		DESIGNED BY: [Signature]	
APPROVED BY: [Signature]		APPROVED BY: [Signature]	
PROJECT NO. SR 30		PROJECT NO. SR 30	
PROJECT NAME		PROJECT NAME	
STATE OF FLORIDA		STATE OF FLORIDA	
DEPARTMENT OF TRANSPORTATION		DEPARTMENT OF TRANSPORTATION	
TALLAHASSEE, FL 32304		TALLAHASSEE, FL 32304	
2840 East Park Avenue, Suite 200		2840 East Park Avenue, Suite 200	
Tallahassee, FL 32304		Tallahassee, FL 32304	
FPRS Certificate of Auth. # 884		FPRS Certificate of Auth. # 884	
William D. Burton, P.E. #62803		William D. Burton, P.E. #62803	



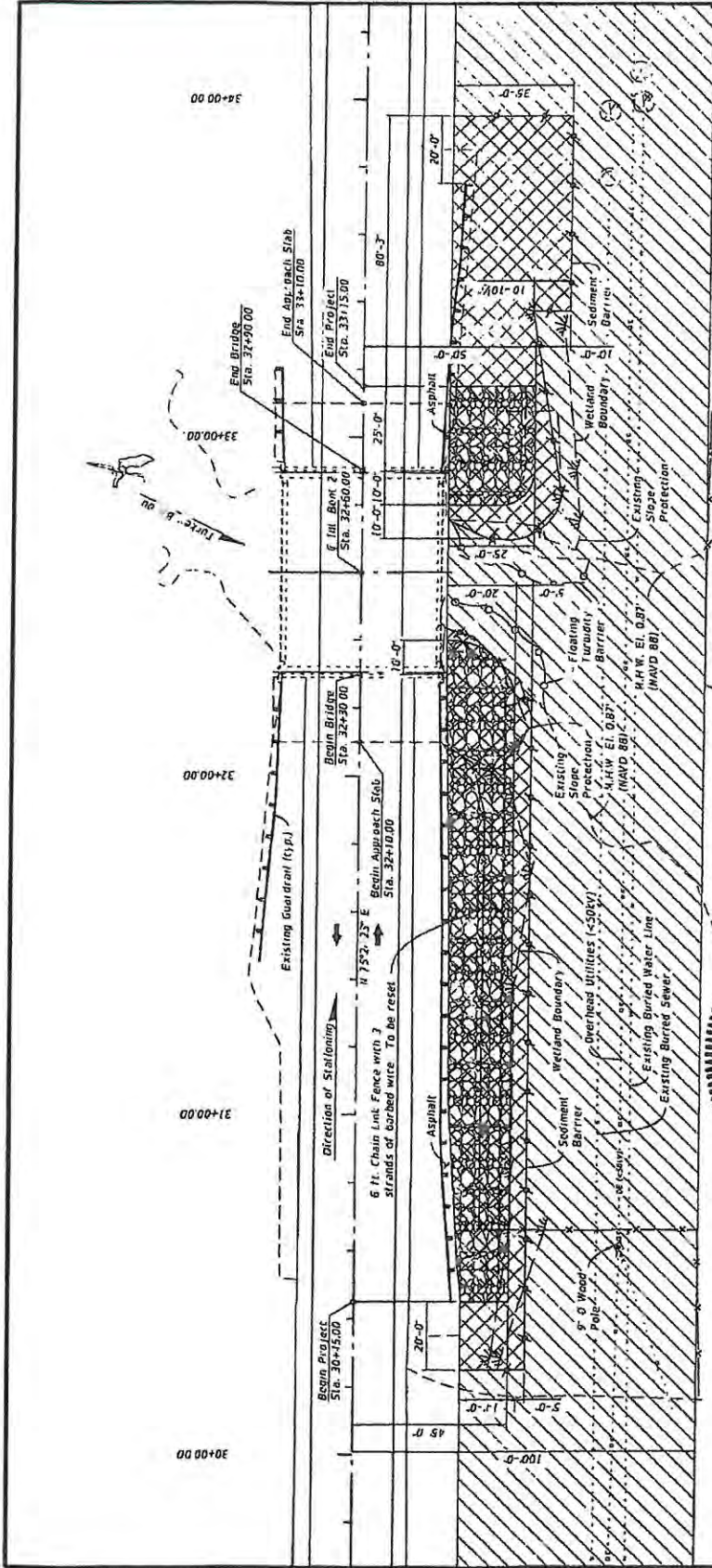

EROSION CONTROL PLAN

FOR PERMIT ONLY
NOT FOR CONSTRUCTION

STATE OF FLORIDA DEPARTMENT OF TRANSPORTATION DISTRICT 30 SR 30 (US 98) OVER TURKEY BAYOU		BRIDGE No. 490030 1/10/12	
PROJECT NO. 424,296-1-52-01	DRAWING NO. SR 30	DATE 1/10/12	SHEET NO. 11-6
ENGINEER WILLIAM D. BURTON 2540 East Park Avenue, Suite 200 Jacksonville, FL 32209 FERRIS CONSULTANTS, INC. William D. Burton, P.E. REG2803		CONTRACT NO. 424,296-1-52-01	
REVISIONS DATE BY	PROJECT LOCATION SR 30 (US 98) OVER TURKEY BAYOU		



Construction Activities NOT Allowed

Construction Activities Allowed

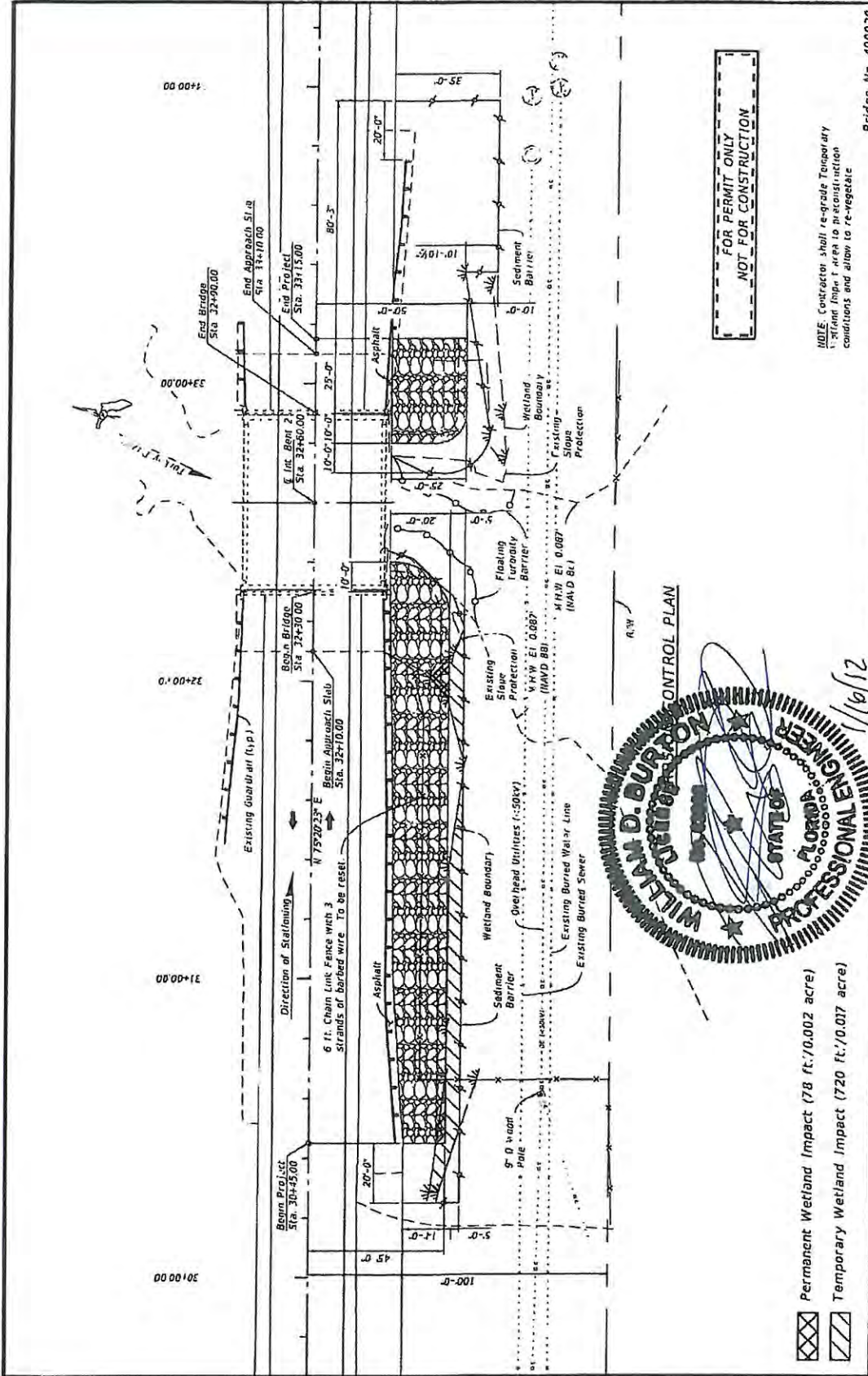

FOR PERMIT ONLY
NOT FOR CONSTRUCTION

NOTE: Contractor shall re-grade Temporary Wetland Slips when to preconstruction conditions and allow to re-vegetate.



Permanent Wetland Impact (78 ft./0.002 acre)
Temporary Wetland Impact (720 ft./0.017 acre)

BRIDGE No. 490030	
STATE OF FLORIDA	WETLAND IMPACTS
DEPARTMENT OF TRANSPORTATION	SR 30 (US 98) OVER TURKEY BAYOU
COUNTY	FRANKLIN
PROJECT NO.	479286-1-52-01
DATE	11-2012
SCALE	AS SHOWN
DESIGNED BY	WILLIAM D. BURDICK
CHECKED BY	WILLIAM D. BURDICK
DATE	11-2012
PROJECT NO.	479286-1-52-01
BRIDGE NO.	490030
SECTION	RI-1



Photograph 3 – South side of East approach (facing East)



Photograph 4 – South side of East approach (facing East)

**SR 30 (US 98) over Turkey Bayou (Bridge No. 490030)
Franklin County, FM No. 429296-1-52-01**



Photograph 1 – South side of West approach (facing West)



Photograph 2 – South side of West approach (facing West)

**SR 30 (US 98) over Turkey Bayou (Bridge No. 490030)
Franklin County, FM No. 429296-1-52-01**