

FOR PERMIT USE ONLY

STATE OF FLORIDA
DEPARTMENT OF TRANSPORTATION

CONTRACT PLANS

FINANCIAL PROJECT ID 220773-7-52-01
WASHINGTON COUNTY (61040)
STATE ROAD NO. 79

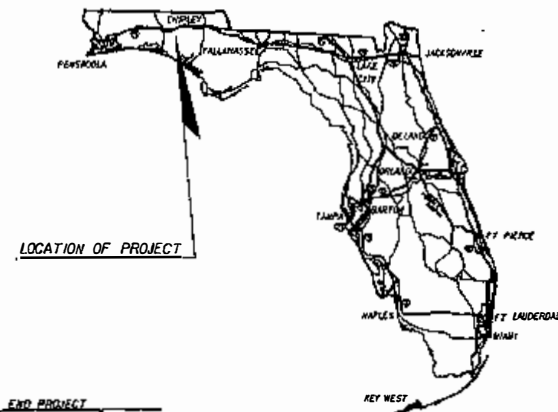

LOCATION OF PROJECT

COMPONENTS OF CONTRACT PLANS SET

ROADWAY PLANS
STRUCTURE PLANS

A DETAILED INDEX APPEARS ON THE
KEY SHEET OF EACH COMPONENT

INDEX OF ROADWAY PLANS

SHEET NO.	SHEET DESCRIPTION
1	KEY SHEET
2	FLOOD DATA
3 - 6	DRAINAGE MAP
7 - 9	TYPICAL SECTION
10	TYPICAL SECTION SPECIAL DETAILS
10A	OPTIONAL MATERIALS TABULATION
11	GENERAL NOTES
12	REFERENCE POINTS
13 - 19	PLAN-PROFILE
21 - 26	SPECIAL DITCH PROFILES
27 - 48	DRAINAGE STRUCTURES
49 - 50	OUTLET CONTROL STRUCTURE SKIMMER DETAILS
51 - 59	POND DETAILS
60	POND SOIL SURVEY POND 4
61 - 67	POND BORINGS
68 - 70	REPORT OF EMBANKMENT CORE BORINGS
71 - 76	REPORT OF CORE BORINGS EMBANKMENT
77 - 84	PLAN-PROFILE OUTFALL PIPE
85 - 130	CROSS SECTIONS
131 - 132	STORMWATER POLLUTION PREVENTION PLAN
133 - 143	EROSION CONTROL PLAN
144 - 146	WETLAND DELINEATION
147	TCP - TYPICAL SECTIONS AND PHASING NOTES

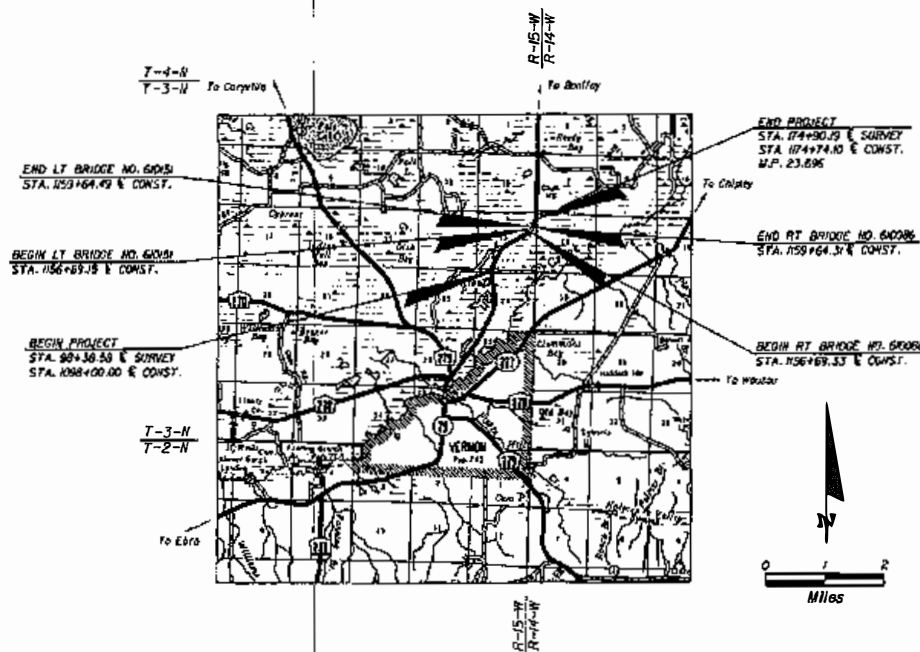

STRUCTURES SHOP DRAWINGS
TO BE SUBMITTED TO:
TIMOTHY J. FARRELL, P.E.
E. C. DRIVER & ASSOCIATES
500 N. WESTSHORE BLVD., SUITE 500
TAMPA, FL 33609
(813) 282-9886

ROADWAY SHOP DRAWINGS
TO BE SUBMITTED TO:
DONALD S. PADGETT, P.E.
E. C. DRIVER & ASSOCIATES
1983 CENTRE POINTE BLVD., SUITE 104
TALLAHASSEE, FL 32308-7823
(850) 893-6148

PLANS PREPARED BY:

ECDriver

1983 CENTRE POINTE BLVD., SUITE 104
TALLAHASSEE, FL 32308-7823
(850) 893-6148
CERTIFICATE OF AUTHORIZATION #3838
VENDOR NUMBER 59-237505
CONTRACT NUMBER C-6127

NOTE: THE SCALE OF THESE PLANS MAY
VARY FROM THE SCALE OF THE PROJECT.

JUL 11 2012

ROADWAY PLANS
ENGINEER OF RECORD: Donald S. Padgett, P.E.

P.E. NO. 53201

FISCAL YEAR	SHEET NO.
12	1

NOTES: THE OFFICIAL RECORD OF THIS SHEET IS THE ELECTRONIC FILE STORED AND SEALED UNDER RULE 68B-03.003, F.A.C.

WING STANDARDS AND SPECIFICATIONS:
DA DEPARTMENT OF TRANSPORTATION,
H STANDARDS DATED 2006,
STANDARD SPECIFICATIONS FOR ROAD AND
E CONSTRUCTION DATED 2006,
ISSUED BY CONTRACT DOCUMENTS.

TABLE DESIGN STANDARDS MODIFICATIONS: 01/01/12
Design Standards Modifications click on
n Standards at the following web site:
http://www.dot.state-fl.us/rdosnap/



PROJECT LENGTH IS BASED ON E CONST. AND LT BRIDGE

LENGTH OF PROJECT		
	LINEAR FEET	MILES
ROADWAY	7,674.10	1.453
BRIDGES	295.34	0.056
NET LENGTH OF PROJECT	7,378.76	1.397
EXCEPTIONS	N/A	N/A
GROSS LENGTH OF PROJECT	7,378.76	1.397

FDOT PROJECT MANAGER: William Barber, P.E.

KEY SHEET REVISIONS		
DATE	BY	DESCRIPTION

SR 79 FROM CR 279 TO NORTH OF CYPRESS CREEK BRIDGE

U.S. Army Corps of Engineers
Permit # SAJ-2012-03021
Date: March 1, 2013
Drawing 1 of 28

FOR PERMIT USE ONLY

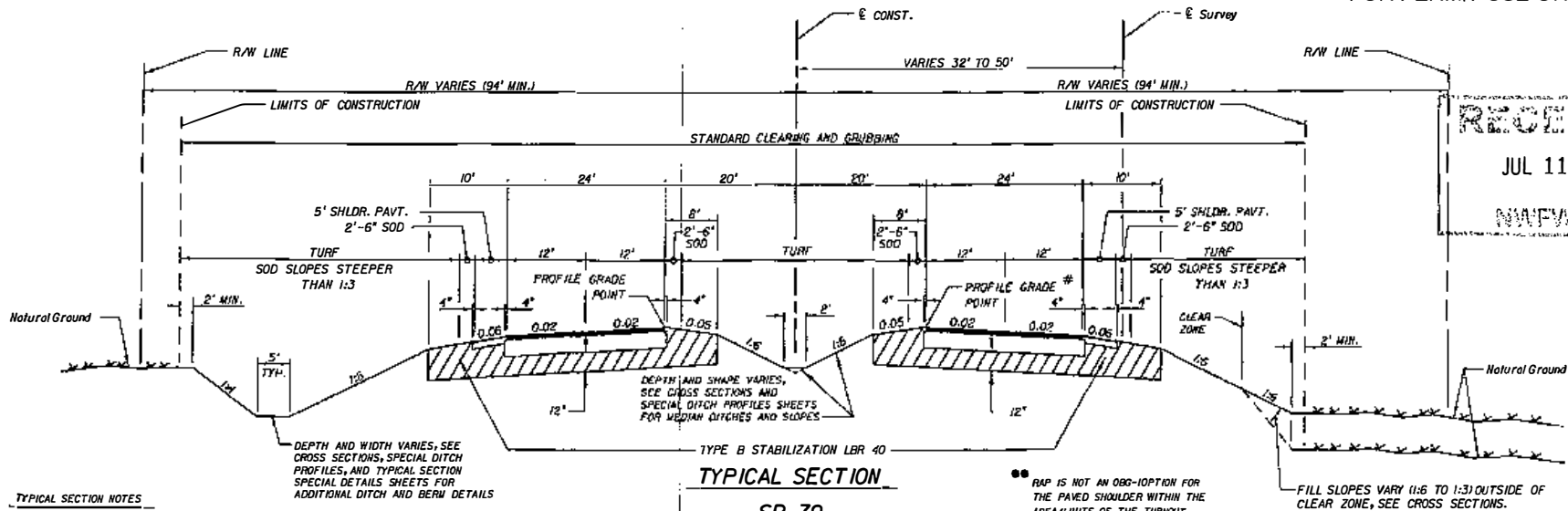

TYPICAL SECTION NOTES

1. THE CROSS SLOPE OF LEFT-TURN LANES IN TANGENT SECTIONS WILL MATCH THE CROSS SLOPE OF THE ADJACENT TRAVEL LANE UNLESS OTHERWISE INDICATED.
2. THE CROSS SLOPE OF THE NORTH BOUND AND SOUTH BOUND LEFT-TURN LANES IN CURVE C/CONST-3 WILL BE 0.04 LESS THAN THE CROSS SLOPE OF THE ADJOINING TRAVEL LANE.
3. THE CONTRACTOR SHALL BE RESPONSIBLE FOR REPLACING OR REPAIRING ANY TURF OUTSIDE THE LIMITS OF CONSTRUCTION DAMAGED DURING CONSTRUCTION.
4. THE FRICTION COURSE SHALL BE BUTT JOINTED INTO EXISTING PAVEMENT.
5. EXCESS BASE SHALL NOT BE SPOILED ON THE OUTSIDE LIMITS OF PLAIN AREAS FOR BASE CONSTRUCTION. THE EXCESS BASE SHALL BE REMOVED FROM THE PROJECT AT NO ADDITIONAL COMPENSATION.

TRAFFIC DATA

URGENT YEAR 2006 = AADT = 4,800
 ESTIMATED OPENING YEAR 2012 = AADT = 9,400
 ESTIMATED DESIGN YEAR 2032 = AADT = 20,420
 V = 13.3% D = 58.2% T = 8.3% (24 HOUR)
 DESIGN HOUR T = 4.2%
 DESIGN SPEED = 70 MPH
 CLEAR ZONE = 36 FT (FROM OUTSIDE EDGE OF TRAVEL LANE)

NEW CONSTRUCTION

OPTIONAL BASE GROUP 9 WITH
 TYPE SP STRUCTURAL COURSE (TRAFFIC C)(1 1/2") (PG 76-22)
 AND FRICTION COURSE FC-5 (3/4") (PG 76-22)

****SHOULDER PAVEMENT**

OPTIONAL BASE GROUP 1 WITH
 TYPE SP STRUCTURAL COURSE (TRAFFIC C)(1 1/2") (PG 76-22)
 AND FRICTION COURSE FC-5 (3/4") (PG 76-22)



PERMITTED PLANS

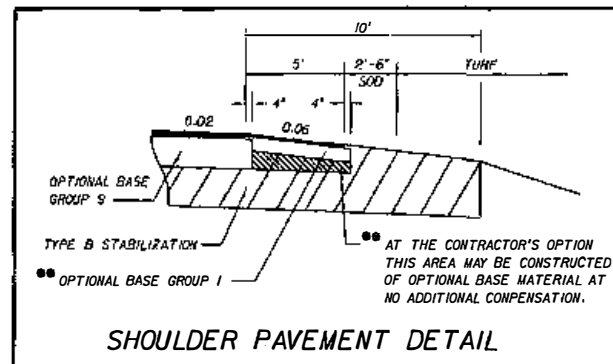

SHOULDER PAVEMENT DETAIL

REVISIONS	DATE	DESCRIPTION

ECDriver 700 CENTRE POINT BLVD. SUITE 104 TALLAHASSEE, FL 32309-7821 CONF. OF AUTH. #3352	STATE OF FLORIDA DEPARTMENT OF TRANSPORTATION ROAD NO. SR 79 COUNTY WASHINGTON FINANCIAL PROJECT ID 220773-7-52-Q1	SHEET NO. 7
--	--	-------------

U.S. Army Corps of Engineers
 Permit # SA1-2012-03021
 Date: March 1, 2013
 Drawing 2 of 28

NOTICE: THE OFFICIAL RECORD OF THIS SHEET IS THE ELECTRONIC FILE SIGNED AND SEALED UNDER BILL 665-23103, F.A.C.

FOR PERMIT USE ONLY

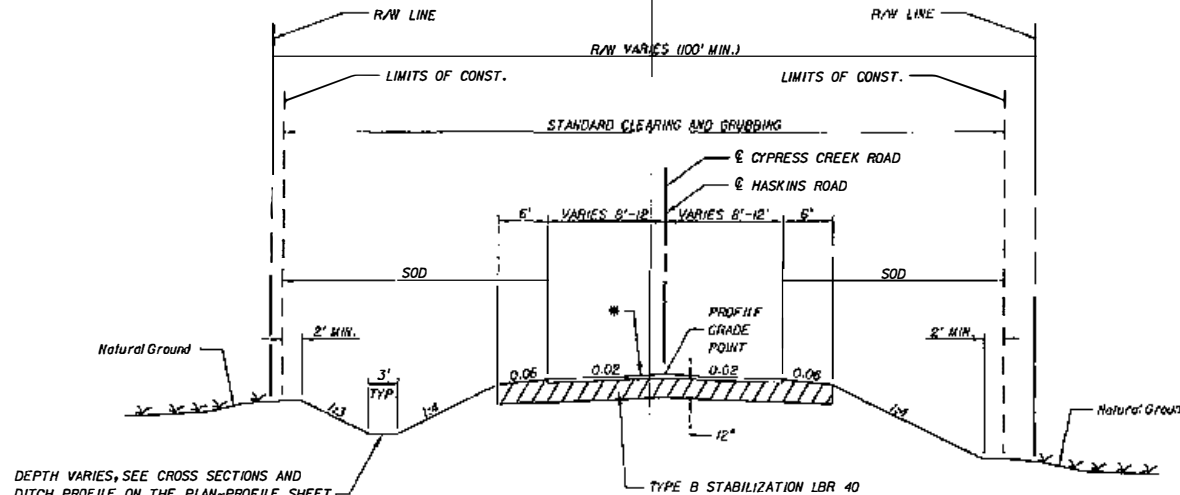

RECEIVED
JUL 11 2012
MAINTENANCE

DESIGN SPEED = 30 MPH

CLEAR ZONE = 6 FT (FROM OUTSIDE EDGE OF TRAVEL LANE)

GRADING TYPICAL SECTION

HASKINS ROAD

STA. 200+05.00 TO STA. 202+50.05

CYPRESS SPRINGS ROAD

STA. 301+32.81 TO STA. 301+92.91

* - Cypress Springs Road Only:
Surface with Optional Base Group I, (Graded Aggregate Base only)

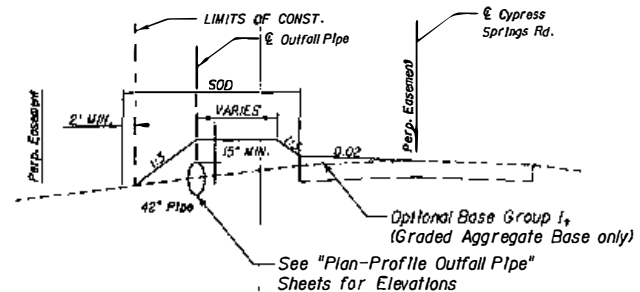

GRADING TYPICAL SECTION

CYPRESS SPRINGS ROAD

STA. 58+65.07 TO STA. 63+97.32



**PERMITTED
PLANS**

REVISIONS			DESCRIPTION
DATE	BY	DESCRIPTION	

ECDriver
ENGINEER OF RECORD: DORIS S. PUGH, P.E.
P.E. NO. 5329

STATE OF FLORIDA
DEPARTMENT OF TRANSPORTATION
ROAD NO. SR 79 COUNTY WASHINGTON FINANCIAL PROJECT ID 220773-7-52-01

TYPICAL SECTION

SHEET NO. 8

U.S. Army Corps of Engineers
Permit # SAJ-2012-03021
Date: March 1, 2013
Drawing 3 of 28

NOTICE: THE OFFICIAL RECORD OF THIS SHEET IS THE ELECTRONIC FILE SIGNED AND SEALED UNDER RULE 6A05-21.003, F.A.C.

FOR PERMIT USE ONLY

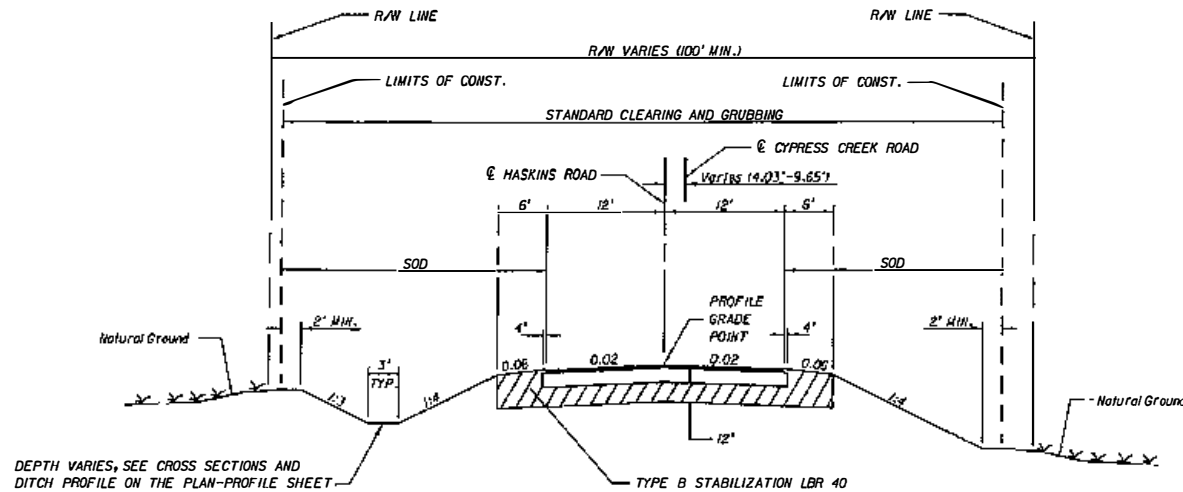

RECEIVED
JUL 11 2012
NWFWMD

DESIGN SPEED = 30 MPH
CLEAR ZONE = 6 FT (FROM OUTSIDE EDGE OF TRAVEL LANE)

TYPICAL SECTION

HASKINS ROAD

STA. 202+50.05 TO STA. 203+05.75

CYPRESS SPRINGS ROAD

STA. 300+44.37 TO STA. 301+32.81

NEW CONSTRUCTION

OPTIONAL BASE GROUP 9 WITH
TYPE SP STRUCTURAL COURSE (TRAFFIC C) (3 1/2") (PG 76-22)
AND FRICTION COURSE FC-5 (3/4") (PG 76-22)



U.S. Army Corps of Engineers
Permit # SAJ-2012-03021
Date: March 1, 2013
Drawing 4 of 28



REVISIONS				DESCRIPTION	DATE	BY	CHECKED	APPROVED	E.C. DRIVER	STATE OF FLORIDA DEPARTMENT OF TRANSPORTATION	ROAD NO.	COUNTY	FINANCIAL PROJECT ID	TYPICAL SECTION	SHEET NO.
DATE	BY	DESCRIPTION	DATE												
											SR 79	WASHINGTON	220773-7-52-CV		9

NOTICE: THE ORIGINAL RECORD OF THIS SHEET IS THE ELECTRONIC FILE SAVED AND SEALED UNDER FILE 605-03021.PJL

Begin Station	End Station	Slope	Berm Height (Feet)
1136+46.78	1116+00.00	LT	1.0
1116+00.00	1122+02.62	LT	1.0
1136+77.45	1140+00.00	LT	2.5
1140+00.00	1143+00.00	LT	2.0
1098+10.00	1104+00.00	RT	1.5
1105+50.00	1114+50.00	RT	1.5
1116+00.00	1128+20.00	RT	1.5
1141+00.00	1143+75.00	RT	1.5
1146+25.00	1149+50.37	RT	2.5

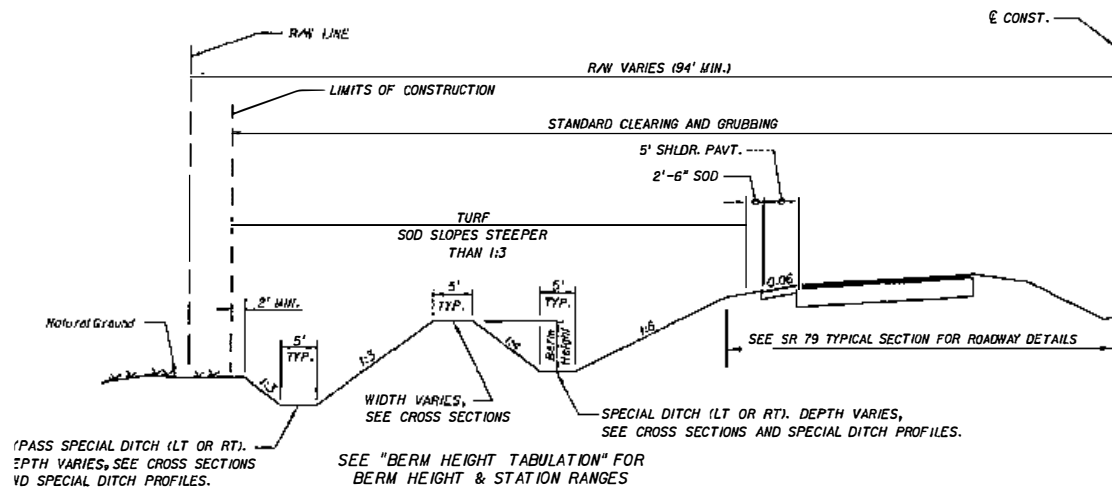

SPECIAL DITCH DETAIL

U.S. Army Corps of Engineers
 Permit # SAJ-2012-03021
 Date: March 1, 2013
 Drawing 5 of 28

RECEIVED

JUL 11 2012

NAFABID



PERMITTED PLANS

REVISIONS						<div><div>ECDriver</div><div>1981 CENTRE PONTA BUD. SUITE 404 TALLAHASSEE, FL 32309-7823 CERT. OF AUTH. #5358</div></div>	STATE OF FLORIDA DEPARTMENT OF TRANSPORTATION			TYPICAL SECTION SPECIAL DETAILS	SHEET NO. 10
DATE	BY	DESCRIPTION	DATE	BY	DESCRIPTION		ROAD NO.	COUNTY	FINANCIAL PROJECT ID		
						SR 79	WASHINGTON	220773-7-52-01			

NOTICE: THE OFFICIAL RECORD OF THIS SHEET IS THE ELECTRONIC FILE STORED AND SEALED UNDER RULE GDS-23.000, F.A.C.

FOR PERMIT USE ONLY

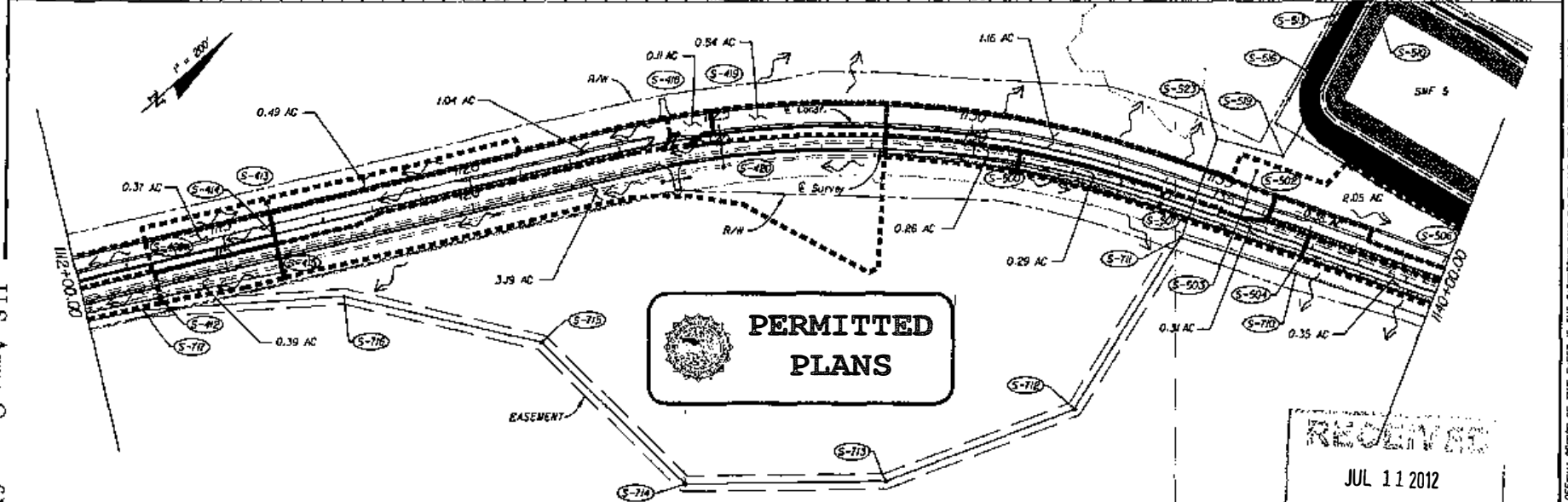
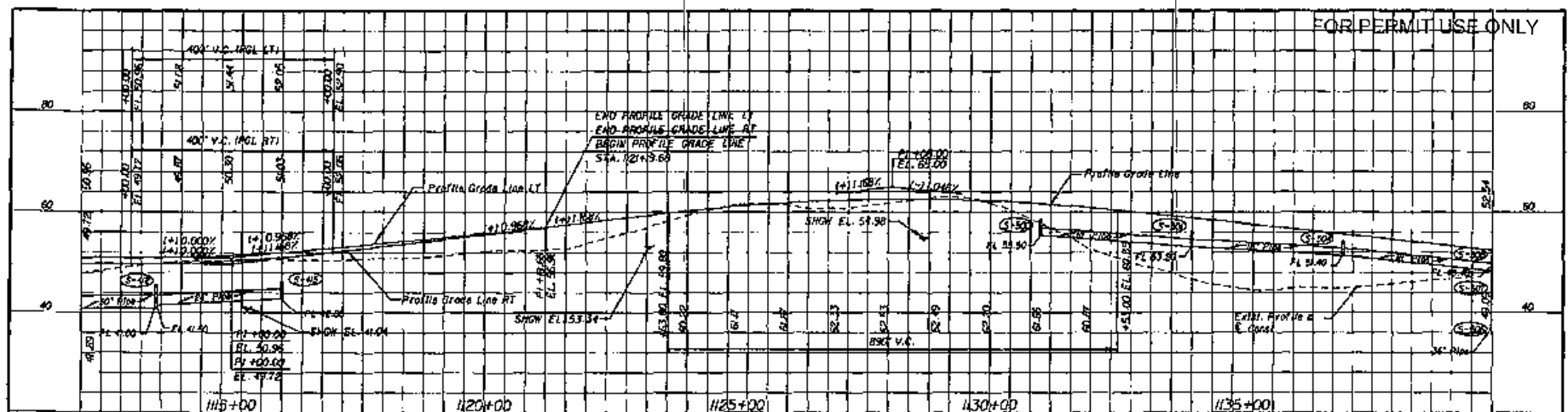

DO NOT USE THE INFORMATION ON THIS SHEET FOR CONSTRUCTION PURPOSES.
This sheet is in the plans for documentation and to assist construction personnel with drainage concerns.

RECEIVED
JUL 11 2012
NWFWMD

U.S. Army Corps of Engineers
Permit # SAJ-2012-03021
Date: March 1, 2013

REVISIONS				DESCRIPTION	E.C. DRIVER	STATE OF FLORIDA DEPARTMENT OF TRANSPORTATION			SHEET NO.
BY	DATE	BY	DATE			ROAD NO.	COUNTY	FINANCIAL PROJECT ID	
						SR 79	WASHINGTON	22073-7-52-01	4

NOTICE: THE OFFICIAL RECORD OF THIS SHEET IS THE ELECTRONIC FILE STORED AND SEALED UNDER RULE 6805-21.001, F.A.C.

FOR PERMIT USE ONLY

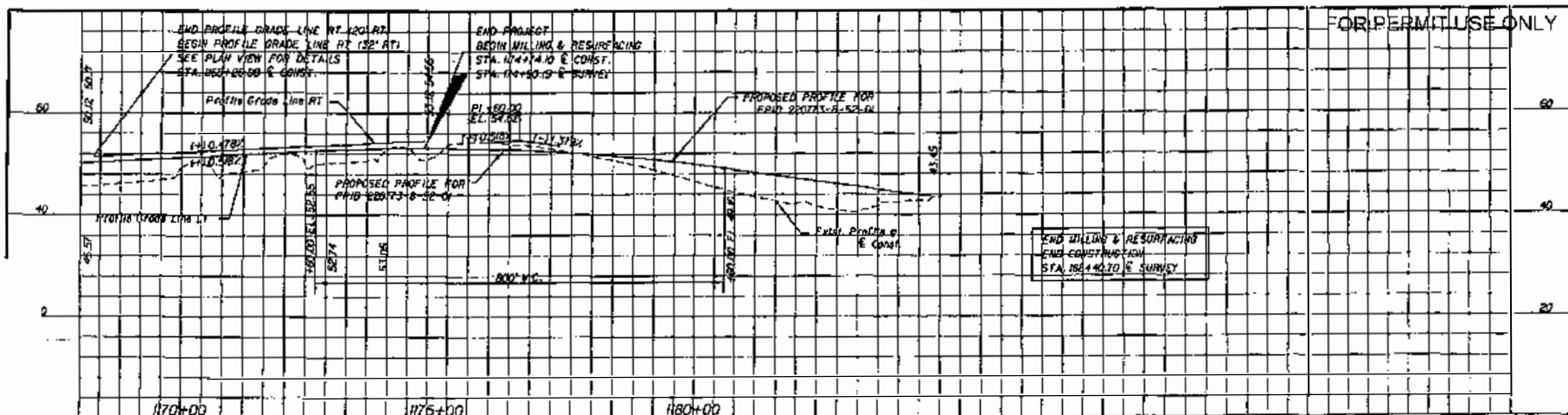

DO NOT USE THE INFORMATION ON THIS SHEET FOR CONSTRUCTION PURPOSES.
This sheet is in the plans for documentation and to assist construction personnel with drainage concerns.

1" = 200'

END MILLING & RESURFACING
END CONSTRUCTION
STA. 185+40.70 & SURVEY

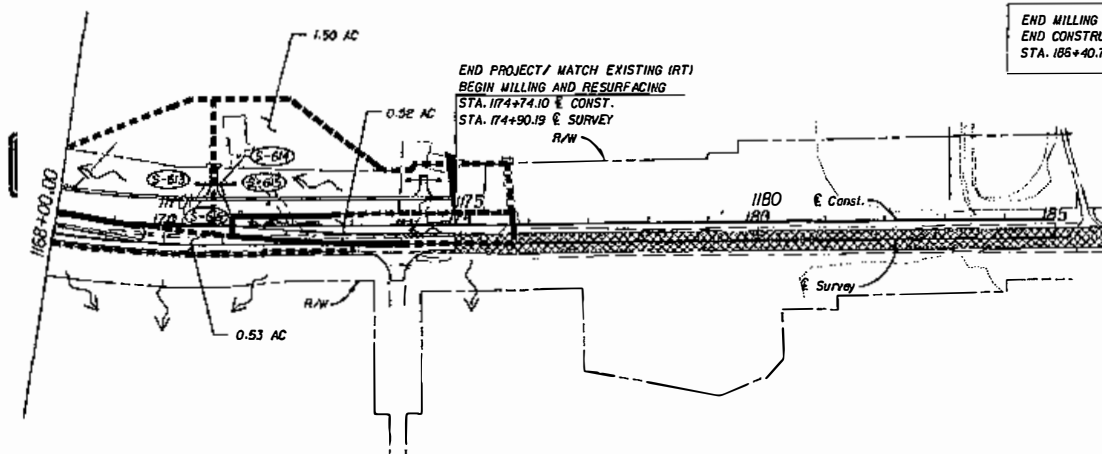

**PERMITTED
PLANS**

RECEIVED
JUL 11 2012
NWFWMD

REVISIONS				DESCRIPTION	
DATE	BY	DESCRIPTION	DATE	BY	DESCRIPTION

ECDriver
ENGINEER OF RECORD
Doris L. Stephens, P.E.
P.E. NO. 5480

803 CENTRE POINTE BLVD.
SUITE 200
TALLAHASSEE, FL 32308-1823
CERT. OF AUTH. #3830

STATE OF FLORIDA
DEPARTMENT OF TRANSPORTATION

ROAD NO.	COUNTY	FINANCIAL PROJECT ID
SR 79	WASHINGTON	220773-7-52-01

DRAINAGE MAP

SHEET NO.
6

NOTICE: THE OFFICIAL RECORD OF THIS SHEET IS THE ELECTRONIC FILE SHOWN AND SIGNED UNDER RULE 68F-23.001, F.A.C.

U.S. Army Corps of Engineers
Permit # SAJ-2012-03021
Date: March 1 2012

FOR PERMIT USE ONLY

PERMITTED PLANS

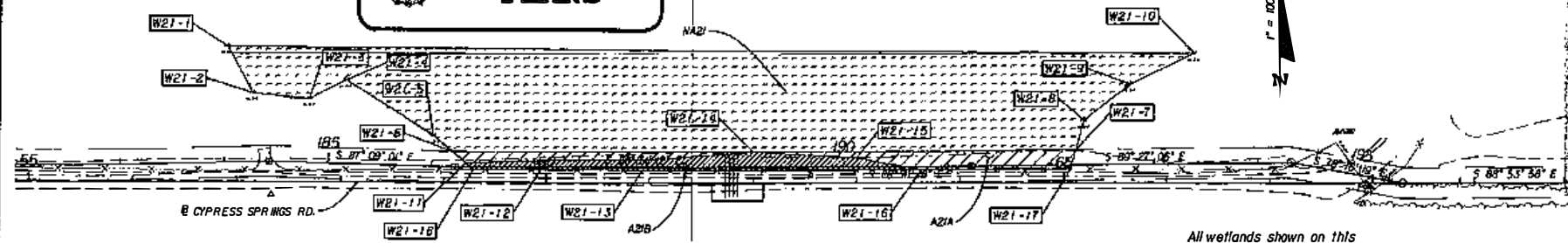

All wetlands shown on this sheet are not part of the binding jurisdictional determination.

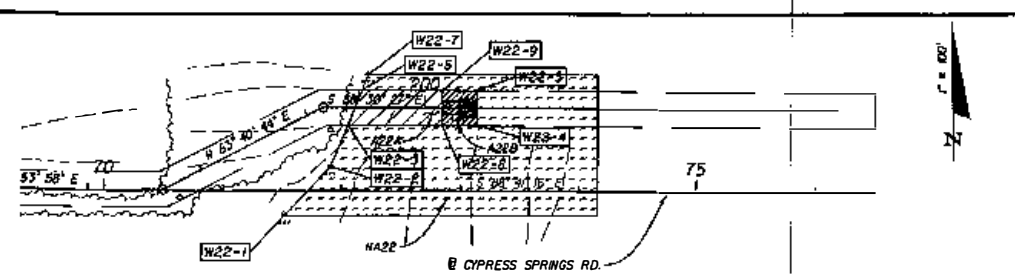

CALL OUTS ARE BASED ON CYPRESS SPRINGS RD. UNLESS OTHERWISE NOTED

NON-IMPACTED WETLANDS			
AREA	POINT	STATION	OFFSET
NA21	W21-1	59+00.00	171.08 ft
	W21-2	57+74.71	85.32 ft
	W21-3	57+26.00	88.11 ft
	W21-4	56+30.00	25.35 ft
	W21-5	55+00.00	38.89 ft
	W21-6	53+24.00	80.22 ft
	W21-7	52+24.00	94.24 ft
	W21-8	51+00.00	128.82 ft
	W21-9	49+00.00	90.30 ft
	W21-10	47+00.00	90.30 ft
NA22	W22-1	73+00.00	56.14 ft
	W22-2	72+00.00	56.14 ft
	W22-3	71+00.00	56.14 ft
	W22-4	70+00.00	56.14 ft
NA23	W23-1	113+00.00	171.08 ft
	W23-2	112+00.00	171.08 ft
	W23-3	111+00.00	171.08 ft
	W23-4	110+00.00	171.08 ft

TEMPORARY WETLAND IMPACTS				
AREA	POINT	STATION	OFFSET	AREA (ACRES)
AZ1A	W21-5	53+00.00	25.35 ft	0.133
	W21-6	51+00.00	128.82 ft	
	W21-7	50+00.00	88.11 ft	
	W21-8	49+00.00	90.30 ft	
	W21-9	47+00.00	90.30 ft	
	W21-10	45+00.00	71.07 ft	
	W21-11	43+00.00	56.14 ft	
	W21-12	41+00.00	56.14 ft	
	W21-13	39+00.00	56.14 ft	
	W21-14	37+00.00	56.14 ft	
AZ2A	W22-1	73+00.00	56.14 ft	0.050
	W22-2	72+00.00	56.14 ft	
	W22-3	71+00.00	56.14 ft	
	W22-4	70+00.00	56.14 ft	

WETLAND IMPACTS (FILL)				
AREA	POINT	STATION	OFFSET	AREA (ACRES)
AZ1B	W21-11	53+00.00	171.08 ft	0.110
	W21-12	51+00.00	171.08 ft	
	W21-13	49+00.00	171.08 ft	
	W21-14	47+00.00	171.08 ft	
AZ2B	W22-1	73+00.00	56.14 ft	0.020
	W22-2	72+00.00	56.14 ft	
	W22-3	71+00.00	56.14 ft	
	W22-4	70+00.00	56.14 ft	
AZ3A	W23-1	113+00.00	171.08 ft	0.025
	W23-2	112+00.00	171.08 ft	
	W23-3	111+00.00	171.08 ft	
	W23-4	110+00.00	171.08 ft	
	W23-5	109+00.00	171.08 ft	
	W23-6	108+00.00	171.08 ft	
	W23-7	107+00.00	171.08 ft	
	W23-8	106+00.00	171.08 ft	
	W23-9	105+00.00	171.08 ft	
	W23-10	104+00.00	171.08 ft	
	W23-11	103+00.00	171.08 ft	

- Impacted Wetlands (Fill)
- Impacted Wetlands (Excavation)
- Temp. Wetland Impacts
- Non-impacted Wetlands

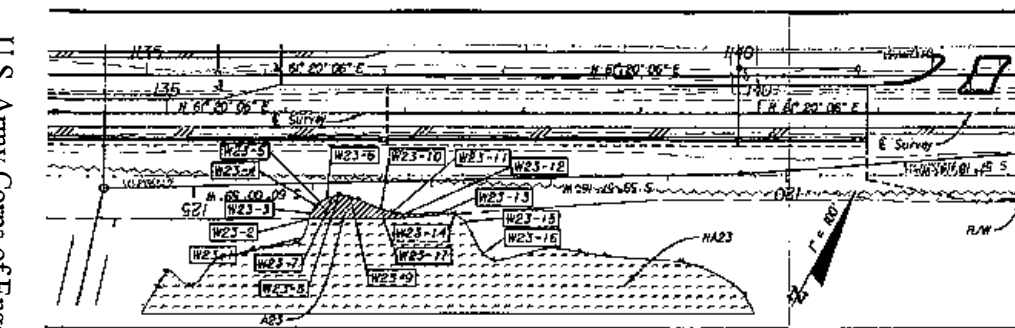

ECDriver 303 CENTRE POINT BLVD. SUITE 104 TAMPA, FL 33606-1043 DEPT. OF TRANSPORTATION		STATE OF FLORIDA DEPARTMENT OF TRANSPORTATION ROAD NO. SR 79 COUNTY WASHINGTON FINANCIAL PROJECT NO. 220773-7-52-01		WETLAND DELINEATION SHEET NO. 146
ENGINEER OF RECORD: Cheryl S. Stapp, P.E. P.E. NO. 34052		DATE: 07/11/2012		

NOTICE: THE OFFICIAL RECORD OF THIS SHEET IS THE ELECTRONIC FILE SHOWN AND SIGNED UNDER RULE 61B02-3.002, F.A.C.

U.S. Army Corps of Engineers
 Permit # SAJ-2012-03021
 Date: March 1, 2013

FOR PERMIT USE ONLY

GENERAL NOTES

1. TRAFFIC CONTROL FOR THIS PROJECT SHALL COMPLY WITH THE LATEST EDITION OF THE FDOT DESIGN STANDARDS, THE MANUAL ON UNIFORM TRAFFIC CONTROL DEVICES (MUTCD), AND THE STANDARD SPECIFICATIONS FOR ROAD AND BRIDGE CONSTRUCTION.
2. ALL STRIPING THAT CONFLICTS WITH TRAFFIC CONTROL STRIPING SHALL BE ADDRESSED ACCORDING TO STANDARD SPECIFICATION 102.
3. EXISTING SIGNS THAT CONFLICT WITH THE TRAFFIC CONTROL PLAN SHALL BE REMOVED, STORED, AND REINSTALLED AS DIRECTED BY THE PROJECT ADMINISTRATOR. THE COST FOR REMOVING, STORING, AND REINSTALLING THE EXISTING SIGNS SHALL BE INCLUDED IN THE BID PRICE FOR PAY ITEM 102-1.
4. THERE ARE NO LANE CLOSURE RESTRICTIONS DUE TO EXISTING TRAFFIC VOLUMES.
5. PORTABLE CHANGEABLE (VARIABLE) MESSAGE SIGNS (PCMS) WITH SETUP "A" MESSAGES ARE TO BE USED FOR 7 DAYS BEFORE TRAFFIC CONTROL PHASES IA, II & III BEGIN. PCMS SETUP "B" MESSAGES ARE TO BE USED FOR 5 DAYS AFTER TRAFFIC CONTROL PHASES IA, II & III ARE IMPLEMENTED. SEE PLAN SHEETS FOR LOCATIONS.

PCMS MESSAGES

SETUP "A"	SETUP "B"
NEW TRAFFIC PATTERN	NEW TRAFFIC PATTERN
MESSAGE 1	MESSAGE 1
MESSAGE 2	MESSAGE 2
MESSAGE 3	MESSAGE 3
MESSAGE 4	MESSAGE 4
MESSAGE 5	MESSAGE 5
MESSAGE 6	MESSAGE 6
MESSAGE 7	MESSAGE 7
MESSAGE 8	MESSAGE 8
MESSAGE 9	MESSAGE 9
MESSAGE 10	MESSAGE 10
MESSAGE 11	MESSAGE 11
MESSAGE 12	MESSAGE 12
MESSAGE 13	MESSAGE 13
MESSAGE 14	MESSAGE 14
MESSAGE 15	MESSAGE 15
MESSAGE 16	MESSAGE 16
MESSAGE 17	MESSAGE 17
MESSAGE 18	MESSAGE 18
MESSAGE 19	MESSAGE 19
MESSAGE 20	MESSAGE 20
MESSAGE 21	MESSAGE 21
MESSAGE 22	MESSAGE 22
MESSAGE 23	MESSAGE 23
MESSAGE 24	MESSAGE 24
MESSAGE 25	MESSAGE 25
MESSAGE 26	MESSAGE 26
MESSAGE 27	MESSAGE 27
MESSAGE 28	MESSAGE 28
MESSAGE 29	MESSAGE 29
MESSAGE 30	MESSAGE 30
MESSAGE 31	MESSAGE 31
MESSAGE 32	MESSAGE 32
MESSAGE 33	MESSAGE 33
MESSAGE 34	MESSAGE 34
MESSAGE 35	MESSAGE 35
MESSAGE 36	MESSAGE 36
MESSAGE 37	MESSAGE 37
MESSAGE 38	MESSAGE 38
MESSAGE 39	MESSAGE 39
MESSAGE 40	MESSAGE 40
MESSAGE 41	MESSAGE 41
MESSAGE 42	MESSAGE 42
MESSAGE 43	MESSAGE 43
MESSAGE 44	MESSAGE 44
MESSAGE 45	MESSAGE 45
MESSAGE 46	MESSAGE 46
MESSAGE 47	MESSAGE 47
MESSAGE 48	MESSAGE 48
MESSAGE 49	MESSAGE 49
MESSAGE 50	MESSAGE 50
MESSAGE 51	MESSAGE 51
MESSAGE 52	MESSAGE 52
MESSAGE 53	MESSAGE 53
MESSAGE 54	MESSAGE 54
MESSAGE 55	MESSAGE 55
MESSAGE 56	MESSAGE 56
MESSAGE 57	MESSAGE 57
MESSAGE 58	MESSAGE 58
MESSAGE 59	MESSAGE 59
MESSAGE 60	MESSAGE 60
MESSAGE 61	MESSAGE 61
MESSAGE 62	MESSAGE 62
MESSAGE 63	MESSAGE 63
MESSAGE 64	MESSAGE 64
MESSAGE 65	MESSAGE 65
MESSAGE 66	MESSAGE 66
MESSAGE 67	MESSAGE 67
MESSAGE 68	MESSAGE 68
MESSAGE 69	MESSAGE 69
MESSAGE 70	MESSAGE 70
MESSAGE 71	MESSAGE 71
MESSAGE 72	MESSAGE 72
MESSAGE 73	MESSAGE 73
MESSAGE 74	MESSAGE 74
MESSAGE 75	MESSAGE 75
MESSAGE 76	MESSAGE 76
MESSAGE 77	MESSAGE 77
MESSAGE 78	MESSAGE 78
MESSAGE 79	MESSAGE 79
MESSAGE 80	MESSAGE 80
MESSAGE 81	MESSAGE 81
MESSAGE 82	MESSAGE 82
MESSAGE 83	MESSAGE 83
MESSAGE 84	MESSAGE 84
MESSAGE 85	MESSAGE 85
MESSAGE 86	MESSAGE 86
MESSAGE 87	MESSAGE 87
MESSAGE 88	MESSAGE 88
MESSAGE 89	MESSAGE 89
MESSAGE 90	MESSAGE 90
MESSAGE 91	MESSAGE 91
MESSAGE 92	MESSAGE 92
MESSAGE 93	MESSAGE 93
MESSAGE 94	MESSAGE 94
MESSAGE 95	MESSAGE 95
MESSAGE 96	MESSAGE 96
MESSAGE 97	MESSAGE 97
MESSAGE 98	MESSAGE 98
MESSAGE 99	MESSAGE 99
MESSAGE 100	MESSAGE 100

R/W LABEL LEGEND FROM TOP PLAN SHEETS

TEMP. BD Y/R RPM'S	TEMPORARY BI-DIRECTIONAL YELLOW/YELLOW RAISED PAVEMENT MARKERS
TEMP. BD Y/R RPM'S	TEMPORARY BI-DIRECTIONAL YELLOW/RED RAISED PAVEMENT MARKERS
TEMP. BD W/R RPM'S	TEMPORARY BI-DIRECTIONAL WHITE/RED RAISED PAVEMENT MARKERS

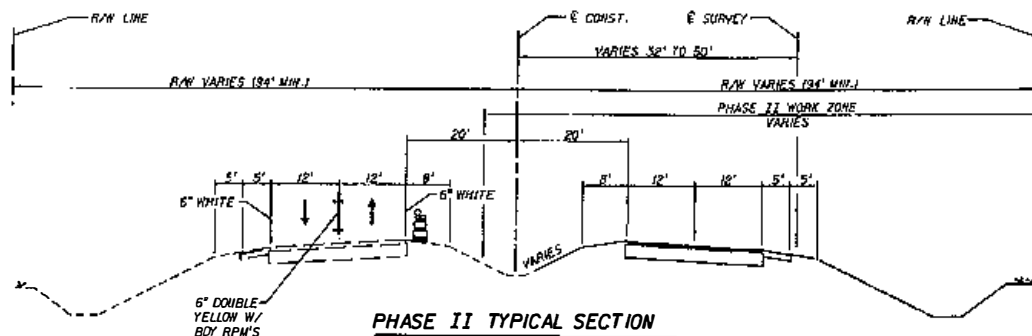
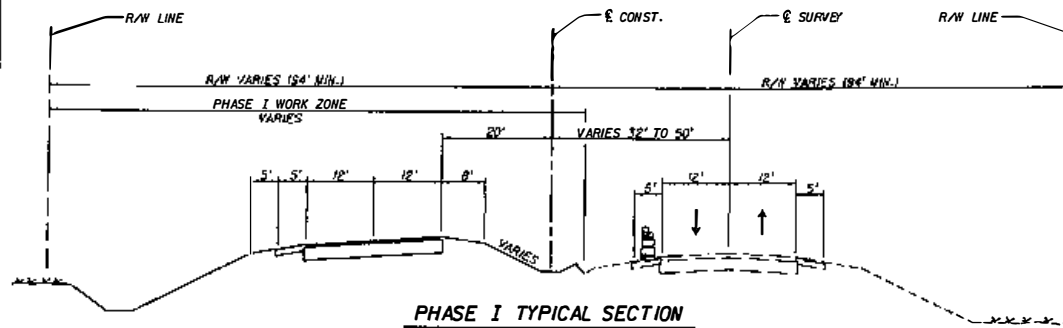

6. ALL LANES MUST BE REOPENED TO NORMAL TRAFFIC WITHIN 12 HOURS OF EVACUATION DUE TO A HURRICANE OR ANY OTHER CATASTROPHIC EVENT AND SHALL REMAIN OPEN FOR THE DURATION OF THE EVACUATION OR EVENT AS DIRECTED BY THE PROJECT ADMINISTRATOR.
7. MAINTAIN DRIVEWAY AND SIDE ROAD ACCESS DURING ALL PHASES PER STANDARD SPECIFICATION 102.
8. ALL TEMPORARY AND DIVERSION PAVEMENT SHALL BE CONSTRUCTED WITH A MINIMUM 2" ASPHALT SURFACE ON A FIRM, UNYIELDING, WELL COMPACTED SUBGRADE AS DESCRIBED IN THE FDOT SPECIFICATIONS, SECTION 102-6. IN ADDITION, ALL TEMPORARY PAVEMENT THAT IS CONSTRUCTED ADJACENT TO THE EXISTING TRAVEL LANES SHALL MATCH THE EXISTING ROADWAY IN TERMS OF GRADE AND CROSS SLOPE.

PHASE I

1. THE POSTED SPEED LIMIT SHALL BE 55 MPH FOR PHASE I.
2. INSTALL ADVANCE WARNING SIGNS AND TRAFFIC CONTROL DEVICES WITH REFERENCE TO STANDARD INDEX 640 AND AS SHOWN IN THE PHASE I PLANS.
3. INSTALL EROSION CONTROL DEVICES FOR PHASE I.
4. MAINTAIN TWO-LANE, TWO-WAY TRAFFIC ON THE EXISTING FACILITY.
5. EXISTING DITCH GRADES AND CROSS DRAIN FLOW DIRECTIONS ARE TO BE MAINTAINED DURING PHASE I CONSTRUCTION.
6. WORKING FROM DOWNSTREAM TO UPSTREAM, CONSTRUCT PROPOSED STORMWATER MANAGEMENT FACILITY, POND OUTFALLS, TEMPORARY STRUCTURE 3-Y AND DRAINAGE AS SHOWN. UTILIZING LANE CLOSURES, CONSTRUCT POND PROPOSED INFALL PIPES, PARTIALLY CONSTRUCT CROSS DRAINS AS SHOWN IN THE PHASE I TRAFFIC CONTROL PLANS.
7. CONSTRUCT PROPOSED SOUTHBOUND ROADWAY (EXCEPT FRICTION COURSE), DRAINAGE, SOUTHBOUND BRIDGE AND PARTIAL MEDIAN AS SHOWN IN THE PHASE I TYPICAL SECTION AND PLANS.
8. INSTALL TEMPORARY PAVEMENT MARKINGS ON THE NEW SOUTHBOUND ROADWAY AS SHOWN IN THE PHASE II TRAFFIC CONTROL PLANS.
9. UTILIZING LANE CLOSURES AS NECESSARY CONSTRUCT DIVERSION I AS SHOWN IN PHASE I TRAFFIC CONTROL PLANS AND STRIPE DIVERSION I AS SHOWN IN THE PHASE II PLANS.
10. INSTALL TEMPORARY PAVEMENT AND STRIPE AS SHOWN IN THE PHASE IA TRAFFIC CONTROL PLANS.
11. INSTALL PAVEMENT MARKINGS FOR THE NORTHBOUND LANE SHIFT AS SHOWN IN THE PHASE IA TRAFFIC CONTROL PLANS.

PHASE IA

1. MAINTAINING ADVANCE & SIDE ROAD WARNING SIGNS, SHIFT TRAFFIC TO THE PHASE IA TRAFFIC PATTERN. COMPLETE THE REMAINDER OF THE INSIDE SOUTHBOUND LANE AND CONSTRUCT THE NEW NORTHBOUND INSIDE LANE (EXCEPT FOR FRICTION COURSE). INSTALL THE TEMPORARY NORTHBOUND MEDIAN CROSSING PAVEMENT.
2. INSTALL PAVEMENT MARKINGS FOR THE TEMPORARY MEDIAN CROSSING AS SHOWN IN THE PHASE II TRAFFIC CONTROL PLANS.

PHASE II

1. THE POSTED SPEED LIMIT SHALL BE 55 MPH FOR PHASE II.
2. INSTALL ADVANCE WARNING SIGNS AND TRAFFIC CONTROL DEVICES AS SHOWN IN THE PHASE II PLANS.
3. SHIFT TRAFFIC TO PHASE II TRAFFIC PATTERN.
4. MAINTAIN CURRENT EROSION CONTROL DEVICES AND INSTALL EROSION CONTROL DEVICES FOR PHASE II.
5. CONSTRUCT NORTHBOUND ROADWAY (WITHOUT FRICTION COURSE), DRAINAGE, NORTHBOUND BRIDGE, LANE TRANSITION AND MEDIAN AS SHOWN IN THE PHASE II PLANS.
6. INSTALL TEMPORARY PAVEMENT MARKINGS ON THE NEW NORTHBOUND ROADWAY AS SHOWN IN THE SIGNING AND PAVEMENT MARKING PLANS, EXCEPT FOR THE LANES IN USE FOR THE TEMPORARY MEDIAN CROSSING AT THE BEGINNING OF THE PROJECT. ALSO INSTALL TEMPORARY PAVEMENT MARKINGS ON THE FINAL SOUTHBOUND LANE TRANSITION NEAR THE END OF THE PROJECT AS SHOWN IN THE SIGNING AND PAVEMENT MARKING PLANS.
7. COMPLETE STRIPING FOR THE NORTHBOUND ROADWAY AS SHOWN IN THE SIGNING AND PAVEMENT MARKING PLANS. INSTALL THE FINAL SIGNING (EXCEPT FOR THE 60 MPH SIGNS) AS SHOWN IN THE SIGNING AND PAVEMENT MARKING PLANS. SEE PHASE III SIGNING DETAIL FOR SPEED LIMIT SIGN PLACEMENT LOCATIONS.

PHASE III

1. THE POSTED SPEED LIMIT SHALL BE 55 MPH FOR PHASE III.
2. INSTALL ADVANCE WARNING SIGNS AS SHOWN ON THE PHASE III SIGNING DETAIL SHEET.
3. SHIFT NORTHBOUND TRAFFIC TO THE FINAL CONFIGURATION AND SHIFT SOUTHBOUND TRAFFIC FROM DIVERSION I TO THE SOUTHBOUND LANE TRANSITION.
4. REMOVE THE TEMPORARY MEDIAN CROSSING AT THE BEGINNING OF THE PROJECT AND COMPLETE THE FINAL MEDIAN SLOPES. ALSO REMOVE DIVERSION I AND INSTALL TURF OVER THE AREA.
5. REFERENCING INDEX 613, MILL AND RESURFACE THE EXISTING ROADWAYS AS SHOWN ON THE "MILLING AND RESURFACING DETAILS" SHEET. ALSO INSTALL THE FRICTION COURSE ON THE NEW ROADWAY. INSTALL FINAL PAVEMENT MARKINGS AND FINAL 60 MPH SIGNS AS SHOWN IN SIGNING AND PAVEMENT MARKING PLANS.
6. REMOVE TRAFFIC CONTROL SIGNING AND EROSION CONTROLS DEVICES AS DIRECTED BY THE PROJECT ADMINISTRATOR.

REV	DESCRIPTION	DATE	BY	DESCRIPTION

ECODriver RRS CENTRE POINT BLVD. SUITE 101 TALLAHASSEE, FL 32308-7023 CERT. OF AUTH. #3838

ENGINEER OF RECORD: Douglas S. Pridemore P.E. NO. 5380

STATE OF FLORIDA DEPARTMENT OF TRANSPORTATION		
ROAD NO.	COUNTY	FINANCIAL PROJECT ID
SR 79	WASHINGTON	220773-7-52-01

TCP - TYPICAL SECTIONS AND PHASING NOTES

SHEET NO. 147

NOTICE: THE OFFICIAL RECORD OF THIS SHEET IS THE ELECTRONIC FILE SAVED AND SEALED UNDER RULE 61E5-23.003, F.A.C.

JUL 11 2012

MAILED

U.S. Army Corps of Engineers
Permit # SAJ-2012-03021
Date: March 1, 2013

U.S. Army Corps of Engineers
Permit # SA1-2012-03021
Date: March 1, 2013
Drawing 14 of 28

INDEX OF SHEETS

B-1 Index of Sheets, General Notes, Bid Item Notes & Surface Finish Detail

BRIDGE No. 610151

B1-1 General Plan and Elevation
B1-2 Bridge Hydraulic Recommendations
B1-3 Foundation Layout
B1-4 Slope Protection Details (Drawing 1 of 2)
B1-5 Slope Protection Details (Drawing 2 of 2)
Reinforcing List

BRIDGE No. 610086 (Existing Bridge Deck Replacement)

B2-1 General Plan and Elevation



**PERMITTED
PLANS**

BID ITEM NOTES

- For summary of Bridge Pay Items, see SUMMARY OF PAY ITEMS sheets in the Roadway Plans.
- Payment for incidental items not specifically covered in the individual Bid Items shall be included in the Contract Unit Price for the Bid Items.
- Bid Item No. 400-9 includes Slob Grooving of the 2'-0" exposed finished concrete on each of the Approach Slobs.
- The cost of the scupper shall be included in the contract unit price for Superstructure Concrete, Pay Item Number 400-4-4.
- Bid Item No. 400-143 shall be used for coating existing structure per the SURFACE FINISH DETAIL, this sheet.
- Bid Item No. 110-3 REMOVAL OF EXISTING STRUCTURE includes 14,125 SF of Bridge Deck and 1,884 SF of Approach Slob and the Traffic Railing Barrier within these limits.
- The price and payment for Bid Item 455-146 EMBEDDED DATA COLLECTOR shall be full compensation for furnishing and installing the Embedded Data Collectors.
- Bid Item No. 530-1 shall include the cost of #4 rebar driven through sand-cement mrap. See SLOPE PROTECTION DETAILS sheet for details.

REVISIONS

DATE	BY	DESCRIPTION	DATE	BY	DESCRIPTION

GENERAL NOTES
GENERAL SPECIFICATIONS: Florida Department of Transportation "Standard Specifications for Road and Bridge Construction" (2007 edition), and supplements thereto.

DESIGN SPECIFICATIONS: American Association of State Highway and Transportation Officials (AASHTO) LRFD Bridge Design Specifications (3rd edition) and approved Interims as specified in the Structures Design Guidelines.

FOOT "Structures Design Guidelines for Load and Resistance Factor Design" Effective January 2008, FDOT Design Standards 2008 and FDOT Plans Preparation Manual effective January 2007.

DESIGN METHOD: Load and Resistance Factor Design (LRFD).

DESIGN LOADING: HL 93.

FUTURE WEARING SURFACE: Design includes no allowance for future wearing surface. Deck thickness and top cover include 1/2" allowance for grooving and planing.

EARTHQUAKE: The length of bearings at End Bents meets the requirements for AASHTO Section 4.7.4.4 and Section 2.3 of the Structures Design Guidelines.

STAY-IN-PLACE METAL FORMS: SIP forms are allowed for Bridge 610151, design allowance is 20 psf.
SIP forms for Bridge 610086 shall have flutes covered with a 20 gage metal cover, design allowance is 8 psf.

CONCRETE: All concrete shall be in accordance with Section 346.

CONCRETE CLASS	Min. 28-day Comp. Strength (PSI)	LOCATION
IV	5500	Substructure
IV	5500	Traffic Railing Barrier
V	6500	AASHTO Type III Prestressed Beams
IV	5500	Superstructure
II (Bridge Deck)	4500	Approach Slobs (CIP)
V (Special)	6000	Prestressed Concrete Piles

REINFORCING STEEL: All reinforcing steel shall be ASTM A615, Grade 60.

ENVIRONMENT: Substructure: Moderately Aggressive
Superstructure: Slightly Aggressive

CONCRETE COVER: Concrete cover shown in the plans does not include reinforcement placement and fabrication tolerances unless shown as "minimum cover". See FDOT Standard Specifications for allowable reinforcement placement tolerances.

CONCRETE SURFACE FINISH: All exposed surfaces of end bents and interior bents, the inside and outside faces and top of concrete Traffic Railing Barrier, deck slob coping, and soffit receive a "Class 5 Applied Finish Coating". See details this sheet.

DISTRIBUTION VALUES: Live Load Distribution values per AASHTO LRFD: Bridge 610151

Interior Beam (M=0.806, V=0.942)
Exterior Beam (M=0.917, V=0.917)
Bridge 610086 (Existing Beams)
Interior Beam (M=0.914, V=1.001)
Exterior Beam (M=0.968, V=0.956)

SCOUR: Scour has been considered in the design of the Pile Foundation. (Refer to the Pile Data Table on Foundation Layout Sheet.)

UTILITIES: For utility information, see Roadway Plans.

BEARING PADS: Bearing Pads shall be AASHTO Type III Beam Type B Pad. See FDOT Standard Index No. 20580.

GENERAL NOTES FOR PERMIT USE ONLY

SCREEDING DECK SLABS: Scream the riding surface of the Bridge Deck and Approach Slabs to achieve the Finish Grade Elevations shown in the Plans. Account for theoretical deflections due to deck self weight, deck casting sequence, deck forming systems, construction loads, overlays and temporary shoring, ect. as required.

PLAN DIMENSIONS: All dimensions in these plans are measured in feet either vertically or horizontally unless otherwise noted.

DIMENSION VERIFICATION: The dimensions and intersection angles shown are based on information as detailed in the Original Construction Plans of the existing bridges (unless noted otherwise), and may not represent the as-built conditions. It is the Contractor's responsibility to verify this data before beginning construction.

EXISTING BRIDGE DECK REMOVAL: The existing deck, approach slabs, and traffic barriers shall be removed by the Contractor. Avoid damage to the remaining structure and reinforcing. Notify the Engineer of any damage occurring to the existing beams, reinforcing, diaphragm or other structural elements. Any damage occurring to the existing structure shall be repaired by the Contractor as directed by the Department at no additional cost to the Department.

MATERIALS REMOVAL: Demolition and removal of the existing structure shall be accomplished avoiding impacts to wetlands. This will require the Contractor to adhere to all requirements of the environmental permits and avoid placing any construction debris within the waterway or wetland areas. The Contractor will be responsible to retain debris prior to the debris falling into the waterway and wetland areas. Any debris in the waterway or wetland areas shall be immediately removed.

MAINTENANCE OF TRAFFIC: For Maintenance of Traffic Notes see Roadway Plans.

DATUM: The Bench Mark Datum for this project is NAVD 1988.

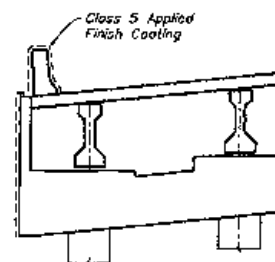
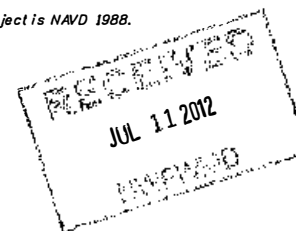

SURFACE FINISH DETAIL
END BENT

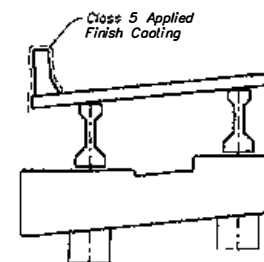

SURFACE FINISH DETAIL
INTERMEDIATE BENT
Bridge Nos. 610086 & 610151

REVISIONS						ENGINEER OF RECORD				FLORIDA DEPARTMENT OF TRANSPORTATION				INDEX OF SHEETS, GENERAL NOTES, BID ITEM NOTES & SURFACE FINISH DETAIL			
DATE	BY	DESCRIPTION	DATE	BY	DESCRIPTION	DRAWN BY	CHECKED BY	DESIGNED BY	APPROVED BY	PROJECT NO.	COUNTY	FINANCIAL PROJECT ID	PROJECT NAME	SHEET NO.			
						REB	REB	REB	REB	79	WASHINGTON	220773-7-52-01	STATE ROAD 79 OVER CYPRESS CREEK	B-1			

NOTES: THE OFFICIAL RECORD OF THIS SHEET IS THE ELECTRONIC FILE SIGNED AND SEALED UNDER RULE 6805-23.001, F.A.C.

FOR PERMIT USE ONLY

Note: Existing Riprap Rubble to remain except that a portion may be removed to facilitate installation of Left Bridge and New Riprap Rubble. New Riprap Rubble shall be tied-in to existing Riprap Rubble at the interface. (Typ.)

*Transition Berm beneath Left Bridge from 10'-0" Min. to match existing outer limits between the two bridges.

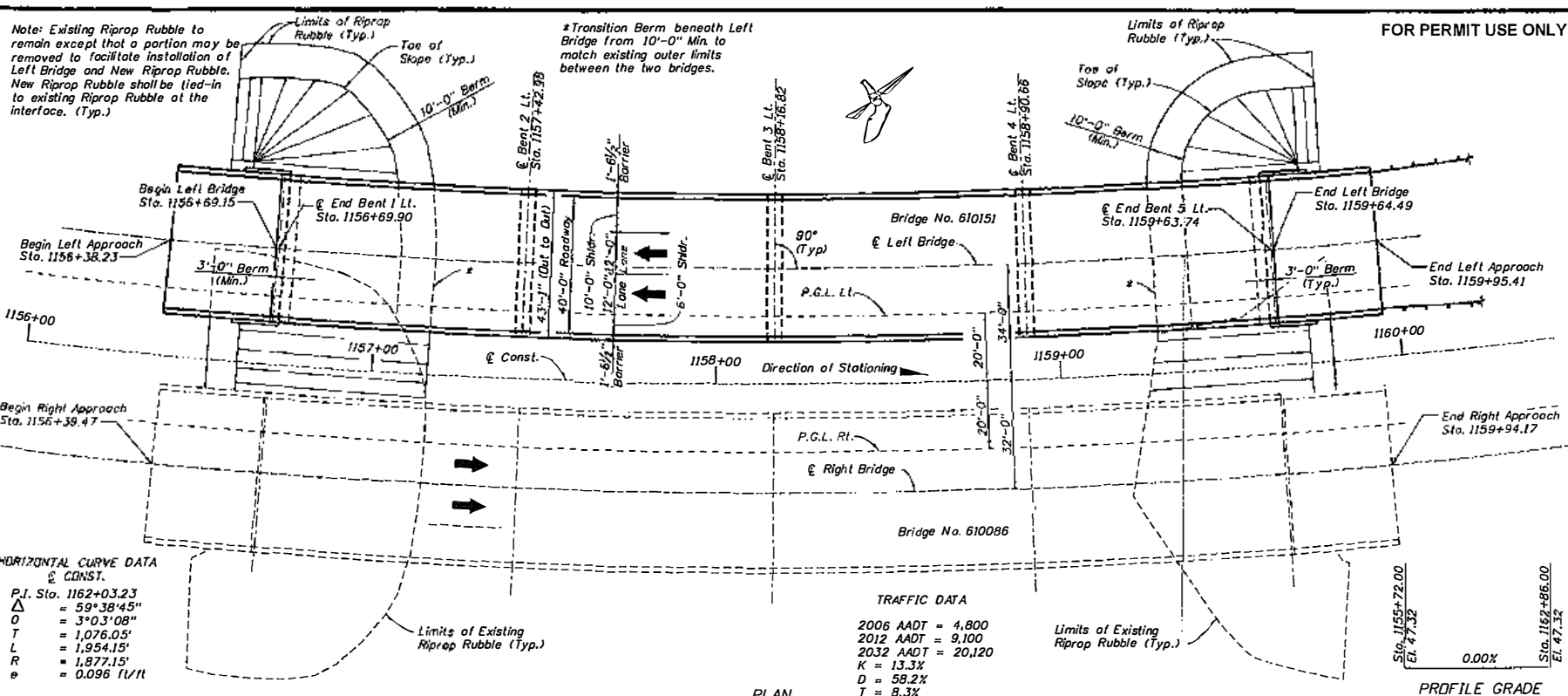

Note: All Stationing is Along & Const.

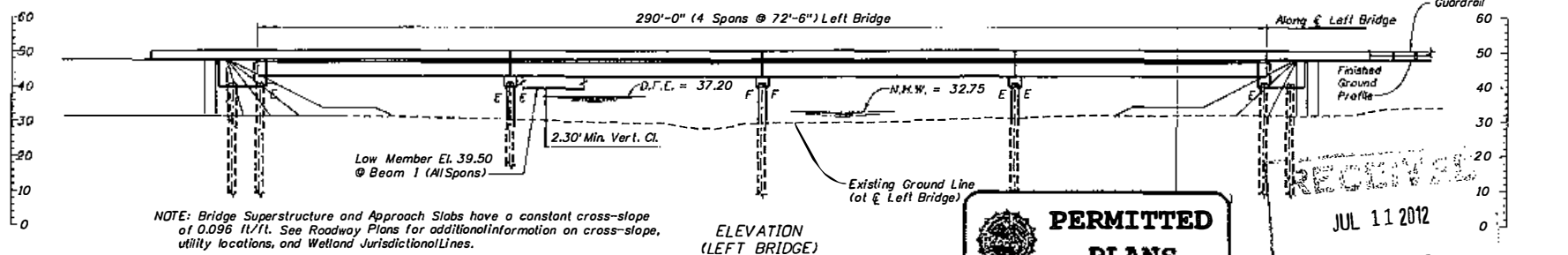

PERMITTED PLANS

JUL 11 2012

REVISIONS				ENGINEER OF RECORD				FLORIDA DEPARTMENT OF TRANSPORTATION				GENERAL PLAN AND ELEVATION	
NO.	DATE	BY	REASON	NAME	DATE	PROJECT NO.	LOCATION	ROAD NO.	COUNTY	FINANCIAL PROJECT ID	PROJECT NAME	SHEET NO.	
1	6/07	REC	REVISED	THOMAS J. FORRELL	6/07	79	WASHINGTON	220773-7-52-01			STATE ROAD 79 OVER CYPRESS CREEK	81-1	

NOTICE: THE OFFICIAL RECORD OF THIS SHEET IS THE ELECTRONIC FILE SAVED AND SEALED UNDER RULE 605-21.003, F.A.C.

U.S. Army Corps of Engineers
Permit # SAJ-2012-03021
Date: March 1, 2013

JUL 11 2012

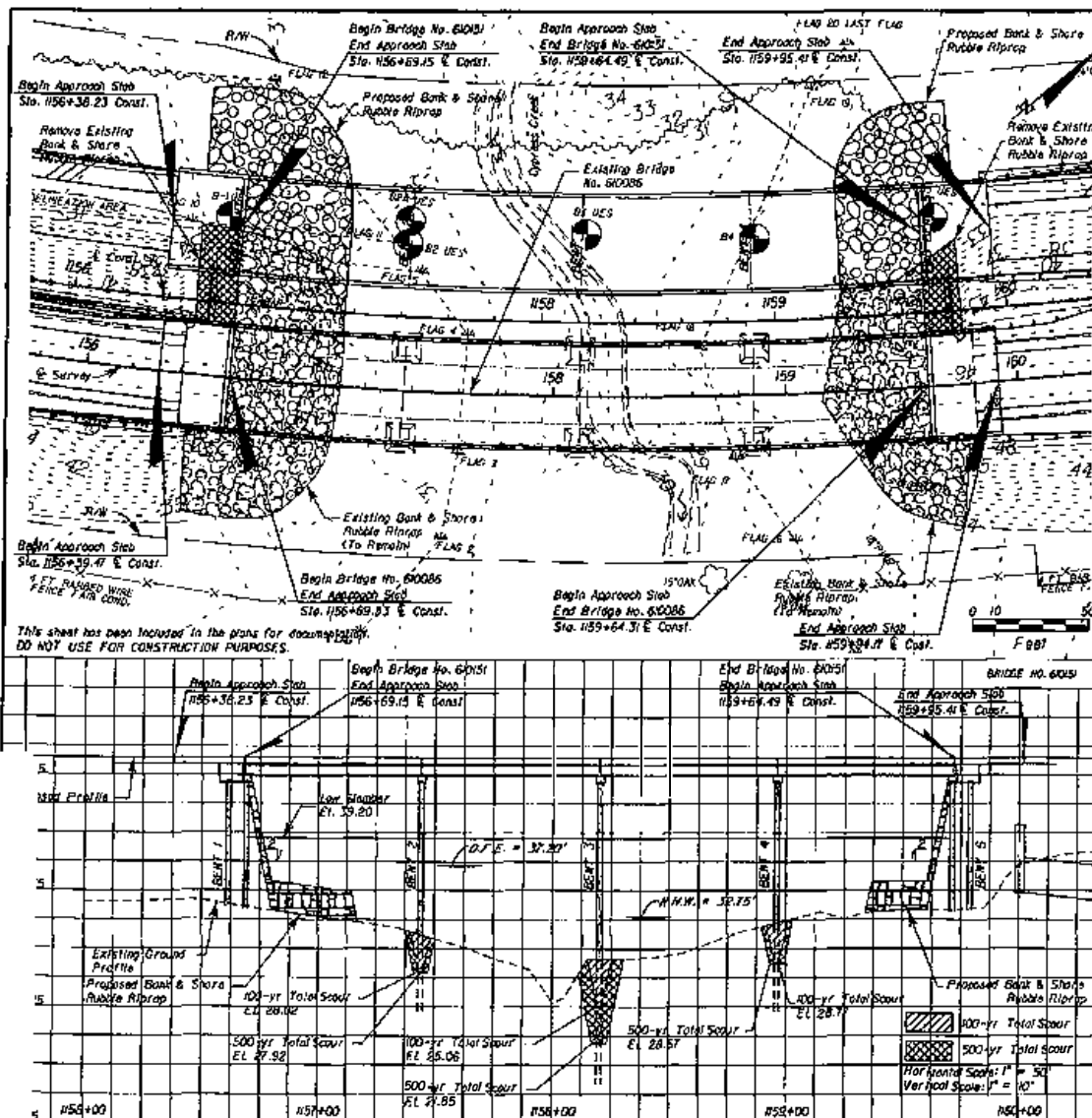

This sheet has been included in the plans for documentation. DO NOT USE FOR CONSTRUCTION PURPOSES.

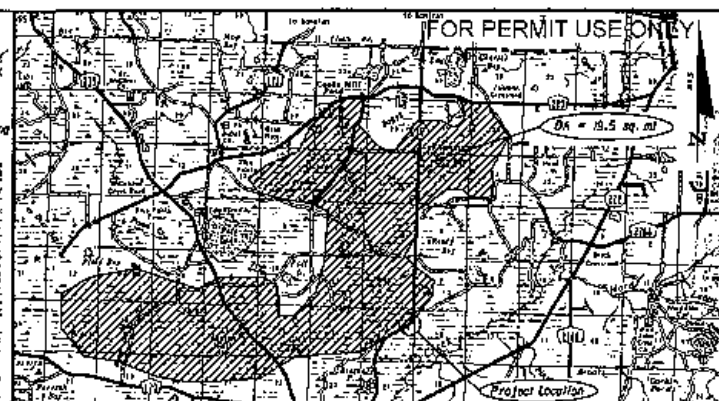
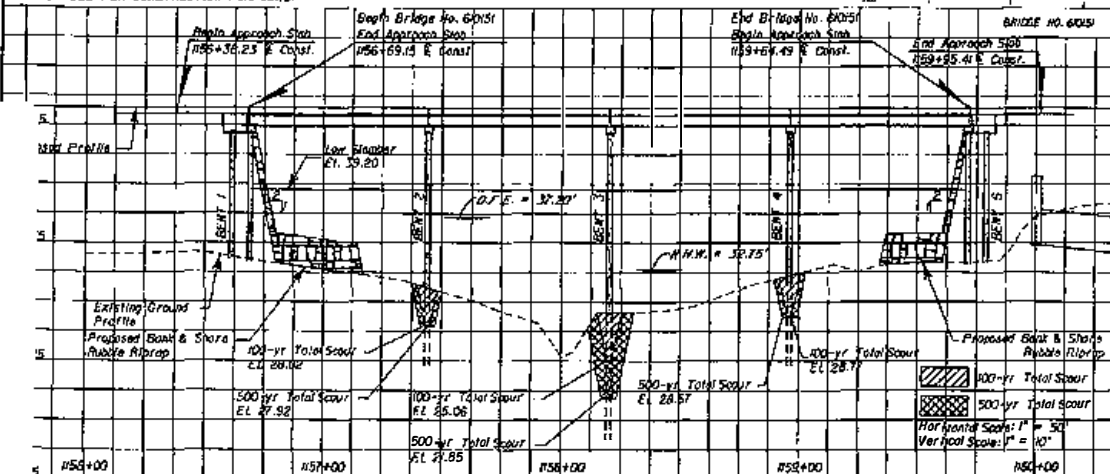

REFERENCE	EXISTING STRUCTURES	PROPOSED STRUCTURE
FOUNDATION	CONC.	CONC.
OVERALL LENGTH	131	131
SPAN LENGTH	CONC.	CONC.
TYPE CONSTRUCTION	CONC.	CONC.
AREA OF OPENING O.D.F.	CONC.	CONC.
BRIDGE WIDTH	CONC.	CONC.
ELEV. LOW WATER	CONC.	CONC.

PERMITTED PLANS

HYDRAULIC DESIGN DATA

NOTE: The hydraulic data is shown for informational purposes only to indicate the flood discharges and water surface elevations which may be anticipated in any given year. This data was generated using highly variable factors determined by a study of the watershed. Any judgments are required to establish these factors. The resultant hydraulic data is sensitive to changes, particularly antecedent conditions, urbanization, channelization and land use. Users of this data are cautioned against the assumption of precision which cannot be obtained.

TERMS:
 Design Flood: Utilized to ensure a desired level of hydraulic performance.
 Base Flood: Has a 1% chance of being exceeded in any given year (100 year frequency).
 Overlapping Flood: Causes flow over the highway, over a watershed divide, or thru emergency relief structures.
 Greatest Flood: The most severe that can be predicted where overlapping is not practicable.

WATER SURFACE ELEVATIONS:		N.H.W. (100-T100)	32.75	M.H.W. (100)	N/A
FLOOD DATA:		MAX. EVENT OF RECORD	DESIGN FLOOD	BASE FLOOD	OVERLAPPING OR GREATEST FLOOD
STAGE ELEV. MOD. (11)		N/A	32.75	28.75	4.99
DISCHARGE (CFS)		N/A	100	100	100
AVERAGE VELOCITY (FT/S)		N/A	0.55	0.55	0.55
EXCEEDANCE PROB. (%)		N/A	1	1	1
FREQUENCY (yr.)		N/A	50	100	500

HYDRAULIC RECOMMENDATIONS

1. BEGIN BRIDGE STATION: 156+69.15 END BRIDGE STATION: 159+64.49 SPAN ANGLE: 0°
 2. CLEARANCE PROVIDED: 12.5' VERT. 12.5' ABOVE EL. 27.5' ABOVE EL. 37.2'
 3. MINIMUM CLEARANCE: 12.5' VERT. 12.5' ABOVE EL. 27.5' ABOVE EL. 37.2'
 4. ABUTMENTS: 100-yr Total Scour EL 28.75 500-yr Total Scour EL 28.75
 5. DECK DRAINAGE: 4" SCUPPERS @ 10' CENTER

REMARKS: THE EXISTING BRIDGE (60085) IS TO REMAIN, BUT THE DECK WILL BE REPLACED. RESULTS IN 5' ELEV. AND DECKS WILL BE PROTECTED WITH STANDARD BANK & SHORE RIPRAP. THEREFORE NO SCOUR IS ANTICIPATED. BRIDGE LENGTHS ARE BASED ON THE R. RIGHT BRIDGE AND L. LEFT BRIDGE.

U.S. Army Corps of Engineers
 Permit # SAJ-2012-03021
 Date: March 1 2012

REVISIONS	DATE	BY	DESCRIPTION
1	03/01/12	EC/Driver	100-yr Total Scour EL 28.75 500-yr Total Scour EL 28.75

EC/Driver
 1001 CENTRE POINT BLVD.
 SUITE 101
 TALLAHASSEE, FL 32309-1823
 TEL: 904.438.3333
 ENGINEER OF RECORD: DR. E. HARRISON, P.E.
 P.E. NO. 44008

STATE OF FLORIDA DEPARTMENT OF TRANSPORTATION		
ROAD NO.	COUNTY	FINANCIAL PROJECT ID
SR 79	WASHINGTON	220773-7-52-01

**BRIDGE HYDRAULIC
RECOMMENDATIONS**

SHEET NO.
 B1-2



FOR PERMIT USE ONLY

RECEIVED
JUL 11 2012

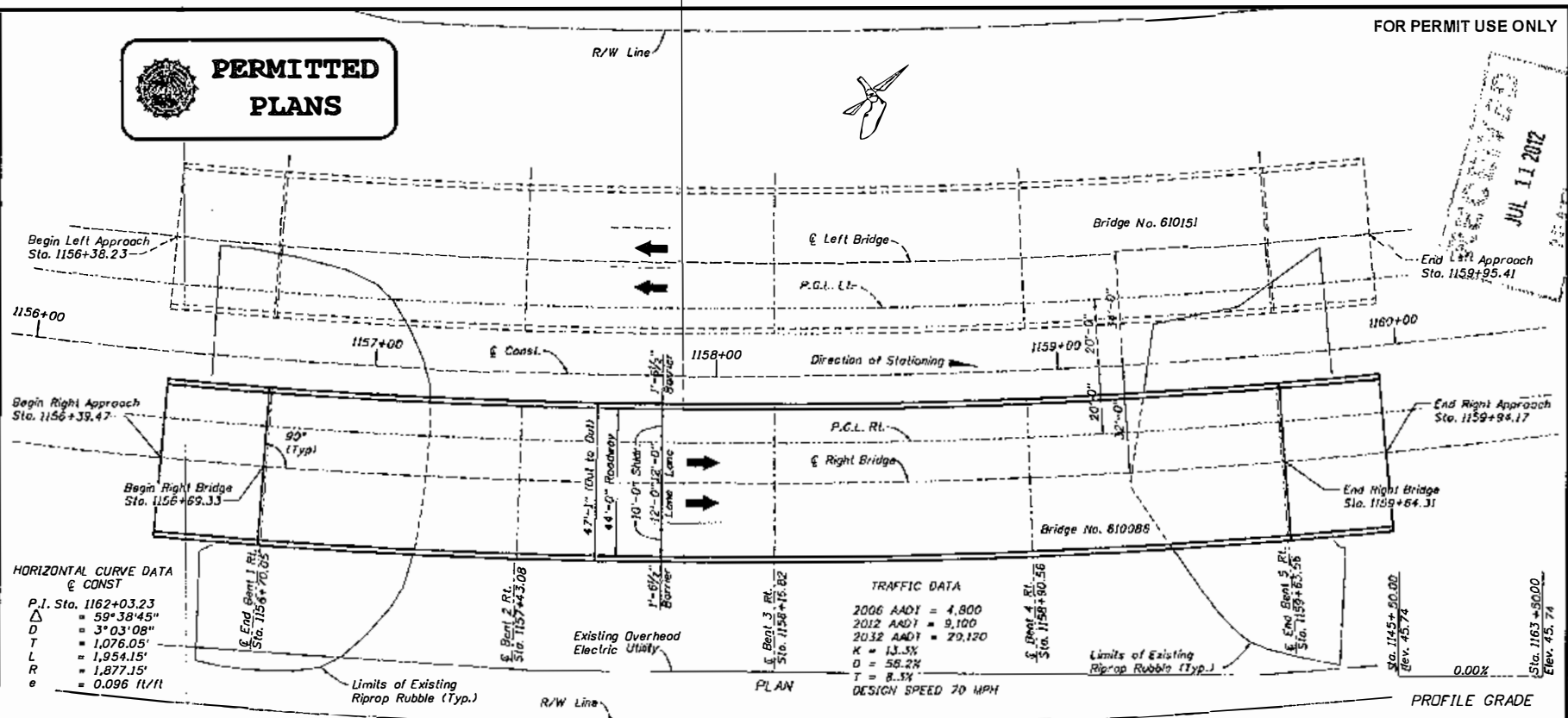

HORIZONTAL CURVE DATA
@ CONST

P.I. Sta. 1162+03.23
Δ = 59°38'45"
D = 3°03'08"
T = 1,076.05'
L = 1,954.15'
R = 1,877.15'
e = 0.096 ft/ft

TRAFFIC DATA

2006 AADT = 4,800
2012 AADT = 9,100
2032 AADT = 20,120
K = 13.5%
D = 58.2%
T = 8.5%
DESIGN SPEED 70 MPH

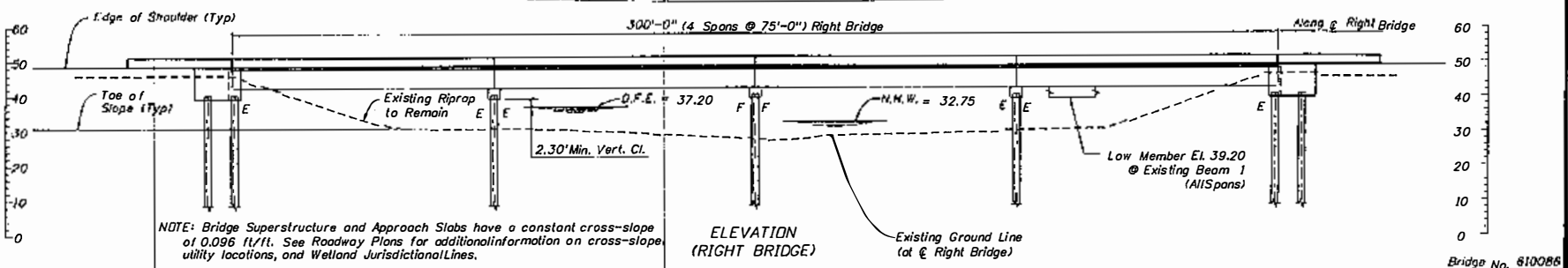

NOTE: Bridge Superstructure and Approach Slabs have a constant cross-slope of 0.096 ft/ft. See Roadway Plans for additional information on cross-slope, utility locations, and Wetland Jurisdictional Lines.

REVISIONS				DESCRIPTION	DRAWN BY	CHECKED BY	DATE	REVISION	ENGINEER OF RECORD:	FLORIDA DEPARTMENT OF TRANSPORTATION			PROJECT NO.	SHEET NO.
NO.	DATE	BY	DESCRIPTION							TITLE	COUNT	FINANCIAL #/SCALE		
					RCG	RIV	12/08		EC Driver	79	WASHINGTON	220773-7-52-01	STATE ROAD 79 OVER CYPRESS CREEK	B2-1
					CAINCEB BY	RW	8/08		300 N. W					

NOTICE: THE OFFICIAL RECORD OF THIS SHEET IS THE ELECTRONIC FILE SIGNED AND SEALED UNDER RULE 62B-13.002, F.A.C.

U.S. Army Corps of Engineers
Permit # SAJ-2012-03021
Date: March 1, 2013

2 $1'' = 100'$

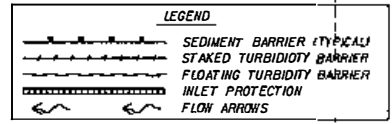

REVISIONS				3825 CENTRE POINTE BLVD. SUITE 804 TALLAHASSEE, FL 32309-3441 CERT. OF AUTH. 000055		STATE OF FLORIDA DEPARTMENT OF TRANSPORTATION		SHEET NO.	
NO.	DESCRIPTION	DATE	BY	EC Driver	ROAD NO.	COUNTY	FINANCIAL PROJECT ID	EROSION CONTROL PLAN	
				ENCLOSURE OF RECORD: DALE A. STEPHEN, P.E. P.E. NO. 5482	SR 79	WASHINGTON	220773-7-52-01	133	

NOTICE: THE OFFICIAL RECORD OF THIS SHEET IS THE ELECTRONIC FILE STORED AND SEALED UNDER RULE 6005-93.003, F.A.C.

U.S. Army Corps of Engineers
Permit # SAJ-2012-03021
Date: March 1, 2013

RECEIVED
JUL 11 2012
RECEIVED



REVISIONS						<div><div><div>ECDriver</div><div>#00000000</div></div><div>ENGINEER OF RECORD</div></div> <div>1983 CENTRE POINTE BLVD. SUITE 404 TALLAHASSEE, FL 32309-7023 CERT. OF AUTH. #0359</div> <div>Clark L. Stephens, P.E. P.E. NO. 54857</div>	STATE OF FLORIDA DEPARTMENT OF TRANSPORTATION			EROSION CONTROL PLAN	SHEET NO. 134
DATE	BY	DESCRIPTION	DATE	BY	DESCRIPTION		ROAD NO.	COUNTY	FINANCIAL PROJECT ID		
						SR 79	WASHINGTON	220773-7-52-01			

E.A. DUBER 4/20/2002 8:09:12 AM L:\Data\JF\500-projects\46107\X-ray\042002\042002_01

Drawing 19 of 28



U.S. Army Corps of Engineers
 Permit # SAJ-2012-03021
 Date: March 1, 2013
 Drawing 20 of 28



RECEIVED
 JUL 11 2012
 NATIONAL

LEGEND

	SEDIMENT BARRIER (TYPICAL)
	STAKED TURBIDITY BARRIER
	FLOATING TURBIDITY BARRIER
	INLET PROTECTION
	FLOW ARROWS

REVISIONS			
DATE	BY	DESCRIPTION	DATE

ECDriver
 1015 CENTRE ROUTE 1000
 SUITE 100
 TALLAHASSEE, FL 32304-1003
 CENT. OF AUTH. 03130
 ENGINEER OF RECORD: DWY L. STAGG, P.E.
 P.E. NO. 54097

STATE OF FLORIDA DEPARTMENT OF TRANSPORTATION		
ROAD NO.	COUNTY	FINANCIAL PROJECT NO.
SR 79	WASHINGTON	220773-7-52-01

EROSION CONTROL PLAN

SHEET NO.
135

NOTICE: THE OFFICIAL RECORD OF THIS SHEET IS THE ELECTRONIC FILE STORED AND SEALED UNDER RULE 6005-88.003, F.A.C.

A right triangle is shown with a vertical leg on the left and a horizontal leg on the bottom. The angle at the top vertex is labeled $1^\circ = 100'$. The angle at the bottom-left vertex is labeled 2° . The right angle is at the bottom-right vertex.



PERMITTED PLANS

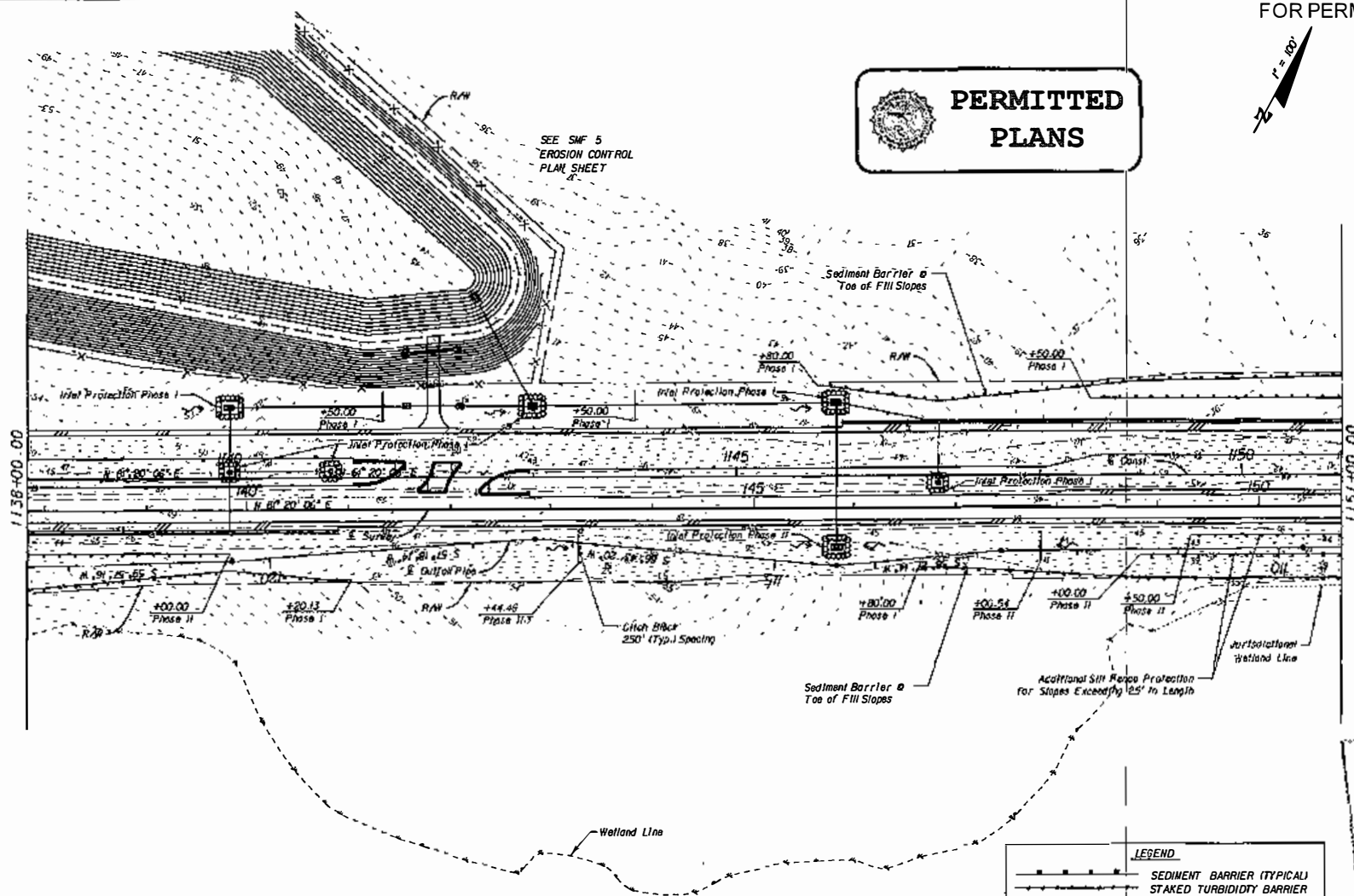

LEGEND

- SEDIMENT BARRIER (TYPICAL)
- STAKED TURBIDITY BARRIER
- FLOATING TURBIDITY BARRIER
- INLET PROTECTION
- FLOW ARROWS

RECEIVED
JUL 11 2012
FBI - NEW YORK

ATTENTION: THE OFFICIAL RECORD OF THIS SAFETY IS YOURS. IT IS YOUR RESPONSIBILITY TO KEEP IT SAFE AND TO RETURN IT TO THE OFFICE OF THE ATTORNEY GENERAL.

REVISIONS			
BY	DESCRIPTION	DATE	BY

ECDriver AN ADAPTER **WAS CENTRE POINT BUILT FOR THE TALLAHASSEE, FL 32308-7425 CENT. OF MATH. 0303**

ENGINEER OF SECOND: Carl S. Shorley, P.E. NO 3400

STATE OF FLORIDA DEPARTMENT OF TRANSPORTATION		
ROAD NO.	COUNTY	FINANCIAL PROJECT ID
SR 79	WASHINGTON	220773-7-52-01

EROSION CONTROL PLAN

SHEET
NO.

136

E. C. DRYE

424

12504 P

2017年12月15日

U.S. Army Corps of Engineers
Permit # SAL-2012-03021
Date: March 1, 2013
Drawing 21 of 28



FOR PERMIT USE ONLY

**PERMITTED
PLANS**

RECEIVED
JUL 11 2013
MAILED

U.S. Army Corps of Engineers
Permit # SAJ-2012-03021
Date: March 1, 2013
Drawing 22 of 28

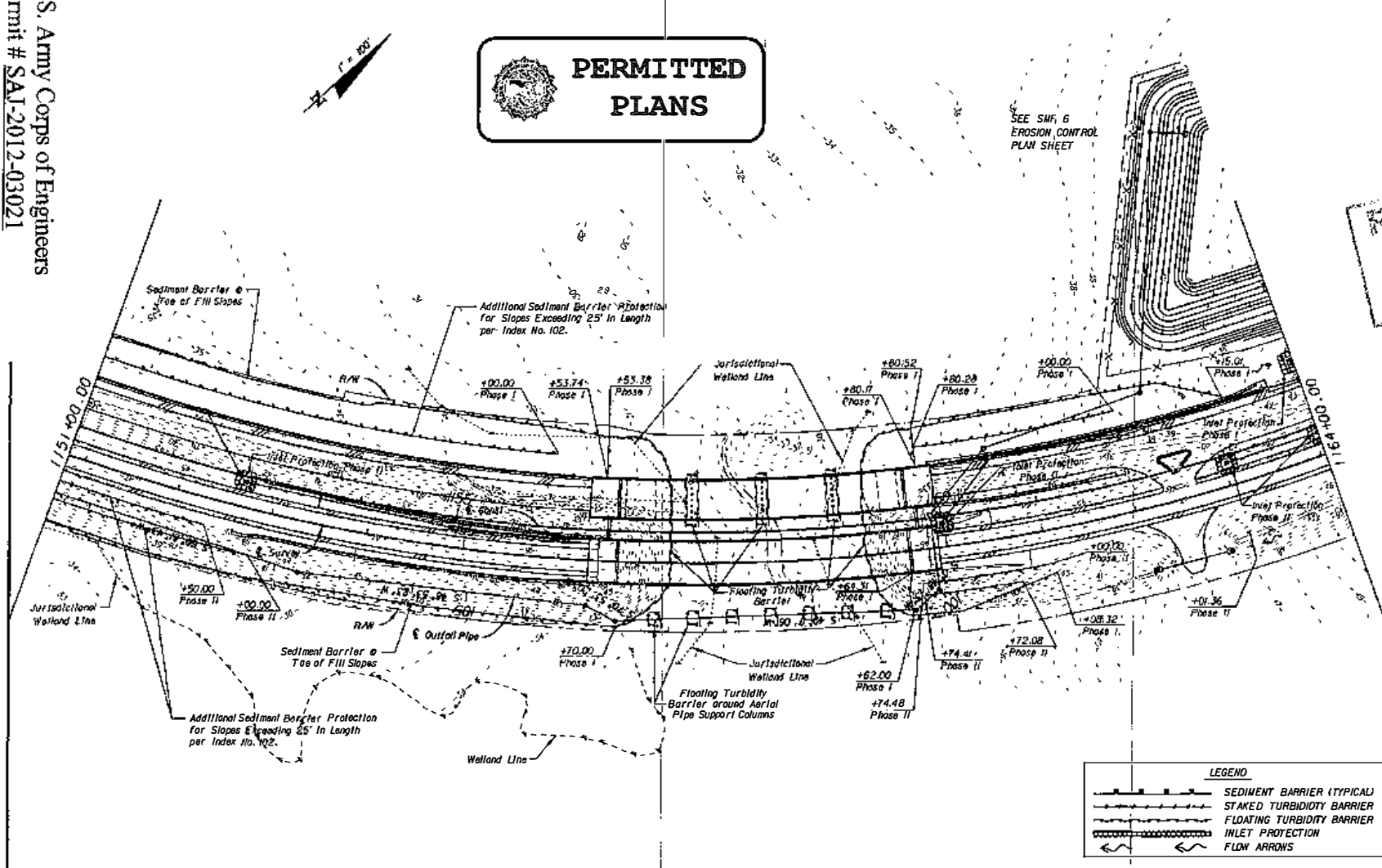

LEGEND

- SEDIMENT BARRIER (TYPICAL)
- STAKED TURBIDITY BARRIER
- FLOWING TURBIDITY BARRIER
- INLET PROTECTION
- FLOW ARROWS

REVISIONS			
DATE	BY	DESCRIPTION	DATE

ECDriver
 1001 CENTRE POINTS BLVD.
 SUITE 104
 TALLAHASSEE, FL 32308-1623
 (904) 833-1000
 ENGINEER OF RECORD: Dora L. Stephens, P.E.
 P.E. NO. 54857

STATE OF FLORIDA DEPARTMENT OF TRANSPORTATION		
ROAD NO.	COUNTY	FINANCIAL PROJECT ID
SR 79	WASHINGTON	220773-7-52-01

EROSION CONTROL PLAN	
SHEET NO.	137

NOTICE: THE OFFICIAL RECORD OF THIS SHEET IS THE ELECTRONIC FILE SIGNED AND SEALED UNDER RULE 68B-23.003, F.A.C.

U.S. Army Corps of Engineers
 Permit # SAJ-2012-03021
 Date: March 1, 2013
 Drawing 23 of 28

FOR PERMIT USE ONLY

RECEIVED
 JUL 11 2012
 CHATTAUGEE

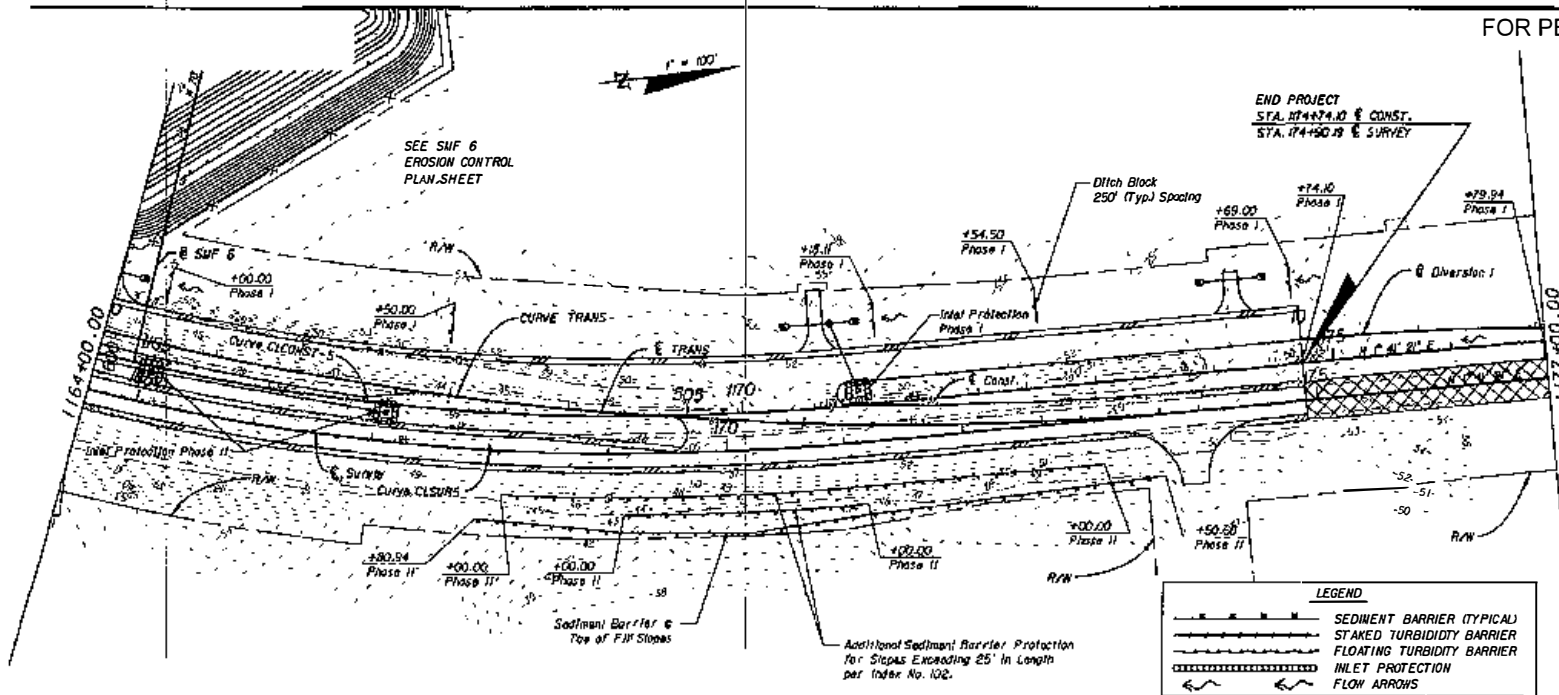

LEGEND	
	SEDIMENT BARRIER (TYPICAL)
	STAKED TURBIDITY BARRIER
	FLOATING TURBIDITY BARRIER
	INLET PROTECTION
	FLOW ARROWS

PERMITTED PLANS

LEGEND	
	SILT FENCE TYPE III (TYPICAL)
	STAKED TURBIDITY BARRIER
	FLOATING TURBIDITY BARRIER
	FLOW ARROWS

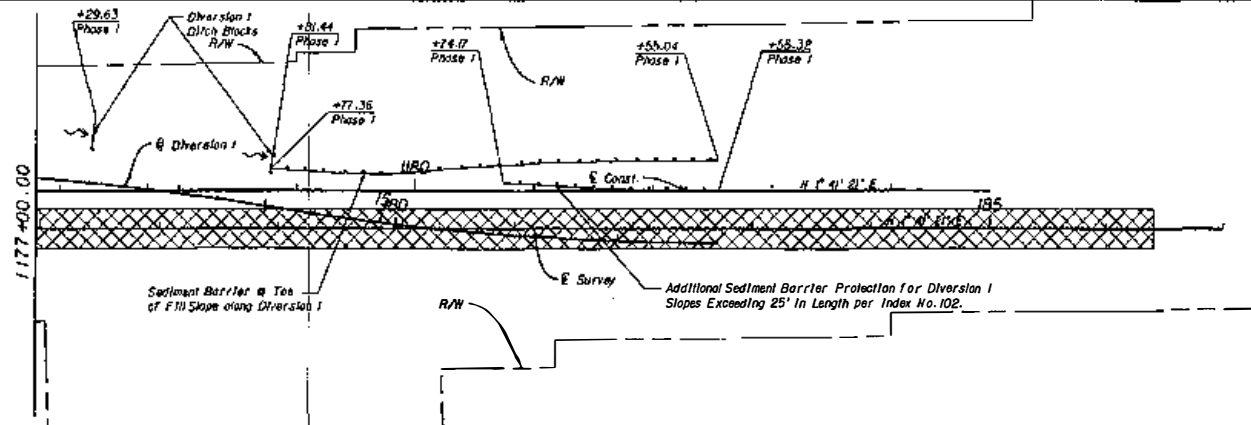

REVISIONS				DATE		BY		DESCRIPTION	
DATE	BY	DESCRIPTION	DATE	BY	DESCRIPTION	DATE	BY	DESCRIPTION	DATE

ECDriver		1001 CENTRE POINT BLVD SUITE 100 TALLAHASSEE, FL 32309-1843 TEL: 904.438.1000 FAX: 904.438.1001		STATE OF FLORIDA DEPARTMENT OF TRANSPORTATION		ROAD NO. COUNTY FINANCIAL PROJECT ID		SHEET NO.	
ENGINEER OF RECORD: CHA T. WATSON, P.E. P.E. NO. 54907		SR 79 WASHINGTON 220773-7-52-01		E.C. DRIVER		4/25/2012		138	

NOTES: THE OFFICIAL RECORD OF THIS SHEET IS THE ELECTRONIC FILE SAVED AND SEALED UNDER RULE 600-23.001, F.A.C.

FOR PERMIT USE ONLY

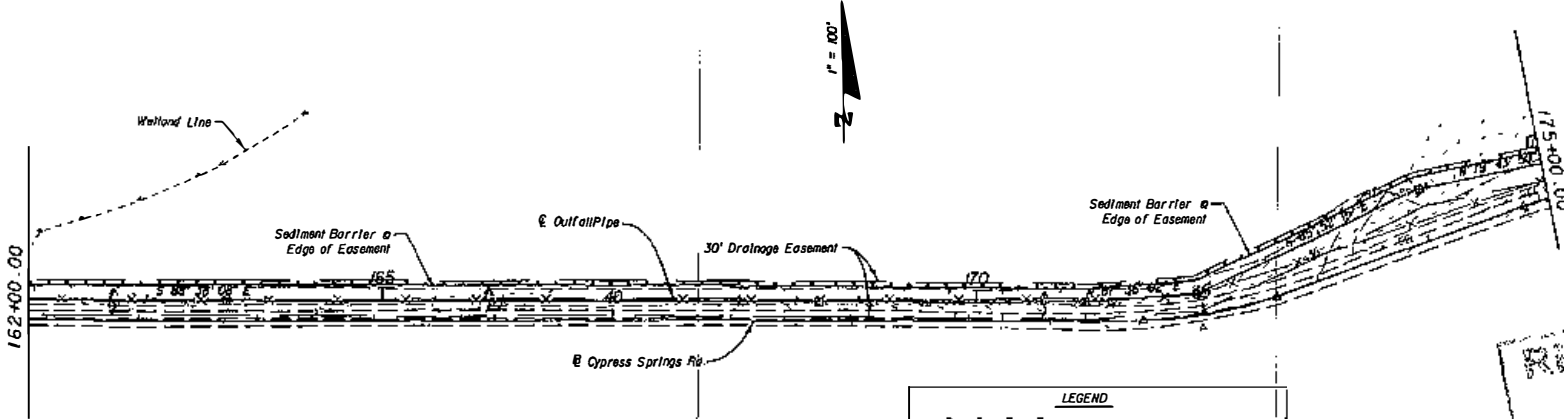

LEGEND	
	SEDIMENT BARRIER (TYPICAL)
	STAKED TURBIDITY BARRIER
	FLOATING TURBIDITY BARRIER
	FLOW ARROWS

RECEIVED
JUL 11 2012
MAINTENANCE

PERMITTED PLANS

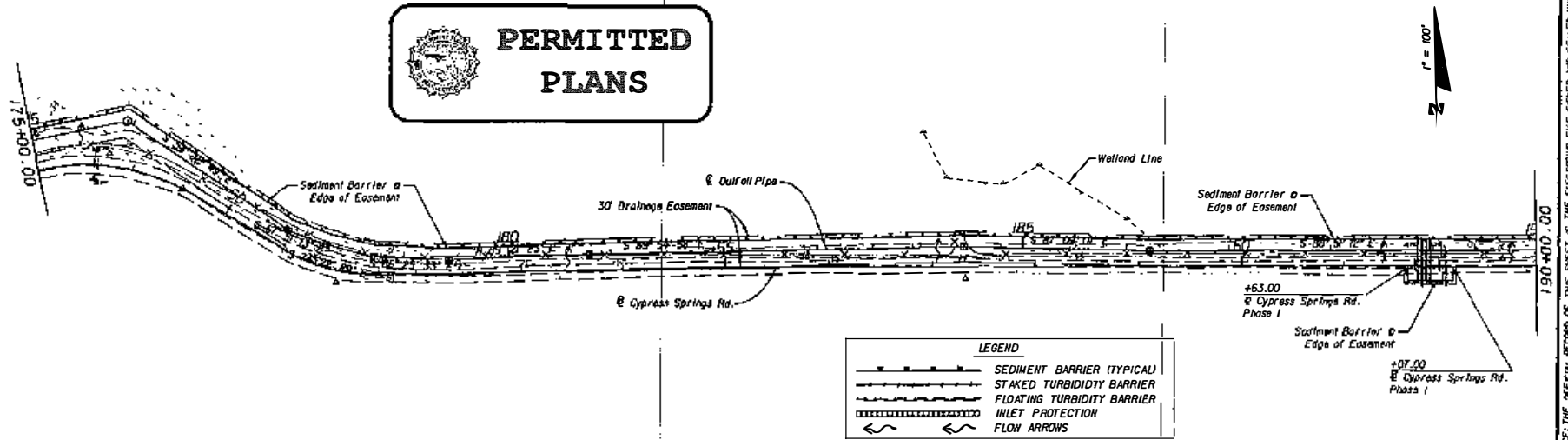

LEGEND	
	SEDIMENT BARRIER (TYPICAL)
	STAKED TURBIDITY BARRIER
	FLOATING TURBIDITY BARRIER
	INLET PROTECTION
	FLOW ARROWS

REVISIONS			
DATE	BY	DESCRIPTION	REVISION

ECDriver
403 CENTRE POINT BLVD.
SUITE 104
TALLAHASSEE, FL 32309-7023
TEL: 904.438.0030
FAX: 904.438.0030
E-MAIL: info@ecdriver.com
P.E. NO. 54807

STATE OF FLORIDA DEPARTMENT OF TRANSPORTATION		
ROAD NO.	COUNTY	FINANCIAL PROJECT ID
SR 79	WASHINGTON	220773-7-52-01

EROSION CONTROL PLAN

SHEET NO.
139

NOTICE: THE OFFICIAL RECORD OF THIS SHEET IS THE ELECTRONIC FILE SHOWN AND SEALED UNDER RULE 60D-2.003, F.A.C.

U.S. Army Corps of Engineers
Permit # SAJ-2012-03021
Date: March 1, 2013
Drawing 24 of 28

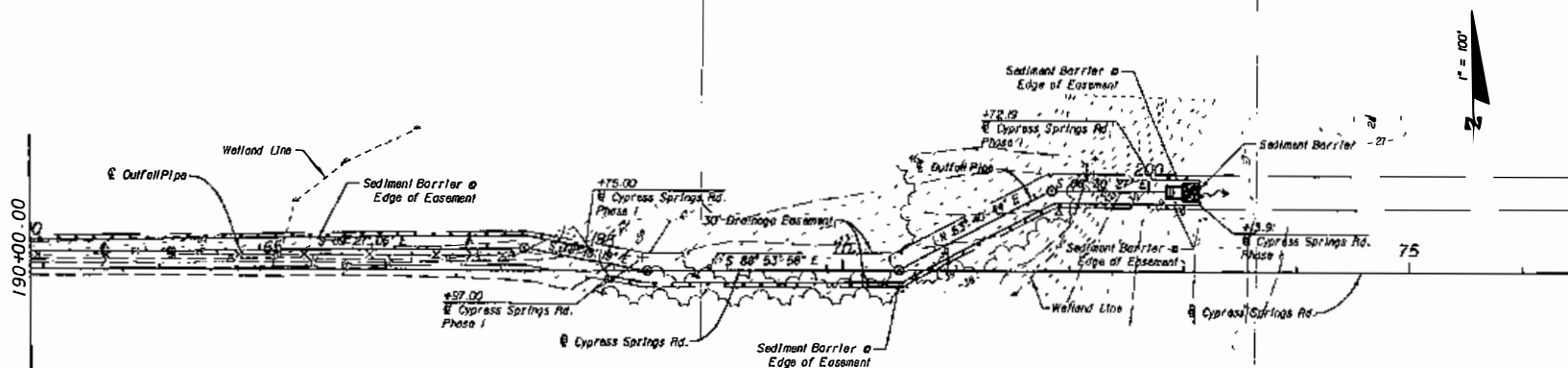

PERMITTED PLANS

$$\frac{r''}{r} = 100^\circ$$

LEGEND

-
- SEDIMENT BARRIER (TYPICAL)
 STAKED TURBIDITY BARRIER
 FLOATING TURBIDITY BARRIER
 INLET PROTECTION
 FLOW ARROWS

RECEIVED
JUL 11 2012
MAYFARID

NOTICE: THE OFFICIAL RECORD OF THIS SHEET IS THE ELECTRONIC FILE SIGNED AND SEALED UNDER RULE 6005-29.001, E.A.C.

REVISIONS		
DESCRIPTION	DATE	BY

ECDriver

1983 CENTRE POINTE BLVD.
SUITE 104
TALLAHASSEE, FL 32308-7623
CERT. OF AUTH. #3838

ENGINEER OF RECORD: Clark L. Stephens, P.E.
P.E. NO. 54867

STATE OF FLORIDA
DEPARTMENT OF TRANSPORTATION

ROAD NO.	COUNTY	FINANCIAL PROJECT ID
SR 79	WASHINGTON	220773-7-52-01

12. 12. 1978

104

1:27:03 PM

2025 RELEASE UNDER E.O. 14176

EROSION CONTROL PLAN

SHEET
NO.

140

U.S. Army Corps of Engineers
Permit # SAJ-2012-03021
Date: March 1, 2013
Drawing 25 of 28



FOR PERMIT USE ONLY



**PERMITTED
PLANS**



RECEIVED
JUL 11 2012
WAFWMD

U.S. Army Corps of Engineers
Permit # SAJ-2012-03021
Date: March 1, 2013
Drawing 26 of 28

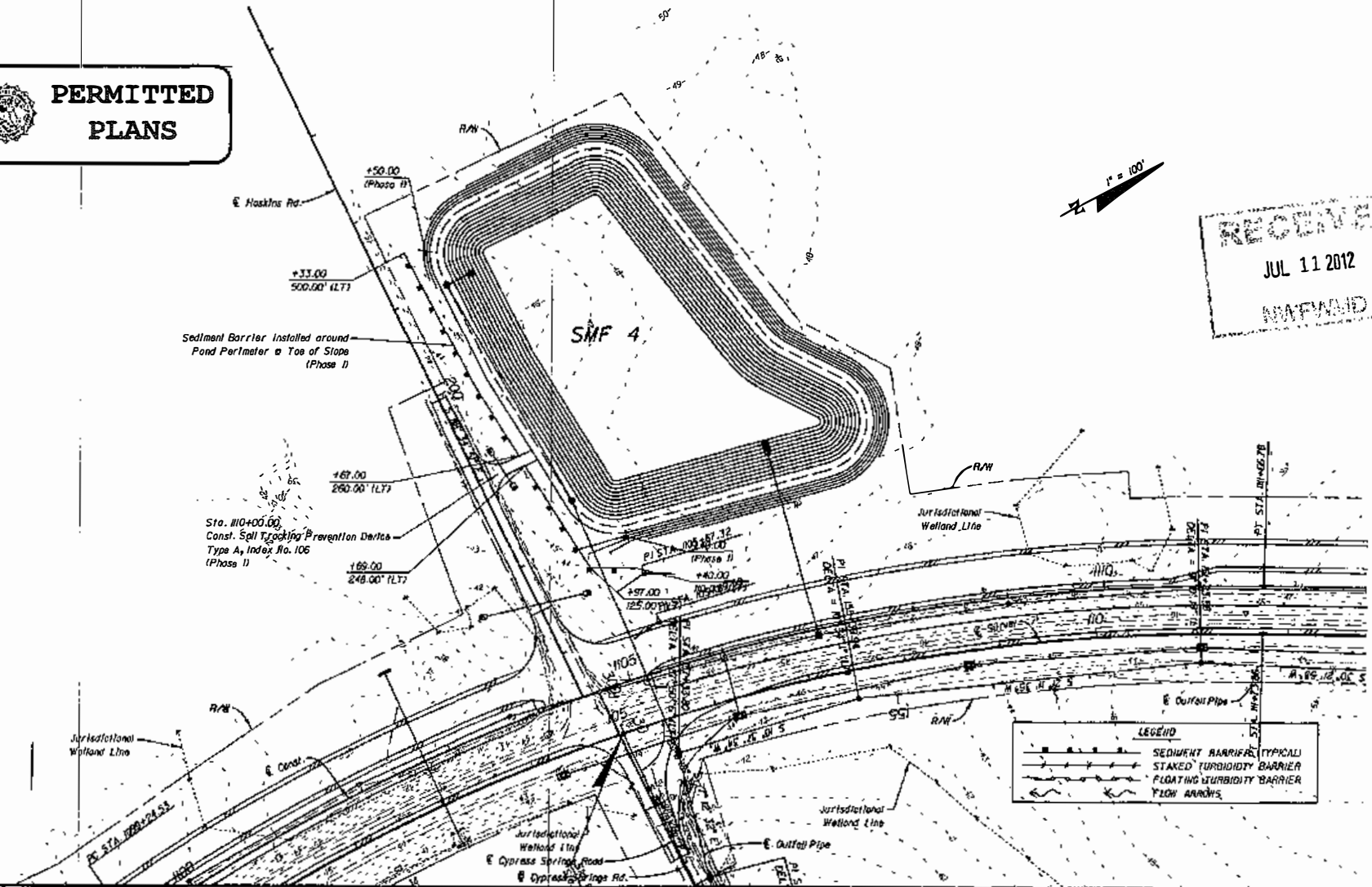

REVISIONS				STATE OF FLORIDA DEPARTMENT OF TRANSPORTATION			EROSION CONTROL PLAN SMF 4	SHEET NO. 141
DATE	BY	DESCRIPTION	DATE	BY	DESCRIPTION	FINANCIAL PROJECT ID		

FOR PERMIT USE ONLY



PERMITTED PLANS



LEGEND	
	SEDIMENT BARRIER (TYPICAL)
	STAKED TURBIDITY BARRIER
	FLOATING TURBIDITY BARRIER
	FLOW ARROWS

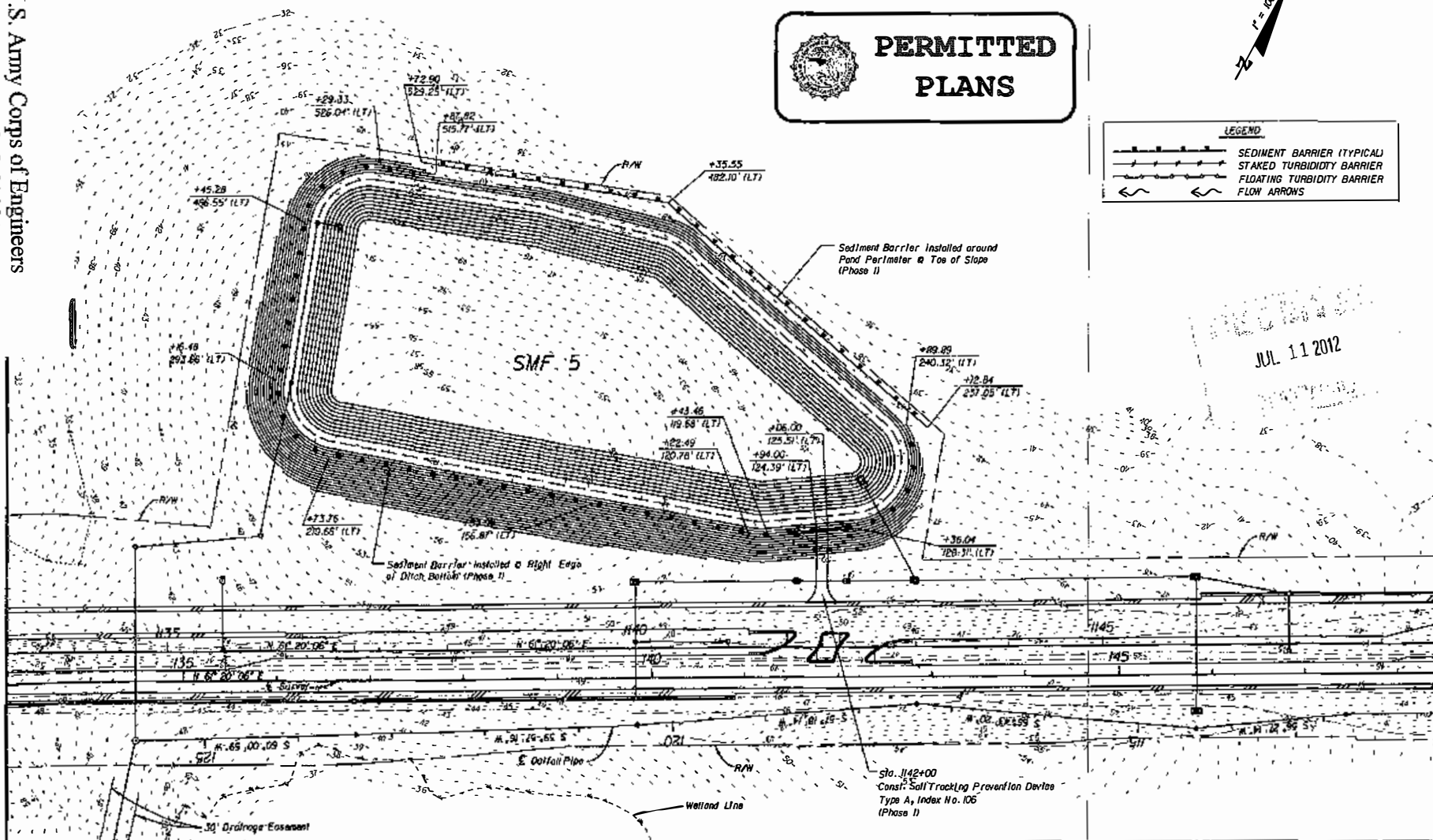

JUL 11 2012

REVISIONS						STATE OF FLORIDA DEPARTMENT OF TRANSPORTATION			EROSION CONTROL PLAN		SHEET NO.
DATE	BY	DESCRIPTION	DATE	BY	DESCRIPTION	ROAD NO.	COUNTY	FINANCIAL PROJECT ID			
						SR 79	WASHINGTON	220773-7-52-01		142	

ECDriver

1001 CENTRE POINTE BLVD.
SUITE 100
TALLAHASSEE, FL 32301-1001
CENT. OF HIGH. #30320

ENGINEER OF RECORD: CHRIS L. SIMPSON, P.E.
P.E. NO. 34007

22.07.2012

4/20/2012

4/20/2012

11/20/2012

NOTICE: THE OFFICIAL RECORD OF THIS SHEET IS THE ELECTRONIC FILE SIGNED AND SEALED UNDER RULE 6105-23.001, F.A.C.

U.S. Army Corps of Engineers
Permit # SAJ-2012-03021
Date: March 1, 2013
Drawing 27 of 28



FOR PERMIT USE ONLY



PERMITTED PLANS

LEGEND	
	SEDIMENT BARRIER (TYPICAL)
	STAKED TURBIDITY BARRIER
	FLOATING TURBIDITY BARRIER
	FLOW ARROWS

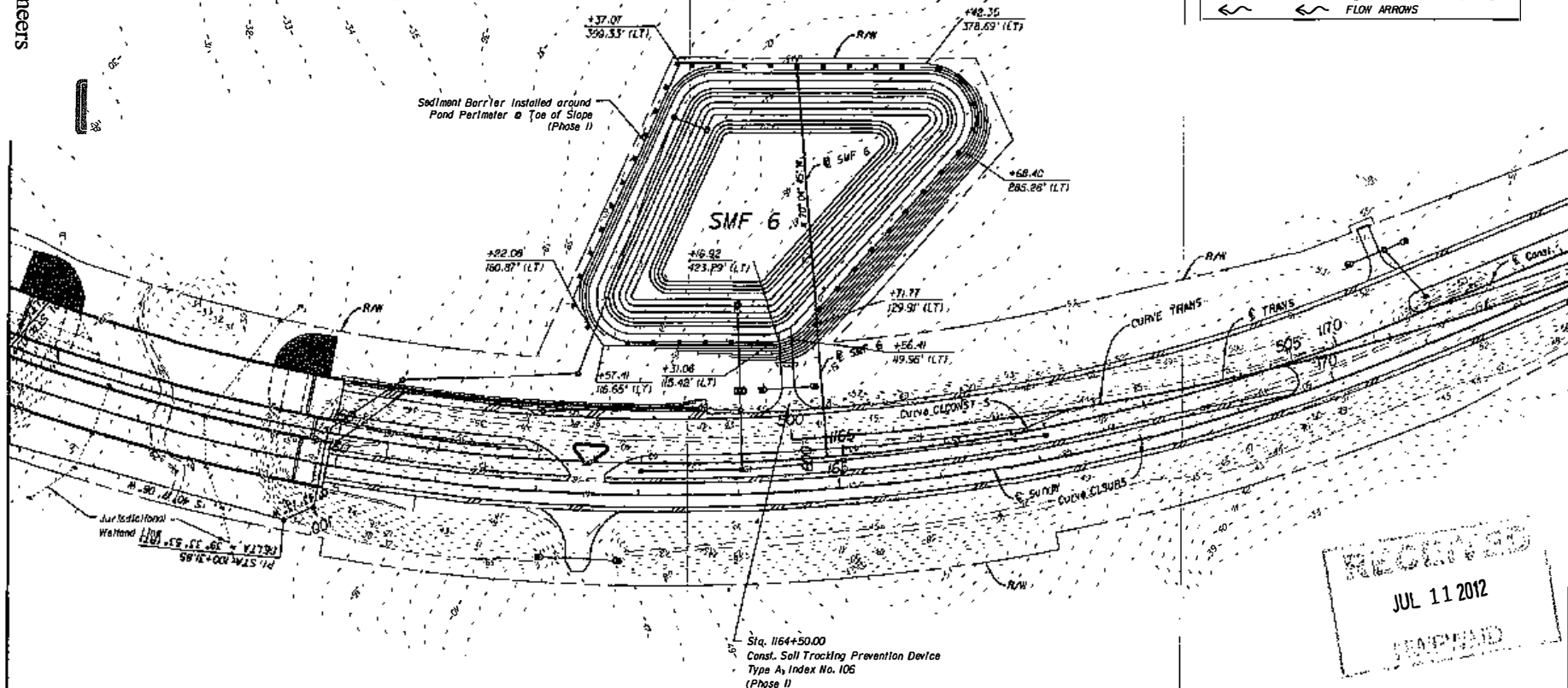

RECEIVED
JUL 11 2012
STATION

REVISIONS					
DATE	BY	DESCRIPTION	DATE	BY	DESCRIPTION

ECDriver — ENGINEER —	901 CENTRE POINT BLVD. SUITE 104 TALLAHASSEE, FL 32304-1803 TEL: 904.644.1111	
	ENGINEER OF RECORD DAVID L. WILSON, P.E. P.E. NO. 54857	

STATE OF FLORIDA DEPARTMENT OF TRANSPORTATION		
ROAD NO.	COUNTY	FINANCIAL PROJECT ID
SR 79	WASHINGTON	220773-7-52-01

EROSION CONTROL PLAN		SHEET NO.
SMF 6		143

NOTICE: THE OFFICIAL RECORD OF THIS SHEET IS THE ELECTRONIC FILE SIGNED AND SEALED UNDER RULE 6805-21.001, F.A.C.

U.S. Army Corps of Engineers
Permit # SAJ-2012-03021
Date: March 1, 2013
Drawing 28 of 28



**NORTHWEST FLORIDA WATER MANAGEMENT DISTRICT
INDIVIDUAL ENVIRONMENTAL RESOURCE PERMIT**

PERMIT NUMBER: 1420

DATE ISSUED: October 26, 2012

PROJECT NAME: Widening SR 79 vicinity of Cypress Creek Bridge

CONSTRUCTION PHASE EXPIRATION DATE: October 26, 2017

A PERMIT AUTHORIZING:

The construction of a surface water management system to provide water quality treatment for 1 inch of runoff and peak discharge attenuation for the 25 year/24 hour storm for the widening of SR 79 from south of Cypress Springs Road to north of Cypress Creek Bridge, in Washington County, from a two-lane undivided roadway to a four-lane divided roadway for a total length of approximately 7,674 linear feet. The stormwater management system includes three wet detention ponds with liners. The stormwater for the widening project will be collected and conveyed by open ditch and piped systems to the stormwater management facilities. The stormwater management facilities will discharge via control structures, into the proposed outfall pipeline which discharges south of Cypress Springs. Authorized impacts to wetlands include a total of 1.721 acres of fill, 0.194 acres of excavation, and 0.894 acres of temporary impacts. Wetland impacts will be offset by providing mitigation at the Sand Hill Lakes Mitigation Bank (SHLMB) in accordance with Statute 373.4137. A Credit Reservation and purchase agreement, signed by the NFWFMD has been provided with the project application that indicates that there are sufficient credits available for purchase at SHLMB. Escrow funds have been set aside for this portion of the SR 79 widening. The Permittee, the Florida Department of Transportation, shall submit all necessary documentation to verify that 2 credits have been purchased from the SHLMB and deducted from the mitigation credit ledger associated with the SHLMB to offset the aforementioned wetland impacts.

LOCATION:

City: Vernon

County: Washington

Address: SR 79 from south of Cypress Springs Road to north of Cypress Creek Bridge

Section(s): 13

Township(s): 3N

Range(s): 15W

Latitude: 30° 39' 53" N

Longitude: 85° 41' 40" W

ISSUED TO:

Applicant

Florida Department of Transportation, District 3

PO Box 607

Chipley, FL 32428

Permittee agrees to hold and save the Northwest Florida Water Management District and its successors harmless from any and all damages, claims, or liabilities which may arise from permit issuance. Said application, including all plans and specifications attached thereto, is by reference made a part hereof.

This permit does not convey to any permittee any property rights nor any rights or privileges other than those specified herein, nor relieve the permittee from complying with any law, regulation or requirement affecting the rights of other bodies or agencies. All structures and works installed by permittee hereunder shall remain the property of the permittee.

This permit is issued pursuant to Part IV of Chapter 373, Florida Statute (F.S.), and Chapter 62-346, Florida Administrative Code, (F.A.C.), and may be revoked, modified or transferred at any time

SAJ-2012-03021(SP-AWP)
Attachement 2
March 1, 2013

Florida Department of Transportation, District 3

Permit Number: 1420

October 26, 2012

Page 2 of 9

pursuant to the appropriate provisions of Chapter 373, Florida Statutes.

This permit also constitutes certification compliance with water quality standards under Section 401 of the Clean Water Act, 33 U.S. Code 1341.

PERMIT IS CONDITIONED UPON:

See conditions on attached "Exhibit A", dated October 26, 2012

See conditions on attached "Exhibit B", dated October 26, 2012

AUTHORIZED BY: Northwest Florida Water Management District
Division of Resource Regulation

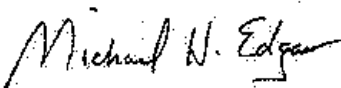
By: 

Michael Edgar, Director, Division of Resource Regulation

Exhibit A

Specific Conditions

The following conditions are in addition to those listed in exhibit B, as provided for in subsection 62-346.381(2), Florida Administrative Code (F.A.C.).

General Specific Conditions

1. Once project construction has been deemed complete, including the re-stabilization of all side slopes, embankments, and other disturbed areas, and before the transfer to the Operation and Maintenance phase, all obsolete erosion control materials shall be removed.
2. Record-keeping. The permittee shall be responsible for keeping records documenting that relevant permit conditions are met. This documentation shall include, at a minimum, the date of each inspection, the name and qualifications of the inspector, any maintenance actions taken, and a determination by the inspector as to whether the system is operating as intended.

Wet Detention

3. The wet detention area shall be inspected periodically for debris and trash built up around the discharge structures. Accumulations of debris and trash that negatively affect the function of the system shall be removed upon discovery.
4. The weir and baffle shall be inspected to confirm that it is free-flowing and clear of debris.
5. The stormwater system shall be inspected periodically for silt accumulation. Accumulations of silt that negatively affect the function of the system shall be removed upon discovery.
6. The stormwater management system shall be inspected by a registered professional at least once every third year after completion of construction and conversion of this permit to the Operation and Maintenance phase, to ensure that the system is functioning as designed and permitted. The Permittee shall submit to the District a completed inspection report on Form No 62-346.900(8) Operation and Maintenance Inspection Certification. The report must be submitted within 30 days of the third anniversary date of conversion to the Operation and Maintenance phase, and at 3 year intervals thereafter. However, a Report shall be submitted to the District within 30 days of any system failure or non-compliance with permit conditions.

Other Specific Conditions

7. Wetland impacts for this project include a total of 1.721 acres of fill, 0.194 acres of excavation, and 0.894 acres of other impacts. Wetland impacts will be mitigated through the Northwest Florida Umbrella, Watershed-Based Regional Mitigation Plan (PLAN) by the purchase of 2 credits from the Sand Hill Lakes Mitigation Bank (SHLMB) in accordance with Statute 373.4137. The permittee shall provide verification to the District that 2 mitigation credits have been purchased and deducted from the mitigation credit ledger associated with SHLMB. All necessary documentation shall be received and approved by District staff prior to transfer to the Operation and Maintenance phase of this permit.

Exhibit B

*Conditions for Issuance of an Individual Permit (Rule 62-346.301, F.A.C.),
Additional Conditions for Issuance of Individual and Conceptual Approval Permits (Rule
62-346.302, F.A.C.), and
General and Special Limiting Conditions (Rule 62-346.381, F.A.C.).
(all Rules Effective November 1, 2010)*

62-346.301 Conditions for Issuance of Individual Permits.

- (1) In order to obtain an individual permit under this chapter, an applicant must provide reasonable assurance that the construction, alteration, operation, maintenance, removal, or abandonment of a surface water management system:
- (a) Will not cause adverse water quantity impacts to receiving waters and adjacent lands;
 - (b) Will not cause adverse flooding to on-site or off-site property;
 - (c) Will not cause adverse impacts to existing surface water storage and conveyance capabilities;
 - (d) Will not adversely impact the value of functions provided to fish and wildlife and listed species by wetlands and other surface waters.
 - (e) Will not cause a violation of the water quality standards set forth in Chapters 62-4, 62-302, 62-520, 62-522, and 62-550, F.A.C., including the provisions of Rules 62-4.243, 62-4.244 and 62-4.246, F.A.C., the antidegradation provisions of paragraphs 62-4.242(1)(a) and (b), F.A.C., subsections 62-4.242(2) and (3), F.A.C., and Rule 62-302.300, F.A.C., and any special standards for Outstanding Florida Waters and Outstanding National Resource Waters set forth in subsections 62-4.242(2) and (3), F.A.C.;
 - (f) Will not cause adverse secondary impacts to the water resources and not otherwise adversely impact the maintenance of surface or ground water levels or surface water flows established pursuant to Section 373.042, F.S.
 - (g) Will be capable, based on generally accepted engineering and scientific principles, of being performed and of functioning as proposed;
 - (h) Will be conducted by an entity with the financial, legal and administrative capability of ensuring that the activity will be undertaken in accordance with the terms and conditions of the permit, if issued; and
 - (i) Will comply with any applicable special basin or geographic area criteria rules incorporated by reference in this chapter. When karst features exist on the site of a proposed stormwater management system, in addition to paragraphs (a) through (h) above, the applicant must provide reasonable assurance that untreated stormwater from the proposed system will not reach the Floridan Aquifer through sinkholes, solution pipes, or other karst features.
- (2) In instances where an applicant is unable to meet water quality standards because existing ambient water quality does not meet standards and the system will contribute to this existing condition, mitigation for water quality impacts can consist of water quality enhancement. In these cases, the applicant must implement mitigation measures that are proposed by or acceptable to the applicant that will cause net improvement of the water quality in the receiving waters for those parameters that do not meet standards.
- (3) In addition to the criteria in subsections 62-346.301(1) and (2), F.A.C., an applicant proposing the construction, alteration, operation, maintenance, abandonment, or removal of a dry storage facility for 10 or more vessels that is functionally associated with a boat launching area must provide reasonable assurance that the facility, taking into consideration any secondary impacts, will meet the public interest test of Section 373.414(1)(a), F.S., including the potential adverse impacts

Exhibit B (cont'd)

to manatees.

(4) The standards and criteria, including the provisions for elimination or reduction of impacts, and the mitigation provisions contained in sections 10.2.1 through 10.2.1.3 and sections 10.3 through 10.3.8, respectively, of Applicant's Handbook Volume I adopted by reference in Rule 62-346.091, F.A.C., shall determine whether the reasonable assurances required by subsection 62-346.301(1) and Rule 62-346.302, F.A.C., have been provided, as applicable. Forms for demonstrating that an applicant has met the financial responsibility requirements of sections 10.3.7 through 10.3.7.9 of Applicant's Handbook Volume I are hereby adopted and incorporated by reference as:

(a) Form 62-346.900(12), "State of Florida Performance Bond To Demonstrate Financial Assurance for Mitigation" November 1, 2010;

(b) Form 62-346.900(13), "State of Florida Irrevocable Letter of Credit To Demonstrate Financial Assurance for Mitigation" November 1, 2010;

(c) Form 62-346.900(14), "Certificate I To _____ (Name of Issuing Bank) Irrevocable Letter of Credit No. _____" November 1, 2010;

(d) Form 62-346.900(15), "Certificate II To _____ (Name of Issuing Bank) Irrevocable Nontransferable Standby Letter of Credit No. _____" November 1, 2010;

(e) Form 62-346.900(16), "State of Florida Standby Trust Fund Agreement to Demonstrate Financial Assurance for Mitigation Activities" November 1, 2010;

(f) Form 62-346.900(17), "State of Florida Trust Fund Agreement to Demonstrate Financial Assurance for Mitigation Activities" November 1, 2010.

These forms are contained in Appendix C of the "Department of Environmental Protection and Northwest Florida Water Management District Environmental Resource Permit Applicant's Handbook-Volume I (General and Environmental)," and may be obtained from the locations provided in Rule 62-346.900, F.A.C.

Rulemaking Authority 373.026(7), 373.043, 373.4145, 373.418, 403.805(1) FS. Law Implemented 373.042, 373.409, 373.413, 373.4142, 373.4145, 373.416, 373.4132, 373.426, 373.429 FS. History- New 10-1-07, Amended 11-1-10.

62-346.302 Additional Conditions for Issuance of Individual and Conceptual Approval Permits.

(1) In addition to the conditions set forth in Rule 62-346.301, F.A.C., in order to obtain an individual (including conceptual approval) permit under this chapter, an applicant must provide reasonable assurance that the construction, alteration, operation, maintenance, removal, and abandonment of a system:

(a) Located in, on, or over wetlands or other surface waters will not be contrary to the public interest, or if such an activity significantly degrades or is within an Outstanding Florida Water, that the activity will be clearly in the public interest, as determined by balancing the following criteria as set forth in sections 10.2.3 through 10.2.3.7 of Applicant's Handbook Volume I adopted by reference in Rule 62-346.091, F.A.C.:

1. Whether the activity will adversely affect the public health, safety, or welfare or the property of others;
2. Whether the activity will adversely affect the conservation of fish and wildlife, including endangered or threatened species, or their habitats;
3. Whether the activity will adversely affect navigation or the flow of water or cause harmful erosion or shoaling;
4. Whether the activity will adversely affect the fishing or recreational values or marine productivity in the vicinity of the activity;

Exhibit B (cont'd)

5. Whether the activity will be of a temporary or permanent nature;
6. Whether the activity will adversely affect or will enhance significant historical and archaeological resources under the provisions of Section 267.061, F.S.; and
7. The current condition and relative value of functions being performed by areas affected by the proposed activity.
 - (b) Will not cause unacceptable cumulative impacts upon wetlands and other surface waters as set forth in sections 10.2.8 through 10.2.8.2 of Applicant's Handbook Volume I.
 - (c) Located in, adjacent to or in close proximity to Class II waters or located in Class II waters or Class III waters classified by the Department of Agriculture and Consumer Services as approved, restricted, conditionally approved, or conditionally restricted for shellfish harvesting as set forth or incorporated by reference in Chapter 5L-1, F.A.C. (July 29, 2008), will comply with the additional criteria in section 10.2.5 of Applicant's Handbook Volume I.
 - (d) Which constitute vertical seawalls in estuaries or lagoons, will comply with the additional criteria provided in section 10.2.6 of Applicant's Handbook Volume I.
- (2) When determining whether a permit applicant has provided reasonable assurances that the Department's permitting standards will be met, the Department shall take into consideration the applicant's violation of any Department rules adopted pursuant to Sections 403.91 through 403.929, F.S., (1984 Supp.), as amended, or any Department rules adopted pursuant to Part IV, Chapter 373, F.S., relating to any other project or activity and efforts taken by the applicant to resolve these violations.

Rulemaking Authority 373.026(7), 373.043, 373.414(9), 403.805(1) FS. Law Implemented 373.042, 373.413, 373.414, 373.416, 373.426, 380.23 FS. History-New 11-1-10.

62-346.381 General and Special Limiting Conditions.

- (1) The following general conditions shall be applicable to and binding on all individual permits issued pursuant to this chapter, unless the conditions are not applicable to the activity authorized by the permit, or where the conditions must be modified to accommodate unique, project-specific conditions.
 - (a) All activities authorized by this permit shall be implemented as set forth in the plans, specifications and performance criteria approved by this permit. Any deviation from the permitted activity and the conditions for undertaking that activity may constitute grounds for revocation or enforcement action by the Department, unless a modification has been applied for and approved in accordance with Rule 62-346.100, F.A.C.
 - (b) This permit or a copy thereof, complete with all conditions, attachments, exhibits, and modifications, shall be kept at the work site of the permitted activity during the construction phase. The complete permit shall be available for review at the work site upon request by the Department staff. The permittee shall require the contractor to review the complete permit prior to commencement of the activity authorized by this permit. A weather-resistant sign, measuring at least 8 1/2 inches by 11 inches, and including the permit number (in lettering that is easily visible from the access road) shall be placed on the property facing the road.
 - (c) Activities approved by this permit shall be conducted in a manner that does not cause violations of state water quality standards.
 - (d) Immediately prior to, during construction, and for the period of time after construction to allow for stabilization of all disturbed areas, the permittee shall implement and maintain erosion and sediment control best management practices, such as silt fences, erosion control blankets, mulch, sediment traps, polyacrylamide (PAM), temporary grass seed, permanent sod, and floating turbidity screens to retain sediment on-site and to prevent violations of state water quality standards. These

Exhibit B (cont'd)

devices shall be installed, used, and maintained at all locations where the possibility of transferring suspended solids into the receiving waterbody exists due to the permitted work, and shall remain in place at all locations until construction is completed and soils are permanently stabilized. All best management practices shall be in accordance with the guidelines and specifications described in the State of Florida Erosion and Sediment Control Designer and Reviewer Manual (Florida Department of Transportation and Florida Department of Environmental Protection, 2007), unless a project-specific erosion and sediment control plan is approved as part of the permit. If project-specific conditions require additional measures during any phase of construction or operation to prevent erosion or control sediments beyond those specified in the approved erosion and sediment control plan, the permittee shall implement additional best management practices as necessary, in accordance with the guidelines and specifications in the State of Florida Erosion and Sediment Control Designer and Reviewer Manual, Prepared for Florida Department of Transportation & Florida Department of Environmental Protection by HydroDynamics Incorporated in cooperation with Stormwater Management Academy, June 2007. The permittee shall correct any erosion or shoaling that causes adverse impacts to the water resources as soon as practicable. Once project construction has been deemed complete, including the re-stabilization of all side slopes, embankments, and other disturbed areas, and before conversion of the permit to the operation and maintenance phase, all silt screens and fences, temporary baffles, and other materials that are no longer required for erosion and sediment control shall be removed.

(e) Stabilization measures shall be initiated for erosion and sediment control on disturbed areas as soon as practicable in portions of the site where construction activities have temporarily or permanently ceased, but in no case more than seven days after the construction activity in that portion of the site has temporarily or permanently ceased.

(f) At least 48 hours prior to commencement of activity authorized by this permit, the permittee shall submit to the Department a fully executed Form 62-346.900(3), "Construction Commencement Notice," incorporated by reference herein, indicating the expected start and completion dates. Information on how a copy of this form may be obtained is contained in Rule 62-346.900, F.A.C.

(g) Within 30 days after completion of construction of the whole system, or independent portion of the system, the permittee shall notify the Department that construction has been completed and the system is ready for inspection by submitting one of the following forms to the Department office that issued the permit:

1. For systems other than those that serve an individual, private single-family residential dwelling unit, duplex, triplex, or quadruplex, Form 62-346.900(4), "As-Built Certification by a Registered Professional." If the registered professional has certified that the system has been built substantially in compliance with the plans and specifications in the permit, and that such system is ready for inspection, the permittee shall also submit Form 62-346.900(6), "Request for Conversion of Environmental Resource Individual Permit Construction Phase to Operation and Maintenance Phase." The system shall not be used and operated for its permitted purpose until the Department has approved the request to authorize the operation phase, in accordance with Rule 62-346.095, F.A.C. The "As-Built Certification" shall be for the purpose of determining if the work was completed in substantial compliance with permitted plans and specifications. The certification shall include as-built drawings in the form of the permitted drawings that clearly show any substantial deviations made during construction. The plans must be clearly labeled as "as-built" or "record" drawings.

2. For systems that serve an individual, private single-family residential dwelling unit, duplex, triplex, or quadruplex, Form 62-346.900(5), "Construction Completion and Inspection Certification for a System Serving an Individual, Private Single-Family Dwelling Unit."

(h) Each phase or independent portion of the permitted system must be completed in accordance with the permitted plans and permit conditions prior to the initiation of the permitted use of the

Exhibit B (cont'd)

facility, or the site infrastructure located within the area served by that portion or phase of the system.

(i) The permittee shall remain liable for compliance with the operation and maintenance of the system in accordance with the terms and conditions of the permit for the life of the system, unless such permit is transferred to an acceptable responsible entity in accordance with Rules 62-346.095 and 62-346.130, F.A.C. Once transfer of the permit has been approved by the Department, the transferee shall be liable for compliance with all the terms and conditions of the operation and maintenance phase of the permit for the life of the system.

(j) Should any other regulatory agency require changes to the permitted system, the permittee shall notify the Department in writing of the changes prior to implementation so that the Department can determine whether a permit modification is appropriate.

(k) This permit does not convey to the permittee or create in the permittee any property right or any interest in real property, nor does it authorize any entrance upon or activities on property that is not owned or controlled by the permittee, or convey any rights or privileges other than those specified in this permit or Chapter 62-346, F.A.C. Permittees having the right to exercise the power of eminent domain or who had a contract to purchase the property subject to this permit shall not commence any work under this permit until the permittee has provided the Department with proof of transfer of ownership of the property in the name of the permittee. If such transfer of ownership does not occur, the permittee shall surrender this permit, and the permit shall be null and void.

(l) Pursuant to Section 373.422, F.S., prior to conducting any activities on sovereign submerged lands, the permittee must receive all necessary approvals and authorizations under Chapters 253 and 258, F.S. Written authorization that requires formal execution by the Board of Trustees of the Internal Improvement Trust Fund shall not be considered received until it has been fully executed.

(m) The permittee shall hold and save the Department harmless from any and all damages, claims, or liabilities that may arise by reason of the construction, alteration, operation, maintenance, removal, abandonment or use of any system authorized by the permit.

(n) The permittee shall notify the Department in writing at least 30 days prior to any sale, conveyance, or other transfer of ownership or control of a permitted system or the real property on which the permitted system is located. Where ownership of the land subject to the permit was demonstrated through a long-term lease, the lessee must have transferred ownership and control of the permitted system to the current landowner or new lessee, effective prior to or on the date of expiration of the lease. All transfers of ownership or transfers of a permit are subject to the requirements of Rules 62-346.095 and 62-346.130, F.A.C.

(o) Upon reasonable notice to the permittee, Department staff with proper identification shall have permission to enter, inspect, sample and test the system to ensure conformity with the plans and specifications authorized in the permit.

(p) If historical or archaeological artifacts are discovered at any time on the project site, the permittee shall immediately notify the Department.

(q) The permittee shall immediately notify the Department in writing of any previously submitted information that is later discovered to be inaccurate.

(r) The issuance of this permit does not relieve the permittee from the responsibility to obtain any other required federal, state, and local authorizations.

(s) The permittee is advised that, pursuant to Section 556.105, F.S., excavating contractors are required to provide certain information concerning the excavation that may affect underground facilities through the one-call notification system not less than two, nor more than five, business days before beginning any excavation.

(2) In addition to those general conditions set forth in subsection (1) above, the Department shall impose on any individual permit granted under this chapter such reasonable project-specific special

Exhibit B (cont'd)

conditions as are necessary to assure that the permitted system will not be harmful to the water resources, as set forth in Rules 62-346.301 and 62-346.302, as applicable, F.A.C., and the Applicant's Handbook Volumes I and II.

Rulemaking Authority 373.026(7), 373.043, 373.4145, 373.418, 403.805(1) FS. Law Implemented 373.117, 373.409, 373.413, 373.4142, 373.4145, 373.416, 373.418, 373.419, 373.422, 373.423, 373.426, 373.428, 403.0877 FS. History-New 10-1-07, Amended 11-1-10.

STANDARD PROTECTION MEASURES FOR THE EASTERN INDIGO SNAKE

1. An eastern indigo snake protection/education plan shall be developed by the applicant or requestor for all construction personnel to follow. The plan shall be provided to the Service for review and approval at least 30 days prior to any clearing activities. The educational materials for the plan may consist of a combination of posters, videos, pamphlets, and lectures (e.g., an observer trained to identify eastern indigo snakes could use the protection/education plan to instruct construction personnel before any clearing activities occur). Informational signs should be posted throughout the construction site and along any proposed access road to contain the following information:
 - a. a description of the eastern indigo snake, its habits, and protection under Federal Law;
 - b. instructions not to injure, harm, harass or kill this species;
 - c. directions to cease clearing activities and allow the eastern indigo snake sufficient time to move away from the site on its own before resuming clearing; and,
 - d. telephone numbers of pertinent agencies to be contacted if a dead eastern indigo snake is encountered. The dead specimen should be thoroughly soaked in water and then frozen.
2. If not currently authorized through an Incidental Take Statement in association with a Biological Opinion, only individuals who have been either authorized by a section 10(a)(1)(A) permit issued by the Service, or by the State of Florida through the Florida Fish Wildlife Conservation Commission (FWC) for such activities, are permitted to come in contact with an eastern indigo snake.
3. An eastern indigo snake monitoring report must be submitted to the appropriate Florida Field Office within 60 days of the conclusion of clearing phases. The report should be submitted whether or not eastern indigo snakes are observed. The report should contain the following information:
 - a. any sightings of eastern indigo snakes and
 - b. other obligations required by the Florida Fish and Wildlife Conservation Commission, as stipulated in the permit.

Revised February 12, 2004

AS-BUILT CERTIFICATION BY PROFESSIONAL ENGINEER

Submit this form and one set of as-built engineering drawings to the U.S. Army Corps of Engineers, Enforcement Section, Attn: Terry Wells, 41 North Jefferson St., Suite 301, Pensacola, FL 32502. If you have questions regarding this requirement, please contact the Enforcement Branch at 904-232-3131.

1. Department of the Army Permit Number: SAJ-2012-03021(SP-AWP)

2. Permittee Information:

Name: _____

Address: _____

3. Project Site Identification (physical location/address):

4. As-Built Certification: I hereby certify that the authorized work, including any mitigation required by Special Conditions to the permit, has been accomplished in accordance with the Department of the Army permit with any deviations noted below. This determination is based upon on-site observation, scheduled, and conducted by me or by a project representative under my direct supervision. I have enclosed one set of as-built engineering drawings.

Signature of Engineer

Name (*Please type*)

(FL, PR, or VI) Reg. Number

Company Name

City

State

ZIP

(Affix Seal)

Date

Telephone Number

SAJ-2012-03021(SP-AWP)
Attachement 4
March 1, 2013

Identify any deviations from the approved permit drawings and/or special conditions (attach additional pages if necessary):

[illegible]