



# Florida Department of Transportation

JEB BUSH  
GOVERNOR

JOSÉ ABREU  
SECRETARY

Environmental Management Office  
Post Office Box 607  
Chipley, FL 32428  
850-638-0250, Ext. 505

April 29, 2005

Ms. Connie Bersok  
Florida Department of Environmental Protection  
Bureau of Submerged Lands and Environmental Resources  
Twin Towers Office Building  
2600 Blair Stone Road  
Tallahassee, FL 32399-2400

RE: Mitigation Inventory

Dear Ms. Bersok:

Attached is the Mitigation Inventory for the upcoming work program.

If you have any questions or need further information, please call me at the above number or SunCom 767-1505.

Sincerely,

*Blair A. Martin*  
for

Joy Giddens  
Assistant Environmental Permits Coordinator

JG/rg  
Attachments

cc: Joshua Boan – DOT – Tallahassee, Chelcy Patterson - Tallahassee  
Duncan Cairns - NFWMD  
Blair Martin, Tommy Barfield, Regina Battles, Cheryl McCall – DOT



## Florida Department of Transportation

JEB BUSH  
GOVERNOR

JOSÉ ABREU  
SECRETARY

Environmental Management Office  
Post Office Box 607  
Chipley, FL 32428  
850-638-0250, Ext. 505

April 29, 2005

Mr. Duncan Cairns  
Northwest Florida Water Management District  
81 Water Management Drive  
Havana, FL 32333-9700

RE: Mitigation Inventory

Dear Mr. Cairns:

Attached is the Mitigation Inventory for the upcoming work program.

If you have any questions or need further information, please call me at the above number or SunCom 767-1505.

Sincerely,

A handwritten signature in blue ink that reads "Blair A. Martin" with a small "fow" written below it.

Joy Giddens  
Assistant Environmental Permits Coordinator

JG/rg  
Attachments

cc: Joshua Boan – DOT – Tallahassee, Chelcy Patterson - Tallahassee  
Connie Bersok – DEP  
Blair Martin, Tommy Barfield, Regina Battles, Cheryl McCall – DOT

FDOT District 3 ENVIRONMENTAL IMPACT INVENTORY - FY \_\_ 2005/2006

Work Program Item Number/Fincial Management Number	Project Description	Water Management District	Wetland Location (Include Sec., Rnge., Twnship)	Name of Drainage Basin	Mitigation Date	Begin Construction Date	Florida Land Use Classification Codes (List Each Wetland Type Separately)	Impact Acres Per Each FLUCCS Type	Wetland Quality	Water Use Classification	Name of Surface Waters or Wetlands	State/Regional Designation(s)	Listed Species Affected Y/N	Permit Application Date
FIN 2225902	SR 8 (I-10) from East of Rest Area to Pvt. Chg. West CR 361	NWFWMD	Sect.16,17,18,19 R-1W T-1N	Lake Munson & Fred George	2005/2006	09/14/2006	640	1.9	Low	Class 3	No Name	None	No	12/06/2004
FIN 4090241	SR 73 from SR 71 to North of SR 20	NWFWMD	Sect.11,3,33,28, 21,22,15,10,2, 35,26,23,14,1,34 R-10W T-3S,T-2S,T1S	Cypress Creek	2005/2006	12/21/2006	640	3.9	Low	Class 3	Cypress Creek	None	No	04/07/2005
FIN 4162401	SR 79 Over Open Creek Bridge Replacement	NWFWMD	Sect.24,19 R-15W,14W T-4N	Open Creek	2005/2006	03/29/2007	615	1.99	Medium	Class 3	Open Creek	None	No	05/06/2005

FDOT District 3 ENVIRONMENTAL IMPACT INVENTORY - FY \_\_ 2008/2009

Work Program Item Number/Fincial Management Number	Project Description	Water Management District	Wetland Location (Include Sec., Rnge., Twship)	Name of Drainage Basin	Mitigation Date	Begin Construction Date	Florida Land Use Classification Codes (List Each Wetland Type Separately)	Impact Acres Per Each FLUCCS Type	Wetland Quality	Water Use Classification	Name of Surface Waters or Wetlands	State/Regional Designation(s)	Listed Species Affected Y/N	Permit Application Date
FIN 4071671	SR 79 Holmes Creek Bridge Replacement & Approaches from McFatter Ave. to North of CR 279	NWFWMD	Sect.26,35 R-15W T-3N	Holmes Ceek	2008/2009	09/17/2009	510 630	0.48 1.43 Total Acres-1.91	Medium Medium	Class 3-Wetlands Class 2-Creek	Holmes Creek Holmes Creek	Florida	Goldstripe Darter (Possible)	09/01/2005

# Washington County Bridge Replacement

SR 79  
Over Open Creek (Bridge)

FPID: 416240-1-32-01

Section No.: 61040

Bridge No.: 610910

County: Washington

PROJECT LIMITS  
CMP 27.923 to CMP 28.765

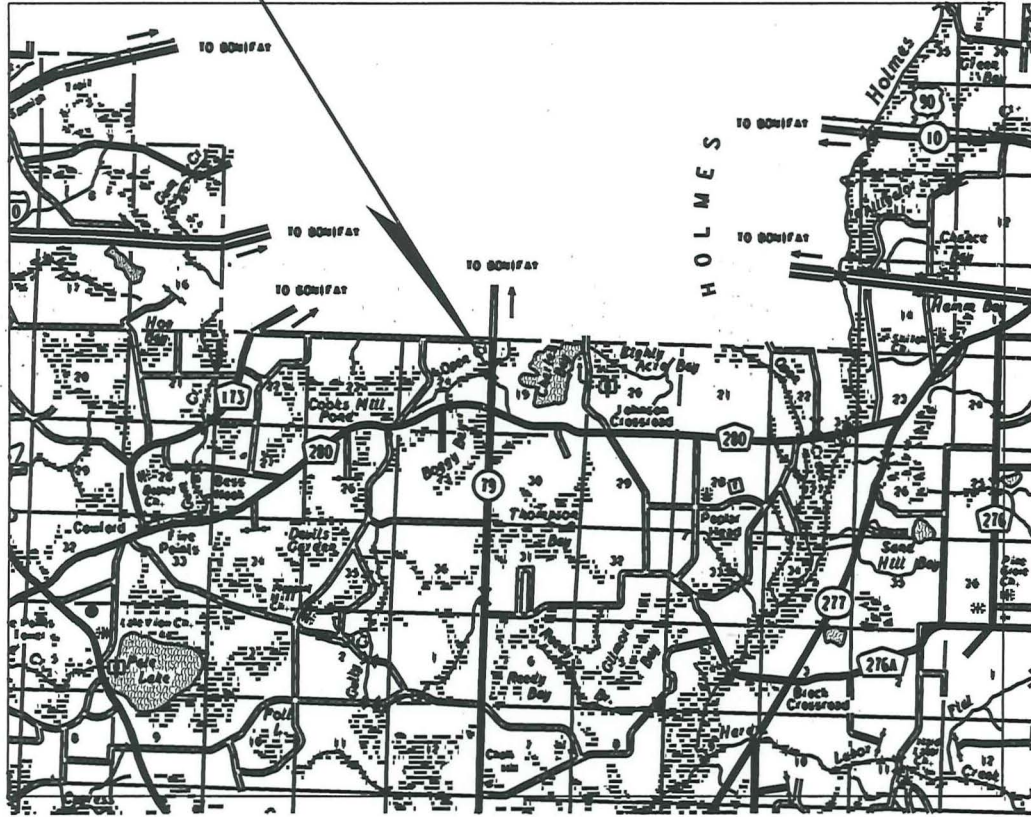

PROJECT LOCATION MAP

# LOCATION MAP

FINANCIAL PROJECT ID 409024-1-52-01

CALHOUN COUNTY

SR 73 FROM SR 71 TO SR 20

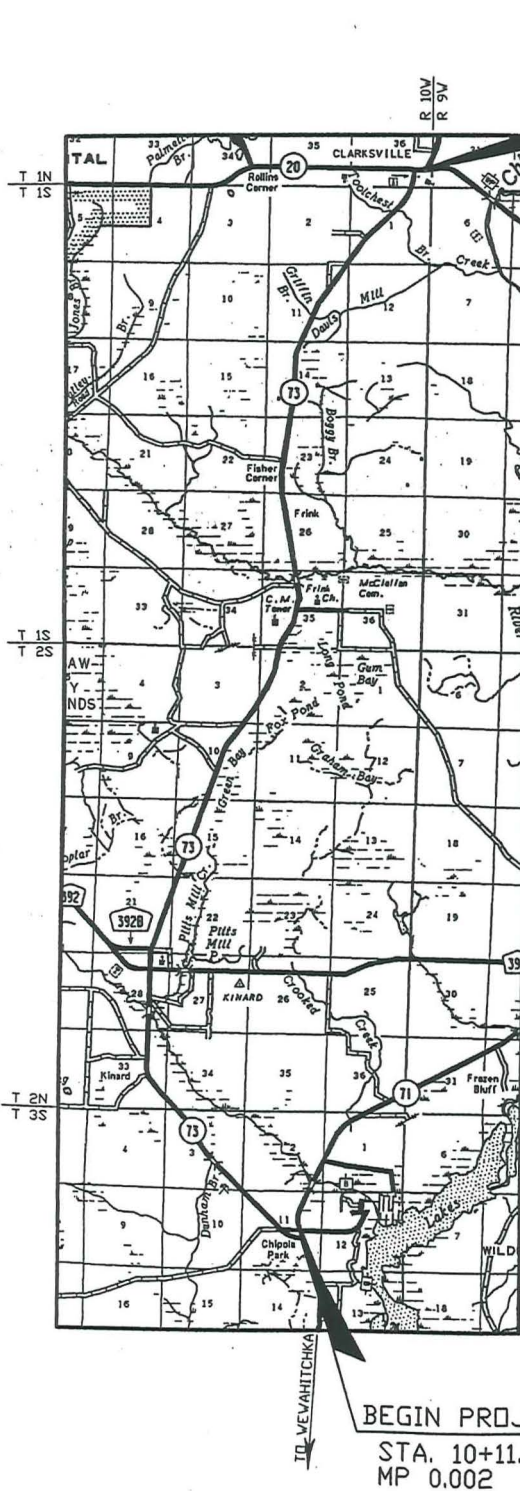

**END PROJECT**

STA. 833+26.09  
MP 15.595

**PROJECT LOCATION**

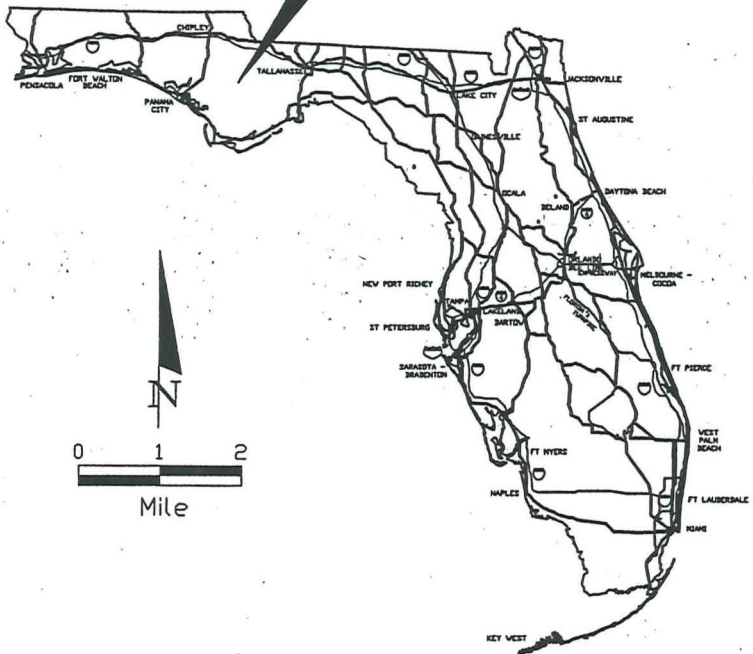

Project Location:

From Pensacola, Take Interstate 10 East to U.S. 231 South in Cottondale. Take U.S. 231 South to SR 20. Take SR 20 East to SR 73 South. The intersection of SR 20 and SR 73 South is the End Project location.

LENGTH OF PROJECT		
	LINEAR FEET	MILES
ROADWAY	81,867.74	15.505
BRIDGES	N/A	N/A
NET LENGTH OF PROJECT	81,867.74	15.505
EXCEPTIONS	465.57	0.088
GROSS LENGTH OF PROJECT	82,333.31	15.593

FDOT PROJECT MANAGER: LISA SLAY

R-15-W  
R-14-W

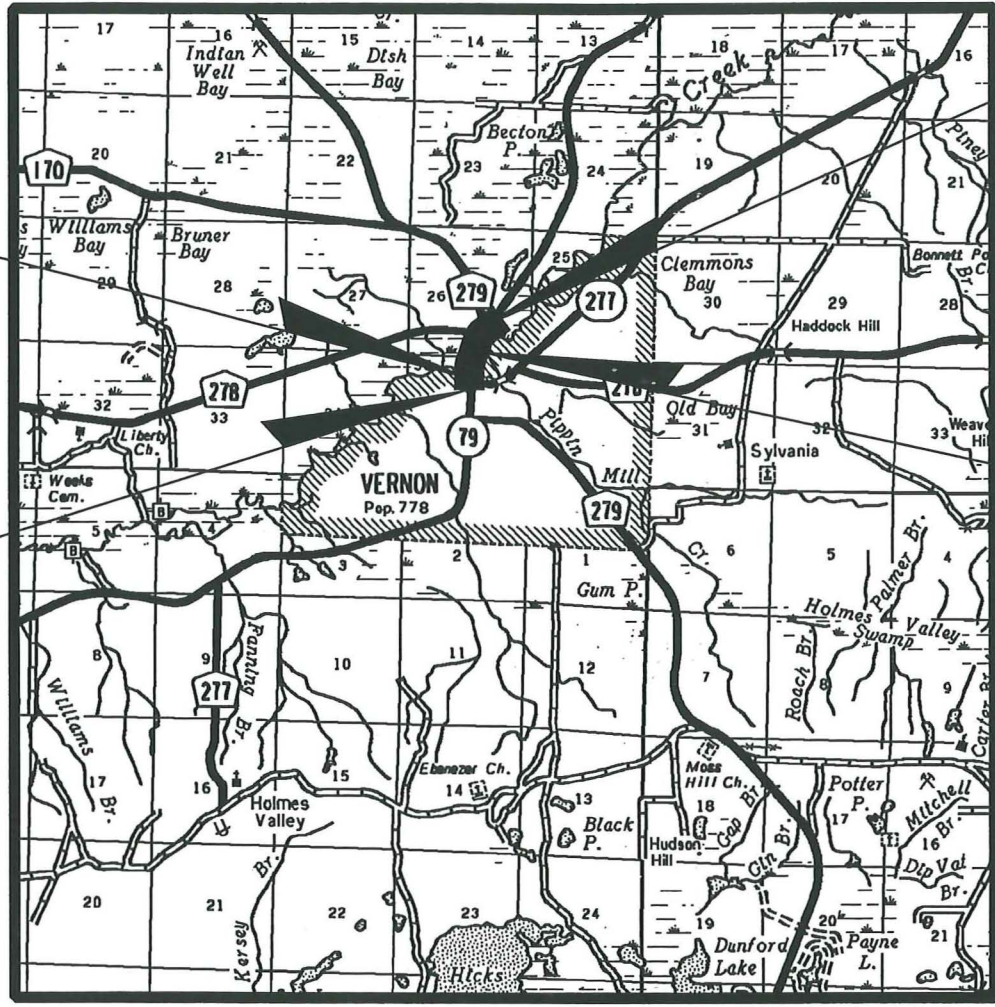

BEGIN BRIDGE  
STATION 1522+95.00

END PROJECT  
STATION 1564+20.00

BEGIN PROJECT  
STATION 1509+00.00  
MP 19.698

END BRIDGE  
STATION 1533+15.00

T-3-N  
T-2-N

T-3-N  
T-2-N

TO EAST

R-15-W  
R-14-W

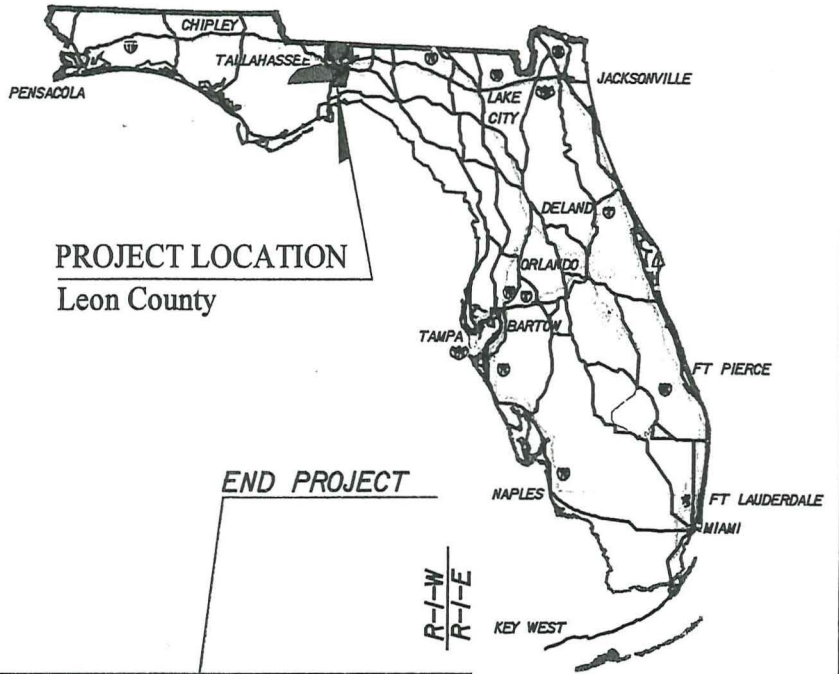

BEGIN PROJECT

END PROJECT

T-2-N  
T-1-N

T-2-N  
T-1-N

TO QUINCY

TO LLOYD

NTS

T-1-N  
T-1-S

T-1-N  
T-1-S

R-2-W  
R-1-W

R-1-W  
R-1-E

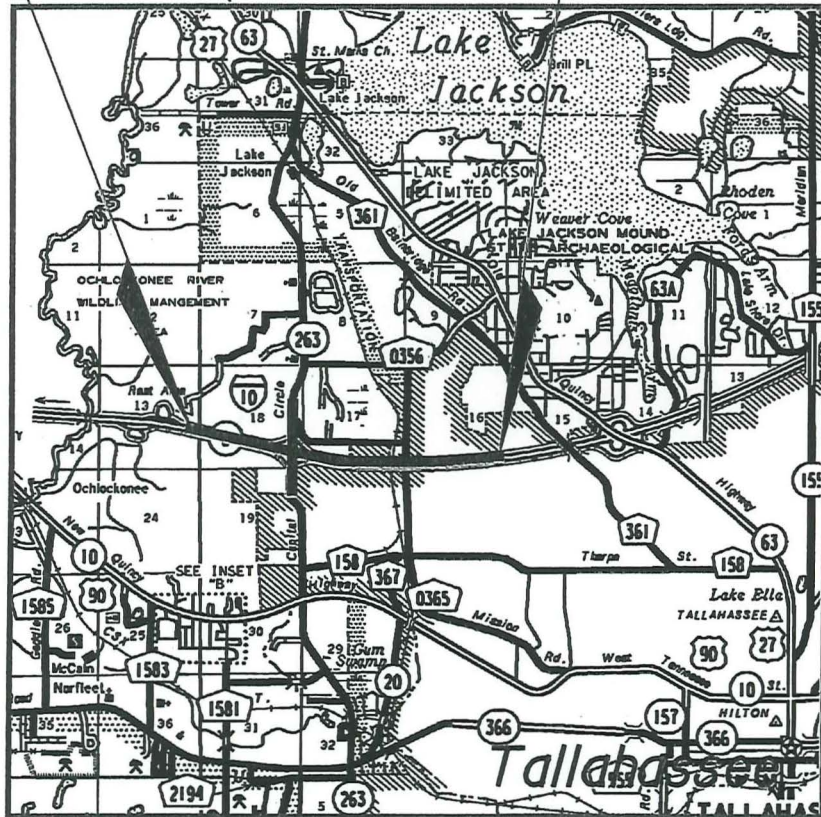

### PROJECT VICINITY MAP



FLORIDA DEPARTMENT of TRANSPORTATION  
Financial Project 222590-2-52-01

SR 8 (I-10) \ SR 263  
in Leon County

EXHIBIT 1